

EXHIBIT A

JEAN-MICHEL OTHONIEL

CORAL FOUNTAINS

FOR CORAL GABLES

MIAMI 2021

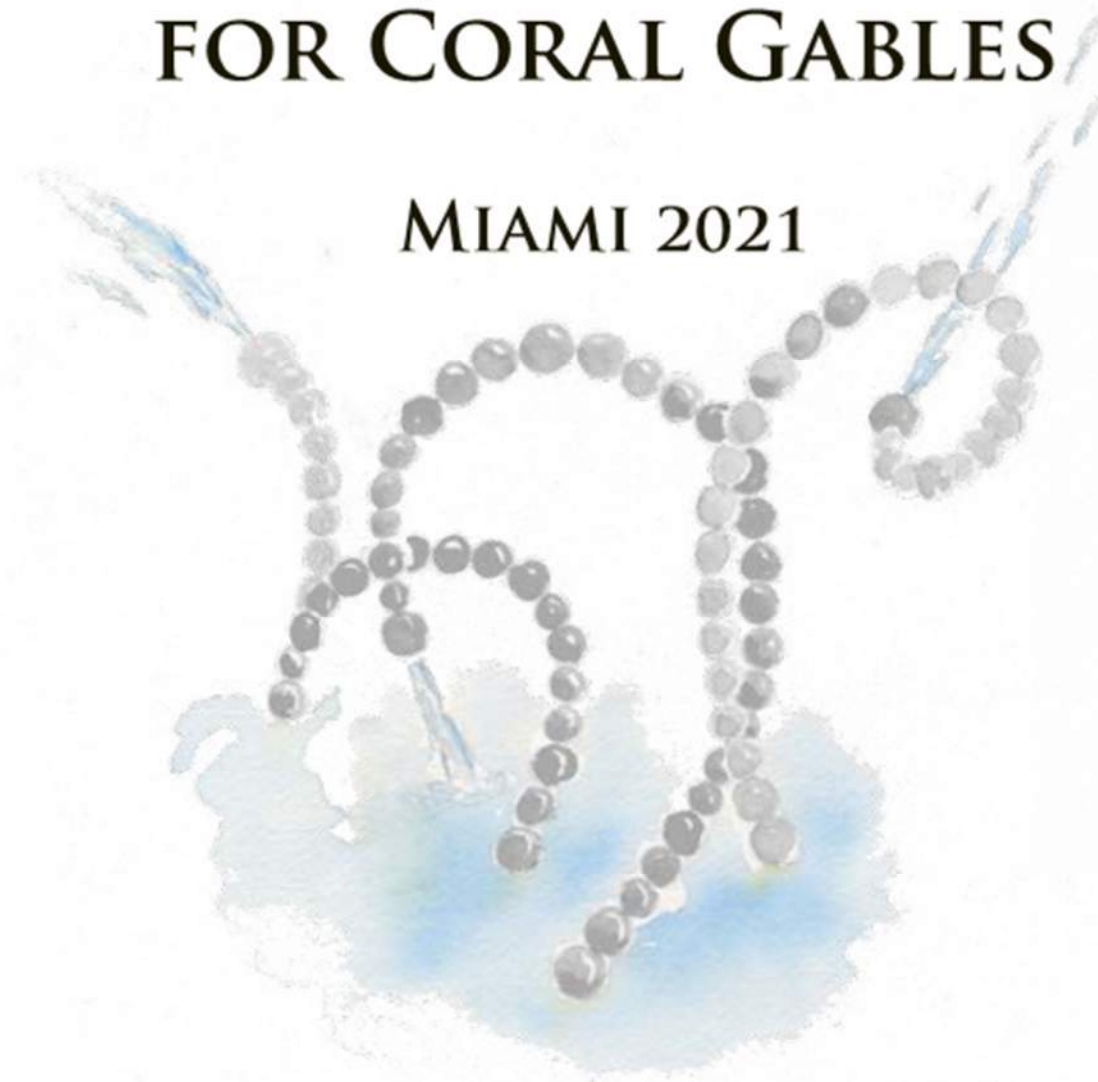

August 2020 Update

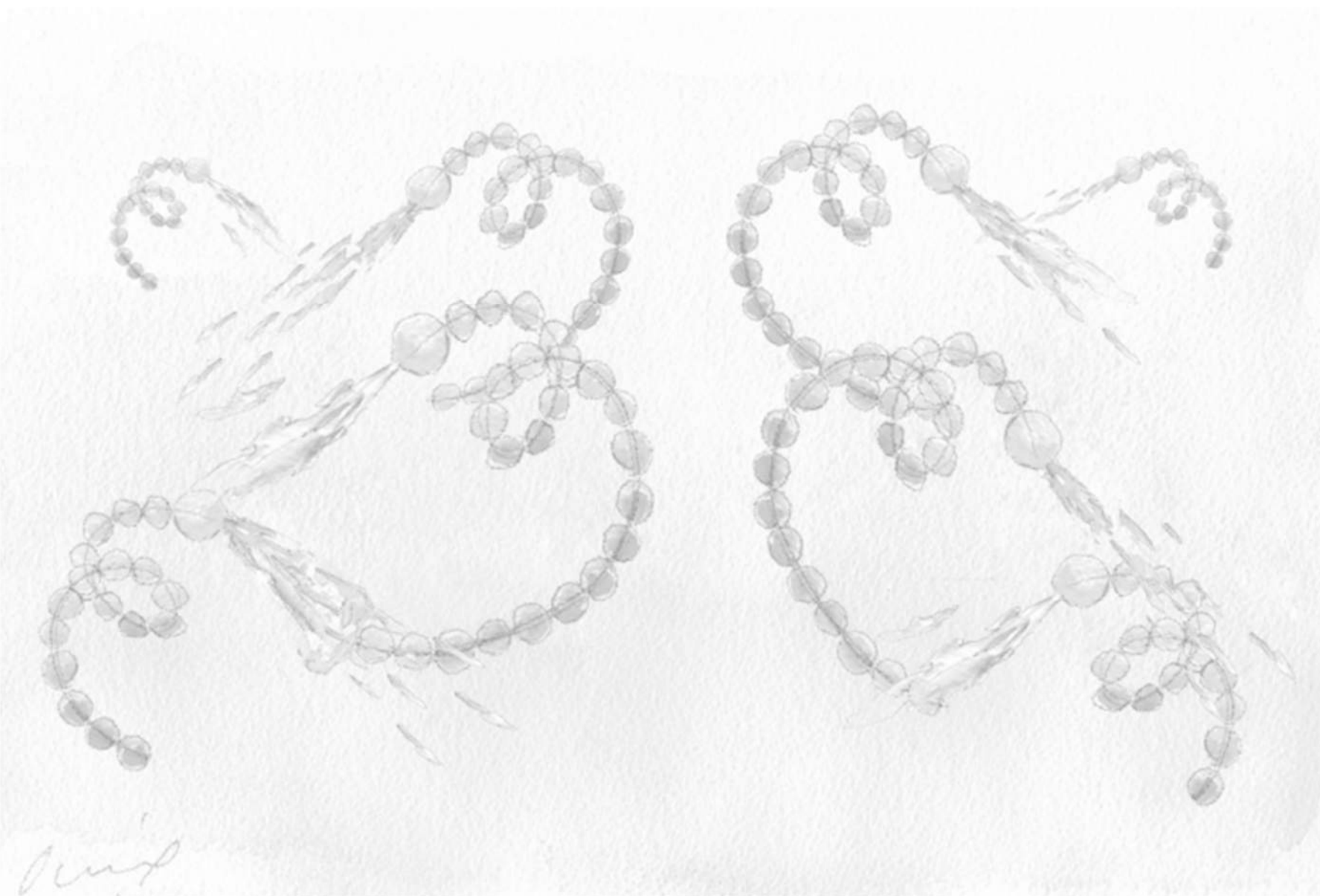

CORAL FOUNTAINS

« For Coral Gables, I wanted to create a sculpture linked to the water element and the sea. As the city is often presented as the pearl of South Florida, I decided to work with my signature element, the bead. I thus drawn fountain-sculptures made of gilded or mirrored beads, that will joyfully play with the water pond, as enigmatic and shimmering lively sea creatures. I always found a great inspiration in Ernst Haeckel's *Art Forms in Nature*. What first appealed to me and inspired me about those plates was the abstraction and constant symmetry into which Haeckel's prism translate forms found in nature. When first sketching the ideas for the shapes of the fountains, I thus drew organic and symmetric forms halfway between twisted corals and dancing sea horses. I then worked with mirrored beads extending the crystalline water jets like pure drops of gushing water. »

Jean-Michel Othoniel



MIRROR

The fountains deploy an interlacing string made of stainless steel mirrored beads that draws a perpetual movement, rising from the cristaline waters of the pond. Like a gush of water, the dynamic movement of the sculptures are extended by the water jet. As shimmering as a torrent they present an infinity of reflections creating complex and imaginary knots.

These curves and circumvolution forms are dynamic, sinuous constructions, calligraphic gestures that reflect the artist's love for writing and signs.



Tornado (detail), Mirror polished Stainless steel, 2017.





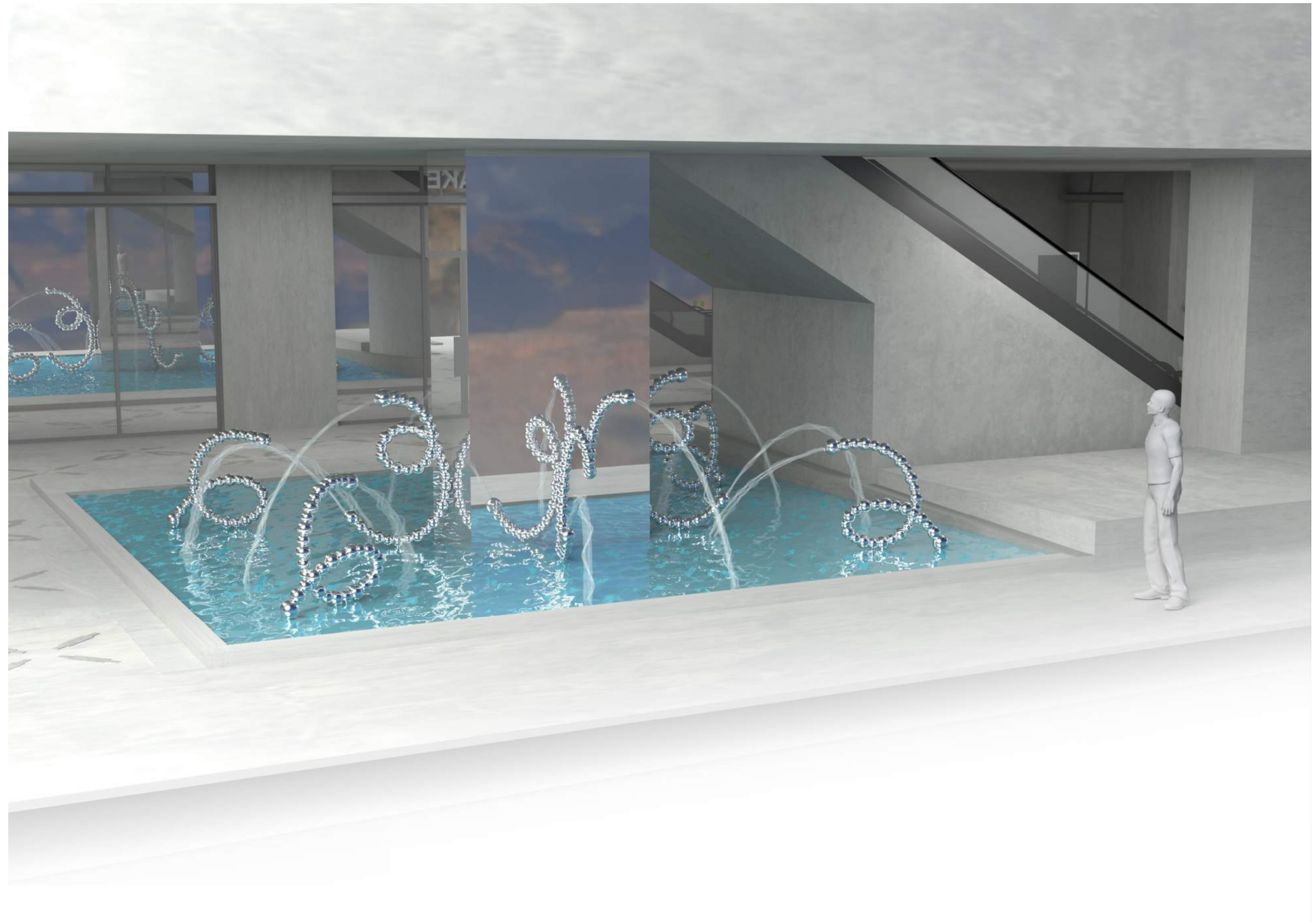

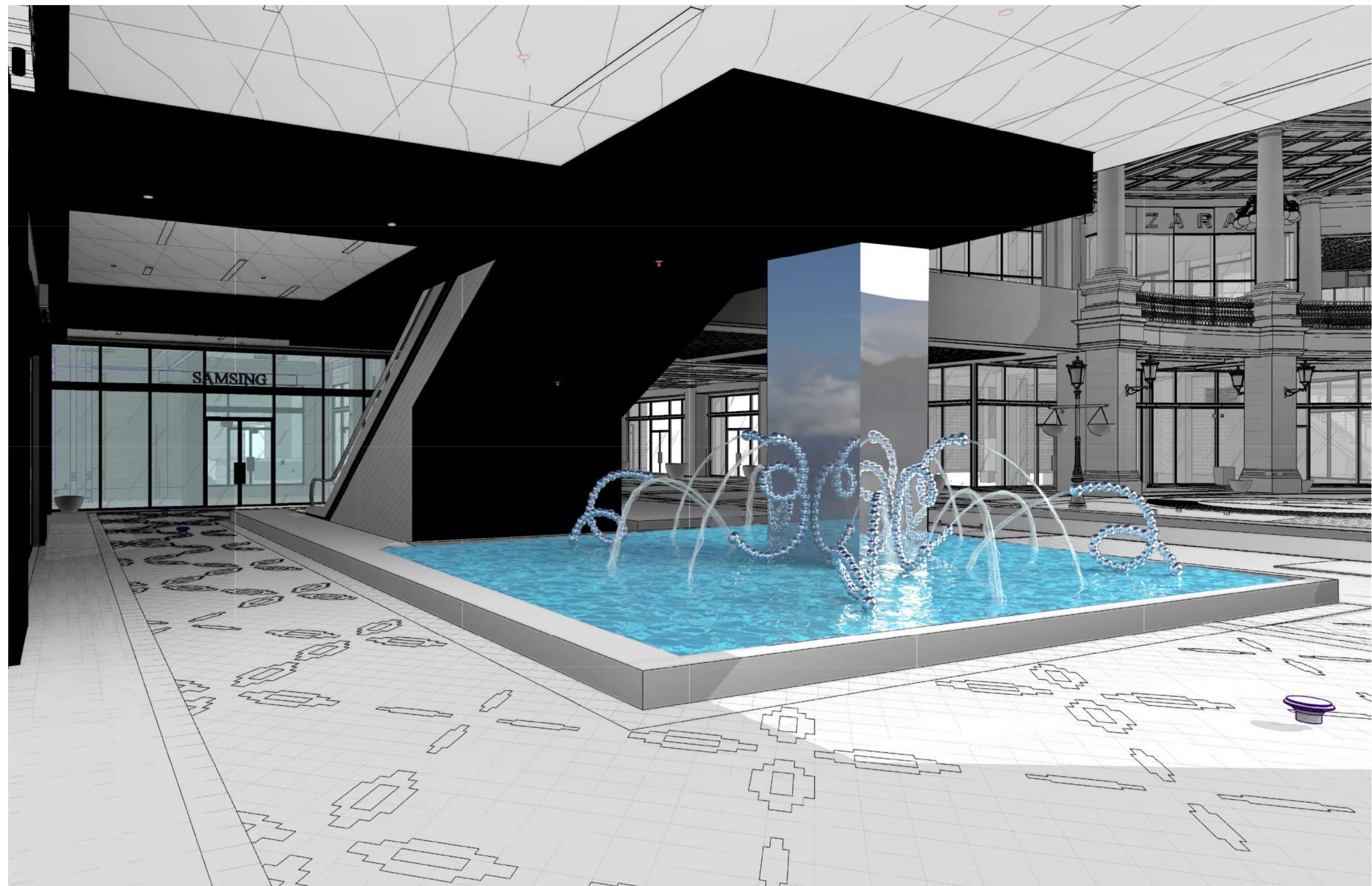

June 2020 Presented Version

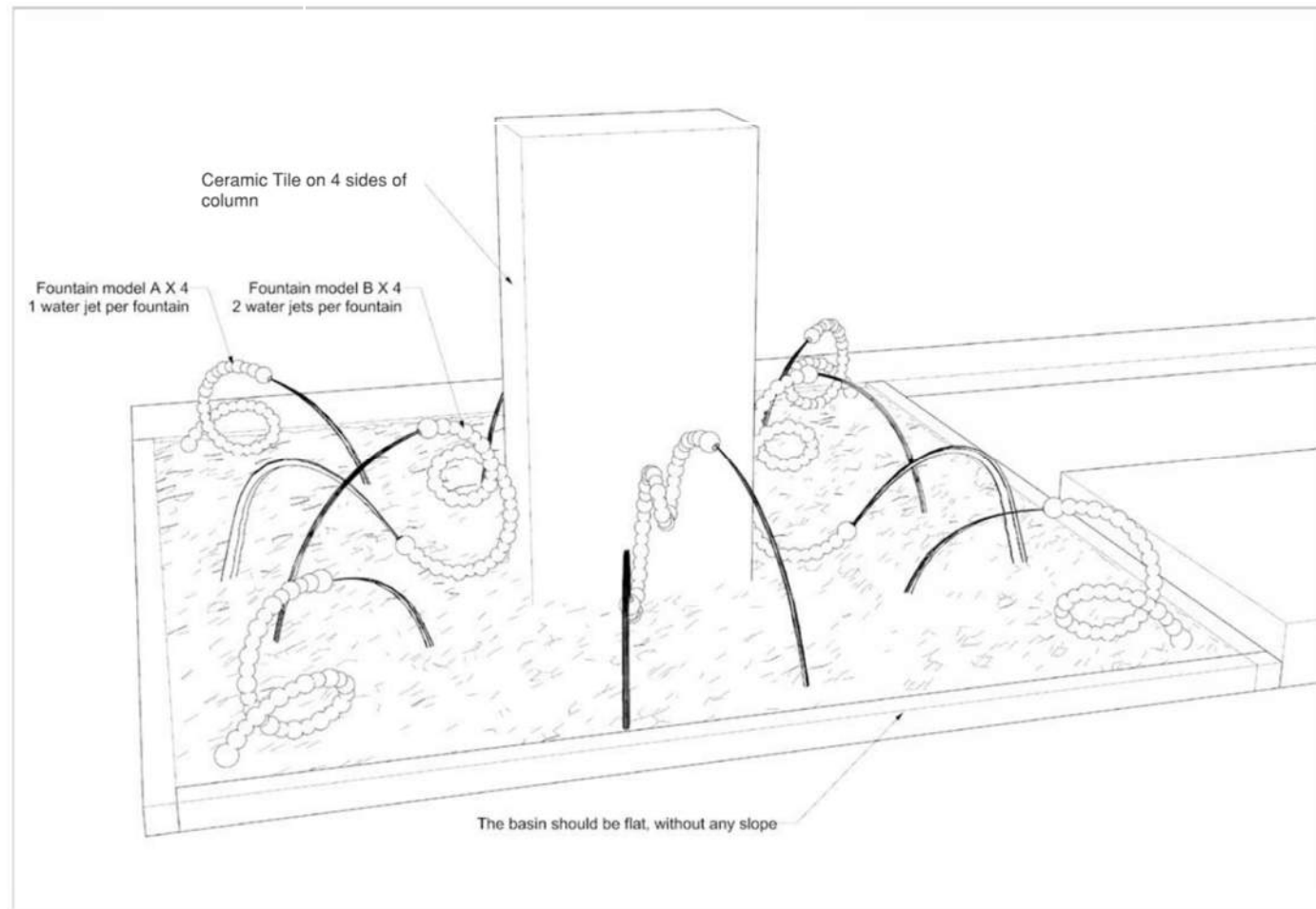

Othoniel Studio August 2020 revisions per Arts Advisory Panel

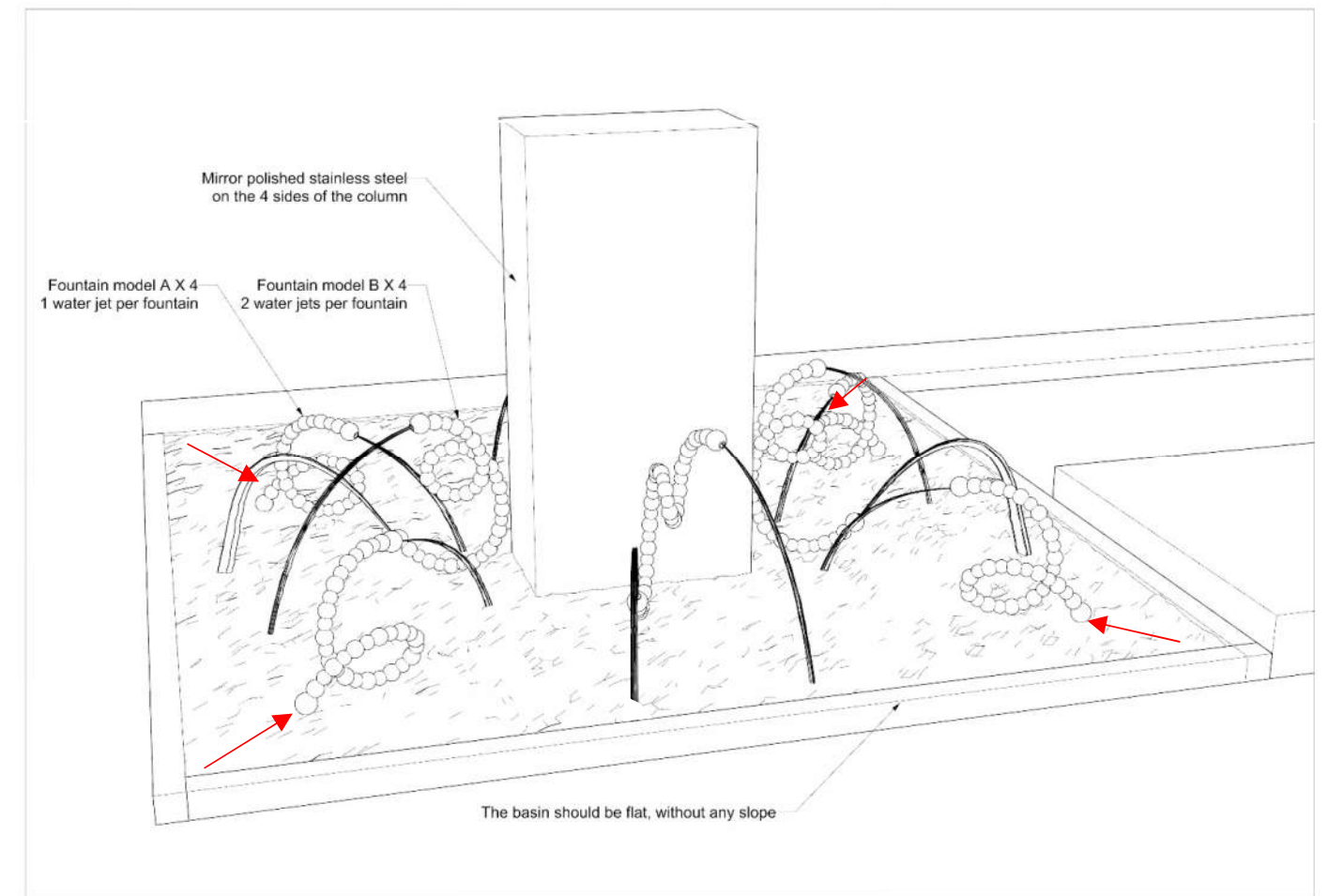

Latest revisions- summary

- JM Othoniel has relocated the 4 fountain model A X 4 inwards from the corners in order to address concerns regarding the close proximity to the pool edge and pedestrians attempting to touch the fountain elements.
- The tighter spacing of the individual elements/jets results in a denser and more elaborate, interesting and complex view around the column/pilar in the middle of the basin.
- JM Othoniel has revised the surface treatment of the pilar, which is now a polished stainless-steel mirrored surface. This treatment will greatly enhance the light and visual impact of the stainless steel silver mirrored beads and water from the jets. The basin will have a ceramic tile treatment. Maintenance of the polished stainless steel pilar surface will be by Agave/The Plaza, following similar maintenance and cleaning procedures as per JM Othoniel Studio for the mirrored beads.

- Upon further review regarding comments about potential water splashing on adjoining areas, both the Othoniel Studio and Agave have determined this not to be an issue. The fountain hydraulic systems and water jets are designed to be adjustable for flow intensity and direction. The B x 4 elements that project outwards, have been designed so as to leave enough distance from the inside edge of the basin.
- The overall fountain site location within The Plaza Coral Gables Project, is well protected from the weather specifically from strong wind and gusts that could interfere with the water fountain and splash adjoining areas. The water feature is located in the heart of the North Plaza area adjacent to the Project Reception/lobby, the valet/Under/Lyft lounge and selected food & beverage and retail establishments. A highly visible area with 24/7 security.



SIDE VIEW

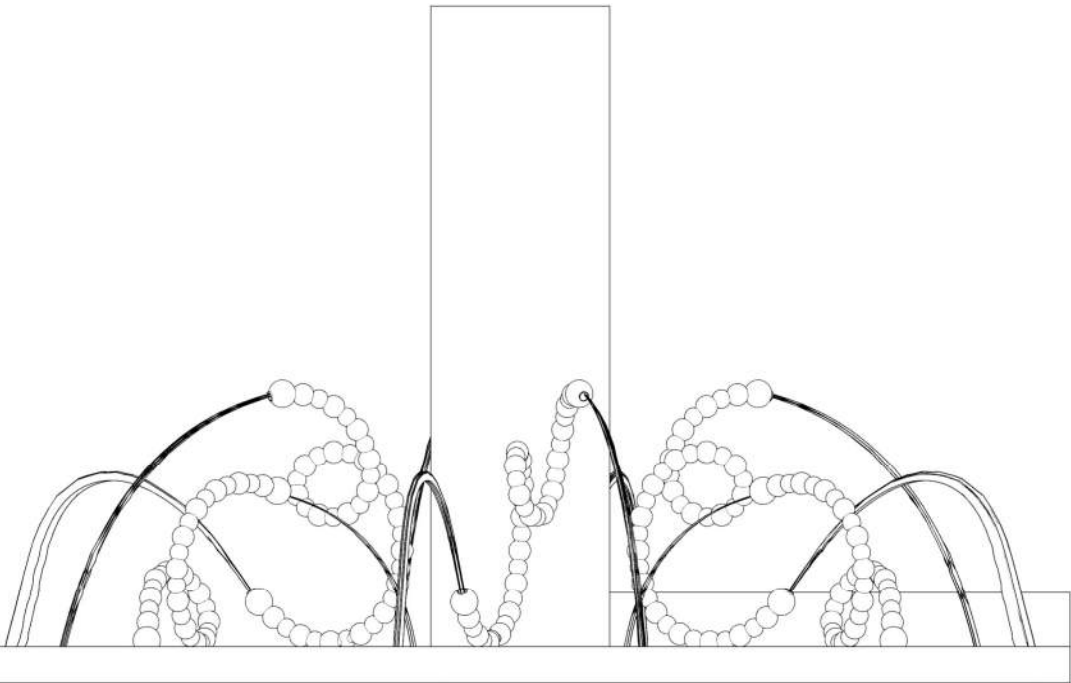

Scale 1/30 eme

Top view
Scale: 1/30eme
Units: mm
19_IN115

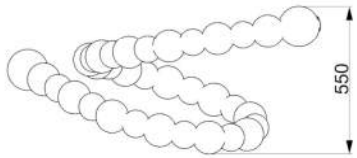

Fountain type A:
Bead Ø15mm: 2
Bead Ø 12: 17
Bead Ø 10: 16
Total Beads: 35
4 Fountains: 140 beads

Fountain type B:
Bead Ø15mm: 2
Bead Ø 12: 20
Bead Ø 10: 19
Total beads: 41
4 Fountains: 164 beads

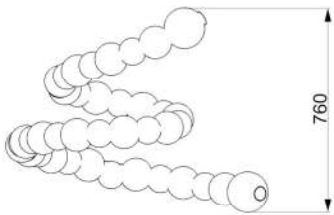

Front view
Scale: 1/30eme
Units: mm

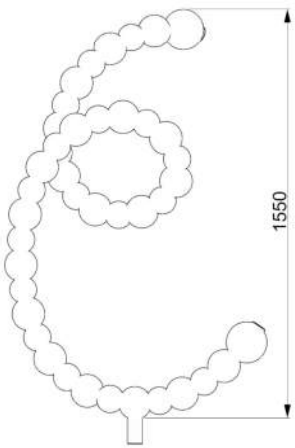
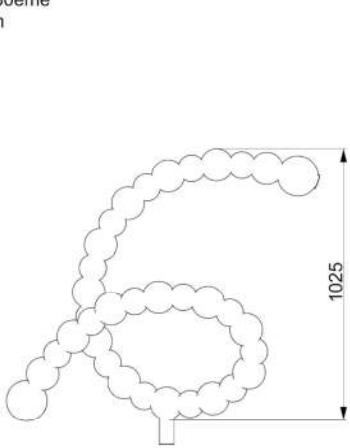

Right view
Scale: 1/30eme
Units: mm

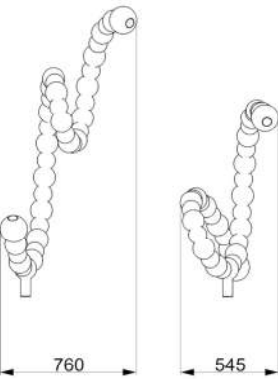

A SITE PLAN SHOWING THE LOCATION OF THE ARTWORK

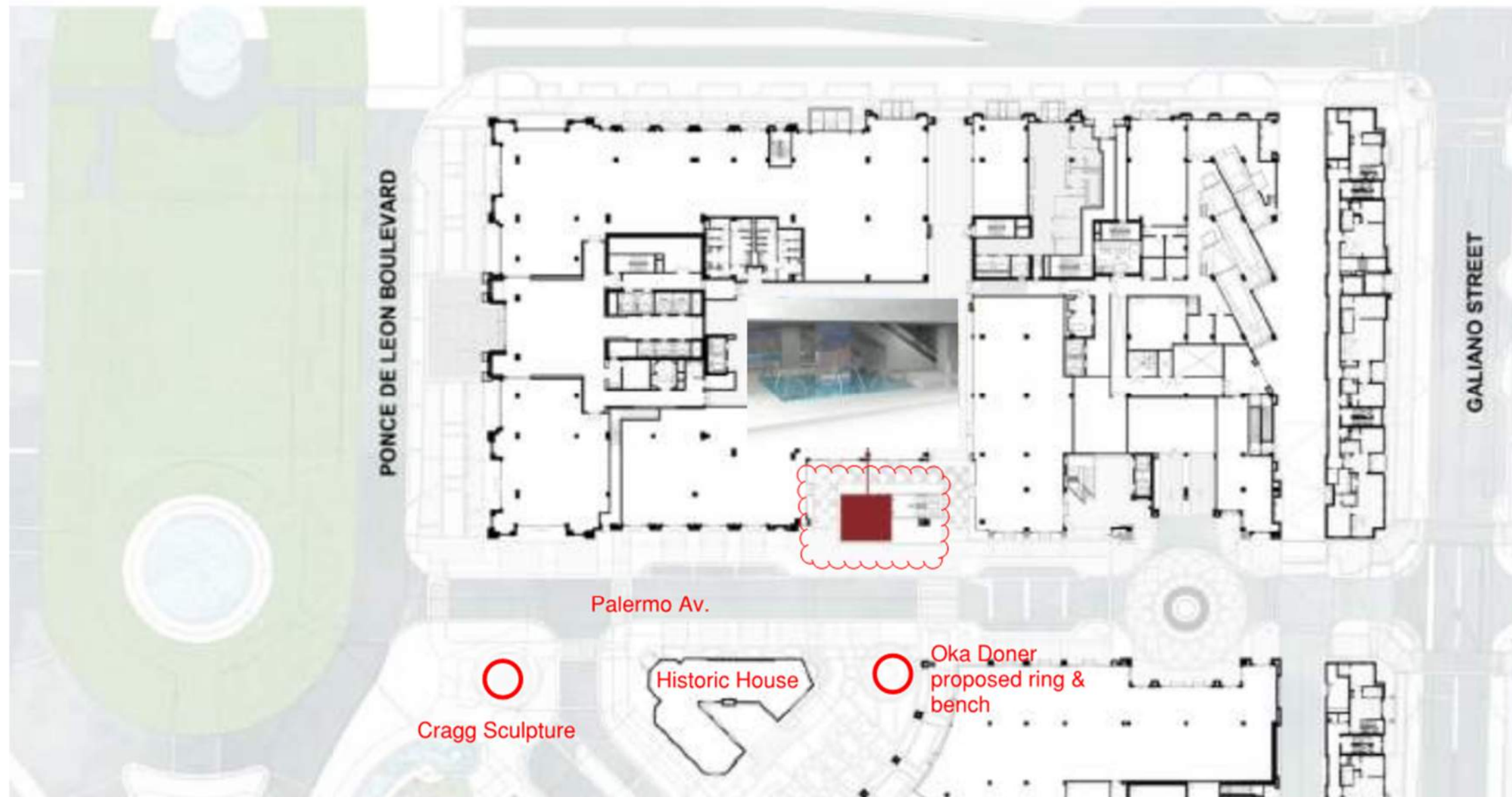

TECHNICAL INFORMATION

ARTWORK'S MANUFACTURING and HYDRAULICS

Othoniel Studio is manufacturing the fountains designed by Jean-Michel Othoniel but is not responsible for all the hydraulics part of the fountains.

The client must hire a fountain's specialist to design all the hydraulics system, to manufacture it and to install it.

Othoniel Studio and the appointed fountain's specialist must work together to achieve the fountain effects wished by Jean-Michel Othoniel starting before Othoniel Studio launches the manufacturing of the artwork.

- > Jean-Michel Othoniel will express his wish in terms of fountain's effects to the specialist.
- > The specialist will design the hydraulics accordingly.
- > Othoniel Studio and the specialist will agree on the type of tube needed for the fountains, on the jets, on the connections, on the fixings, etc.
- > Othoniel Studio will manufacture the fountains, including the fixings and the water flanges.
- > The specialist will manufacture the hydraulics.
- > The hydraulic system must be installed prior to the installation of the fountains.
- > The specialist must be present during the installation of the artwork to do all the settings (adjustments of the jets, power, etc.).

The fountains manufactured by Othoniel Studio will be delivered in Othoniel Studio in Montreuil (Paris area, France).

The client is responsible for packing, transport and installation.

Othoniel Studio will send a team to Miami with the artist to install the fountains at the cost of the client. Number of people and of days on site will be fixed according to the project.

BASIN AND COLUMN

Jean-Michel Othoniel would like the client to manufacture the basin entirely flat, with no slope.

Jean-Michel Othoniel would like the central column to be covered with mirror polished stainless steel on the 4 sides of it to reflect the artwork.

The client is responsible for providing and installing the mirror polished stainless steel.

MAINTENANCE

Othoniel Studio will provide a maintenance sheet for the fountains upon delivery.

If the client chooses the gilded version of the artwork, the fountain water treatment must be very rigorous.

There are numerous examples of gilded fountains all around the world (Place de la Concorde in Paris, in Versailles, etc.) that last during years and years without any problem with a very specific treatment (without any limescale, several filters, important engine room, etc.).

The client will thus have to ensure that the treatment is appropriate and is continuous all year long.

If the treatment is not appropriate the gold might deteriorate.

LIGHTING

Othoniel Studio is not responsible for the lighting of the fountains. Jean-Michel Othoniel can advise on the type of lighting he wishes but the client is responsible for designing, providing and installing the lighting system.

A STATEMENT OF HOW THE PROPOSED ARTWORK ADDRESSES
BROADER CITY URBAN DESIGN GOALS

Jean-Michel offers a fresh eye and contemporary voice. Enriching public environments, such as civic spaces and pedestrian streetscapes in France and all over the world. Local citizens of Coral Gables, employees and visitors will experience this with his proposed fountain at The Plaza Coral Gables.

Othoniel’s predilection for materials with reversible and often reflective properties – particularly blown glass and mirrored steel that has been the hallmark of his practice since the early 1990s – relates to the deeply equivocal nature of his art. Creating art that is monumental yet delicate, baroque yet minimal, poetic, and contemplative.

Jean-Michel Othoniel’s holistic sensibility further compares to Feng Shui or the art of harmonizing people with their environment, in his case allowing viewers to inhabit his world through reflection and motion. This work will expand upon and contribute to economic development and tourism, add beauty and interest to public spaces and increase opportunities for the public to experience and participate in the arts through the acquisition and installation of world-class art in publicly accessible areas.

Furthermore the Jean-Michel’s fountain will build on Coral Gables’ identity as “a unique city of artistry and beauty establish the City as a leader in the region’s vibrant visual arts community that facilitates projects that garner national and international acclaim.”

		THE PLAZA CORAL GABLES - Art In Public Spaces	
		CORAL FOUNTAINS - by Jean Michel Othoniel	
	Item	Description	Amount
	1	AutoCad drawings and concept	\$ 65,000
	2	Fabrication \ Production\ Hydrolics and fountain tech	\$ 685,000
	3	Shipping estimate	\$ 25,000
	4	Installation (allowance)	\$ 25,000
	5	Art Consultant Fee	\$ 25,000
	6	plaque	\$ 2,500
	7	revised stainless steel pilar cladding	\$ 21,000
		Total JM Othoniel Studio	\$ 848,500
Other items part of feature but being furnished/paid by Owner			
	6	Water Feature	owner
	5	Tile finish @ basin	owner
	7	Fountain perimeter stone top	owner
	8	All mechanical/water systems	owner
	9	All Lighting/Electrical systems	owner
	10	maintenance	owner
		GRAND TOTAL	\$ 848,500



CONTACT

OTHONIEL STUDIO

18, rue de la Perle

75003 - Paris

France

Thomas Patrix

thomas@othoniel.fr

T +33 (0)1 43 67 47 22

www.othoniel.fr