

Shops at Merrick Park Landscape

Area 1



Area 2



Shops at Merrick Park Landscape

Area 3



Shops at Merrick Park Landscape

Area 4



Area 5



Shops at Merrick Park Landscape

Area 6



Area 6



Shops at Merrick Park Landscape

Area 6



Area 6



Shops at Merrick Park Landscape

Area 7



Area 8



Shops at Merrick Park Landscape

Area 9



Area 9



Shops at Merrick Park Landscape

Area 10



Area 10



Shops at Merrick Park Landscape

Area 11



Area 11



Shops at Merrick Park Landscape

Area 12

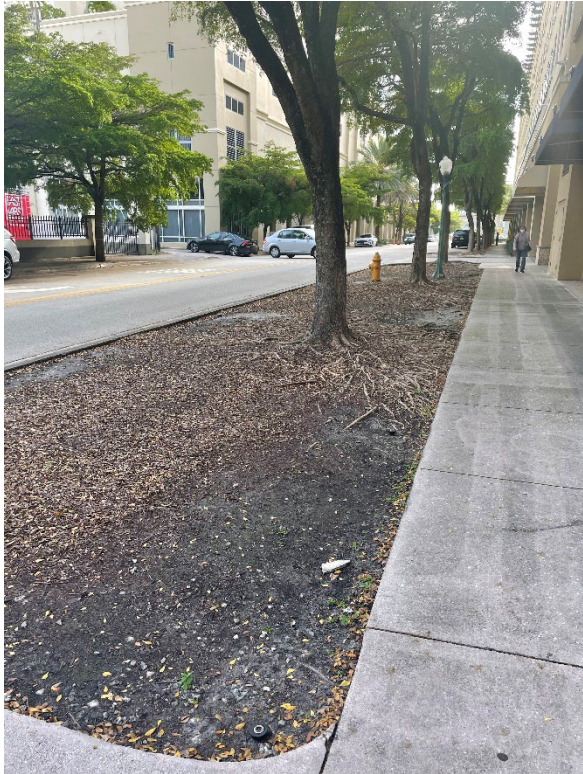

Area 13



Shops at Merrick Park Landscape

Area 14



Area 15



GRC
 GRASS ROOTS
 COMPLETE
 2775 Burris Road Suite 7B
 Davie, FL 33314
 954-970-5252
 sales@grcservices.com



** Need Permits*
** Same MATHEMATICS*
** 1 week mobilizing*
** 1 week / 1 week / 2 weeks*
 PROPOSAL # 30212
 DATE 02/08/2022 3-5 weeks

PROPOSAL

ADDRESS
 Shops at Merrick Park 4220-
 3352365
 246 Altara Avenue
 Coral Gables, Florida 33146

SHIP TO
 Shops at Merrick Park 4220-
 3352365
 246 Altara Avenue
 Coral Gables, Florida 33146

DESCRIPTION	QTY	RATE	AMOUNT
Code Violation Remediation Estimate			
AREA 1 (NOTED ON MAP)			
Crinum Lily - 3 gal -Planted in median between black olives (alternating gaps with Rojo Congo)	46	20.00	920.00
Philodendron Rojo Congo - 3 gal -Planted in median between black olives (alternating gaps with Crinum Lily)	50	18.50	925.00
			Subtotal: 1,845.00
AREA 2 (NOTED ON MAP)			
Grind Down Roots of (2) Royal Palms	2	250.00	500.00
Evergreen Liriope - 1 gal -Planted around base of Royal Palm -12 each tree	24	8.25	198.00
			Subtotal: 698.00
AREA 3 (NOTED ON MAP)			
Wax Jasmine - 3 gal -Fill ins on both sides of the street where dead or empty -NOTE: Many of these replacements will be required as a result of root grinding work	325	18.50	6,012.50
Grind Down Royal Palm Stumps	33	250.00	8,250.00
			Subtotal: 14,262.50
AREA 4 (NOTED ON MAP)			

All past due invoices will accrue interest on the unpaid balance at the rate of eighteen percent (18%) per annum, or the highest rate permissible by law. Customer agrees to pay any and all costs of collection, whether through litigation or otherwise, including reasonable attorneys' fees incurred up through any appeal.

DESCRIPTION	QTY	RATE	AMOUNT
Grind Down Royal Palm Stumps	9	250.00	2,250.00
Evergreen Liriope - 1 gal -12 around the base of each tree	108	8.25	891.00
			Subtotal: 3,141.00
AREA 5 (NOTED ON MAP)			
Wax Jasmine - 3 gal -Fill in under Royal palm and adjacent bed	50	18.50	925.00
Evergreen Liriope -1 gal -Fill in under Greco Ave Sign	18	8.25	148.50
Ixora Nora Grant - 3 gal -Fill in declined in bed	7	18.50	129.50
AREA 6 (NOTED ON MAP)			
Remove Ixora Nora Grant in small island	1	75.00	75.00
Evergreen Liriope - 1 gal -To replace Ixora Nora Grant	18	8.25	148.50
Trinette - 3 gal -Fill in under (1) Yield Sign	18	18.50	333.00
Evergreen Liriope - 1 gal -Install in empty bed under other yield sign	18	8.25	148.50
			Subtotal: 1,908.00
AREA 7 (NOTED ON MAP)			
Philodendron Burle Marx - 3 gal -For lower level plantings and raised planter in median	80	20.00	1,600.00
Wax Jasmine - 3 gal -Fill in median closer to A1A	35	18.50	647.50
			Subtotal: 2,247.50
AREA 8 (NOTED ON MAP)			
Ixora Nora Grant - 3 gal -Fill in small beds outside of construction area	40	18.50	740.00
			Subtotal: 740.00
AREA 9 (NOTED ON MAP)			
Ixora Nora Grant - 3 gal -Fill in large bed outside of circle	15	18.50	277.50
Wax Jasmine - 3 gal -Fill in large bed outside of circle	60	18.50	1,110.00
			Subtotal: 1,387.50
AREA 10 (NOTED ON MAP)			
Wax Jasmine - 3 gal -Fill in front of bed closest to circle	18	18.50	333.00

All past due invoices will accrue interest on the unpaid balance at the rate of eighteen percent (18%) per annum, or the highest rate permissible by law. Customer agrees to pay any and all costs of collection, whether through litigation or otherwise, including reasonable attorneys' fees incurred up through any appeal.

DESCRIPTION	QTY	RATE	AMOUNT
Crinum Lily - 3 gal -In middle gap between Black Olives	9	20.00	180.00
Philodendron Rojo Congo - 3 gal -In two outside gaps between Black Olives	30	18.50	555.00
AREA 11 (NOTED ON MAP)			
Grind Down roots of Royal Palms	14	250.00	3,500.00
Evergreen Liriope - 1 gal -Planted Around bases of Royal Palms (12 each)	168	8.25	1,386.00
			Subtotal: 5,954.00
AREA 12 (NOTED ON MAP)			
Wart Fern - 1 gal -Fill in empty bed	150	8.25	1,237.50
			Subtotal: 1,237.50
AREA 13 (NOTED ON MAP)			
Wax Jasmine - 3 gal -Fill in any declined material in small beds near road	25	18.50	462.50
			Subtotal: 462.50
AREA 14 (NOTED ON MAP)			
Remove shrubs on either side of Le Juene Sidewalk along Nieman Marcus	1	950.00	950.00
Top Soil - CY -To bring area grade up as the beds are much lower than sidewalk	20	85.00	1,700.00
Wart Fern - 1 gal -Spaced out to allow to fill in	840	8.25	6,930.00
			Subtotal: 9,580.00
AREA 15 (NOTED ON MAP)			
Wax Jasmine - 3 gal -Fill in center of median where Wax Jasmine is currently	50	18.50	925.00
			Subtotal: 925.00
Overall Site Work			
Removals/Prep work for areas as needed	1	2,000.00	2,000.00
Soil w/ Amendments for planting areas as needed (up to 10 CY)	1	850.00	850.00
			Subtotal: 2,850.00
Brown Mulch - Pallet	11	500.00	5,500.00
Architectural Plans to Match Installation Plan (IF NEEDED)	1	2,500.00	2,500.00

All past due invoices will accrue interest on the unpaid balance at the rate of eighteen percent (18%) per annum, or the highest rate permissible by law. Customer agrees to pay any and all costs of collection, whether through litigation or otherwise, including reasonable attorneys' fees incurred up through any appeal.

DESCRIPTION	QTY	RATE	AMOUNT
-------------	-----	------	--------

-Price to deliver signed and sealed Landscape Plan for City Approval if needed. Current rendering may suffice and this line item will be omitted from billing if it will qualify.

Irrigation Repairs

1 6,500.00 6,500.00

-Repair any defunct Irrigation Lines to areas where new plants are being installed as a result of ongoing construction, root growth, root grinding, etc.

-NOTE: Pricing does not include Boring underneath roadway if needed

-Invoice will bill for actual amount required up to proposed price. Any unforeseen work above and beyond NTE price will be proposed in writing prior to execution.

6 Months Warranty on Trees & Palms, 90 Days on Shrubs subject to sufficient Irrigation, Pest control, Fertilization & Maintenance. No Warranty on Sod, Podocarpus relocated material, or Material planted in Potted Containers. 50% Deposit on Acceptance - 50% Balance on Completion. Site must be delivered within 1" - 2" of final grade and cleared of rocks and debris. Note* - reasonable on site Field Adjustments may be necessary on date of installation and invoice will be adjusted accordingly. Irrigation modification will be billed for T&M. Designs and plans indicated or represented by this proposal are the exclusive property of GRC Services. Stump Grinding, mitigation trees not included. GRC will not be liable for any utility, cable, pipe or damage that may result from digging on client's property. Estimate assumes water source/hose hookup within 150' of planting location. Any planting areas needing a water truck due to lack of water source will incur an extra charge of \$200 per time.

TOTAL

\$61,738.50

Accepted By

Accepted Date

All past due invoices will accrue interest on the unpaid balance at the rate of eighteen percent (18%) per annum, or the highest rate permissible by law. Customer agrees to pay any and all costs of collection, whether through litigation or otherwise, including reasonable attorneys' fees incurred up through any appeal.

The Village
 of Merrick Park

CORAL GABLES FLORIDA

REGISTRATION
 STATE OF CALIFORNIA
 ARCHITECTS
 LICENSE NO. 31818
 EXPIRES 06/30/2011
 TEL: 510.549.2309

REGISTERED PROFESSIONAL ENGINEER
 STATE OF CALIFORNIA
 LICENSE NO. 44282
 EXPIRES 06/30/2011
 TEL: 510.549.2309

REGISTERED PROFESSIONAL LANDSCAPE ARCHITECT
 STATE OF CALIFORNIA
 LICENSE NO. 10000
 EXPIRES 06/30/2011
 TEL: 510.549.2309

REGISTERED PROFESSIONAL PLANNING ARCHITECT
 STATE OF CALIFORNIA
 LICENSE NO. 10000
 EXPIRES 06/30/2011
 TEL: 510.549.2309

REGISTERED PROFESSIONAL CIVIL ENGINEER
 STATE OF CALIFORNIA
 LICENSE NO. 10000
 EXPIRES 06/30/2011
 TEL: 510.549.2309

REGISTERED PROFESSIONAL ELECTRICAL ENGINEER
 STATE OF CALIFORNIA
 LICENSE NO. 10000
 EXPIRES 06/30/2011
 TEL: 510.549.2309

REGISTERED PROFESSIONAL MECHANICAL ENGINEER
 STATE OF CALIFORNIA
 LICENSE NO. 10000
 EXPIRES 06/30/2011
 TEL: 510.549.2309

REGISTERED PROFESSIONAL CHEMICAL ENGINEER
 STATE OF CALIFORNIA
 LICENSE NO. 10000
 EXPIRES 06/30/2011
 TEL: 510.549.2309

REGISTERED PROFESSIONAL INDUSTRIAL ENGINEER
 STATE OF CALIFORNIA
 LICENSE NO. 10000
 EXPIRES 06/30/2011
 TEL: 510.549.2309

REGISTERED PROFESSIONAL AERONAUTICAL AND NAUTICAL ENGINEER
 STATE OF CALIFORNIA
 LICENSE NO. 10000
 EXPIRES 06/30/2011
 TEL: 510.549.2309

REGISTERED PROFESSIONAL METALLURGICAL ENGINEER
 STATE OF CALIFORNIA
 LICENSE NO. 10000
 EXPIRES 06/30/2011
 TEL: 510.549.2309

REGISTERED PROFESSIONAL CIVIL ENGINEER
 STATE OF CALIFORNIA
 LICENSE NO. 10000
 EXPIRES 06/30/2011
 TEL: 510.549.2309

REGISTERED PROFESSIONAL ELECTRICAL ENGINEER
 STATE OF CALIFORNIA
 LICENSE NO. 10000
 EXPIRES 06/30/2011
 TEL: 510.549.2309

REGISTERED PROFESSIONAL MECHANICAL ENGINEER
 STATE OF CALIFORNIA
 LICENSE NO. 10000
 EXPIRES 06/30/2011
 TEL: 510.549.2309

REGISTERED PROFESSIONAL CHEMICAL ENGINEER
 STATE OF CALIFORNIA
 LICENSE NO. 10000
 EXPIRES 06/30/2011
 TEL: 510.549.2309

REGISTERED PROFESSIONAL INDUSTRIAL ENGINEER
 STATE OF CALIFORNIA
 LICENSE NO. 10000
 EXPIRES 06/30/2011
 TEL: 510.549.2309

REGISTERED PROFESSIONAL AERONAUTICAL AND NAUTICAL ENGINEER
 STATE OF CALIFORNIA
 LICENSE NO. 10000
 EXPIRES 06/30/2011
 TEL: 510.549.2309

REGISTERED PROFESSIONAL METALLURGICAL ENGINEER
 STATE OF CALIFORNIA
 LICENSE NO. 10000
 EXPIRES 06/30/2011
 TEL: 510.549.2309

REGISTERED PROFESSIONAL CIVIL ENGINEER
 STATE OF CALIFORNIA
 LICENSE NO. 10000
 EXPIRES 06/30/2011
 TEL: 510.549.2309

- Wax Jasmine
- Wart Fern
- Rojo Congo and Crinum Lily
- Evergreen Liriope
- Ixora Nora Grant
- Trinette
- Burle Marx Philodendron
- Royal Palm Grind w/ Liriope

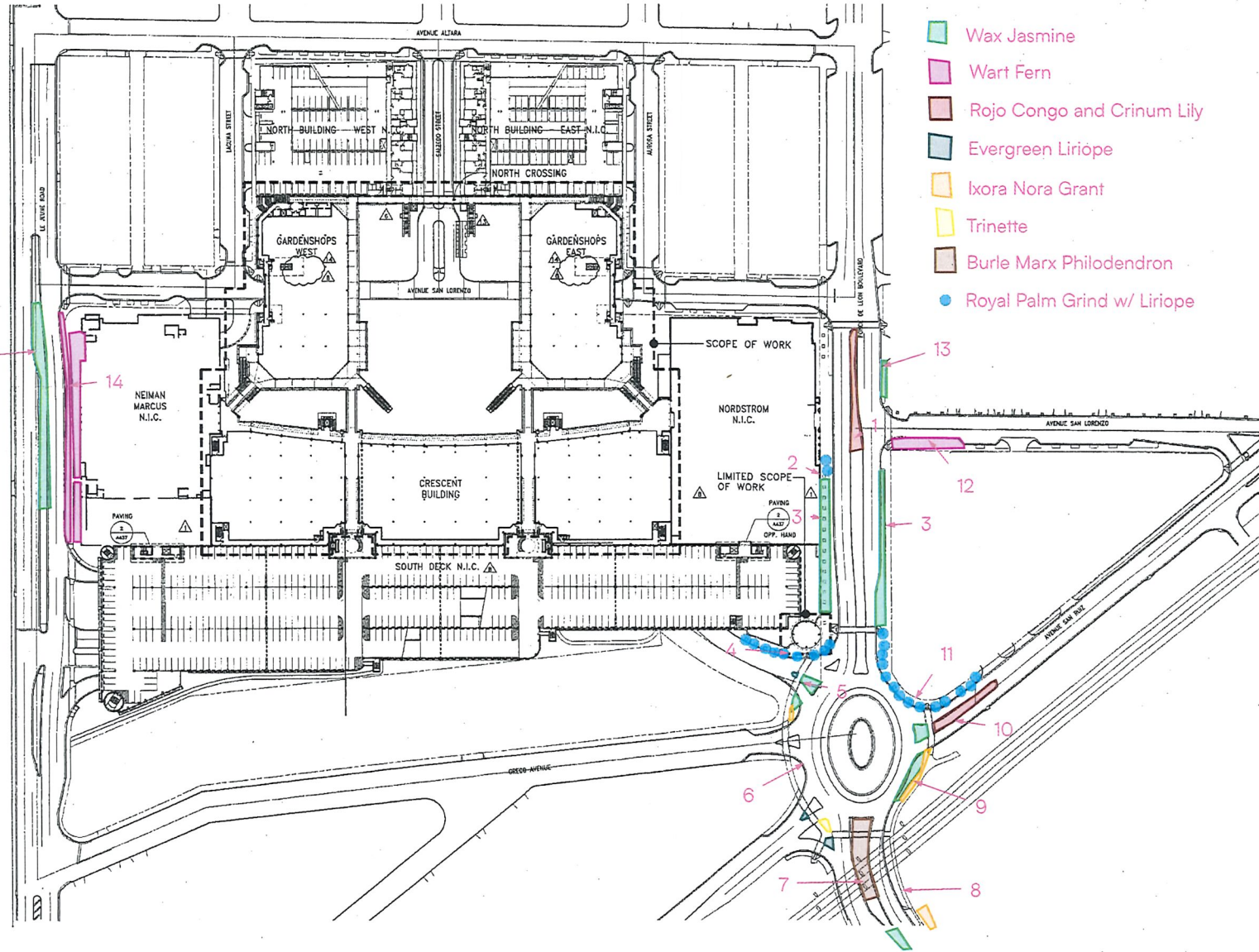

1 MAIN LEVEL COMPOSITE PLAN
 T = 50'-0"

R0158

REVISION 7	▲
REVISION 6	▲
REVISION 5	▲
REVISION 4	▲
REVISION 3	▲
REVISION 2	▲
REVISION 1	▲

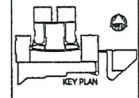

CONSTRUCTION DOCUMENTS

COMPOSITE PLAN
 MAIN LEVEL

DATE	9905.00	A202
SCALE	1"=50'-0"	
SHEET	11-08-00	
DATE	11-08-00	



City of Coral Gables
405 Biltmore Way
Coral Gables, FL 33134

<h1>Permit</h1>	Permit NO.: PWKS-22-04-0549
	Permit Type: Public Works Permit
	Work Classification: Swale planting/Irrigation
Permit Status: Issued	
Issue Date: 04/25/2022	Expiration: 05/25/2022

Location Address	Parcel Number	Building Code Version
358 SAN LORENZO AVE, Coral Gables, FL 33146-0000	0341200670040	FBC 2020

Contacts

Melissa C Castro, MED EXPEDITORS 2525 Ponce de Leon BLVD #300 300, CORAL GABLES, FL 33134 (786) 384-2353	Applicant MEDEXPEDITORS@GMAIL.COM
----------------------------------------------------------------------------------------------------------------	---------------------------------------------

Description: LANDSCAPING ON LE JEUNE, ENTRANCE TO GARAGE, AND ALONG BOTH SIDES OF PONCE DE LEON	Valuation: \$61,738.00
	Total Sq Feet: 0.00

--	--

A permit issued shall be construed to be a license to proceed with the work and not as authority to violate, cancel, alter or set aside any of the provisions of the technical codes, nor shall issuance of a permit prevent the building official from thereafter requiring a correction of errors in plans, construction or violations of this code. Every permit issued shall become invalid unless the work authorized by such permit is commenced within 6 months after its issuance, or if the work authorized by such permit is suspended or abandoned for a period of 6 months after the time the work is commenced.

WARNING TO OWNER: YOUR FAILURE TO RECORD A NOTICE OF COMMENCEMENT MAY RESULT IN YOU PAYING TWICE FOR IMPROVEMENTS TO YOUR PROPERTY. IF YOU INTEND TO OBTAIN FINANCING, CONSULT YOUR LENDER OR AN ATTORNEY BEFORE RECORDING YOUR NOTICE OF COMMENCEMENT. (F.S. 713.135)

THE NOTICE OF COMMENCEMENT MUST BE DISPLAYED AT THE JOB SITE.

NOTICE: In addition to the requirements of this permit there may be additional restrictions applicable to this property that may be found in the public records of this county, and there may be additional permits required from other governmental entities such as water management districts, state agencies, or federal agencies. Please be advised that in accordance with City Ordinance No. 2765, it is the responsibility of the property owner to repair all broken sidewalks. Compliance must be obtained prior to final Public Works approval.

A CERTIFICATE OF OCCUPANCY OR COMPLETION MUST BE SECURED BEFORE THIS BUILDING CAN BE USED FOR ANY PURPOSE.

April 25, 2022

Issued By: _____

Date

Required Inspections:

Inspection Type	Inspector Initials	Date
Final Public Works		