

01 SITE PLAN - GRADE
SCALE: 1/16" = 1'-0"

SHEET NOTES

GENERAL NOTES

CITY OF CORAL GABLES
245 Andalusia Avenue Coral Gables FL 33134

Gensler

545 NS 26th St
Suite 250
Miami, FL 33127
United States
Tel: 305.350.7070
Fax: 305.350.7071

**Kimley»Horn
Kimley Horn & Associates**

Landscape Architect
355 Alhambra Circle
Suite 1400
Coral Gables, FL 33134



Alpha Corporation

Civil Engineer
21000 Atlantic Boulevard,
Suite 400
Dulles, VA 20166

Alpha Corporation

Structural Engineer
21000 Atlantic Boulevard,
Suite 400
Dulles, VA 20166



TLC Engineering

MEP Engineer
5757 Blue Lagoon Drive
Suite 400
Miami, FL 33126

Date	Description
10/1/2021	ISSUE FOR SCHEMATIC DESIGN

Seal / Signature

NOT FOR CONSTRUCTION

Project Name
CORAL GABLES MOBILITY HUB
Project Number
79.0582.000
Description
SITE PLAN

Scale
1/16" = 1'-0"

A02.000

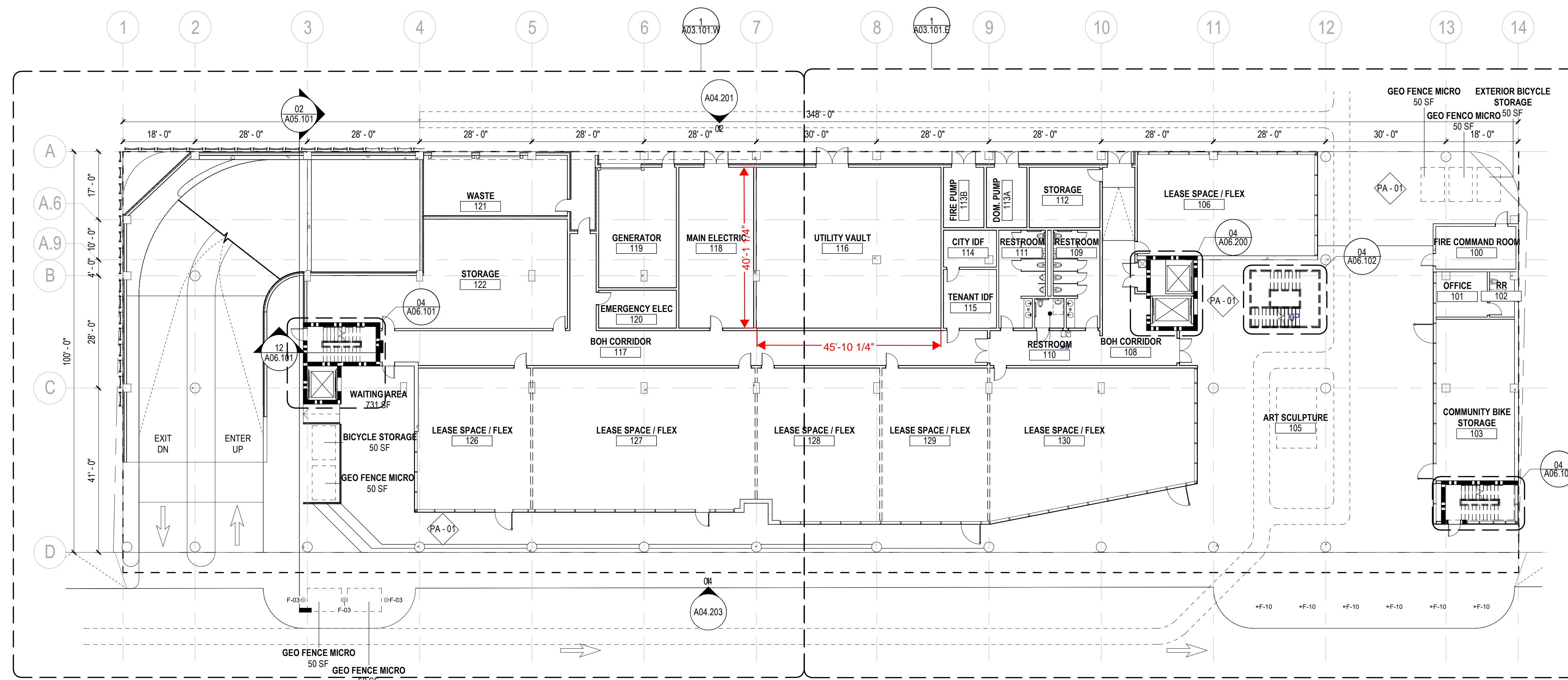

02 CONSTRUCTION PLAN - LEVEL 01
 SCALE: 1/16" = 1'-0"

GENERAL NOTES

Date	Description
10/12/2021	ISSUE FOR SCHEMATIC DESIGN

Seal / Signature

NOT FOR CONSTRUCTION

Project Name
CORAL GABLES MOBILITY HUB
 Project Number
79.0582.000
 Description
 CONSTRUCTION PLAN - LEVEL 01 & 02

MATERIAL LEGEND

AT-01	ARTIFICIAL TURF
CO-01	ARCHITECTURAL FINISH CONCRETE
CO-02	PAINTED CONCRETE
GL-01	GLAZING
MP-01	PERFORATED METAL PANEL
MT-01	PAINTED METAL
PA-01	EXTERIOR PAVERS
PL-01	PLANTERS
SL-01	SOLAR PANELS
RF-01	RESILIENT RUBBER PAVING
WD-01	ENGINEERED LUMBER FACADE
WD-02	ENGINEERED LUMBER FLOOR

Scale
 As indicated

Ref North

A02.201

04 CONSTRUCTION PLAN - LEVEL 02
 SCALE: 1/16" = 1'-0"

