

ANDALUSIA AVENUE

C.G.N.D.

C.N.

N.D.

C.C.

COLUMBUS BOULEVARD

CORDOVA BOULEVARD

F.N.D.

N.D.

C.C.

N.D.

C.C.

N.D.

C.C.

N.D.

C.C.

N.D.

C.C.

N.D.

C.C.

N.D.

C.C.

N.D.

C.C.

N.D.

C.C.

N.D.

C.C.

N.D.

C.C.

N.D.

C.C.

VALENCIA AVENUE

FLAG POLE

11.5

STORAGE

48.4

OFFICE

WOMEN'S LOCKER

32.8

WOMEN'S LOCKER

36.8

WOMEN'S LOCKER

36.8

WOMEN'S LOCKER

36.8

WOMEN'S LOCKER

36.8

WOMEN'S LOCKER

36.8

WOMEN'S LOCKER

36.8

WOMEN'S LOCKER

36.8

WOMEN'S LOCKER

36.8

WOMEN'S LOCKER

36.8

WOMEN'S LOCKER

36.8

WOMEN'S LOCKER

36.8

WOMEN'S LOCKER

36.8

WOMEN'S LOCKER

36.8

WOMEN'S LOCKER

36.8

WOMEN'S LOCKER

36.8

WOMEN'S LOCKER

36.8

WOMEN'S LOCKER

36.8

WOMEN'S LOCKER

36.8

WOMEN'S LOCKER

36.8

WOMEN'S LOCKER

36.8

WOMEN'S LOCKER

36.8

WOMEN'S LOCKER

36.8

WOMEN'S LOCKER

36.8

WOMEN'S LOCKER

36.8

F.P.

1-1/2"

F.P.

1-1/2"

F.P.

1-1/2"

F.P.

1-1/2"

F.P.

1-1/2"

F.P.

1-1/2"

F.P.

1-1/2"

F.P.

1-1/2"

F.P.

1-1/2"

ASPHALTED PARKING

SALVADORE PARK - EXISTING

SCALE: 1" = 40'-0"





ANDALUSIA AVENUE

C.G.N.D.

C.N.

N.D.

C.G.

COLUMBUS BOULEVARD

CORDOVA BOULEVARD

F.N.D.

N.D.

N.D.

N.D.

N.D.

C.G.

PROPOSED DOG RUN

ASPHALTED PARKING

VALENCIA AVENUE

SALVADORE PARK - PROPOSED AREAS

SCALE: 1" = 40'-0"

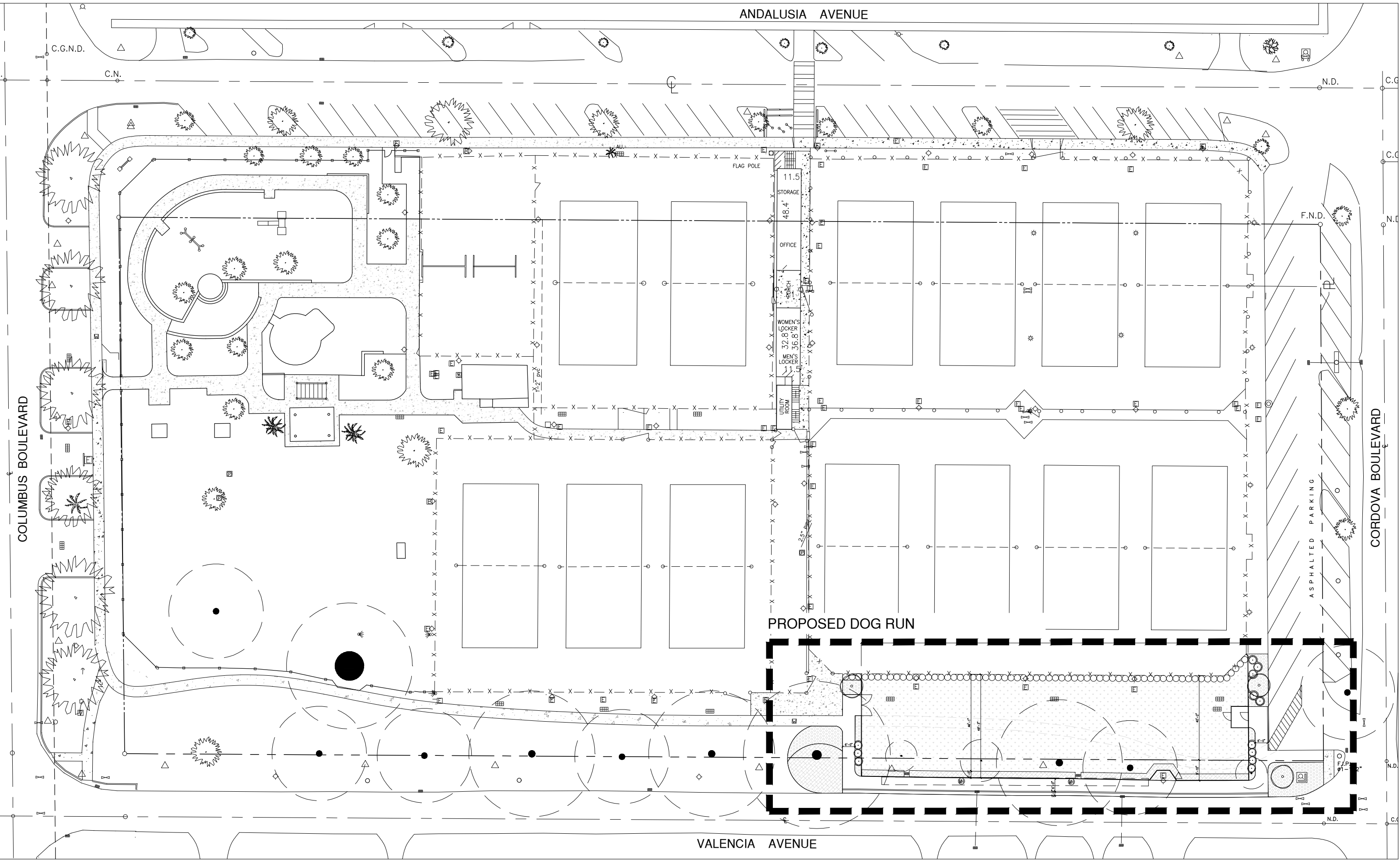





EXISTING TREE #1 - BLACK OLIVE
APPROX. 42" DBH, 50' HT, 70' SPR.



EXISTING TREE #2 - BLACK OLIVE
APPROX. 6" DBH, 30' HT, 15' SPR.



EXISTING TREE #3 - BLACK OLIVE
APPROX. 6" DBH, 35' HT, 20' SPR.

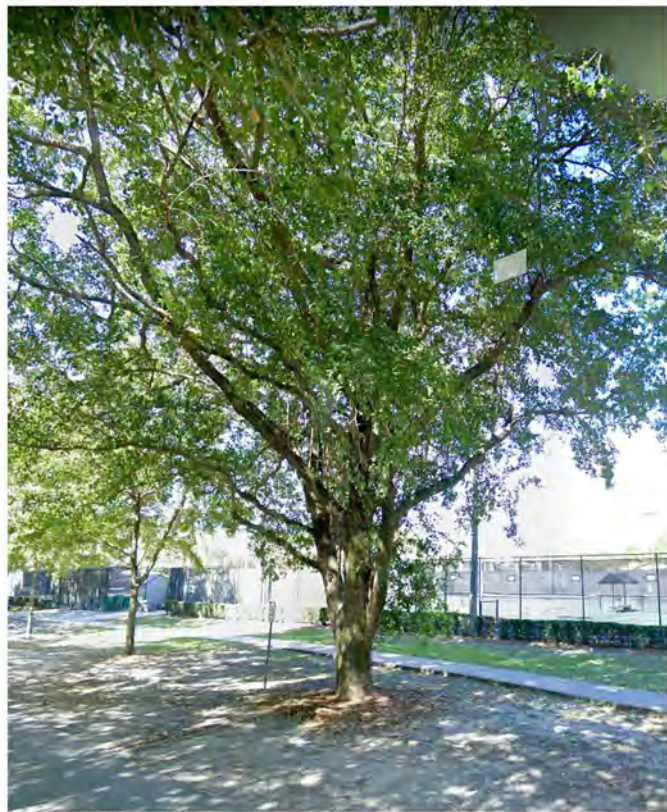

EXISTING TREE #4 - BLACK OLIVE
APPROX. 38" DBH, 45' HT, 60' SPR.



EXISTING TREE #5 - BLACK OLIVE
APPROX. 32" DBH, 40' HT, 45' SPR.



EXISTING TREE #6 - BLACK OLIVE
APPROX. 6" DBH, 20' HT, 15' SPR.



EXISTING TENNIS COURTS

EXFILTRATION TRENCHES
BELOW GRADE TO BE
REPLACED 184'-0"

10' MAINTENANCE
ENTRANCE

EX. TENNIS FENCE

EX. LIGHT POLE

CRABWOOD HEDGE
15 GAL.

EX. LIGHT POLE

EX. LIGHT POLE

EX. STORM DRAINS

EXISTING
PARKING LOT

CONVERT (1) TO
ADA PARKING
SPOT

CORDOVA STREET

ORANGE GEIGER TREES

EX. CONCRETE

EX. SIDEWALK

PROPERTY LINE

EX. STORM DRAINS

NEW 15" STORM DRAIN

EX. SIDEWALK TO BE DEMOLISHED

EX. STORM DRAINS

NEW 15" STORM DRAIN

REMOVE EX. INLET

ST. AUGUSTINE SOD

PEDESTRIAN/DOG
PARK ENTRY

NEW 6" CURB

NEW INLET

6'-0"

46'-1"

49'-3"

40'-2"

NEW SIDEWALK

F.I.P.
Ø1-1/2"

N.D.

EX. WALK

EX. SLAB
COVERED DITCH

VALENCIA AVE

EX. INLET

NEW ALUMINUM FENCE
W/ GATES. 5' HT. MIN.

RED TIP COCOPLUM
3 GAL.

NEW 2'
CURB & GUTTER

NEW INLET

EX. INLET

EX. LIGHT
POLE.

9 - SATIN LEAF TREES
20'-22' O.C.

EDGE OF ROAD

NEW CONCRETE SIDEWALK,
6' WIDE W/ NEW 2' CURB & GUTTER

YELLOW LANTANA

ORANGE GEIGER N.D.

C.G.N

1 - BULNESIA ARBOREA

BAHAMA COFFEE

SALVADORE PARK - DOG RUN - ENLARGEMENT

SCALE: 1" = 20'-0"

