



516 Caligula Ave., Coral Gables

French Country Village

Historical Landmark – Copper Chimney Cap Proposal

Slate Roof Project Update

100th-Year Birthday Present - 100 Year Materials Guarantee



Copper Cap Around Cylindrical Chimney
More low profile than this – custom made



- Oldest Picture On File
- 1926 Historical Landmark
- French Country Village
- Appears Mixed Color Slate





- Recent Pictures 2024
- Multi shades of Brown
- Ludovici Terracotta Tile



French Hooked Slating

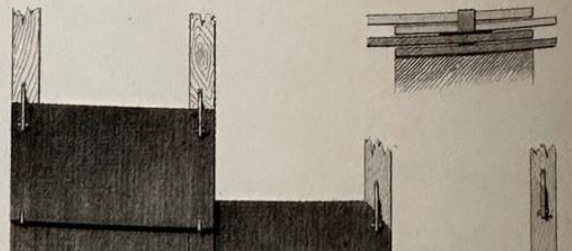
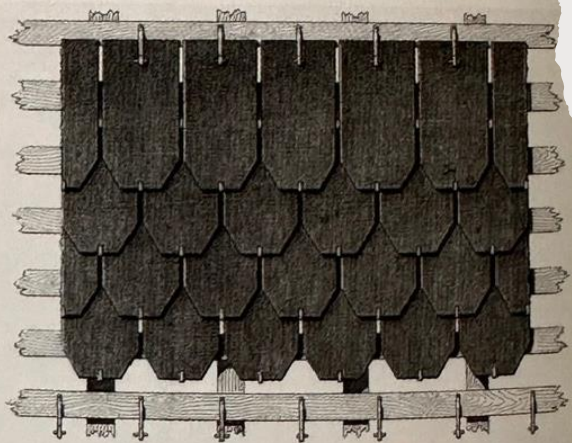
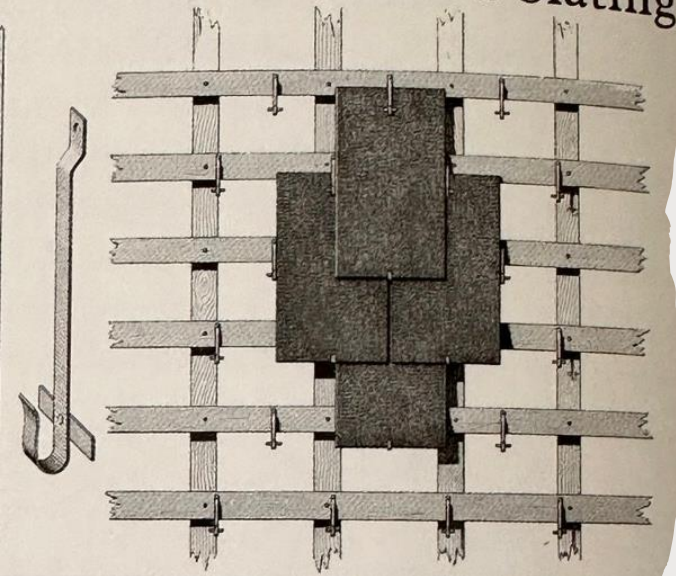

Traditional French Fish Scale Design

- Maintain traditional heritage of the architecture while honoring the French Country design.
- Enhancement to a more refined and durable slate roof designed to last over 100 years.
- Unparalleled quality of materials sourced from Europe and custom cut for the home from quarries that provide slate to Provence.
- Installation by world renowned slate master craftsman who would relocate to Miami for 3-4 months.

Shapes of French Slates - 1863



French Hooked

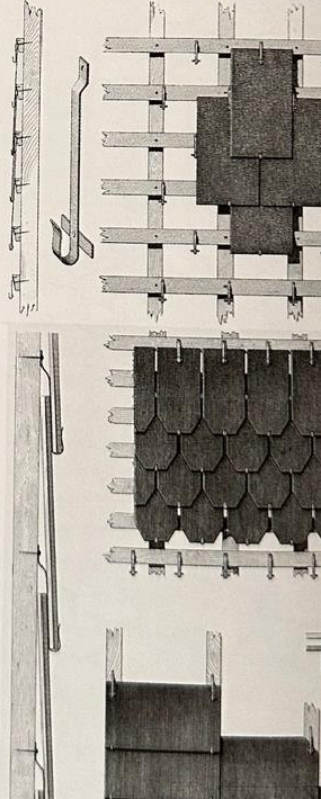

FRENCH PROVINCIAL ARCHITECTURE

*As shown in Various Examples
of Town & Country Houses, Shops
& Public Places adaptable to
American conditions*

by
PHILIP · LIPPINCOTT · GOODWIN
&
HENRY · OOTHOVT · MILLIKEN



Philip Lippincott Goodwin

- Architect of 516 Caligula Ave.
- Co-authored “French Provincial Architecture” in 1924, 2 years prior to building 516 Caligula Ave.
- Passionate about adapting traditional French architecture to American neighborhoods.
- Multiple examples of fish scale slate in the book that may have inspired him.



Buildings of the Chateau of Saumery, Huisseau-sur-Cosson (Loir-et-Cher)

Well

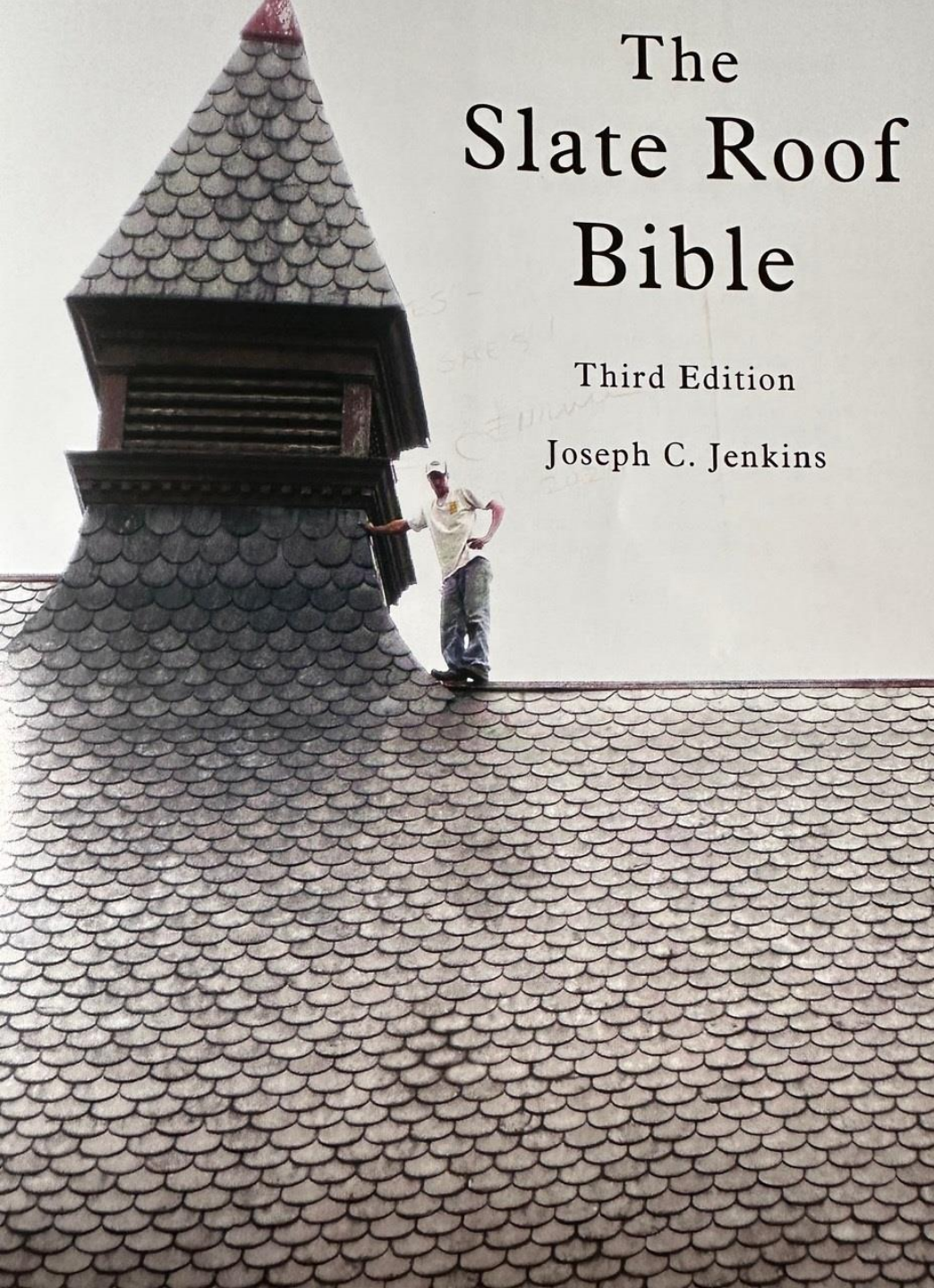
The book cover features a photograph of a man in a white shirt and blue jeans standing on a dark slate roof. The roof has a complex structure with multiple gables and a small cupola. The man is positioned on the lower part of the roof, looking towards the camera. The background is a clear sky.

The Slate Roof Bible

Third Edition

Joseph C. Jenkins

The image shows two church steeples. The one on the left is covered in dark slate tiles and has a small decorative finial on top. The one on the right is also covered in dark slate tiles but has a large, simple wooden cross on top. The background is a clear sky.

Jenkins Slate Masters

- World Renowned Slate & Copper Master Craftsmen.
- Would relocate to Miami January – April 2025.

Examples

- Traditional to France



Examples

- Imports to the US



-
- 516 Caligula
 - Slate Design Area Diagram

CALIGULA AVE CALIGULA AVE CALIGULA AVE

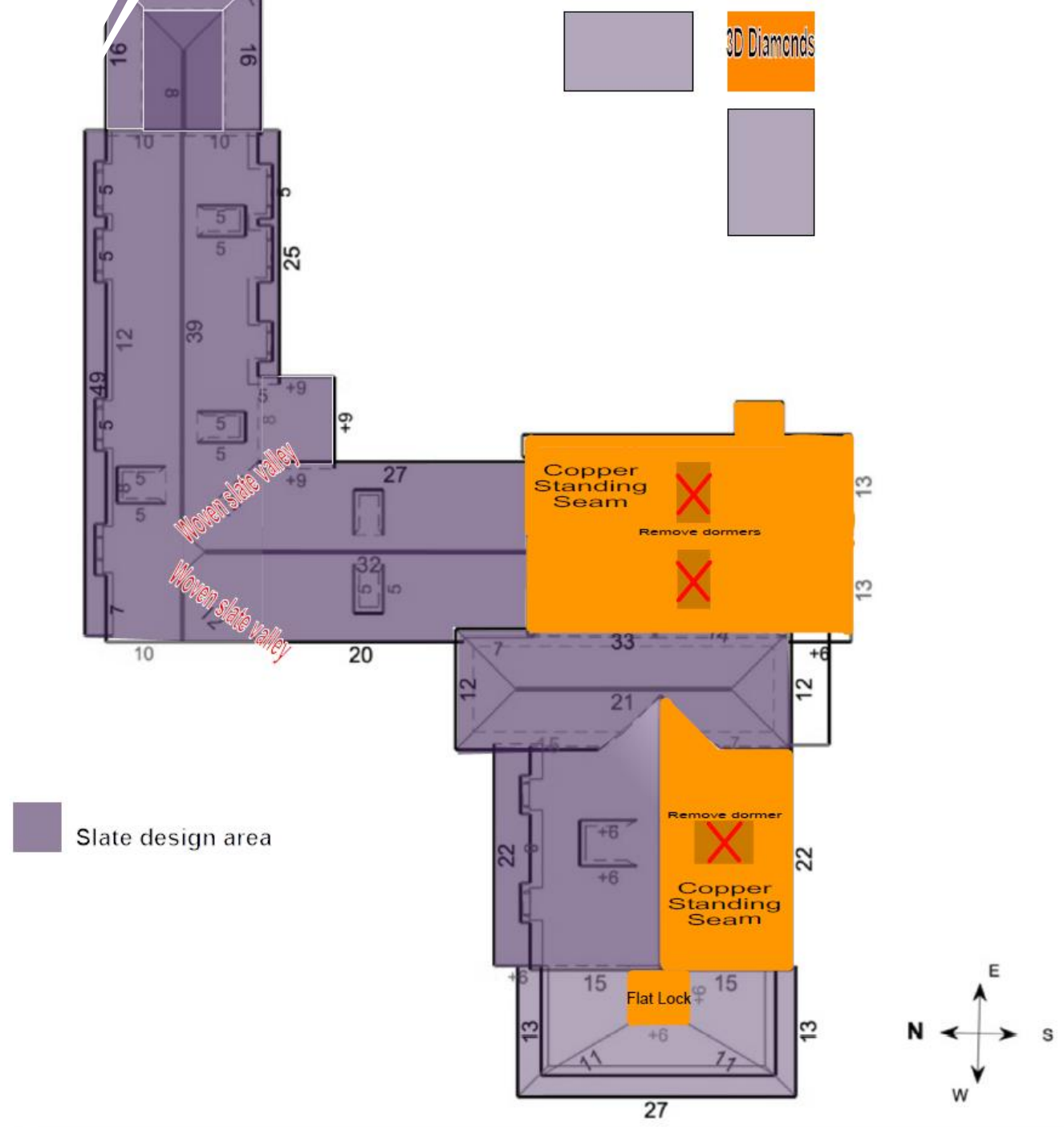

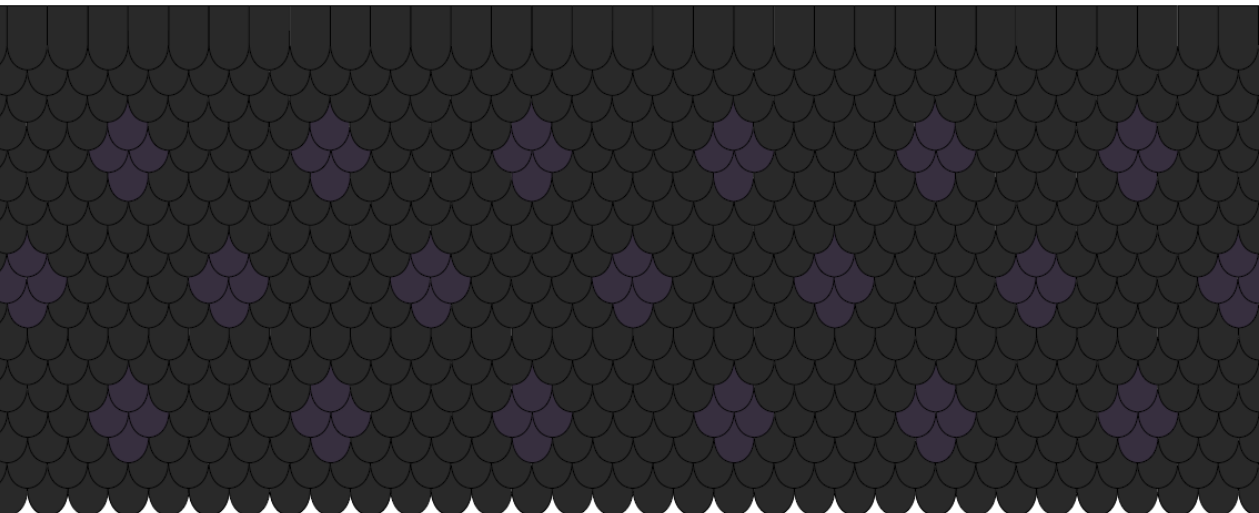
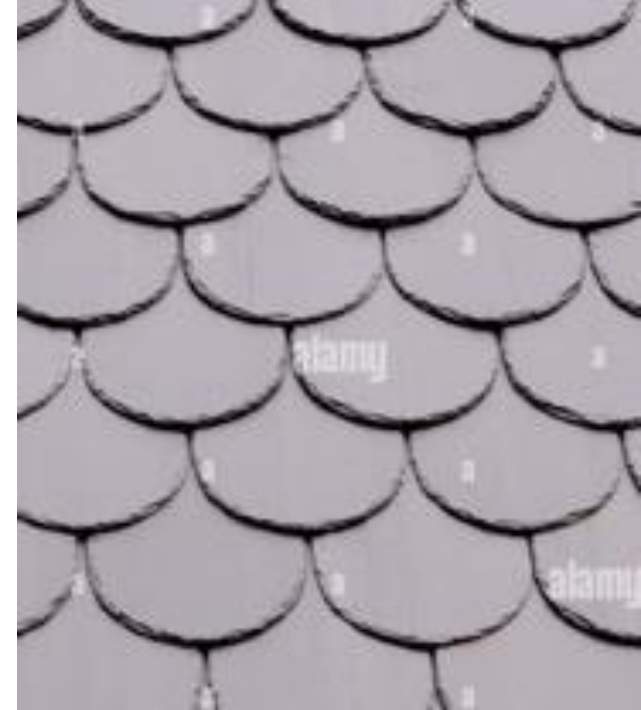
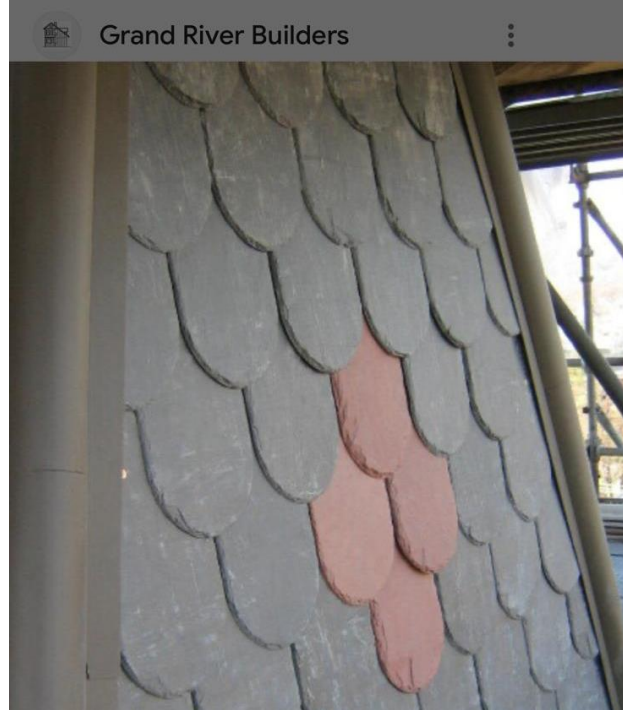

SLATE DESIGN AREA

- Custom fish scale cut , traditional European design from France.
- Subtle 4 purple slate “diamond” patter within the darker black/grey slate.
- Hard to see the contrast between the black and purple slates. (See above)
- Gives the roof sublet texture and elegance, Queen of Caligula Ave.
- All slate sourced from European quarry’s the are primary suppliers to Provence.
- Rare Purple Slate from Wales UK.



Copper Hip Detailing

- Master craftsman work to mold the copper to the contour of the slate.
- Protects against high winds to ensure wind does not get under the slate.
- Left hand side – Neighbor's house 517 Hardee with similar but not as detailed feature.
- Right hand side – Proposed stepping copper hip creating more subtle higher quality detail.



20 Oz. Copper Double Locking Standing Seam

- Back side of the 3-car garage.
- Back side of home on the master bedroom roof.
- Large areas not visible from Caligula.
- Proposed similar seaming under dormer windows barely visible from street. See front of house pictures.
- Highest quality materials available
- Master copper craftsman.

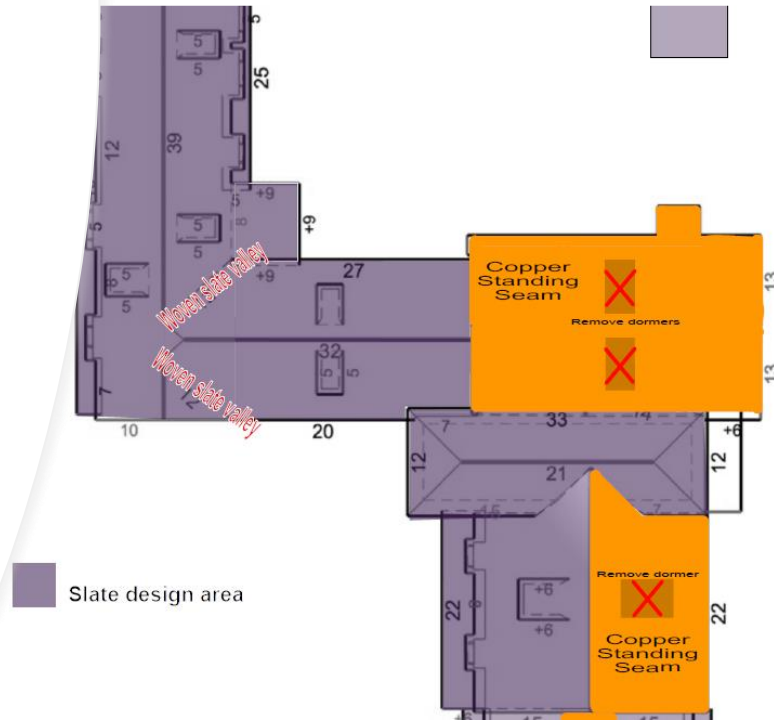

Wall Flashing

ing technique helps divert moisture that
nts. This work was done by Sbardella

ella, Sbardella Slate Inc. (SbardellaSlate.com).



Double-Lock Sweep Seams

Popular in Europe and becoming more so in the U.S., this elegant seaming system eliminates soldering and provides a permanent, water-tight seam at chimney corners and valley top junctures. See also page 322. Photos courtesy Orion Jenkins (JenkinsSlateMasters.com)

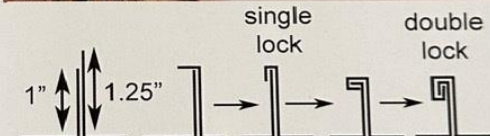

Piece 1 is cleated to roof deck.

Straight standing seam panels can be pre-bent in the shop, as shown at left. When making curved standing seams, start with simple bends as show above.

Piece 1

Piece 2

Fold piece 2 around piece 1 using hand tongs or seamers.

This is the first lock.

Hammer here to make the 2nd lock.



Double seamer backs straight seam so it can be flattened.

20 Oz Double Local Copper Standing Seam



Diamond Copper Detail

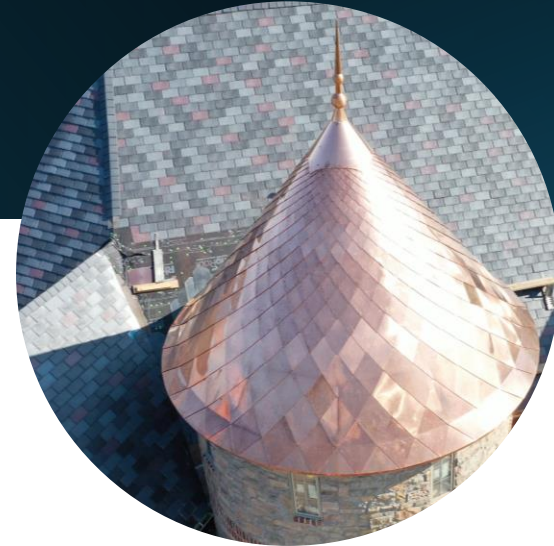
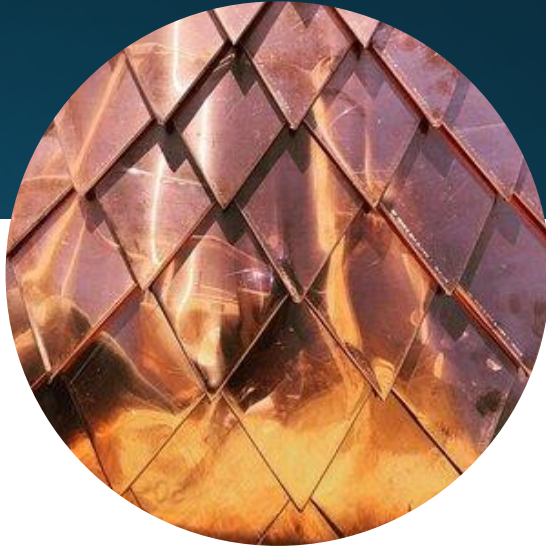

- Proposed over the small gazebo roof of the pool house.
- Not visible from Caligula.
- Not historical structure.

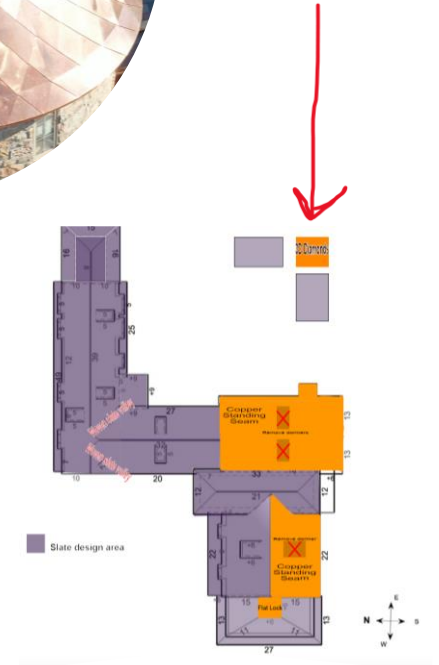



Copper Cap Around Cylindrical Chimney

Jenkins Slate Masters – Pennsylvania

Generations of Craftsmanship

Jenkins Slate Masters, Incorporated is a Slate and Copper Roof Contracting and Consulting company that focuses solely on Slate and Copper roofs, nothing else. Our family passion for the trade began back in 1968 and has progressively grown into one of the most respected companies in the industry. With a strong background in repair and restoration, Jenkins Slate Masters, Inc. has slowly shifted it's focus on custom homes with artistic details. While we are stationed in Western Pa and prefer to work in that general area, we will travel almost anywhere in the world given the right opportunity.

All pictures in this presentation from their portfolio including copper

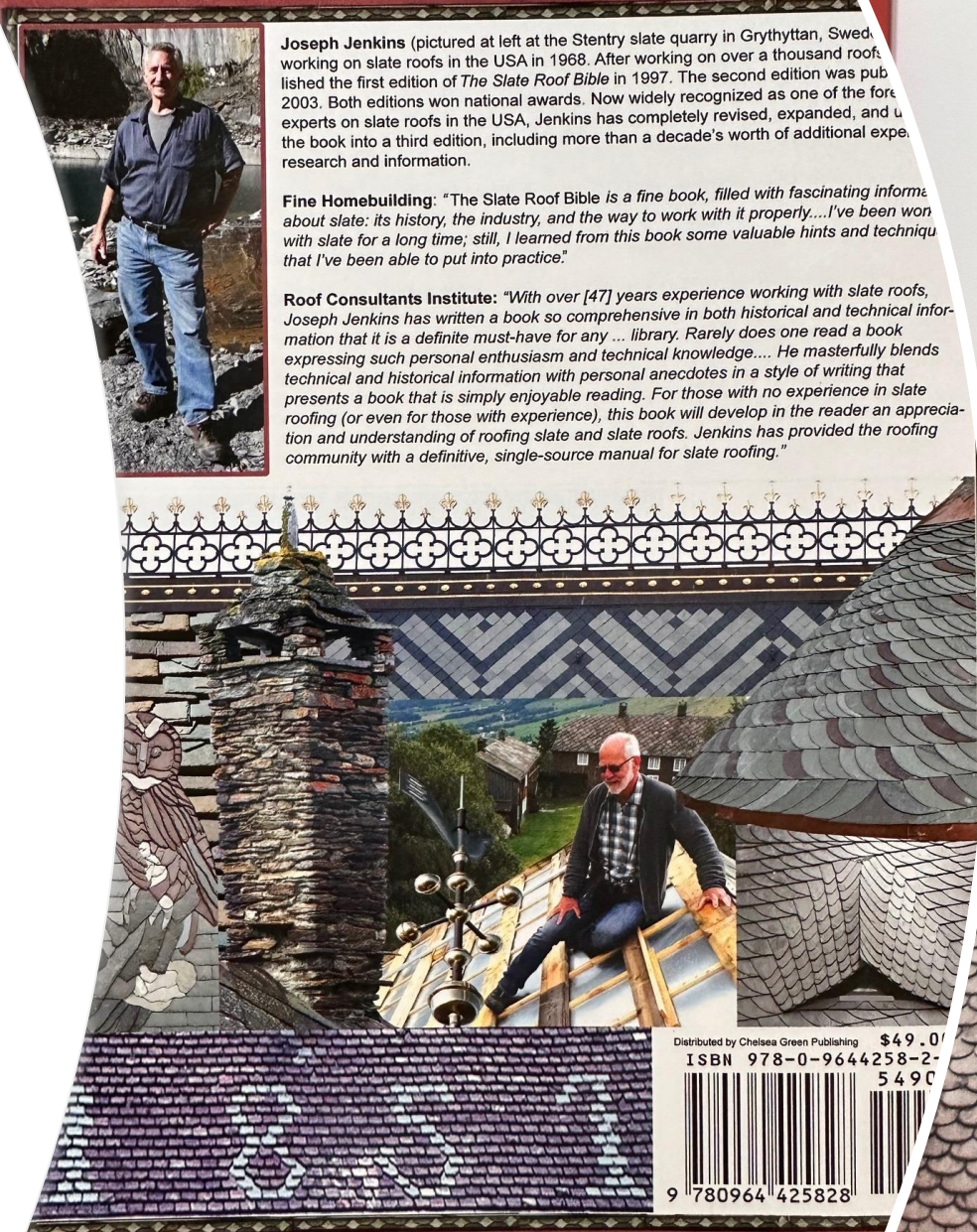

The Slate Roof Bible

Third Edition

Joseph C. Jenkins

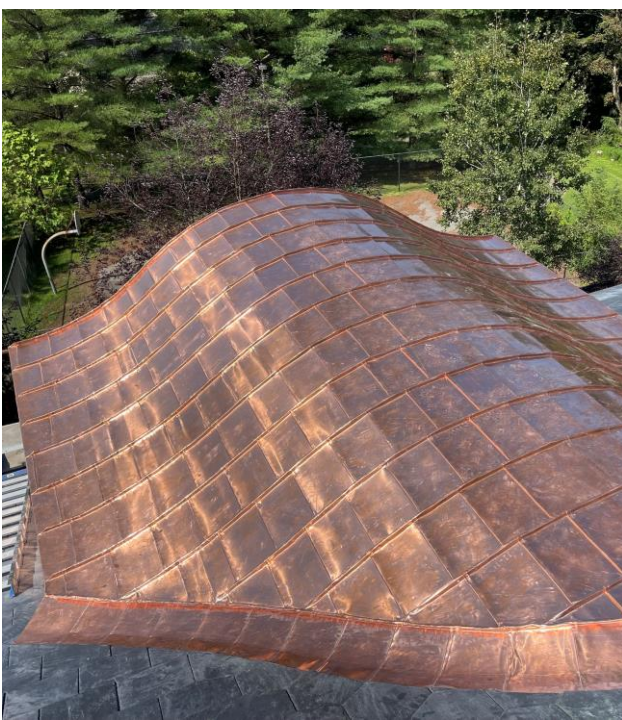
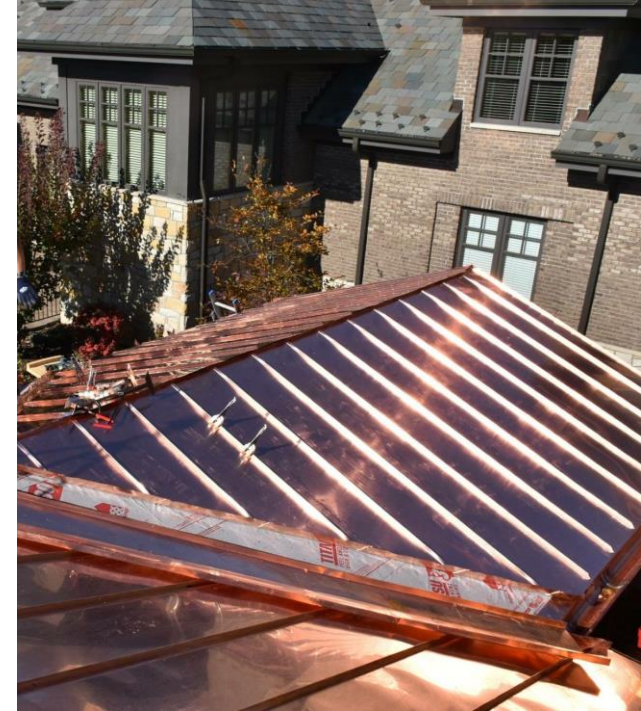
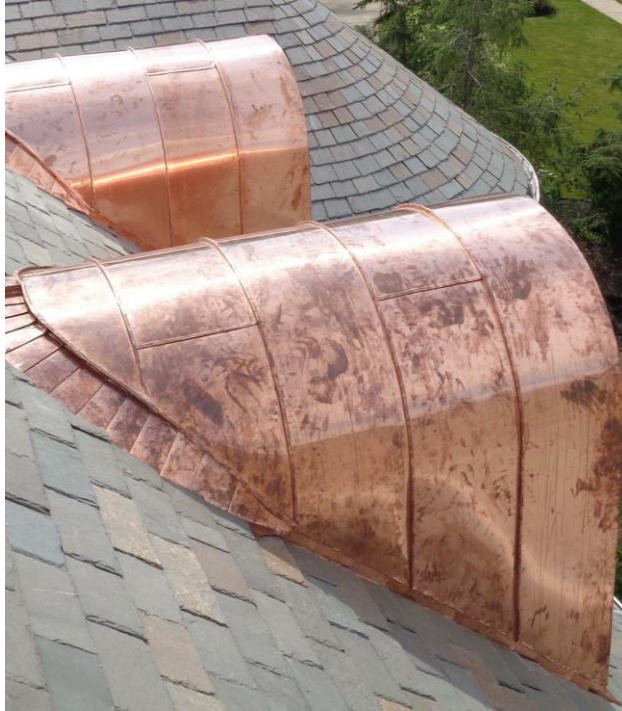

Jenkins Slate Masters

- Exceptional Copper Craftsmanship.
- Slate Master Craftsman.
- Would Travel from Pennsylvania to do this house from January – March 2025.
- No Local Florida Roofers Of Comparable Experience
- Founder Author of “The Slate Bible”. 3 Editions for Aspiring Slate Masters

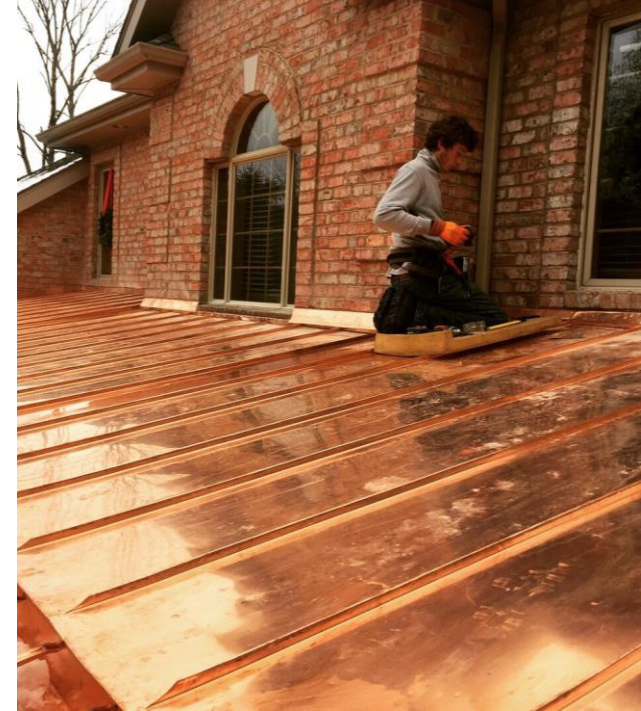
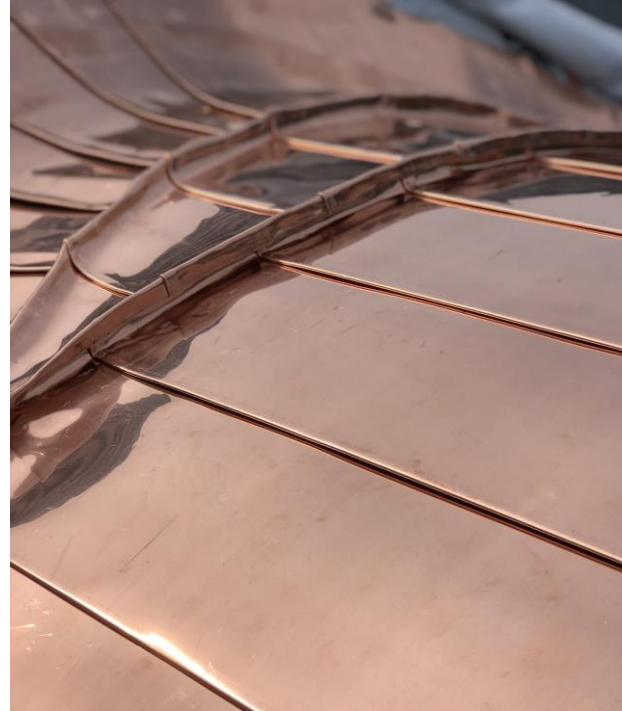
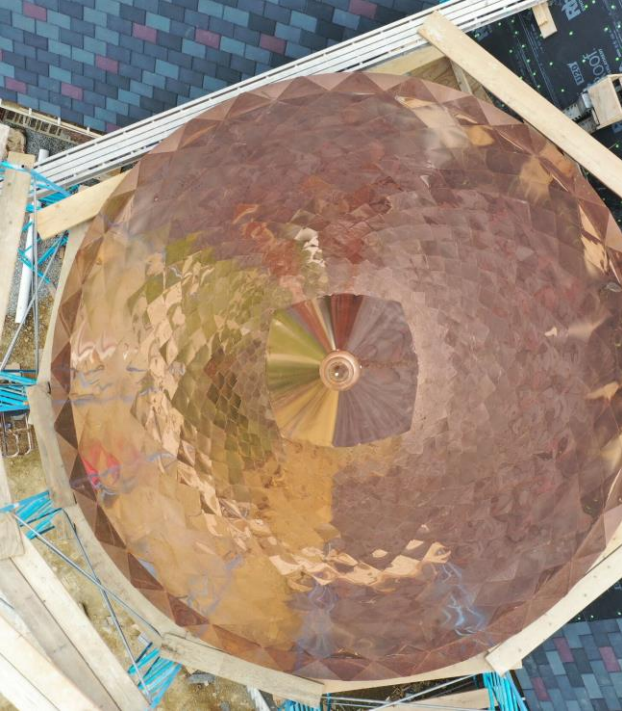

Jenkins Slate Masters

- Portfolio Pictures



Project Update

- Garage Area



Project Update

Stepped Copper Hips

Project Update

- Pool Area
- Diamond Scale Copper



Project Update

- Pool Area
- Diamond Scale Copper





Project Update



Chimney Area



Copper Cap Around Cylindrical Chimney
More low profile than this – custom made