



Planning and Zoning Board  
Giralda Preschool of Coral Gables  
May 20, 2026

# Agenda



---

**01**                      **Purpose of Request**

---

**02**                      **Project Summary**

---

**03**                      **Indoor Plan**

---

**04**                      **Site Plan**

---

**05**                      **Accreditations**

# Agenda

---



06

**Ratios**

---

07

**Traffic Flow and Arrival Distribution**

---

# Purpose of Request

---

Giralda Preschool of Coral Gables is requesting **Conditional Use Approval** to modify the current **childcare (preschool) use** to a **private school**, initially offering **Kindergarten** for Fall 2026, with the potential to expand through fifth grade in the future.

This addition does not increase the facility's approved capacity of 174, as it will serve 10 students and will be accommodated within the existing art room, requiring no physical modifications.

# Giralda Preschool of Coral Gables Project Summary

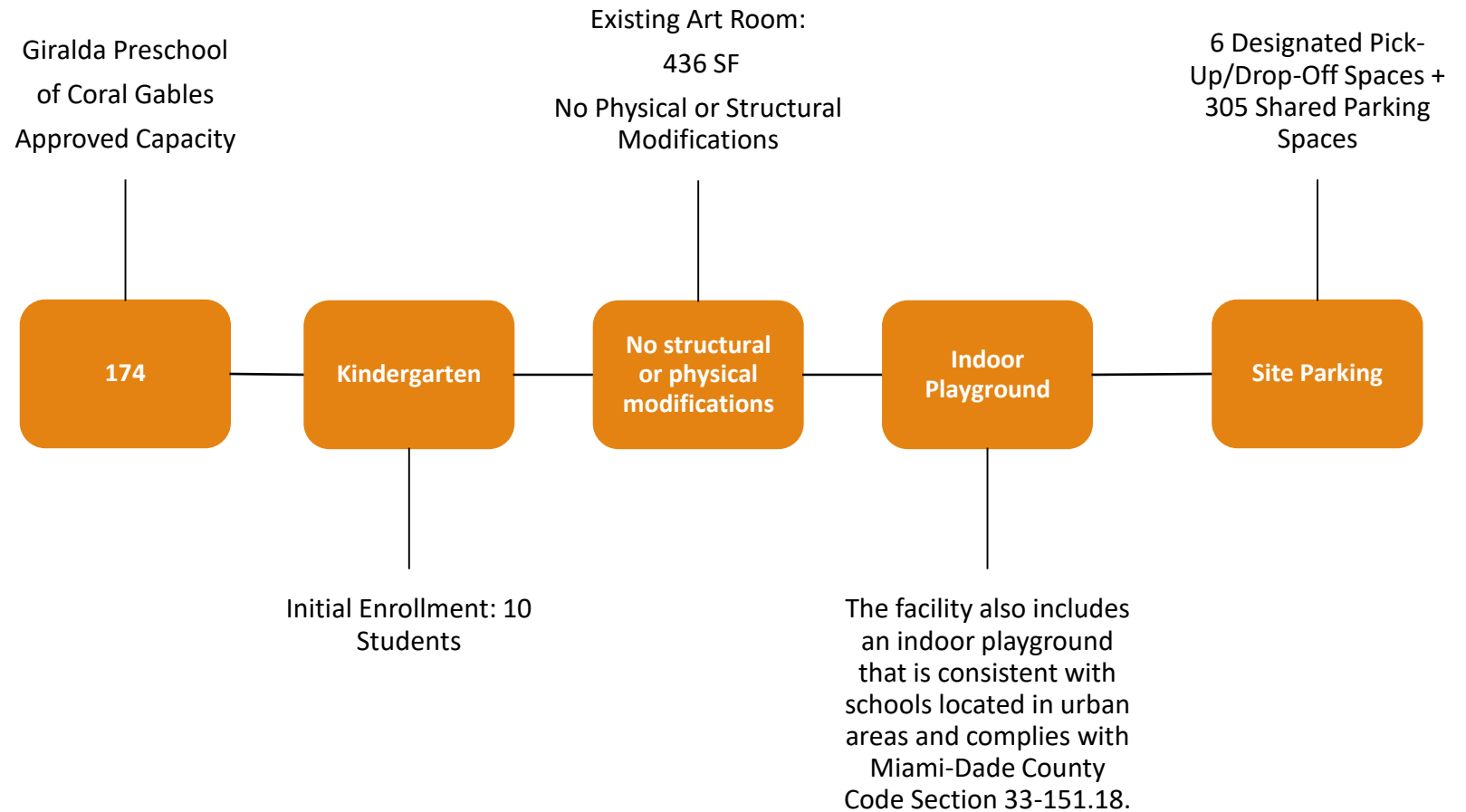



# Site Plan

## Site Plan

Designated drop-off/pick-up  
Parking with direct access to  
a sidewalk leading to the  
school.

Giralda Preschool of  
Coral Gables

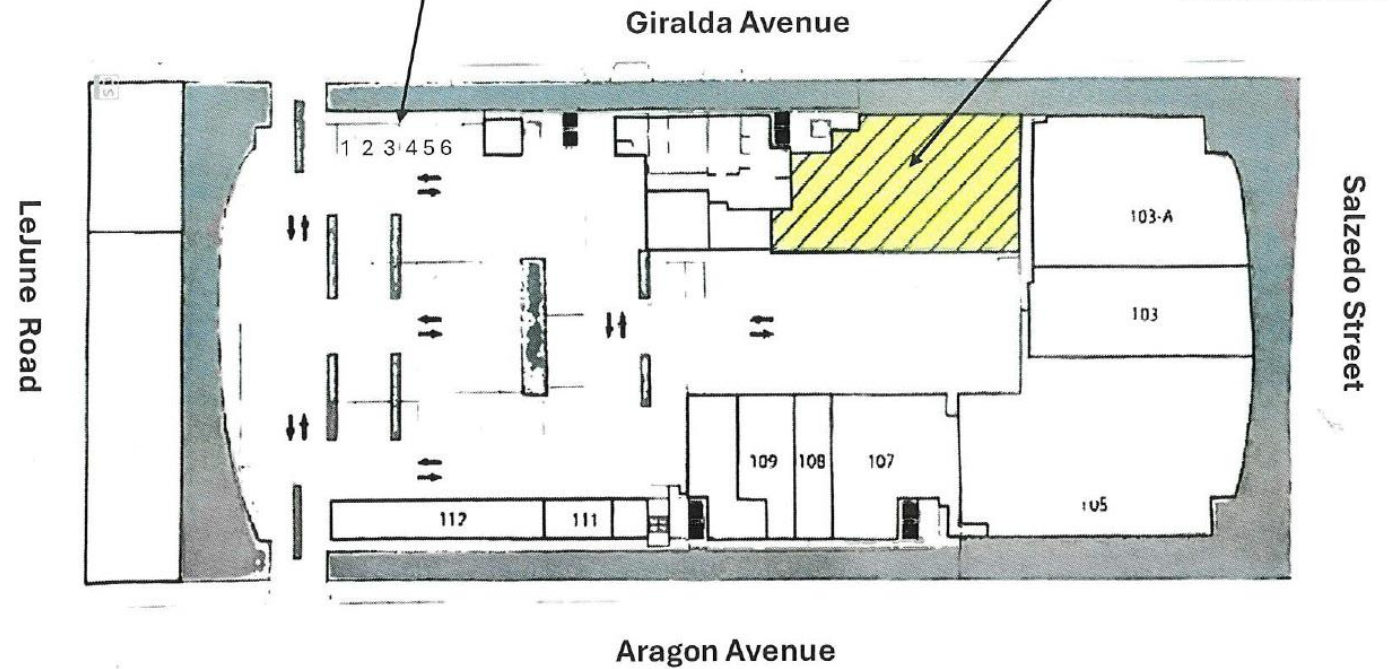

# Accreditations



Accredited Professional Preschool  
Learning Environment.  
APPLE



Gold Seal Quality Care Program  
Florida Department of Children and Families

Giralda Preschool of Coral Gables is a Gold Seal accredited school through the Florida Department of Children and Families (DCF). These accreditations require compliance with strict teacher-to-student ratios and operational standards.

# Ratios

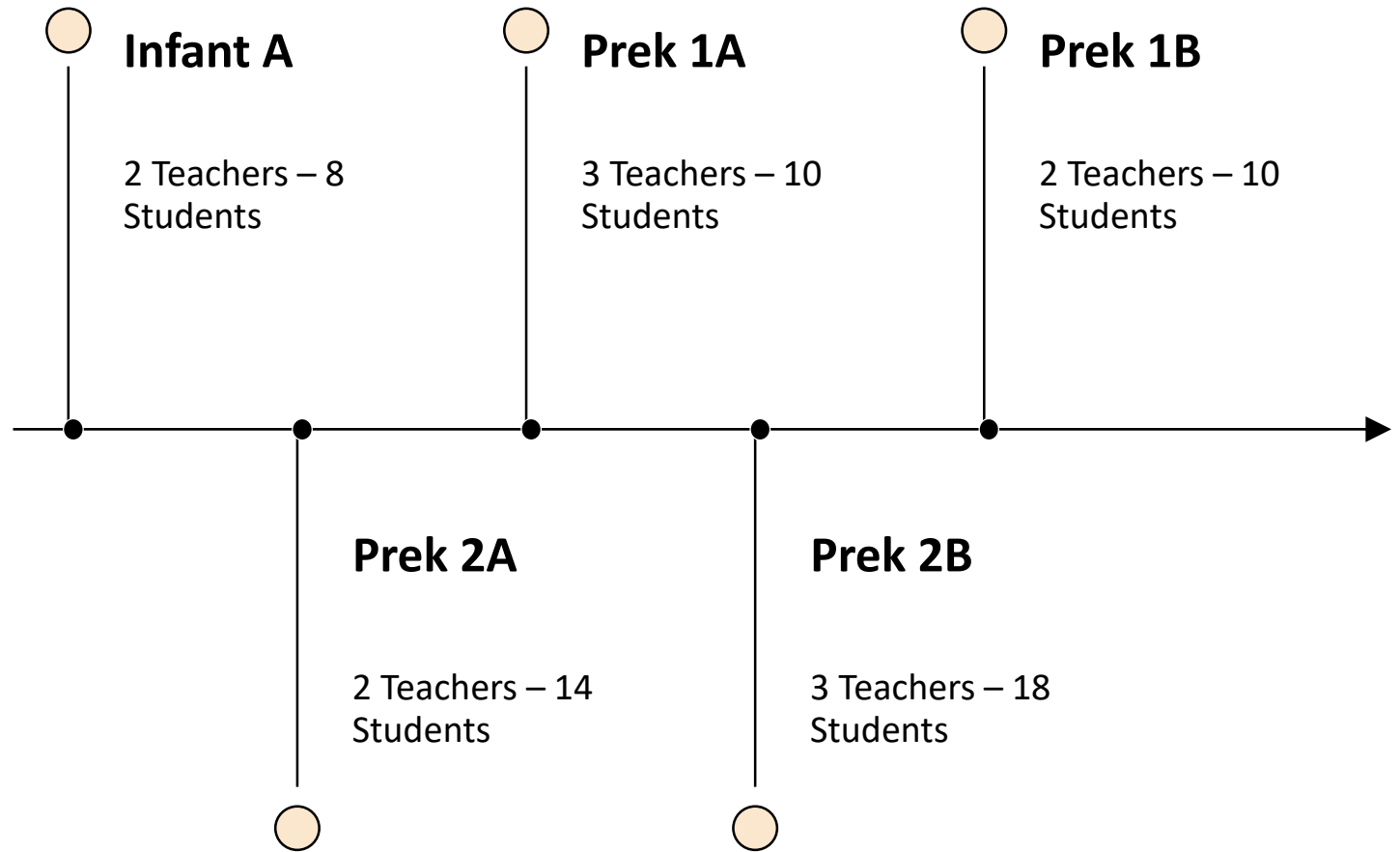

Staffing:

16 Teachers and 3  
Administrative  
Staff.

Total Students: 96

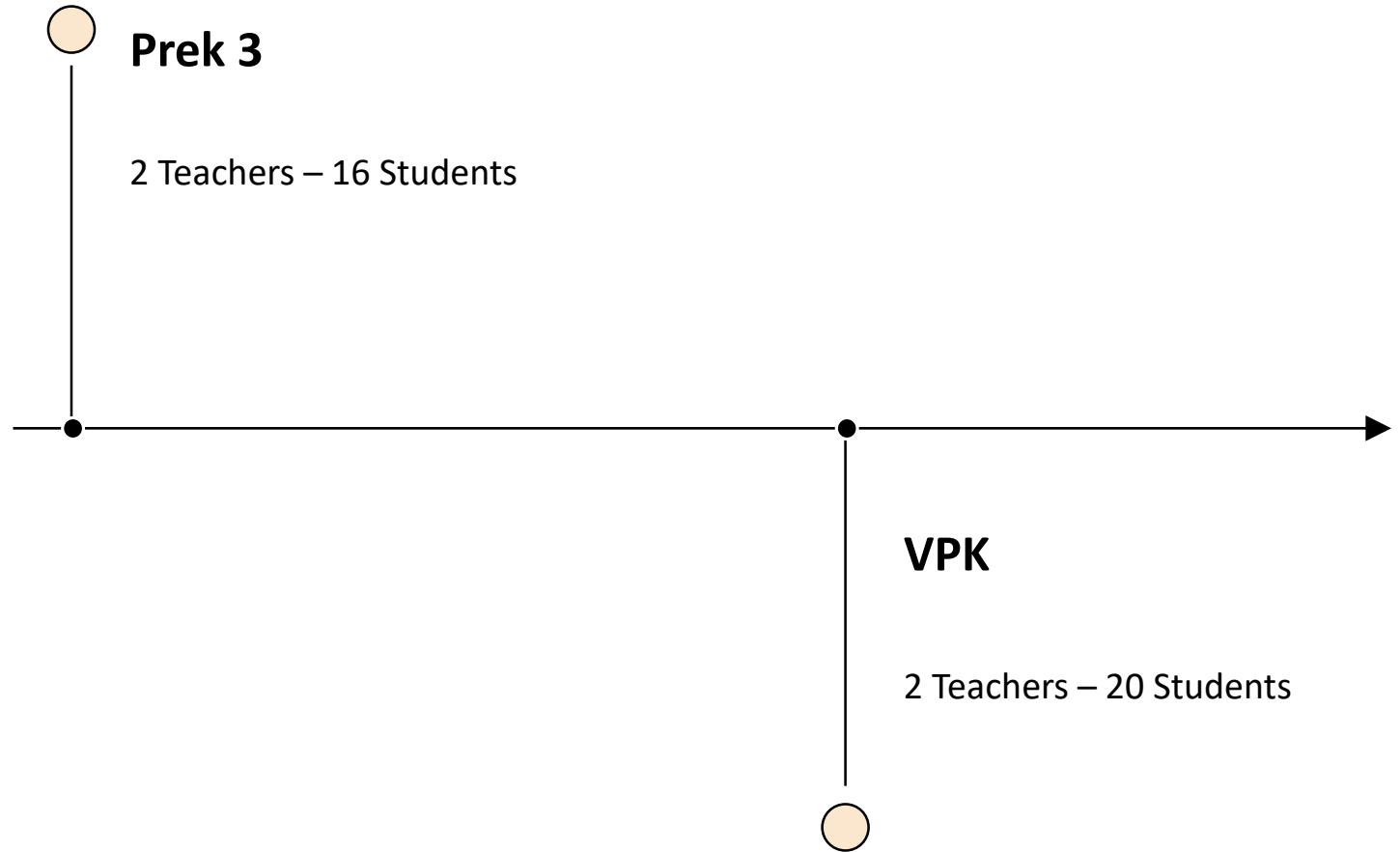

# Kindergarten Program



## **Kindergarten Classroom**

1 Teacher – 10 Students  
(2026-2027)

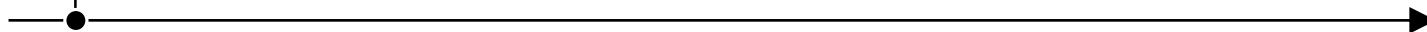

# Traffic and Arrival Flow

## Preschool Hours of Operation

- Part-Time Program: 7:30 AM – 2:30 PM
- Full-Time Program: 7:30 AM – 6:30 PM
- Most school arrivals occur gradually between 8:30 AM and 9:00 AM

## Proposed Kindergarten Program

Hours: 7:30 AM – 3:30 PM  
Kindergarten students arrive promptly at 7:30 AM

## Traffic Distribution

Because preschool and kindergarten schedules differ, student arrivals and dismissals are naturally staggered throughout the day. This separation of more than 30 minutes helps minimize congestion during peak drop-off and pick-up periods.

As a community-centered school in the heart of Coral Gables, many of our families arrive by walking, biking or using strollers.

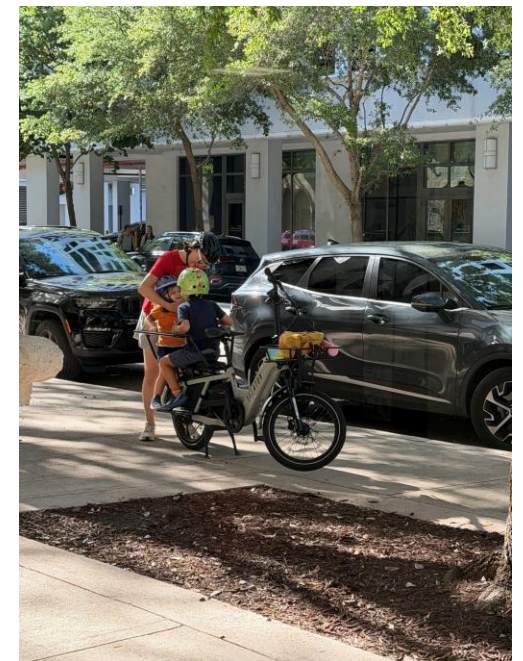

# Thank You

Giralda Preschool of Coral Gables

---

## Questions?



320 Giralda Ave.  
Coral Gables, FL 33134