

9. Landscape / Vegetation Plans

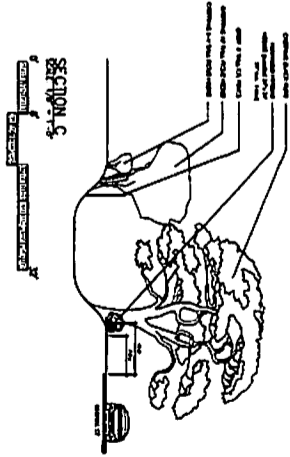
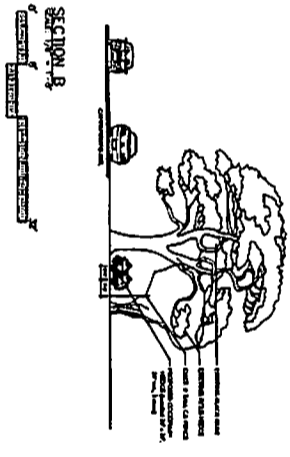
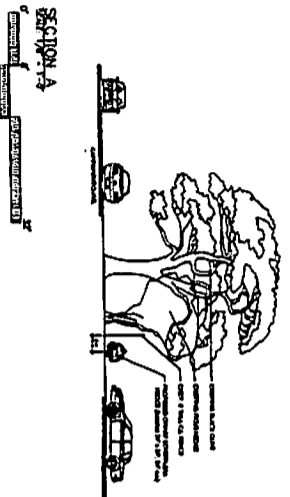
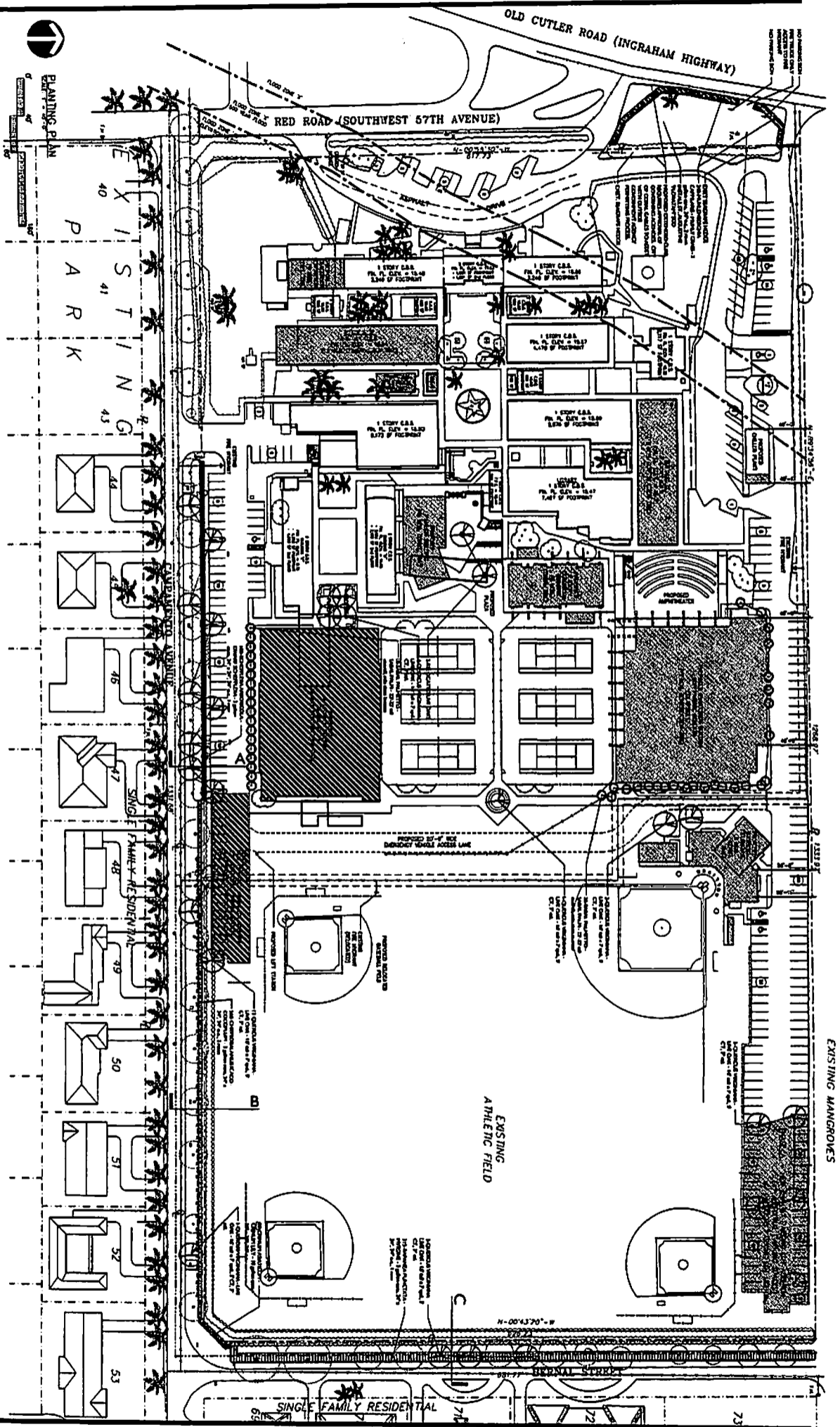

Planting Plan

GULLIVER ACADEMY

12595 Red Road

Coral Gables, FL

ROSENBERG GARDNER DESIGN
 LANDSCAPE ARCHITECTURE
 LAND PLANNING
 MEMBER SOCIETY OF LANDSCAPE ARCHITECTS

DATE	DESCRIPTION
12/15/11	FINAL PLAN
12/14/11	REVISIONS
12/13/11	REVISIONS
12/12/11	REVISIONS
12/11/11	REVISIONS
12/10/11	REVISIONS
12/9/11	REVISIONS
12/8/11	REVISIONS
12/7/11	REVISIONS
12/6/11	REVISIONS
12/5/11	REVISIONS
12/4/11	REVISIONS
12/3/11	REVISIONS
12/2/11	REVISIONS
12/1/11	REVISIONS



1.0 GENERAL NOTES:

1.1. ALL DIMENSIONS ARE TO FACE UNLESS OTHERWISE SPECIFIED.

1.2. THE CONTRACTOR SHALL VERIFY ALL DIMENSIONS AND CONDITIONS OF THE SITE PRIOR TO COMMENCEMENT OF WORK. ANY DISCREPANCIES SHALL BE REPORTED IMMEDIATELY TO THE ARCHITECT.

1.3. THE CONTRACTOR SHALL BE RESPONSIBLE FOR OBTAINING ALL NECESSARY PERMITS AND APPROVALS FROM THE APPROPRIATE AGENCIES.

1.4. ALL MATERIALS AND METHODS OF CONSTRUCTION SHALL BE IN ACCORDANCE WITH THE LATEST EDITIONS OF THE INTERNATIONAL BUILDING CODES (IBC) AND ALL APPLICABLE LOCAL CODES.

1.5. THE CONTRACTOR SHALL MAINTAIN ACCESS TO ALL ADJACENT PROPERTIES AT ALL TIMES. ANY OBSTRUCTIONS SHALL BE REMOVED IMMEDIATELY UPON NOTIFICATION.

1.6. THE CONTRACTOR SHALL BE RESPONSIBLE FOR THE PROTECTION OF ALL EXISTING UTILITIES AND STRUCTURES. ANY DAMAGE SHALL BE REPAIRED AT THE CONTRACTOR'S EXPENSE.

1.7. THE CONTRACTOR SHALL MAINTAIN A SAFE WORKING ENVIRONMENT AT ALL TIMES. ALL SAFETY PRECAUTIONS SHALL BE STRICTLY ENFORCED.

1.8. THE CONTRACTOR SHALL BE RESPONSIBLE FOR THE PROTECTION OF ALL ENVIRONMENTAL FEATURES AND RESOURCES. ANY VIOLATIONS SHALL BE REPORTED IMMEDIATELY TO THE ARCHITECT.

1.9. THE CONTRACTOR SHALL BE RESPONSIBLE FOR THE PROTECTION OF ALL HISTORIC AND CULTURAL RESOURCES. ANY DAMAGE SHALL BE REPAIRED AT THE CONTRACTOR'S EXPENSE.

1.10. THE CONTRACTOR SHALL BE RESPONSIBLE FOR THE PROTECTION OF ALL ADJACENT PROPERTIES AND THE PUBLIC. ANY DAMAGE SHALL BE REPAIRED AT THE CONTRACTOR'S EXPENSE.

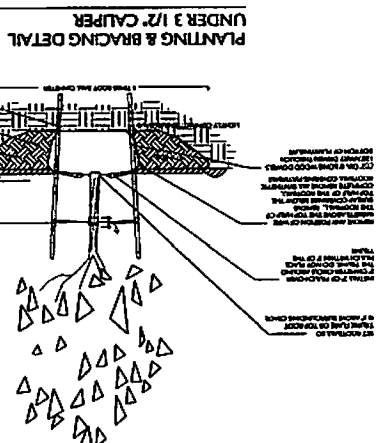

PLANTING & BRACING DETAIL UNDER 3/4" CALIPER

1. SHRUB SHALL BE INSTALLED IN THE HOLE SHOWN.

2. BRACE SHALL BE INSTALLED AS SHOWN TO SUPPORT THE SHRUB.

3. BRACE SHALL BE FASTENED TO THE BRICK WALL WITH AN ANCHOR BOLT.

4. BRACE SHALL BE FASTENED TO THE CONCRETE SLAB WITH AN ANCHOR BOLT.

5. BRACE SHALL BE FASTENED TO THE SHRUB WITH A 2X4 BRACE.

6. BRACE SHALL BE FASTENED TO THE SHRUB WITH A 2X4 BRACE.

7. BRACE SHALL BE FASTENED TO THE SHRUB WITH A 2X4 BRACE.

8. BRACE SHALL BE FASTENED TO THE SHRUB WITH A 2X4 BRACE.

9. BRACE SHALL BE FASTENED TO THE SHRUB WITH A 2X4 BRACE.

10. BRACE SHALL BE FASTENED TO THE SHRUB WITH A 2X4 BRACE.

PLANTING & BRACING DETAIL UNDER 3/4" CALIPER

1. SHRUB SHALL BE INSTALLED IN THE HOLE SHOWN.

2. BRACE SHALL BE INSTALLED AS SHOWN TO SUPPORT THE SHRUB.

3. BRACE SHALL BE FASTENED TO THE BRICK WALL WITH AN ANCHOR BOLT.

4. BRACE SHALL BE FASTENED TO THE CONCRETE SLAB WITH AN ANCHOR BOLT.

5. BRACE SHALL BE FASTENED TO THE SHRUB WITH A 2X4 BRACE.

6. BRACE SHALL BE FASTENED TO THE SHRUB WITH A 2X4 BRACE.

7. BRACE SHALL BE FASTENED TO THE SHRUB WITH A 2X4 BRACE.

8. BRACE SHALL BE FASTENED TO THE SHRUB WITH A 2X4 BRACE.

9. BRACE SHALL BE FASTENED TO THE SHRUB WITH A 2X4 BRACE.

10. BRACE SHALL BE FASTENED TO THE SHRUB WITH A 2X4 BRACE.

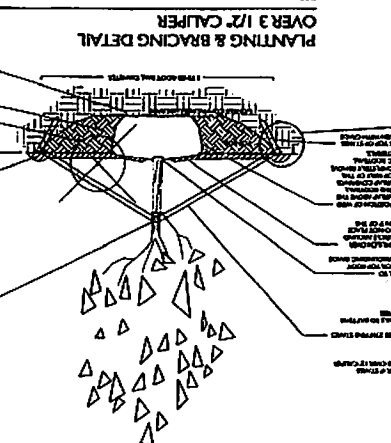

PLANTING & BRACING DETAIL OVER 3/4" CALIPER

1. SHRUB SHALL BE INSTALLED IN THE HOLE SHOWN.

2. BRACE SHALL BE INSTALLED AS SHOWN TO SUPPORT THE SHRUB.

3. BRACE SHALL BE FASTENED TO THE BRICK WALL WITH AN ANCHOR BOLT.

4. BRACE SHALL BE FASTENED TO THE CONCRETE SLAB WITH AN ANCHOR BOLT.

5. BRACE SHALL BE FASTENED TO THE SHRUB WITH A 2X4 BRACE.

6. BRACE SHALL BE FASTENED TO THE SHRUB WITH A 2X4 BRACE.

7. BRACE SHALL BE FASTENED TO THE SHRUB WITH A 2X4 BRACE.

8. BRACE SHALL BE FASTENED TO THE SHRUB WITH A 2X4 BRACE.

9. BRACE SHALL BE FASTENED TO THE SHRUB WITH A 2X4 BRACE.

10. BRACE SHALL BE FASTENED TO THE SHRUB WITH A 2X4 BRACE.

PLANTING & BRACING DETAIL OVER 3/4" CALIPER

1. SHRUB SHALL BE INSTALLED IN THE HOLE SHOWN.

2. BRACE SHALL BE INSTALLED AS SHOWN TO SUPPORT THE SHRUB.

3. BRACE SHALL BE FASTENED TO THE BRICK WALL WITH AN ANCHOR BOLT.

4. BRACE SHALL BE FASTENED TO THE CONCRETE SLAB WITH AN ANCHOR BOLT.

5. BRACE SHALL BE FASTENED TO THE SHRUB WITH A 2X4 BRACE.

6. BRACE SHALL BE FASTENED TO THE SHRUB WITH A 2X4 BRACE.

7. BRACE SHALL BE FASTENED TO THE SHRUB WITH A 2X4 BRACE.

8. BRACE SHALL BE FASTENED TO THE SHRUB WITH A 2X4 BRACE.

9. BRACE SHALL BE FASTENED TO THE SHRUB WITH A 2X4 BRACE.

10. BRACE SHALL BE FASTENED TO THE SHRUB WITH A 2X4 BRACE.

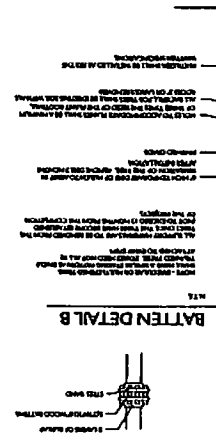

BATTEN DETAIL B

1. BATTEN SHALL BE INSTALLED AS SHOWN.

2. BATTEN SHALL BE FASTENED TO THE BRICK WALL WITH AN ANCHOR BOLT.

3. BATTEN SHALL BE FASTENED TO THE CONCRETE SLAB WITH AN ANCHOR BOLT.

4. BATTEN SHALL BE FASTENED TO THE BRICK WALL WITH AN ANCHOR BOLT.

5. BATTEN SHALL BE FASTENED TO THE CONCRETE SLAB WITH AN ANCHOR BOLT.

BATTEN DETAIL B

1. BATTEN SHALL BE INSTALLED AS SHOWN.

2. BATTEN SHALL BE FASTENED TO THE BRICK WALL WITH AN ANCHOR BOLT.

3. BATTEN SHALL BE FASTENED TO THE CONCRETE SLAB WITH AN ANCHOR BOLT.

4. BATTEN SHALL BE FASTENED TO THE BRICK WALL WITH AN ANCHOR BOLT.

5. BATTEN SHALL BE FASTENED TO THE CONCRETE SLAB WITH AN ANCHOR BOLT.

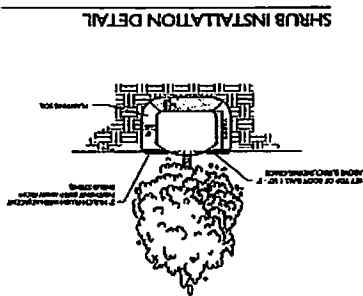

SHRUB INSTALLATION DETAIL

1. SHRUB SHALL BE INSTALLED IN THE HOLE SHOWN.

2. BRACE SHALL BE INSTALLED AS SHOWN TO SUPPORT THE SHRUB.

3. BRACE SHALL BE FASTENED TO THE BRICK WALL WITH AN ANCHOR BOLT.

4. BRACE SHALL BE FASTENED TO THE CONCRETE SLAB WITH AN ANCHOR BOLT.

5. BRACE SHALL BE FASTENED TO THE SHRUB WITH A 2X4 BRACE.

6. BRACE SHALL BE FASTENED TO THE SHRUB WITH A 2X4 BRACE.

7. BRACE SHALL BE FASTENED TO THE SHRUB WITH A 2X4 BRACE.

8. BRACE SHALL BE FASTENED TO THE SHRUB WITH A 2X4 BRACE.

9. BRACE SHALL BE FASTENED TO THE SHRUB WITH A 2X4 BRACE.

10. BRACE SHALL BE FASTENED TO THE SHRUB WITH A 2X4 BRACE.

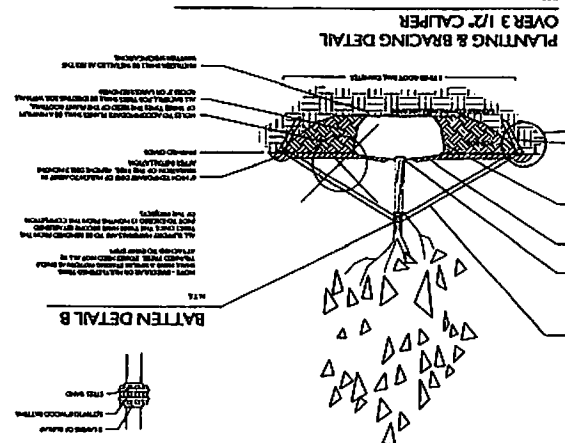

SHRUB SPACING DIAGRAM

1. SHRUBS SHALL BE SPACED AS SHOWN.

2. SHRUBS SHALL BE FASTENED TO THE BRICK WALL WITH AN ANCHOR BOLT.

3. SHRUBS SHALL BE FASTENED TO THE CONCRETE SLAB WITH AN ANCHOR BOLT.

4. SHRUBS SHALL BE FASTENED TO THE BRICK WALL WITH AN ANCHOR BOLT.

5. SHRUBS SHALL BE FASTENED TO THE CONCRETE SLAB WITH AN ANCHOR BOLT.

SHRUB SPACING DIAGRAM

1. SHRUBS SHALL BE SPACED AS SHOWN.

2. SHRUBS SHALL BE FASTENED TO THE BRICK WALL WITH AN ANCHOR BOLT.

3. SHRUBS SHALL BE FASTENED TO THE CONCRETE SLAB WITH AN ANCHOR BOLT.

4. SHRUBS SHALL BE FASTENED TO THE BRICK WALL WITH AN ANCHOR BOLT.

5. SHRUBS SHALL BE FASTENED TO THE CONCRETE SLAB WITH AN ANCHOR BOLT.

DATE	
NO.	
BY	
CHECKED	
APPROVED	
SCALE	

Landscaping Specifications
and Part List

GULLIVER ACADEMY
12355 Blvd Road
Coral Gables, FL

ROSENBERG GARDNER DESIGN
LANDSCAPE ARCHITECTURE
1234567890
1234567890
1234567890
1234567890

MASTERPLAN REVISION FOR GULLIVER ACADEMY DMC SUBMITTAL
 1825 RED ROAD, CORAL GABLES, FLORIDA 33134

GILL-MCGRAW ARCHITECTS, L.L.P.
 4940 SOUTHWEST 78TH AVENUE, SUITE 400, MIAMI, FLORIDA 33150
 TEL: 305.441.9100 FAX: 305.441.9101
 LICENSE NUMBER: A00004263

DATE: 10/22/10
 REVISIONS:
 DWG. NO.:
 (CUSTOMER)

SCALE:
 1" = 100'-0"

CONSULTANT

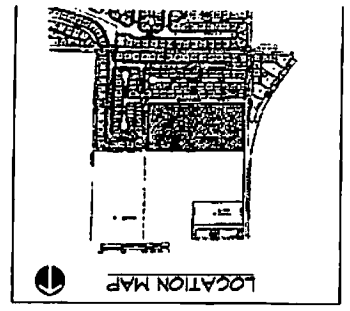

EXISTING TREE LOCATION PLAN (TRANSPOSED FROM SURVEY)
 1" = 100'-0"

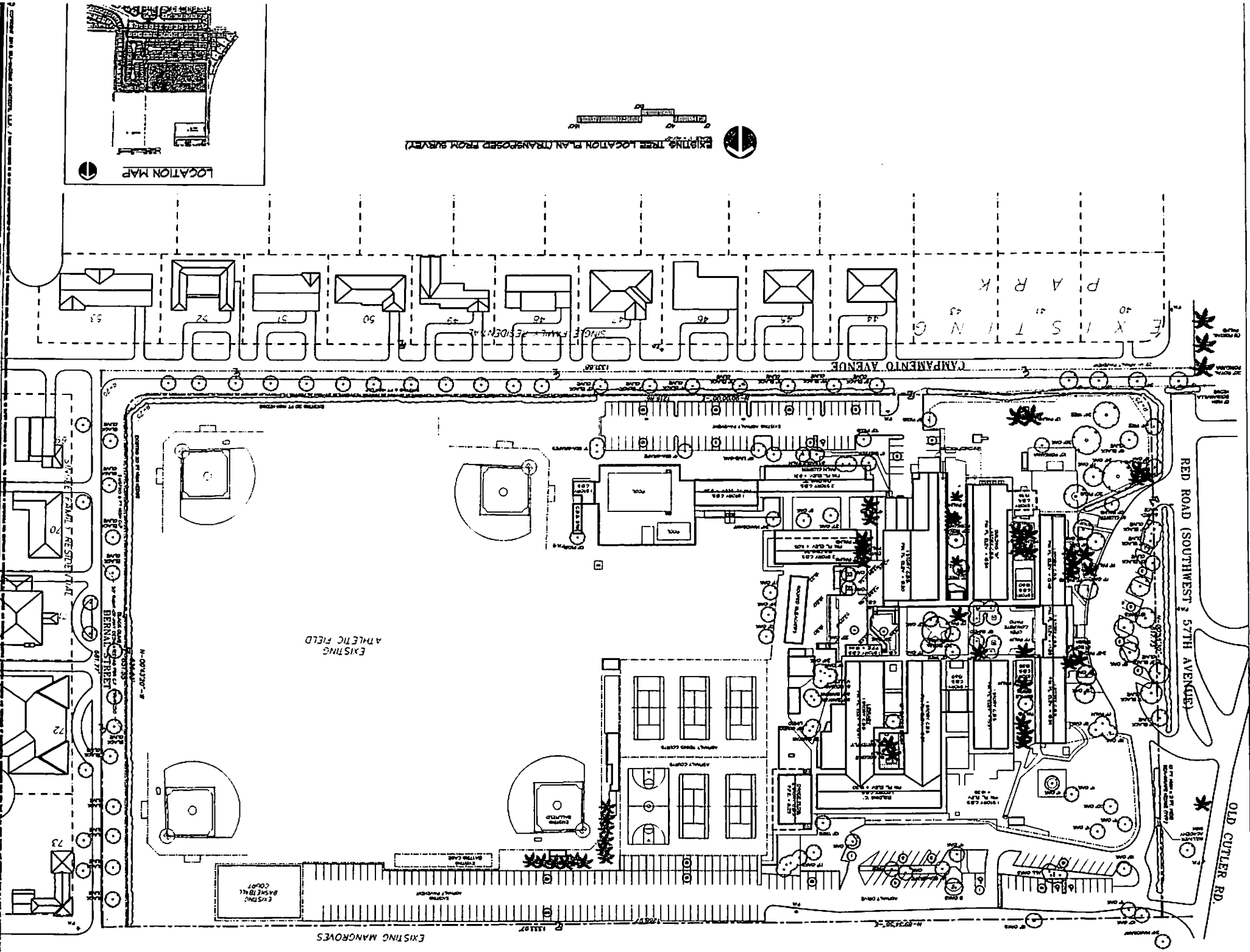

SINGLE FAMILY RESIDENTIAL

OLD CUTLER ROAD (INGRAHAM HIGHWAY)

S.W. 57th AVE.

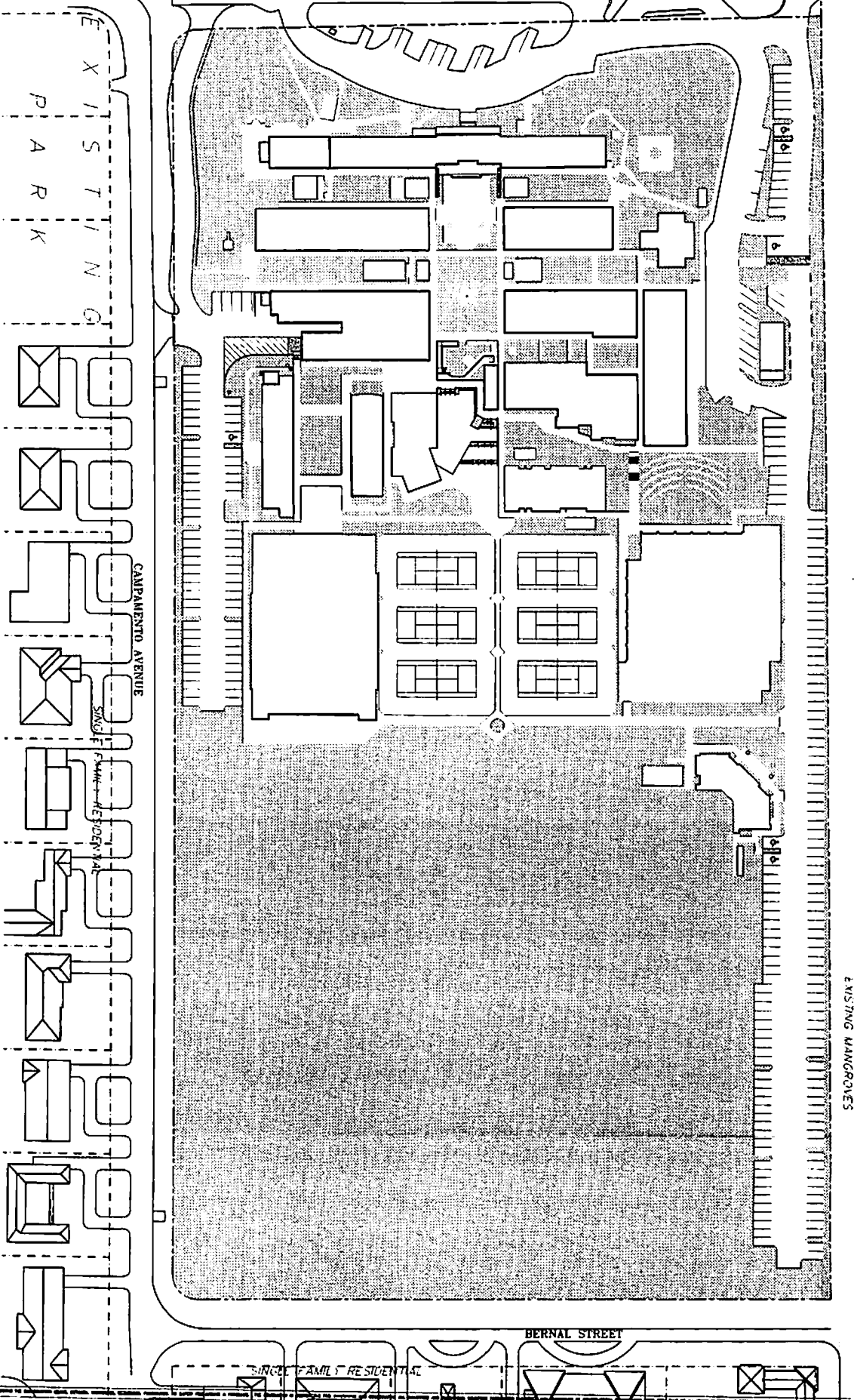

LANDSCAPE OPEN SPACE PLAN



EXISTING PLANTING AREAS OF THE SITE
PROPOSED PLANTING AREAS OF THE SITE

UPDATED TABLE OF CALCULATIONS

ZONE USE:	R-1 - RESIDENTIAL, SINGLE-USE REGULATORY FACILITY	AREA OF SITE (ACRES):	38.1
EXISTING BUILDING AREA:	0	AREA OF SITE (ACRES):	38.1
PROPOSED BUILDING AREA:	100,000 SQ. FT. (7.27 ACRES)	AREA OF SITE (ACRES):	38.1
PROPOSED LOT COVERAGES:	38.1	AREA OF SITE (ACRES):	38.1
PROPOSED LOT COVERAGES (MAXIMUM PERMITTED ONLY):	38.1	AREA OF SITE (ACRES):	38.1
TOTAL LOT COVERAGES ALLOWED:	38.1	AREA OF SITE (ACRES):	38.1
TOTAL LOT COVERAGES EXISTING:	0	AREA OF SITE (ACRES):	38.1
TOTAL LOT COVERAGES PROPOSED:	38.1	AREA OF SITE (ACRES):	38.1
TOTAL LOT COVERAGES EXISTING + PROPOSED:	38.1	AREA OF SITE (ACRES):	38.1
TOTAL LOT COVERAGES ALLOWED:	38.1	AREA OF SITE (ACRES):	38.1
TOTAL LOT COVERAGES EXISTING + PROPOSED:	38.1	AREA OF SITE (ACRES):	38.1

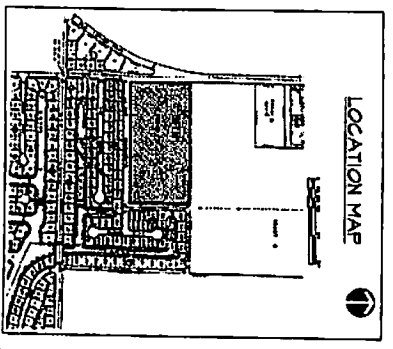

DATE: 11/18/11
SCALE: AS SHOWN
DRAWN BY: [Name]
CHECKED BY: [Name]
PROJECT: LOS



MASTERPLAN REVISION FOR GULLIVER ACADEMY DRC SUBMITTAL
18525 RED ROAD
CORAL GABLES, FLORIDA 33154



GILI-McGRAW ARCHITECTS, L.L.P.
4900 SOUTHWEST 72ND AVENUE, SUITE 405, MIAMI, FLORIDA 33186
TEL. 305.663.1265 FAX 305.663.1264
LICENSE NUMBER: AA0000488

CONTRACT NO.

SINGLE FAMILY RESIDENTIAL

OLD CUTLER ROAD (INGRAHAM HIGHWAY)

S.W. 57th AVE.

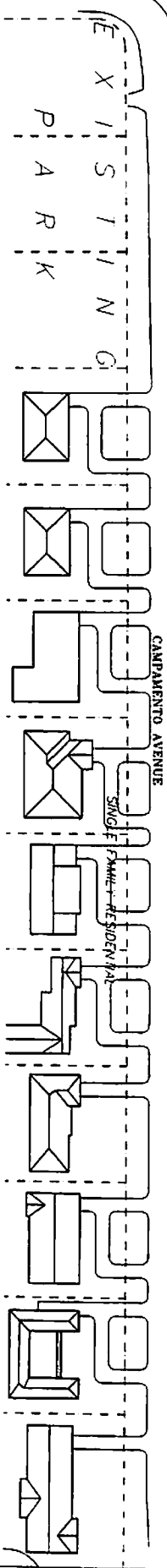

EXISTING MANROOSES



SUPERNOUS & PLAZAS PLAN (PROPOSED & EXISTING)



UPDATED TABLE OF CALCULATIONS

EXISTING LOT: 12,000 S.F. (RECREATIONAL SPECIAL USE REGULATORY FACILITY)

EXISTING BUILDING: 1,000 S.F. (RECREATIONAL SPECIAL USE REGULATORY FACILITY)

PROPOSED NEW BUILDING: 6,517 S.F. (RECREATIONAL SPECIAL USE REGULATORY FACILITY)

TABLE OF CALCULATIONS

DESCRIPTION	AREA (S.F.)	PERCENTAGE OF LOT
TOTAL LOT COVERAGE ALLOWED	20%	2400 S.F.
TOTAL LOT COVERAGE EXISTING	1%	120 S.F.
TOTAL LOT COVERAGE PROPOSED	21%	2537 S.F.
TOTAL LOT COVERAGE	22%	2657 S.F.
TOTAL LOT COVERAGE REMAINING	-1%	-120 S.F.
TOTAL ULTIMATE LOT COVERAGE	21%	2537 S.F.
TOTAL ULTIMATE LOT COVERAGE ALLOWED	20%	2400 S.F.
TOTAL ULTIMATE LOT COVERAGE EXCESS	1%	137 S.F.

TABLE OF CALCULATIONS - CONT.

DESCRIPTION	AREA (S.F.)	PERCENTAGE OF LOT
EXISTING BUILDING 6,517 S.F.	54%	65804 S.F.
PROPOSED NEW BUILDING 6,517 S.F.	54%	78204 S.F.
TOTAL ULTIMATE FLOOR AREA	108%	129008 S.F.
E.A.E. - (MAX. PERM) TOTAL FLOOR AREA OF BUILDINGS / AREA OF SITE	108%	129008 S.F.
MAXIMUM PERMITTED	100%	120000 S.F.
EXCESS	8%	9008 S.F.
EXCESS PERCENTAGE	8%	75%

UNDESIGNED REMAINING AREA: 6,483 S.F. (RECREATIONAL SPECIAL USE REGULATORY FACILITY)

EXISTING LOT COVERAGE: 1% (120 S.F.)

PROPOSED LOT COVERAGE: 21% (2537 S.F.)

TOTAL LOT COVERAGE: 22% (2657 S.F.)

TOTAL ULTIMATE FLOOR AREA: 108% (129008 S.F.)

MAXIMUM PERMITTED: 100% (120000 S.F.)

EXCESS: 8% (9008 S.F.)

EXCESS PERCENTAGE: 8% (75%)

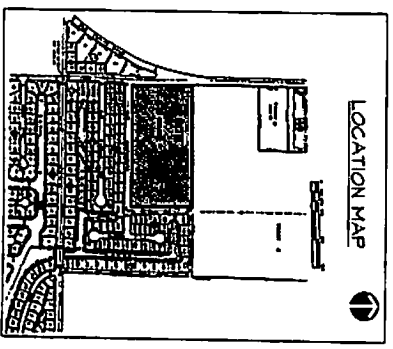

© COPYRIGHT 2013 GILI-McGRAW ARCHITECTS, L.L.P. / ALL RIGHTS RESERVED. NO PART OF THIS DOCUMENT MAY BE REPRODUCED OR TRANSMITTED IN ANY FORM OR BY ANY MEANS, ELECTRONIC OR MECHANICAL, INCLUDING PHOTOCOPYING, RECORDING, OR BY ANY INFORMATION STORAGE AND RETRIEVAL SYSTEM, WITHOUT PERMISSION IN WRITING FROM GILI-McGRAW ARCHITECTS, L.L.P.

	<p>MASTERPLAN REVISION FOR GULLIVER ACADEMY DRC SUBMITTAL</p> <p>12595 RED ROAD CORAL GABLES, FLORIDA 33150</p>		<p>GILI-McGRAW ARCHITECTS, L.L.P.</p> <p>4960 SOUTHWEST 72ND AVENUE, SUITE 403, MIAMI, FLORIDA 33163 TEL 305.663.1203 FAX 305.663.1204 LICENSE NUMBER: AAP0004482</p>	<p>CONSULTANT</p>
	<p>DATE: 10.20.2010</p> <p>REVISIONS:</p> <p>SWP</p>			



1	DATE	
2	BY	
3	SCALE	
4	PROJECT	
5	CLIENT	
6	LOCATION	
7	DESCRIPTION	

Existing Tree

GULLIVER ACADEMY

ROSENBERG GARDNER DESIGN LAND ARCHITECTURE



NO.	DESCRIPTION	TYPE
1
2
3
4
5
6
7
8
9
10
11
12
13
14
15
16
17
18
19
20
21
22
23
24
25
26
27
28
29
30
31
32
33
34
35
36
37
38
39
40
41
42
43
44
45
46
47
48
49
50
51
52
53

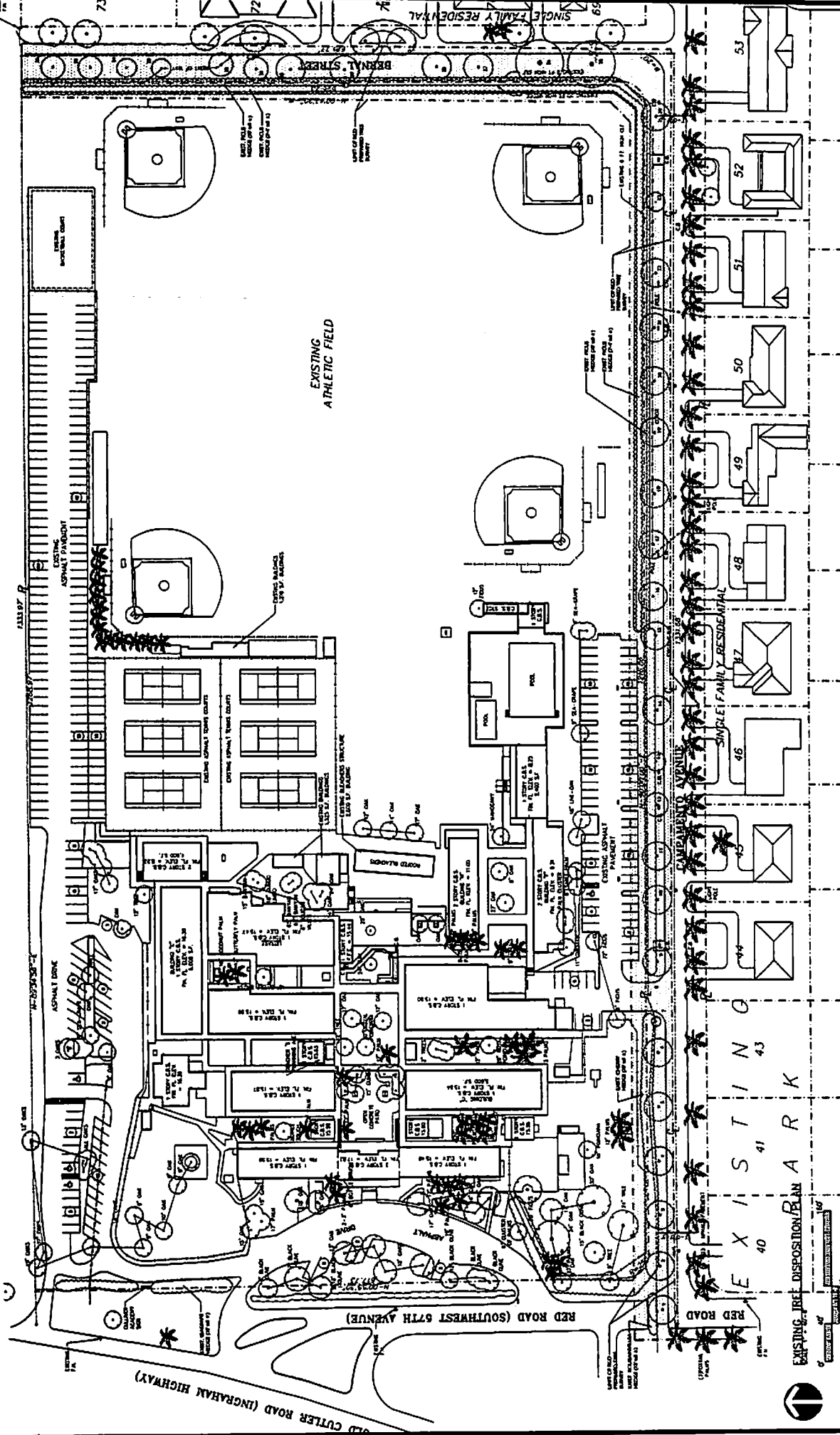

EXISTING TREE DISPOSITION PLAN

