

Le Jeune and Bird Rd Traffic Data

March 12, 2024

CORAL
GABLES[®]
THE CITY BEAUTIFUL



TRAFFIC VOLUMES



- BIRD ROAD AND LE JEUNE RD ARE PRINCIPAL ARTERIAL STATE ROADWAYS
- BIRD ROAD IS A LEGISLATIVELY DESIGNATED STATE HISTORIC HIGHWAY

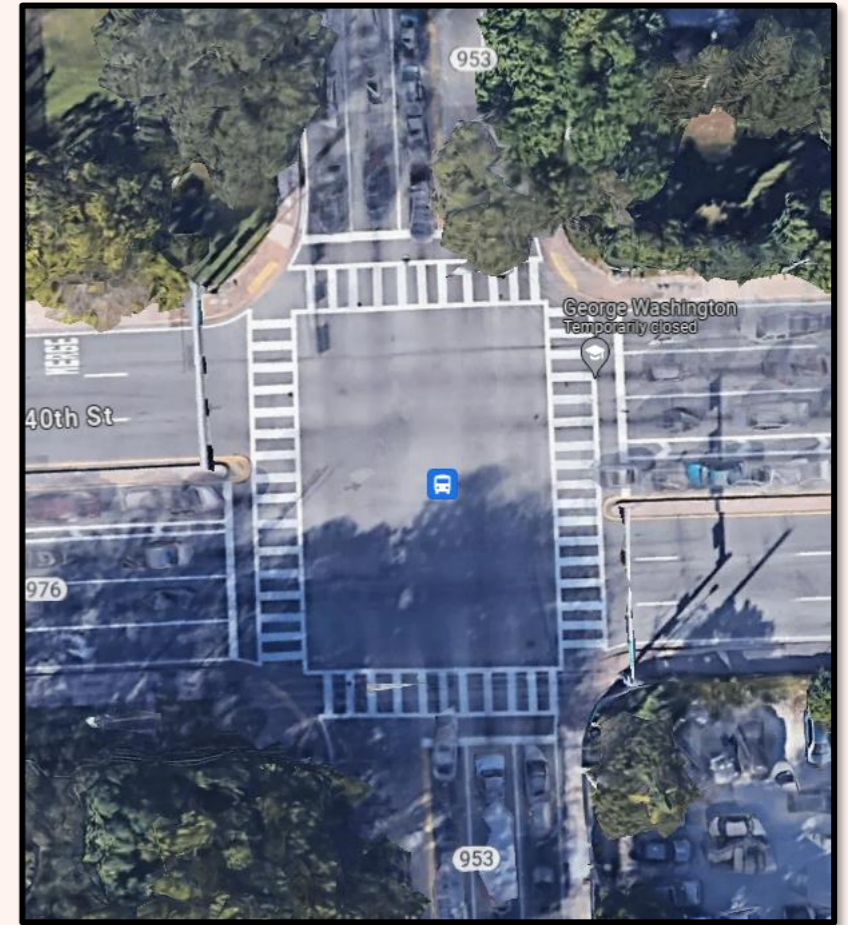

Roadway	2022			2021		
	EB/NB	WB/SB	Total	EB/NB	WB/SB	Total
SW 40 St/Bird Road, West of SW 42 Ave/Le Jeune Rd	19,500	19,500	39,000	22,000	20,500	42,500
SW 40 St/Bird Road, East of SW 42 Ave/Le Jeune Rd	18,000	19,500	37,500	21,000	17,500	38,500
SW 42 Ave/Le Jeune Rd, South of SW 40 St/Bird Rd	12,500	13,500	26,000	10,500	9,400	19,900

CRASH DATA



Crash Type	Year					Total	Percentage
	2019	2020	2021	2022	2023		
Rear End	13	11	13	21	24	82	50.3%
Left Trurn	3	3	5	4	9	24	14.7%
Angle	2	0	3	1	3	9	5.5%
Sideswipe	7	3	1	3	3	17	10.4%
Head On	0	0	0	1	0	1	0.6%
Off Road	1	1	2	1	0	5	3.1%
Right Turn	0	1	0	2	2	5	3.1%
Roll Over	1	0	0	2	0	3	1.8%
Pedestrian	1	0	1	0	1	3	1.8%
Bicycle	0	1	0	0	0	1	0.6%
Other	0	1	1	1	2	5	3.1%
Unknown	2	2	0	2	2	8	4.9%
Total						163	100.0%

Lighting Conditions	Year					Total	Percentage
	2019	2020	2021	2022	2023		
Day Light	20	14	18	23	34	109	66.9%
Dark Lighted	8	7	7	14	10	46	28.2%
Dusk	2	2	0	1	1	6	3.7%
Dark No Lighted	0	0	1	0	1	2	1.2%
Total						163	100.0%

Surface Conditions	Year					Total	Percentage
	2019	2020	2021	2022	2023		
Dry	25	17	24	32	42	140	85.9%
Wet	5	6	2	6	4	23	14.1%
Total						163	100.0%

UPCOMING FDOT PROJECT



- LE JEUNE RD FROM NORTH OF US-1 TO NORTH OF ALTARA AVE
- FDOT ADDING CROSSWALKS AT ALTARA AVE AND GRECO AVE
- PROJECT INCLUDES:
 - ❖ TRAFFIC SIGNAL AT GRECO AVE
 - ❖ SPEED FEEDBACK SIGN
 - ❖ CROSSWALKS
 - ❖ PEDESTRIAN SIGNALS
 - ❖ MILLING & RESURFACING
 - ❖ SIGNAGE
 - ❖ STRIPING

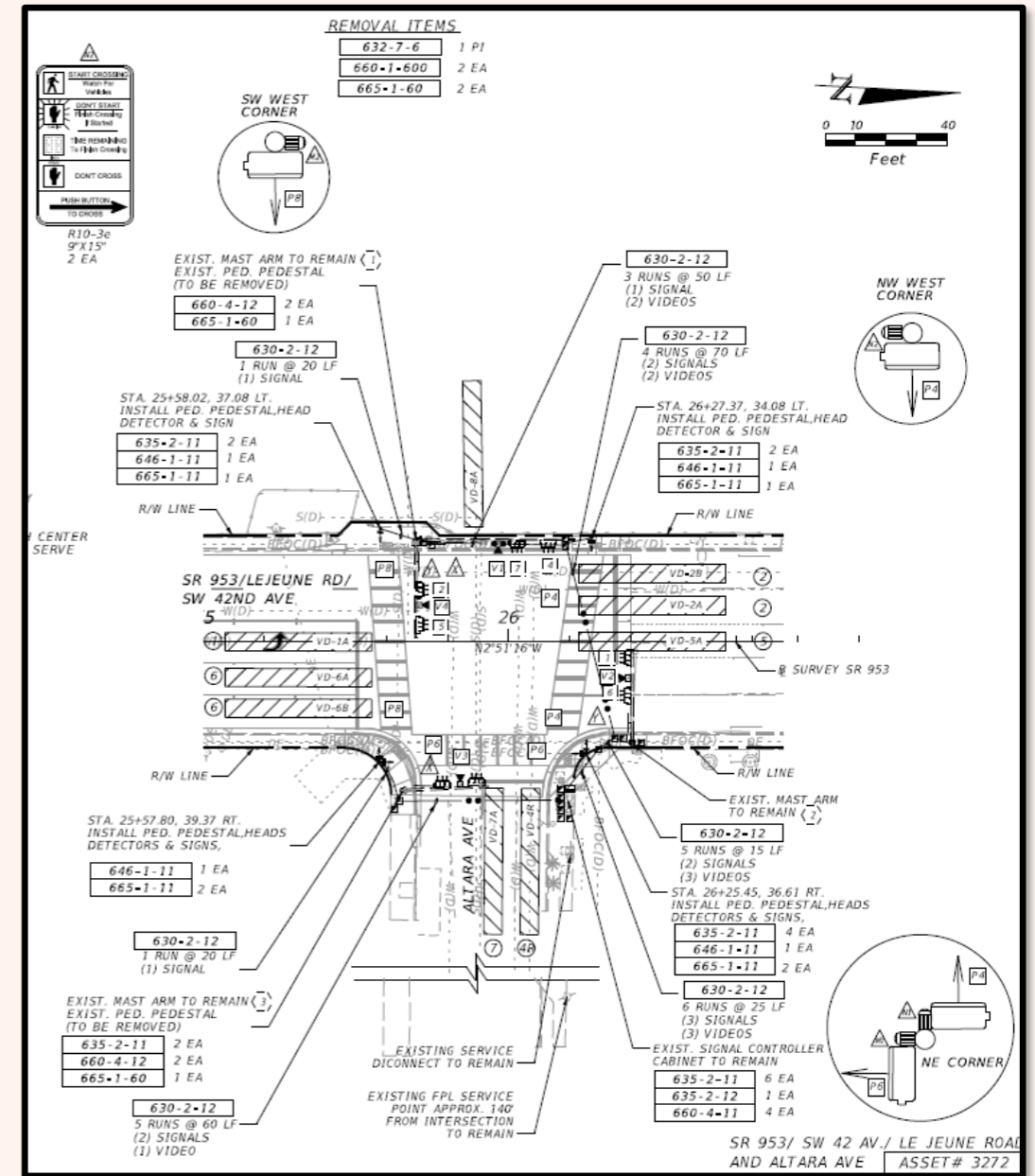

Thank you!

Public Works Department: *Keeping the City Beautiful Yesterday, Today & Tomorrow*

PWDepartment@coralgables.com

**CORAL
GABLES**
THE CITY BEAUTIFUL