

# City of Coral Gables, FL



**BrightView** 

RFP No. 2022-008  
Citywide Landscape Maintenance

BrightView Landscape Services, Inc.  
8191 NW 84<sup>th</sup> Street, Medley, FL 33166  
954-593-2386

Jeremy Cruz

[Jeremy.cruz@brightview.com](mailto:Jeremy.cruz@brightview.com)

5/20/2022

## TABLE OF CONTENTS

**SECTION I:** TITLE PAGE, TABLE OF CONTENTS, REQUIRED FORMS, AND MINIMUM QUALIFICATION REQUIREMENTS (Page 1-34)

**SECTION II:** EXPERIENCES AND PROPOSER'S QUALIFICATIONS (Page 35-57)

**SECTION III:** PROJECT APPROACH AND METHODOLOGY (Page 58-75)

**SECTION IV:** PAST PERFORMANCE AND REFERENCES (Page 76-77)

**SECTION V:** PROPOSAL PRICE PROPOSAL (Page 78-87)

**SECTION V1:** AGREEMENT COMMENTS/EXCEPTIONS (Page 88)

# CITY OF CORAL GABLES, FL

2800 SW 72<sup>nd</sup> Avenue, Miami, FL 33155  
 Finance Department / Procurement Division  
 Tel: 305-460-5102 / Fax: 305-261-1601

## PROPOSER'S ACKNOWLEDGEMENT

<p><b>RFP Title:</b> Citywide Landscape Maintenance</p> <hr/> <p><b>RFP No.:</b> 2022-008</p> <p>A cone of silence is in effect with respect to this RFP. The Cone of Silence prohibits certain communication between potential vendors and the City. For further information, please refer to the City Code Section 2-1027 of the City of Coral Gables Procurement Code.</p>	<p><b>Electronic submittals must be received prior to 2:00 p.m., April 4, 2022, via PublicPurchase; and will remain valid for 120 calendar days. Submittals received after the specified date and time will not be accepted.</b></p> <p>Contact: Andrea Chung                  Title: Procurement Specialist                  Telephone: 305-441-5745                  Email: <a href="mailto:ACHung2@coralgables.com">ACHung2@coralgables.com</a>  <a href="mailto:contracts@coralgables.com">contracts@coralgables.com</a></p>
---	--

Proposer Name: BrightView Landscape Services, Inc.	FEIN or SS Number: 95-4194223
Complete Mailing Address: 8191 NW 84th Street, Medley, FL 33166	Telephone No.: 305-258-8011
	Cellular No.: 954-593-2386
Indicate type of organization below: Corporation: <input checked="" type="checkbox"/> Partnership: <input type="checkbox"/> Individual: <input type="checkbox"/> Other: <input type="checkbox"/>	Fax No.: 305-258-0809
Bid Bond/Security Bond 5%	Email: <a href="mailto:jeremy.cruz@brightview.com">jeremy.cruz@brightview.com</a>

**ATTENTION: THIS FORM ALONG WITH ALL REQUIRED RFP FORMS MUST BE COMPLETED, SIGNED (PREFERABLY IN BLUE INK), AND SUBMITTED WITH THE RESPONSE PRIOR TO THE SUBMITTAL DEADLINE. FAILURE TO DO SO MAY DEEM PROPOSER NON-RESPONSIVE.**

THE PROPOSER CERTIFIES THAT THIS SUBMITTAL IS BASED UPON ALL CONDITIONS AS LISTED IN THE RFP DOCUMENTS AND THAT THE PROPOSER HAS MADE NO CHANGES IN THE RFP DOCUMENT AS RECEIVED. THE PROPOSER FURTHER AGREES IF THE RFP IS ACCEPTED, THE PROPOSER WILL EXECUTE AN APPROPRIATE AGREEMENT FOR THE PURPOSE OF ESTABLISHING A FORMAL CONTRACTUAL RELATIONSHIP BETWEEN THE PROPOSER AND THE CITY OF CORAL GABLES FOR THE PERFORMANCE OF ALL REQUIREMENTS TO WHICH THIS RFP PERTAINS. FURTHER, BY SIGNING BELOW PREFERABLY IN **BLUE INK**, ALL RFP PAGES ARE ACKNOWLEDGED AND ACCEPTED AS WELL AS ANY SPECIAL INSTRUCTION SHEET(S) IF APPLICABLE. THE UNDERSIGNED HEREBY DECLARES (OR CERTIFIES) ACKNOWLEDGEMENT OF THESE REQUIREMENTS AND THAT HE/SHE IS AUTHORIZED TO BIND PERFORMANCE OF THIS RFP FOR THE ABOVE PROPOSER.

  
 \_\_\_\_\_  
 Authorized Name and Signature

  
 \_\_\_\_\_  
 Title

  
 \_\_\_\_\_  
 Date

# **SOLICITATION SUBMISSION CHECKLIST**

## **Request for Proposals (RFP) No. 2022-008**

COMPANY NAME: (Please Print): BrightView Landscape Services, Inc.  
Phone: 954-593-2386 Email: Jeremy.cruz@brightview.com

**A response package numbered by page must be submitted ELECTRONICALLY via PUBLICPURCHASE. Please provide the PAGE NUMBER of your solicitation response in the blanks provided as to where compliance information is located in your Submittal for each of the required submittal items listed below:**

### **SUBMITTAL - SECTION I: TITLE PAGE, TABLE OF CONTENTS, REQUIRED FORMS, AND MINIMUM QUALIFICATION REQUIREMENTS.**

- 1) Title Page: Show the RFP number and title, the name of your firm, address, telephone number, name of contact person, e-mail address, and date. **PAGE #** 1
- 2) Provide a Table of Contents in accordance with and in the same order as the respective "Sections" listed below. Clearly identify the material by section and page number. **PAGE #** 2
- 3) Fill out, sign, and submit the Proposer's Acknowledgement Form. **PAGE #** 3
- 4) Fill out and submit the Solicitation Submission Check List. **PAGE #** 4
- 5) Fill out, sign, notarize (as applicable), and submit the Proposer's Affidavit and Schedules A through M. **PAGE #** 8
- 6) Fill out, E-Verify Affidavit **PAGE #** 25
- 7) Minimum Qualification Requirements: submit detailed verifiable information affirmatively documenting compliance with the Minimum Qualifications Requirements shown in Section 3. **PAGE #** See Section 2/3
- 8) Fill out, Lobbyist Registration & Oral Presentation Forms **PAGE #** 26
- 9) A Bid Bond, a certified check, cashier's check, Treasurer's check or bank draft of any State or National Bank, in accordance with Sections 1.14 - 1.16. **AN ORIGINAL COPY OF THE BOND MUST BE RECEIVED PRIOR THE DEADLINE/CLOSING DATE & TIME OF THE SOLICITATION IN ORDER FOR YOUR SUBMITTAL TO BE CONSIDERED RESPONSIVE. The bond must be delivered DIRECTLY to the Procurement Office located at 2800 SW 72<sup>nd</sup> Avenue, Miami, FL 33155.** The office is open during normal business hours M-F, 8am-5pm (excluding City recognized Holidays). **PAGE #** 28

### **SUBMITTAL - SECTION II: EXPERIENCE AND PROPOSER'S QUALIFICATIONS**

#### **FOR PROPOSER:**

- 1) Provide a complete history and description of your company, including, but not limited to, the number of years in business, size, number of employees, office location, copy of applicable licenses/certifications, credentials, capabilities and capacity to meet the City's needs. **PAGE #** 36



- 2) Describe the Proposer's relevant knowledge and experience in providing the services described in the "Scope of Services" to public sector agencies similar in size to the City of Coral Gables.

**PAGE #** 37

**FOR KEY PERSONNEL:**

- 1) Provide a summary of the qualifications, copy of applicable licenses/certifications, and experience of all proposed key personnel. Include resumes (listing experience, education, licenses/certifications) for your proposed key personnel and specify the role and responsibilities of each team member in providing the services outlined in the RFP. Provide an organizational chart of all key personnel that will be used. For each key team member, please describe the experience in providing the services solicited herein.

**PAGE #** 41

- 2) Experience shall be considered in any of the following:

- a. Work in the field of landscape contracting irrigation design/repair under a licensed company.
- b. Certification in LIAF (Landscape Inspectors Association of Florida) or FNGLA (Florida Nursery Growers Landscape Association)
- c. College level courses in the field of horticulture, botany, landscape architecture, or equal.

**PAGE #** 53

**SUBMITTAL - SECTION III: PROJECT APPROACH AND METHODOLOGY**

- 1) Describe in detail, your approach to perform the services solicited herein. Include detailed information, as applicable, which addresses, but need not be limited to understanding of the RFP scope and requirements, implementation plan and communication with City staff and Consultants. Indicate how the Proposer intends to positively and innovatively work with the City in providing the services outlined in this RFP.

**PAGE #** 58

- 2) Provide a detailed description of the service, including but not limited to:

- a. a. Ability to have available additional or necessary tools and or equipment which may be needed to perform routine tasks and project work.

**PAGE #** 59

- b. Ability to ensure all required tools and or equipment is maintained or replaced to ensure your equipment is always in quality working order

**PAGE #** 61

- c. Ability to provide the services requested herein, including personnel, tools and materials needed for the duration of the contract.

**PAGE #** 61

- 3) Describe in detail your ability to provide the services requested in this RFP, including personnel, tools and materials needed for the duration of the contract.

**PAGE #** 67

- 4) Describe in detail your proposed quality assurance plan inspection procedures, and reporting system that will be used to monitor performance standards under this RFP.

**PAGE#** 74

**SUBMITTAL – SECTION IV: PAST PERFORMANCE AND REFERENCES**

- 1) Provide a minimum of three (3) references (but no more than five (5) from for which Proposer has performed similar scope of services in the past five (5) years. Please include: (1) client name, (2) address, (3) contact name, (4) contact telephone number, (5) contact email address, (6) term of contract (start and end date), (7) contract amount, (8) services provided. **DO NOT include work/services performed for the City of Coral Gables or City employees as reference.**

**PAGE #** 76

- 2) Provide a list with contact information of public sector clients, if any that have discontinued use of Proposer's service within the past two (2) years and indicate the reasons for the same.

**PAGE #** N/A

- 3) Please identify each incident within the last five (5) years where (a) a civil, criminal, administrative, other similar proceeding was filed or is pending, if such proceeding arises from or is a dispute concerning the Proposer's rights, remedies or duties under a contract for the same or similar type services to be provided under this RFP (*See Affidavit D*).

**PAGE #** N/A

**SUBMITTAL – SECTION V: PROPOSAL PRICE PROPOSAL**

- 1) Provide pricing on the Response Form for **Exhibit A and Exhibit G**

**PAGE #** 78

**SUBMITTAL – SECTION VI: AGREEMENT COMMENTS/EXCEPTIONS**

- 1) Please follow the instructions as outlined in Section 1.6 Agreement Execution. The acceptance of or any exceptions taken to the terms and conditions of the City's Agreement shall be considered a part of a Proposer's submittal and will be considered by the Evaluation Committee.

**-- NOTICE --**

**BEFORE SUBMITTING YOUR RFP RESPONSE MAKE SURE YOU:**

1. Carefully read and have a clear understanding of the RFP, including the Scope of Services and enclosed Professional Services Agreement (*draft*).
2. Carefully follow the Submission Requirements outlined in Section 6 of the RFP and ensure you have submitted all of the required information. **DO NOT INCLUDE A COPY OF THE ORIGINAL SOLICITATION.**
3. **Prepare and submit ONE (1) electronic copy via PublicPurchase**
4. Make sure your Response is submitted prior to the submittal deadline. **Late responses will not be accepted.**

**FAILURE TO SUBMIT THIS CHECKLIST AND THE REQUESTED DOCUMENTATION MAY RENDER YOUR RESPONSE SUBMITTAL NON-RESPONSIVE AND CONSTITUTE GROUNDS FOR REJECTION. THIS PAGE IS TO BE RETURNED WITH YOUR RESPONSE PACKAGE.**

## RESPONDENT'S AFFIDAVIT

**SOLICITATION:** IFB 2022-008 Citywide Landscaping Maintenance

**SUBMITTED TO:** City of Coral Gables  
Procurement Division  
2800 SW 72 Avenue  
Miami, Florida 33155

The undersigned acknowledges and understands the information contained in response to this solicitation and the referenced Schedules A through M shall be relied upon by Owner awarding the contract and such information is warranted by Respondent to be true and correct. The discovery of any omission or misstatements that materially affects the Respondent's ability to perform under the contract shall be cause for the City to reject the solicitation submittal, and if necessary, terminate the award and/or contract. I further certify that the undersigned name(s) and official signatures of those persons are authorized as (*Owner, Partner, Officer, Representative or Agent of the respondent that has submitted the attached solicitation response*). Schedules A through M are subject to Local, State and Federal laws (as applicable); both criminal and civil.

- SCHEDULE A – STATEMENT OF CERTIFICATION
- SCHEDULE B – NON-COLLUSION AND CONTINGENT FEE AFFIDAVIT
- SCHEDULE C – DRUG-FREE STATEMENT
- SCHEDULE D – RESPONDENT'S QUALIFICATION STATEMENT
- SCHEDULE E – CODE OF ETHICS, CONFLICT OF INTEREST, AND CONE OF SILENCE
- SCHEDULE F – AMERICANS WITH DISABILITIES ACT (ADA)
- SCHEDULE G – PUBLIC ENTITY CRIMES
- SCHEDULE H – ACKNOWLEDGEMENT OF ADDENDA
- SCHEDULE I – APPENDIX A, 44 C.F.R. PART 18-CERTIFICATION REGARDING LOBBYING
- SCHEDULE J –CERTIFICATION REGARDING DEBARMENT, SUSPENSION, INELIGIBILITY AND VOLUNTARY EXCLUSION
- SCHEDULE K – FEDERAL GRANT FUNDING SPECIAL PROPOSAL CONDITIONS
- SCHEDULE L – WORK HOURS & SAFETY CERTIFICATION
- SCHEDULE M – SAFETY ACCIDENT PREVENTION

This affidavit is to be furnished to the City of Coral Gables with the solicitation response. It is to be filled in, executed by the respondent and notarized. If the response is made by a Corporation, then it should be executed by its Chief Officer. This document MUST be submitted with the solicitation response.

  
\_\_\_\_\_  
Authorized Name and Signature

  
\_\_\_\_\_  
Title

  
\_\_\_\_\_  
Date

STATE OF Florida

COUNTY OF Miami Dade

On this 16 day of May, 2022, before me the undersigned Notary Public of the State of Florida, personally appeared \_\_\_\_\_  
(Name(s) of individual(s) who appeared before Notary)

And whose name(s) is/are subscribes to within the instrument(s), and acknowledges it's execution

  
\_\_\_\_\_  
NOTARY PUBLIC, STATE OF \_\_\_\_\_  
Patricia Soto  
\_\_\_\_\_  
(Name of notary Public; Print, Stamp or Type as Commissioned.)

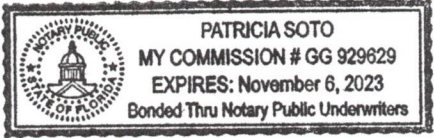

NOTARY PUBLIC  
SEAL OF OFFICE:

Personally know to me, or Produced  
Identification:

\_\_\_\_\_  
(Type of Identification Produced)

**SCHEDULE "A" - CITY OF CORAL GABLES – STATEMENT OF CERTIFICATION**

Neither I, nor the company, hereby represent has:

- a. employed or retained for a commission, percentage brokerage, contingent fee, or other consideration, any company or person (other than a bona fide employee working solely for me or the respondent) to solicit or secure this contract.
- b. agreed, as an express or implied condition for obtaining this contract, to employ or retain the services of any company or person in connection with carrying out the contract, or
- c. paid, or agreed to pay, to any company, organization or person (other than a bona fide employee working solely for me or the respondent) any fee, contribution, donation or consideration of any kind for, or in connection with, procuring or carrying out the contract except as here expressly stated (if any):

**SCHEDULE "B" - CITY OF CORAL GABLES - NON-COLLUSION AND CONTINGENT FEE AFFIDAVIT**

1. He/she is the Charles Gonzalez  
*(Owner, Partner, Officer, Representative or Agent)*

of the Respondent that has submitted the attached response.

- 2. He/she is fully informed with respect to the preparation and contents of the attached response and of all pertinent circumstances respecting such response;
- 3. Said response is made without any connection or common interest in the profits with any other persons making any response to this solicitation. Said response is on our part in all respects fair and without collusion or fraud. No head of any department, any employee or any officer of the City of Coral Gables is directly or indirectly interested therein. If any relatives of Respondent's officers or employees are employed by the City, indicate name and relationship below.

Name: Charles Gonzalez Relationship: SVP

Name: \_\_\_\_\_ Relationship: \_\_\_\_\_

4. No lobbyist or other Respondent is to be paid on a contingent or percentage fee basis in connection with the award of this Contract.



5-5-2022

**SCHEDULE "C" CITY OF CORAL GABLES - VENDOR DRUG-FREE STATEMENT**

Vendors must submit a certification with their bid/proposal certifying they have a drug- free workplace in as follows:

1. Publish a statement notifying employees that the unlawful manufacture, distribution, dispensing, possession, or use of a controlled substance is prohibited in the workplace and specifying the actions that will be taken against employees for violations of such prohibition.
2. Inform employees about the dangers of drug abuse in the workplace, the business's policy of maintaining a drug-free workplace, any available drug counseling, rehabilitation, and employee assistance programs, and the penalties that may be imposed upon employees for drug abuse violations.
3. Give each employee engaged in providing the commodities or contractual services that are under solicitation a copy of the statement specified in subsection (1).
4. In the statement specified in subsection (1), notify the employees that, as a condition of working on the commodities or contractual services that are under solicitation, the employee will abide by the terms of the statement and will notify the employer of any conviction of, or plea of guilty or nolo contendere to, any violation of chapter 893 or of any controlled substance law of the United States or any state, for a violation occurring in the workplace no later than five (5) days after such conviction.
5. Impose a sanction on, or require the satisfactory participation in a drug abuse assistance or rehabilitation program if such is available in the employee's community, by any employee who is so convicted.
6. Make a good faith effort to continue to maintain a drug-free workplace through implementation of this section. As the person authorized to sign the statement, I certify that this form complies fully with the above requirements.

*Cher A. Mc*

*5-5-2022*

**SCHEDULE "D" CITY OF CORAL GABLES – RESPONDENT'S QUALIFICATION STATEMENT**

The undersigned declares the truth and correctness of all statements and all answers to questions made hereinafter:

**GENERAL COMPANY INFORMATION:**

Company Name: BrightView Landscape Services, Inc.

Address: 8191 NW 84th Street Medley FL 33166  
Street City State Zip Code

Telephone No: (954) 593-2386 Fax No: (305) 258-8011 Email: jeremy.cruz@brightview.com

How many years has your company been in business under its present name? 8 Years

If Respondent is operating under Fictitious Name, submit evidence of compliance with Florida Fictitious Name Statute:

N/A

Under what former names has your company operated? : ValleyCrest Companies and Brickman Group

At what address was that company located? 8191 NW 84th Street, Medley, FL 33166

Is your company certified? Yes x No \_\_\_\_\_ If Yes, **ATTACH COPY** of Certification.  
Is your company licensed? Yes x No \_\_\_\_\_ If Yes, **ATTACH COPY** of License

Has your company or its senior officers ever declared bankruptcy?

Yes \_\_\_\_\_ No x If yes, explain: \_\_\_\_\_

**LEGAL INFORMATION:**

Please identify each incident **within the last five (5) years** where (a) a civil, criminal, administrative, other similar proceeding was filed or is pending, if such proceeding arises from or is a dispute concerning the Respondent's rights, remedies or duties under a contract for the same or similar type services to be provided under this solicitation **(A response is required. If applicable please indicate "none" or list specific information related to this question. Please be mindful that responses provided for this question will be independently verified)**:

N/A  
\_\_\_\_\_  
\_\_\_\_\_  
\_\_\_\_\_

Has your company ever been debarred or suspended from doing business with any government entity?

Yes \_\_\_\_\_ No x If Yes, explain \_\_\_\_\_

*CMJ* 5-5-2022



**SCHEDULE "E" CITY OF CORAL GABLES – CODE OF ETHICS, CONFLICT OF INTEREST, AND CONE OF SILENCE**

THESE SECTIONS OF THE CITY CODE CAN BE FOUND ON THE CITY'S WEBSITE, UNDER GOVERNMENT, CITY DEPARTMENT, PROCUREMENT, PROCUREMENT CODE (CITY CODE CHAPTER 2 ARTICLE VIII); SEC 2-1023; SEC 2-606; AND SEC 2-1027, RESPECTIVELY.

IT IS HEREBY ACKNOWLEDGED THAT THE ABOVE NOTED SECTIONS OF THE CITY OF CORAL GABLES CITY CODE ARE TO BE ADHERED TO PURSUANT TO THIS SOLICITATION.

**SCHEDULE "F" CITY OF CORAL GABLES - AMERICANS WITH DISABILITIES ACT (ADA) DISABILITY NONDISCRIMINATION STATEMENT**

I understand that the above named firm, corporation or organization is in compliance with and agreed to continue to comply with, and assure that any sub-contractor, or third party contractor under this project complies with all applicable requirements of the laws listed below including, but not limited to, those provisions pertaining to employment, provision of programs and service, transportation, communications, access to facilities, renovations, and new construction.

The American with Disabilities Act of 1990 (ADA), Pub. L. 101-336, 104 Stat 327, 42 U.S.C. 12101, 12213 and 47 U.S.C. Sections 225 and 661 including Title I, Employment; Title 11, Public Services; Title III, Public Accommodations and Services Operated by Private Entities; Title IV, Telecommunications; and Title V, Miscellaneous Provisions.

The Florida Americans with Disabilities Accessibility Implementation Act of 1993, Sections 5553.501-553.513, Florida Statutes

The Rehabilitation Act of 1973, 229 U.S.C. Section 794

The Federal Transit Act, as amended, 49 U.S.C. Section 1612

The Fair Housing Act as amended, 42 U.S.C. Section 3601-3631

**SCHEDULE "G" CITY OF CORAL GABLES - STATEMENT PURSUANT TO SECTION 287.133 (3) (a), FLORIDA STATUTES, ON PUBLIC ENTITY CRIMES**

1. I understand that a "public entity crime" as define in Paragraph 287.133(1)(g), **Florida Statutes**, means a violation of any state or federal law by a person with respect to and directly related to the transaction of business with any public entity or with an agency or political subdivision of any other state or of the United States, including, but not limited to, any Proposal or contract for goods or services to be provided to any public entity or an agency or political subdivision of any other state or of the United States and involving antitrust, fraud, theft, bribery, collusion, racketeering, conspiracy, or material misrepresentation.
2. I understand that "convicted" or "conviction" as defined in Paragraph 287.133(1)(b), **Florida Statutes**, means a finding of guilt or a conviction of a public entity crime, with or without an adjudication of guilt, in any federal or state trial court of record relating to charges brought by indictment or information after July 1, 1989, as a result of a jury verdict, non-jury trial, or entry of a plea of guilty or nolo contendere.

*Cue John 5-5-2022*

3. I understand that an "affiliate" as defined in Paragraph 287.133(1)(a), Florida Statutes, means:
1. A predecessor or successor of a person convicted of a public entity crime; or 2. An entity under the control of any natural person who is active in the management of the entity and who has been convicted of a public entity crime. The term "affiliate" includes those officers, directors, executives, partners, shareholders, employees, members, and agents who are active in the management of an affiliate. The ownership by one person of shares constituting a controlling interest in another person, or a pooling of equipment or income among persons when not for fair market value under an arm's length agreement, shall be a prima facie case that one person controls another person. A person who knowingly enters into a joint venture with a person who has been convicted of a public entity crime in Florida during the preceding 36 months shall be considered an affiliate.
4. I understand that a "person" as defined in Paragraph 287.133(1)(e), Florida Statutes, means any natural person or entity organized under the laws of any state or of the United States with the legal power to enter into a binding contract and which Proposals or applies to Proposal on contracts for the provision of goods or services let by a public entity, or which otherwise transacts or applies to transact business with a public entity. The term "person" includes those officers, directors, executives, partners, shareholders, employees, members, and agents who are active in management of an entity.
5. Based on information and belief, the statement which I have marked below is true in relation to the entity submitting this sworn statement. **[Please indicate which statement below applies.]**

Neither the entity submitting this sworn statement, nor any of its officers, directors, executives, partners, shareholders, employees, members, or agents who are active in the management of the entity, nor any affiliate of the entity has been charged with and convicted of a public entity crime subsequent to July 1, 1989.

The entity submitting this sworn statement, or one or more of its officers, directors, executives, partners, shareholders, employees, members, or agents who are active in the management of the entity, or an affiliate of the entity has been charged with and convicted of a public entity crime subsequent to July 1, 1989.

The entity submitting this sworn statement, or one or more of its officers, directors, executives, partners, shareholders, employees, members, or agents who are active in the management of the entity, or an affiliate of the entity has been charged with and convicted of a public entity crime subsequent to July 1, 1989. However, there has been subsequent proceeding before a Hearing Officer of the State of Florida, Division of Administrative Hearings and the Final Order entered by the Hearing Officer determined that it was not in the public interest to place the entity submitting this sworn statement on the convicted vendor list.

**[Attach a copy of the final order]**

**I UNDERSTAND THAT THE SUBMISSION OF THIS FORM TO THE CONTRACTING OFFICER FOR THE PUBLIC ENTITY IS FOR THAT PUBLIC ENTITY ONLY AND, THAT THIS FORM IS VALID THROUGH DECEMBER 31 OF THE CALENDAR YEAR IN WHICH IT IS FILED. I ALSO UNDERSTAND THAT I AM REQUIRED TO INFORM THE PUBLIC ENTITY PRIOR TO ENTERING INTO A CONTRACT IN EXCESS OF THE THRESHOLD AMOUNT PROVIDED IN SECTION 287.017, FLORIDA STATUTES FOR CATEGORY TWO OF ANY CHANGE IN THE INFORMATION CONTAINED IN THIS FORM.**

*Chm J. Smith 5-5-2022*

**SCHEDULE "H" CITY OF CORAL GABLES - ACKNOWLEDGEMENT OF ADDENDA**

1. The undersigned agrees, if this RFP is accepted, to enter in a Contract with the CITY to perform and furnish all work as specified or indicated in the RFP and Contract Documents within the Contract time indicated in the RFP and in accordance with the other terms and conditions of the solicitation and contract documents.
2. Acknowledgement is hereby made of the following Addenda, if any (identified by number) received since issuance of the Request for Proposal.

**Failure to adhere to changes communicated via any addendum may render your response non-responsive.**

Addendum No. 1 Date 4/18/2022

Addendum No. \_\_\_\_\_ Date \_\_\_\_\_

Addendum No. 2 Date 5/5/2022

Addendum No. \_\_\_\_\_ Date \_\_\_\_\_

Addendum No. 3 Date 5/13/2022

Addendum No. \_\_\_\_\_ Date \_\_\_\_\_

**SCHEDULE "I" - APPENDIX A, 44 C.F.R. PART 18-CERTIFICATION REGARDING LOBBYING**

**LOBBYING - 31 U.S.C. 1352, as amended**

APPENDIX A, 44 CFR PART 18--CERTIFICATION REGARDING LOBBYING

Certification for Contracts, Grants, Loans, and Cooperative Agreements  
(To be submitted with each bid or offer exceeding \$100,000)

The undersigned [Company] certifies, to the best of his or her knowledge and belief, that:

1. No Federal appropriated funds have been paid or will be paid, by or on behalf of the undersigned, to any person for influencing or attempting to influence an officer or employee of an agency, a Member of Congress, an officer or employee of Congress, or an employee of a Member of Congress in connection with the awarding of any Federal contract, the making of any Federal grant, the making of any Federal loan, the entering into of any cooperative agreement, and the extension, continuation, renewal, amendment, or modification of any Federal contract, grant, loan, or cooperative agreement.
2. If any funds other than Federal appropriated funds have been paid or will be paid to any person for influencing or attempting to influence an officer or employee of any agency, a Member of Congress, an officer or employee of Congress, or an employee of a Member of Congress in connection with this Federal contract, grant, loan, or cooperative agreement, the undersigned shall complete and submit Standard Form-LLL, "Disclosure Form to Report Lobbying," in accordance with its instructions
3. The undersigned shall require that the language of this certification be included in the award documents for all sub-awards at all tiers (including subcontracts, sub-grants, and contracts under grants, loans, and cooperative agreements) and that all sub-recipients shall certify and disclose accordingly.

This certification is a material representation of fact upon which reliance was placed when this transaction was made or entered into. Submission of this certification is a prerequisite for making or entering into this transaction imposed by 31, U.S.C. § 1352 (as amended by the Lobbying Disclosure Act of 1995). Any person who fails to file the required certification shall be subject to a civil penalty of not less than \$10,000 and not more than \$100,000 for each such failure.

The Respondent, BrightView Landscape Services, Inc., certifies or affirms the truthfulness and accuracy of each statement of its certification and disclosure, if any. In addition, the Contractor understands and agrees that the provisions of 31 U.S.C. A 3801, *et seq.*, apply to this certification and disclosure, if any.

 Signature of Company's Authorized Official

Charles Gonzalez SVP Name and Title of Company's Authorized Official

5-5-2022 Date

**SCHEDULE "J" – CERTIFICATION REGARDING DEBARMENT, SUSPENSION, INELIGIBILITY AND VOLUNTARY EXCLUSION**

**Government Debarment & Suspension Instructions**

1. By signing and submitting this form, the prospective lower tier participant is providing the certification set out in accordance with these instructions.
2. The certification in this clause is a material representation of fact upon which reliance was placed when this transaction was entered into. If it is later determined that the prospective lower tier participant knowingly rendered an erroneous certification, in addition to other remedies available to the Federal Government, the department or agency with which this transaction originated may pursue available remedies, including suspension or debarment.
3. The prospective lower tier participant shall provide immediate written notice to the person(s) to which this proposal is submitted if at any time the prospective lower tier participant learns that its certification was erroneous when submitted or has become erroneous by reason of changed circumstances.
4. The terms "covered transaction," "debarred," "suspended," "ineligible," "lower tier covered transaction," "participant," "person," "primary covered transaction," "principal," "proposal," and "voluntarily excluded," as used in this clause, have the meanings set out in the Definitions and Coverage sections of the rules implementing Executive Order 12549, at 2 C.F.R. Parts 180 and 417. You may contact the department or agency to which this proposal is being submitted for assistance in obtaining a copy of those regulations.
5. The prospective lower tier participant agrees by submitting this form that, should the proposed covered transaction be entered into, it shall not knowingly enter into any lower tier covered transaction with a person who is debarred, suspended, declared ineligible, or voluntarily excluded from participation in this covered transaction, unless authorized by the department or agency with which this transaction originated.
6. The prospective lower tier participant further agrees by submitting this form that it will include this clause titled "Certification Regarding Debarment, Suspension, Ineligibility and Voluntary Exclusion - Lower Tier Covered Transactions," without modification, in all lower tier covered transactions and in all solicitations for lower tier covered transactions.
7. A participant in a covered transaction may rely upon a certification of a prospective participant in a lower tier covered transaction that is not debarred, suspended, ineligible, or voluntarily excluded from the covered transaction, unless it knows that the certification is erroneous. A participant may decide the method and frequency by which it determines the eligibility of its principals. Each participant may, but is not required to, check the System for Award Management (SAM) database.
8. Nothing contained in the foregoing shall be construed to require establishment of a system of records in order to render in good faith the certification required by this clause. The knowledge and information of a participant is not required to exceed that which is normally possessed by a prudent person in the ordinary course of business dealings.
9. Except for transactions authorized under paragraph (5) of these instructions, if a participant in a covered transaction knowingly enters into a lower tier covered transaction with a person who is suspended, debarred, ineligible, or voluntarily excluded from participation in this transaction, in addition to other remedies available to the Federal Government, the department or agency with which this transaction originated may pursue available remedies, including suspension and/or debarment.

*CM 1 M*

*5-5-2022*

**Certification Regarding Debarment, Suspension,  
Ineligibility and Voluntary Exclusion  
Lower Tier Covered Transactions**

The following statement is made in accordance with the Privacy Act of 1974 (5 U.S.C. § 552(a), as amended). This certification is required by the regulations implementing Executive Order 12549, Debarment and Suspension, and 2 C.F.R. §§ 180.300, 180.355, Participants' responsibilities. The regulations were amended and published on August 31, 2005, in 70 Fed. Reg. 51865-51880.

**[READ INSTRUCTIONS ON PREVIOUS PAGE BEFORE COMPLETING CERTIFICATION]**

1. The prospective lower tier participant certifies, by submission of this proposal, that neither it nor its principals is presently debarred, suspended, proposed for debarment, declared ineligible, or voluntarily excluded from participation in this transaction by any Federal department or agency;
2. Where the prospective lower tier participant is unable to certify to any of the statements in this certification, such prospective participant shall attach an explanation to this solicitation

Chas L Gonzales SUP

Printed Name and Title of Authorized Representative



Signature

5-5-2022

Date



## **SCHEDULE "K" FEDERAL GRANT FUNDING SPECIAL PROPOSAL CONDITIONS**

This procurement is fully or partially Federally Grant funded. Respondent certifies that it shall comply with the applicable clauses as enumerated below.

1. **Drug Free Workplace Requirements:** Drug-free workplace requirements in accordance with Drug Free Workplace Act of 1988 (Pub L 100-690, Title V, Subtitle D) All proposers entering into Federal funded contracts over \$100,000 must comply with Federal Drug Free workplace requirements as Drug Free Workplace Act of 1988.
2. **Respondent's Compliance:** The respondent shall comply with all uniform administrative requirements, cost principles, and audit requirements for federal awards.
3. **Conflict of Interest:** The respondent must disclose in writing any potential conflict of interest to the city or pass-through entity in accordance with applicable Federal policy.
4. **Mandatory Disclosures:** The respondent must disclose in writing all violations of Federal criminal law involving fraud, bribery, or gratuity violations potentially affecting the Federal award.
5. **Utilization of Minority and Women Firms (M/WBE):** The respondent must take all necessary affirmative steps to assure that minority businesses, women's business enterprises, and labor surplus area firms are used when possible, in accordance with 2CFR 200.321. If subcontracts are to be let, prime proposer will require compliance by all sub-contractor. Prior to contract award, the respondent shall document efforts to utilize M/WBE firms including what firms were solicited as suppliers and/or subcontractor as applicable and submit this information with their bid submittal. Information regarding certified M/WBE firms can be obtained from:  
  
Florida Department of Management Services (Office of Supplier Diversity)  
Florida Department of Transportation  
Minority Business Development Center in most large cities and  
Local Government M/DBE programs in many large counties and cities
6. **Equal Employment Opportunity/Nondiscrimination:** (As per Executive Order 11246) The respondent may not discriminate against any employee or applicant for employment because of age, race, color, creed, sex, disability or national origin. The respondent agrees to take affirmative action to ensure that applicants are employed and that employees are treated during employment without regard to their age, race, color, creed, sex, disability or national origin. Such action shall include but not be limited to the following: employment, upgrading, demotion or transfer, recruitment advertising, layoff or termination, rates of pay or other forms of compensation and selection for training including apprenticeship.
7. **Davis-Bacon Act:** If applicable to this contract, the respondent agrees to comply with all provisions of the Davis Bacon Act as amended (40 U.S.C. 3141-3148). Respondents are required to pay wages to laborers and mechanics at a rate not less than the prevailing wages specified in a wage determination made by the Secretary of Labor. In addition, respondents must be required to pay wages not less than once a week. If the grant award contains Davis Bacon provisions, the City will place a copy of the current prevailing wage determination issued by the Department of Labor in the solicitation document. The decision to award a contract shall be conditioned upon the acceptance of the wage determination.
8. **Copeland Anti Kick Back Act:** If applicable to this contract, respondents shall comply with all the requirements of 18 U.S.C. § 874, 40 U.S.C. § 3145, 29 CFR Part 3 which are incorporated by reference to this contract. Respondents are prohibited from inducing by any means any person employed in the construction, completion or repair of public work to give up any part of the compensation to which he or she is otherwise entitled.

9. **Contract Work Hours and Safety Standards Act** (40 U.S.C. 3701–3708): Where applicable, all contracts awarded in excess of \$100,000 that involve the employment of mechanics or laborers must be in compliance with 40 U.S.C. 3702 and 3704, as supplemented by Department of Labor regulations (29 CFR Part 5). Under 40 U.S.C. 3702 of the Act, each respondent is required to compute the wages of every mechanic and laborer on the basis of a standard work week of 40 hours. Work in excess of the standard work week is permissible provided that the worker is compensated at a rate of not less than one and a half times the basic rate of pay for all hours worked in excess of 40 hours in the work week. The requirements of 40 U.S.C. 3704 are applicable to construction work and provide that no laborer or mechanic must be required to work in surroundings or under working conditions which are unsanitary, hazardous or dangerous. These requirements do not apply to the purchases of supplies or materials or articles ordinarily available on the open market, or contracts for transportation or transmission of intelligence.
10. **Clean Air Act (42 U.S.C. 7401–7671q.) and the Federal Water Pollution Control Act (33 U.S.C. 1251–1387)**: as amended—The Respondent agrees to comply with all applicable standards, orders or regulations issued pursuant to the Clean Air Act (42 U.S.C. 7401–7671q) and the Federal Water Pollution Control Act as amended (33 U.S.C. 1251–1387). Violations must be reported to the Federal awarding agency and the Regional Office of the Environmental Protection Agency (EPA).
11. **Debarment and Suspension** (Executive Orders 12549 and 12689): A contract award (see 2 CFR 180.220 and 2 CFR pt. 300) must not be made to parties listed on the government wide exclusions in the System for Award Management (SAM), in accordance with the OMB guidelines at 2 CFR 180 that implement Executive Orders 12549 (3 CFR part 1986 Comp., p. 189) and 12689 (3 CFR part 1989 Comp., p. 235), “Debarment and Suspension. SAM Exclusions contains the names of parties debarred, suspended, or otherwise excluded by agencies, as well as parties declared ineligible under statutory or regulatory authority other than Executive Order 12549. The respondent shall certify compliance. The respondent further agrees to include a provision requiring such compliance in its lower tier covered transactions and subcontracts.
12. **Byrd Anti-Lobbying Amendment** (31 U.S.C. 1352): Respondents that apply or bid for an award exceeding \$100,000 must file the required certification. Each tier certifies to the tier above that it will not and has not used Federal appropriated funds to pay any person or organization for influencing or attempting to influence an officer or employee of any agency, a member of Congress, officer or employee of Congress, or an employee of a member of Congress in connection with obtaining any Federal contract, grant or any other award covered by 31 U.S.C. 1352. Each tier must also disclose any lobbying with non-Federal funds that takes place in connection with obtaining any Federal award. Such disclosures are forwarded from tier to tier up to the non-Federal award. The respondent shall certify compliance.
13. **Rights to Inventions Made Under a Contract or Agreement**: If the Federal award meets the definition of “funding agreement” under 37 CFR § 401.2 (a) and the recipient or sub-recipient wishes to enter into a contract with a small business firm or nonprofit organization regarding the substitution of parties, assignment or performance of experimental, developmental, or research work under that “funding agreement,” the recipient or sub-recipient must comply with the requirements of 37 CFR Part 401, “Rights to Inventions Made by Nonprofit Organizations and Small Business Firms Under Government Grants, Contracts and Cooperative Agreements,” and any implementing regulations issued by the awarding agency.
14. **Procurement of Recovered Materials**: Respondents must comply with section 6002 of the Solid Waste Disposal Act, as amended by the Resource Conservation and Recovery Act. The requirements of Section 6002 include procuring only items designated in guidelines of the Environmental Protection Agency (EPA) at 40 CFR part 247 that contain the highest percentage of recovered materials practicable, consistent with maintaining a satisfactory level of competition, where the purchase price of the item exceeds \$10,000 or the value of the quantity acquired during the preceding fiscal year exceeded \$10,000; procuring solid waste management services in a manner that maximizes energy and resource recovery; and establishing an affirmative procurement program for procurement of recovered materials identified in the EPA guidelines.



15. **Access to Records and Reports:** Respondent will make available to the City's granting agency, the granting agency's Office of Inspector General, the Government Accountability Office, the Comptroller General of the United States, City of Coral Gables, or any of their duly authorized representatives any books, documents, papers or other records, including electronic records, of the proposer that are pertinent to the City's grant award, in order to make audits, investigations, examinations, excerpts, transcripts, and copies of such documents. The right also includes timely and reasonable access to the respondent's personnel during normal business hours for the purpose of interview and discussion related to such documents. This right of access shall continue as long as records are retained.
16. **Record Retention:** Respondent will retain of all required records pertinent to this contract for a period of three years, beginning on a date as described in 2 C.F.R. §200.333 and retained in compliance with 2 C.F.R. §200.333.
17. **Federal Changes:** Respondent shall comply with all applicable Federal agency regulations, policies, procedures and directives, including without limitation those listed directly or by reference, as they may be amended or promulgated from time to time during the term of the contract.
18. **Termination for Default (Breach or Cause):** If a contract is entered into, the Respondent acknowledges that if it fails to perform in the manner called for in the contract, or if the Respondent fails to comply with any other provisions of the contract, the City may terminate the contract for default. Termination shall be effected by serving a notice of termination to the respondent setting forth the manner in which the respondent is in default. The respondent will only be paid the contract price for supplies delivered and accepted, or services performed in accordance with the manner of performance set forth in the contract.
19. **Safeguarding Personal Identifiable Information:** Respondent will take reasonable measures to safeguard protected personally identifiable information and other information designated as sensitive by the awarding agency or is considered sensitive consistent with applicable Federal, state and/or local laws regarding privacy and obligations of confidentiality.
20. **Prohibition on utilization of cost plus a percentage of cost contracts:** The City will not award contracts containing Federal funding on a cost plus percentage of cost basis.
21. **Energy Policy and Conservation Act (43 U.S.C. §6201):** All contracts except micro-purchases (\$3000 or less, except for construction contracts over \$2000). Contracts shall comply with mandatory standards and policies relating to energy efficiency, stating in the state energy conservation plan issued in compliance with the Energy Policy and Conservation act. (Pub. L. 94-163, 89 Stat. 871) [53 FR 8078, 8087, Mar. 11, 1988, as amended at 60 FR 19639, 19645, Apr. 19, 1995].
22. **Domestic Preference:** As appropriate and to the extent consistent with law, the Contractor should, in accordance with Section 2-699 of the City Code and 2 C.F.R. § 200.322 under Title 2 of the Code of Federal Regulations, to the greatest extent practicable under a Federal award, provide a preference for the purchase, acquisition, or use of goods, products, or materials produced in the United States (including but not limited to iron, aluminum, steel, cement, and other manufactured products). For purposes of this section:
  - a. "Produced in the United States" means, for iron and steel products, that all manufacturing processes, from the initial melting stage through the application of coatings, occurred in the United States.
  - b. "Manufactured products" means items and construction materials composed in whole or in part of non-ferrous metals such as aluminum; plastics and polymer-based products such as polyvinyl chloride pipe; aggregates such as concrete; glass, including optical fiber; and lumber.

23. **Telecommunications Equipment or Services:** It is prohibited, as described in section 889(b)(1) of the John S. McCain National Defense Authorization Act for Fiscal Year 2019 (FY 2019 NDAA)1 and 2 C.F.R. § 200.216.2, for any FEMA award funds to be used in the procurement, the entering into or extending or renewing of a contract for the purpose of obtaining any equipment, system, or service that uses covered telecommunications equipment or services as a substantial or essential component of any system, or as critical technology of any system. For purposes of this section:

- a. Covered telecommunications equipment or services means—
  - i. Telecommunications equipment produced by Huawei Technologies Company or ZTE Corporation, (or any subsidiary or affiliate of such entities);
  - ii. For the purpose of public safety, security of Government facilities, physical security surveillance of critical infrastructure, and other national security purposes, video surveillance and telecommunications equipment produced by Hytera Communications Corporation, Hangzhou Hikvision Digital Technology Company, or Dahua Technology Company (or any subsidiary or affiliate of such entities);
  - iii. Telecommunications or video surveillance services provided by such entities or using such equipment; or
  - iv. Telecommunications or video surveillance equipment or services produced or provided by an entity that the Secretary of Defense, in consultation with the Director of National Intelligence or the Director of the Federal Bureau of Investigation, reasonably believes to be an entity owned or controlled by, or otherwise connected to, the government of a covered foreign country.

24. **Contract with the Enemy:** In accordance with 2 C.F.R. 200.215, it is acknowledged that no services under this contract are to be performed outside the United states and its territories nor in support of a contingency operation in which members of the Armed Forces are actively engaged in hostilities.

As the person authorized to sign this statement, I certify that this company complies/will comply fully with the above applicable requirements and all applicable Federal law, regulations, executive orders, FEMA policies, procedures, and directives."

I further acknowledgement that FEMA financial assistance will be used to fund all or a portion of the contract and that any subcontractor utilized will also be required to comply with the requirements above.

DATE: 5-5-2022

SIGNATURE: 

COMPANY: BrightView Landscape Services, Inc.

NAME: Chris L Garcia

ADDRESS: 8191 NW 84th Street  
Medley, FL 33166

TITLE: SVP

E-MAIL: jeremy.cruz@brightview.com

PHONE NO. 954-593-2386

**SCHEDULE "L" - CONTRACTOR CERTIFICATION WORK HOURS AND SAFETY STANDARDS  
ADDENDUM**

This certification is incorporated as part of the contract for RFP 2022-008 Citywide Landscaping Maintenance.

The Contractor acknowledges and certifies that in accordance with the mandatory requirement that this provision be set forth in all FEMA related contracts, that it shall comply with 40 U.S.C. 3702 and 3704, as supplemented by Department of Labor regulations (29 CFR Part 5).

Under 40 U.S.C. s. 3702, each contractor must be required to compute the wages of every mechanic and laborer on the basis of a standard work week of 40 hours. Work in excess of the standard work week is permissible provided that the worker is compensated at a rate of not less than one and a half times the basic rate of pay for all hours worked in excess of 40 hours in the work week.

The requirements of 40 U.S.C. s. 3704 are applicable to construction work and provide that no laborer or mechanic must be required to work in surroundings or under working conditions which are unsanitary, hazardous or dangerous. These requirements do not apply to the purchase of supplies or materials or articles ordinarily available on the open market, or contracts for transportation or transmission of intelligence.

More particularly, as set forth in 29 CFR s.5.5(b) which provides the required contract clauses:

(1) *Overtime requirements.* No contractor or subcontractor contracting for any part of the contract work which may require or involve the employment of laborers or mechanics shall require or permit any such laborer or mechanic in any workweek in which he or she is employed on such work to work in excess of forty hours in such workweek unless such laborer or mechanic receives compensation at a rate not less than one and one-half times the basic rate of pay for all hours worked in excess of forty hours in such workweek.

(2) *Violation; liability for unpaid wages; liquidated damages.* In the event of any violation of the clause set forth in paragraph (b)(1) of this section the contractor and any subcontractor responsible therefor shall be liable for the unpaid wages. In addition, such contractor and subcontractor shall be liable to the United States (in the case of work done under contract for the District of Columbia or a territory, to such District or to such territory), for liquidated damages. Such liquidated damages shall be computed with respect to each individual laborer or mechanic, including watchmen and guards, employed in violation of the clause set forth in paragraph (b)(1) of this section, in the sum of \$25 for each calendar day on which such individual was required or permitted to work in excess of the standard workweek of forty hours without payment of the overtime wages required by the clause set forth in paragraph (b)(1) of this section.

(3) *Withholding for unpaid wages and liquidated damages.* The (write in the name of the Federal agency or the loan or grant recipient) shall upon its own action or upon written request of an authorized representative of the Department of Labor withhold or cause to be withheld, from any moneys payable on account of work performed by the contractor or subcontractor under any such contract or any other Federal contract with the same prime contractor, or any other federally-assisted contract subject to the Contract Work Hours and Safety Standards Act, which is held by the same prime contractor, such sums as may be determined to be necessary to satisfy any liabilities of such contractor or subcontractor for unpaid wages and liquidated damages as provided in the clause set forth in paragraph (b)(2) of this section.

(4) *Subcontracts.* The contractor or subcontractor shall insert in any subcontracts the clauses set forth in paragraphs (1) through (4) of this section and also a clause requiring the subcontractors to include these clauses in any lower tier subcontracts. The prime contractor shall be responsible for compliance by any subcontractor or lower tier subcontractor with the clauses set forth in paragraphs (1) through (4) of this section.

Charles Gonzalez, hereby certifies that it shall adhere to the Work Hours and Safety Standards regulations throughout the duration of this Contract as set forth above.

  
\_\_\_\_\_  
Contractor Signature

Date: 5-5-2022

**SCHEDULE "M" – SAFETY ACCIDENT PREVENTION**

This provision is applicable to all Federal-aid construction contracts and to all related subcontracts.

1. In the performance of this contract the contractor shall comply with all applicable Federal, State and local laws governing safety, health, and sanitation (23 CFR 635). The contractor shall provide all safeguards, safety devices and protective equipment and take any other needed actions as it determines, or as the contracting officer may determine, to be reasonably necessary to protect the life and health of employees on the job and the safety of the public and to protect property in connection with the performance of the work covered by the contract.
2. It is a condition of this contract, and shall be made a condition of each subcontract, which the contractor enters into pursuant to this contract, that the contractor and any subcontractor shall not permit any employee, in performance of the contract, to work in surroundings or under which are unsanitary, hazardous or dangerous to his/her health or safety, as determined under construction safety and health standards (29 CFR 1926) promulgated by the Secretary of Labor, in accordance with Section 107 of the Construction Work Hours and Safety Standards Act (40 U.S.C. 3704).
3. Pursuant to 29 CFR 1926.3, it is a condition of this contract that the Secretary of Labor or authorized representative thereof, shall have right of entry to any site of contract performance to inspect or investigate the matter of compliance with the construction safety and health standards and to carryout the duties of the Secretary under Section 107 of the Contract Work Hours and Safety Standard Act (40 U.S.C. 3704).

Charles Gonzalez \_\_\_\_\_, hereby certifies that it shall adhere to the Safety Accident Prevention regulations throughout the duration of this Contract as set forth above.

  
\_\_\_\_\_

Contractor Signature

Date: 5-5-2022



City of Coral Gables  
Finance Department/Procurement Division

**Employer E-Verify Affidavit**

By executing this affidavit, the undersigned employer verifies its compliance with F.S. 448.095, stating affirmatively that the individual, firm or corporation has registered with and utilizes the federal work authorization program commonly known as E-Verify, or any subsequent replacement program, in accordance with the applicable provisions and deadlines established in F.S. 448.095 which prohibits the employment, contracting or sub-contracting with an unauthorized alien. The undersigned employer further confirms that it has obtained all necessary affidavits from its subcontractors, if applicable, in compliance with F.S. 448.095, and that such affidavits shall be provided to the City upon request. Failure to comply with the requirements of F.S. 448.095 may result in termination of the employer's contract with the City of Coral Gables. Finally, the undersigned employer hereby attests that its federal work authorization user identification number and date of authorization are as follows:

95-4194223

Federal Work Authorization User Identification Number  
2014

Date of Authorization

I hereby declare under penalty of perjury that the foregoing is true and correct.

Executed on 5-5-2022 in miami (city), FL (state).

  
Signature of Authorized Officer or Agent

Charles Gonzalez SVP  
Printed Name and Title of Authorized Officer or Agent

SUBSCRIBED AND SWORN BEFORE ME  
ON THIS THE 5<sup>th</sup> DAY OF May, 2022

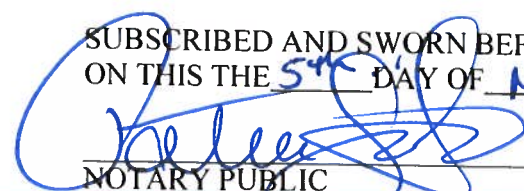
  
NOTARY PUBLIC  
My Commission Expires

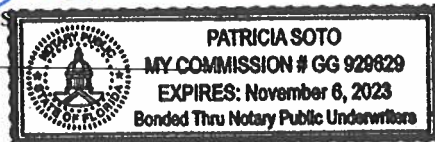



CITY OF CORAL GABLES  
FINANCE DEPARTMENT/PROCUREMENT DIVISION  
LOBBYIST REGISTRATION FORM

SOLICITATION NAME/NUMBER: RFP No. 2022-008/Citywide Landscape Maintenance

The Bidder/Proposer certifies that it understands if it has retained a lobbyist(s) to lobby in connection with this specific competitive solicitation that each lobbyist retained has timely filed the registration or amended registration required under the City of Coral Gables Lobbyist Registration requirement pursuant to Ordinance 2021-24 as outlined below:

*Lobbyist* means an individual, firm, corporation, partnership, or other legal entity employed or retained, whether paid or not, by a principal, or that contracts with a third-party for economic consideration to perform lobbying activities on behalf of a principal.

*Lobbying activity* means any attempt to influence or encourage the passage or defeat of, or modification to, governmental actions, including, but not limited to, ordinances, resolutions, rules, regulations, executive orders, and procurement actions or decisions of the city commission, the mayor, any city board or committee, or any city personnel. The term "lobbying activity" encompasses all forms of communication, whether oral, written, or electronic, during the entire decision-making process on actions, decisions, or recommendations which foreseeably will be heard or reviewed by city personnel. This definition shall be subject to the exceptions stated below.

*Procurement matter* means the city's processes for the purchase of goods and services, including, but not limited to, processes related to the acquisition of: technology; public works; design services; construction, professional architecture, engineering, landscape architecture, land surveying, and mapping services; the purchase, lease or sale of real property; and the acquisition, granting, or other interest in real property.

*City personnel* means those city officials, officers and employees who are entrusted with the day-to-day policy setting, operation, and management of certain defined city functions or areas of responsibility, even though ultimate responsibility for such functions or areas rests with the city commission, with the exception of the City Attorney, Deputy City Attorney, and Assistant City Attorneys, advisory personnel (members of city advisory boards and agencies whose sole or primary responsibility is to recommend legislation or give advice to the city commission); and any employee of a city department or division with the authority to participate in procurement matters, when the communication involves such procurement.

**Affidavit requirement.** The following provisions shall apply to certain individuals who, in procurement matters participate in oral presentations or recorded negotiation meetings and sessions:

- a. The principal shall list on an affidavit form, provided by the City, all technical experts or employees of the principal whose normal scope of employment does not include lobbying activities and whose sole participation in the city procurement matter involves an appearance and participation in a city procurement matter involves an appearance and participation in an oral presentation before a city certification, evaluation, selection, technical review or similar committee, or recorded negotiation meetings or sessions.
- b. No person shall appear before any procurement committee or at any procurement negotiation meeting or session on behalf of a principal unless he/she has been listed as part of the principal's presentation or negotiation team or has registered as a lobbyist. For purposes of this subsection only, the listed members of the oral presentation or negotiation team shall not be required to separately register as lobbyists or pay any registration fees. The affidavit will be filed by the city procurement staff with the city clerk at the after the proposal is submitted or prior to the recorded negotiation meeting or session. Notwithstanding the foregoing, any person who engages in lobbying activities in addition to appearing before a procurement committee to make an oral presentation, or at a recorded procurement negotiation meeting or session, shall comply with all lobbyist registration requirements.

The Bidder/Proposer hereby certifies that: (select one)

It has not retained a lobbyist(s) to lobby in connection with this competitive solicitation; however, if one is retained anytime during the competitive process and prior to contract execution for this project, the lobbyist will properly register with the City Clerk's Office within two (2) business days of being retained with copy to the city procurement staff.

It has retained a lobbyist(s) to lobby in connection with this competitive solicitation and certified that each lobbyist retained has timely filed the registration or amended registration required under the City of Coral Gables

CITY OF CORAL GABLES  
FINANCE DEPARTMENT/PROCUREMENT DIVISION  
LOBBYIST REGISTRATION FORM

Lobbyist Registration requirement pursuant to Ordinance 2021-24 Section and that the required affidavit has been properly filed

It is a requirement of this solicitation that the following information be provided for all lobbyists retained to lobby in connection with this solicitation be listed below:

Name of Lobbyist: N/A  
Lobbyist's Firm (if applicable): \_\_\_\_\_  
Phone: \_\_\_\_\_  
E-mail: \_\_\_\_\_

Name of Lobbyist: \_\_\_\_\_  
Lobbyist's Firm (if applicable): \_\_\_\_\_  
Phone: \_\_\_\_\_  
E-mail: \_\_\_\_\_

Name of Lobbyist: \_\_\_\_\_  
Lobbyist's Firm (if applicable): \_\_\_\_\_  
Phone: \_\_\_\_\_  
E-mail: \_\_\_\_\_

Name of Lobbyist: \_\_\_\_\_  
Lobbyist's Firm (if applicable): \_\_\_\_\_  
Phone: \_\_\_\_\_  
E-mail: \_\_\_\_\_

Authorized Signature:   
Printed Name: Charles L Gombel  
Date: 5-5-2022  
Title: SUP  
Bidder/Proposer Name: Brighton Lodge Services inc

**BID BOND**

STATE OF FLORIDA }  
COUNTY OF MIAMI DADE }SS.  
CITY OF CORAL GABLES }

KNOWN ALL MEN BY THESE PRESENTS, That  
BRIGHTVIEW LANDSCAPE SERVICES, INC., as Principal, and  
LIBERTY MUTUAL INSURANCE COMPANY, as Surety, are held  
and firmly bonded unto the City of Coral Gables as Owner in the penal sum of  
Dollars (\$ 5% of the Total Amount Bid), lawful money of the United States, for the payment of which sum  
well and truly to be made, we bind ourselves, our heirs, executors, administrators, and  
successors, jointly and severally, firmly by these presents.

the Total Amount Bid

Five Percent of

THE CONDITION OF THIS OBLIGATION IS SUCH, that whereas the Principal has  
submitted to the City of Coral Gables the accompanying Bid, signed and dated  
May 6th, 2022 for

**RFP 2022-008 Citywide Landscaping Maintenance  
CORAL GABLES, FLORIDA**

in accordance with the Plans and Specifications therefore, the call for Bids or Proposals,  
and the Instructions to Bidders, all of which are made a part hereof by reference as if fully  
set forth herein.

NOW, THEREFORE,

- (a) If the Principal shall not withdraw said bid within thirty (30) days after date of opening of the same, and shall within ten (10) days after written notice being given by the City Manager or his designee, of the award of the contract, enter into a written contract with the City, in accordance with the bid as accepted, and give bond with good and sufficient surety or sureties, as may be required for the faithful performance and proper fulfillment of such contract,
- (b) in the event of the withdrawal of said bid or proposal within the period specified, or the failure to enter into such contract and give such bond within the time specified, if the Principal shall pay the City the difference between the amount specified in said bid or proposal and the amount for which the City may procure the required work and/or supplies, if the latter amount be in excess of the former, the above obligation shall be void and of no effect, otherwise to remain in full force and effect.



BID BOND

IN WITNESS HEREOF, the above bounded parties have executed this instrument under their several seals this 3rd day of May, A.D., 2022, the name and corporate seal of each corporate party being hereto affixed and these presents duly signed by its undersigned representative, pursuant to authority of its governing body.

WITNESS

(If Sole Ownership or Partnership, Two (2) Witnesses Required. If Corporation, Secretary Only will attest and affix seal).

(1) Vanessa Fong  
Signature

Vanessa Fong, Witness  
Name

(2) n/a  
Signature

n/a  
Name

WITNESS:

(1) Beverly McCoy  
Signature

Beverly McCoy, Witness  
Name

(2) n/a  
Signature

n/a  
Name

PRINCIPAL

BRIGHTVIEW LANDSCAPE SERVICES, INC.  
Name of Firm

Tracy Aston (SEAL)  
Signature of Authorized Officer

Tracy Aston, Attorney-in-Fact  
Name and Title

4155 East Mowry Drive  
Business Address

Hornstead, FL 33033  
City, State

SURETY:

LIBERTY MUTUAL INSURANCE COMPANY  
Corporate Surety

Sam Fazzini (SEAL)  
Attorney-in-Fact Samantha Fazzini

175 Berkeley Street  
Business Address

Boston MA 02116  
City, State

Aon Risk Insurance Services West, Inc.  
Name of Local Agency

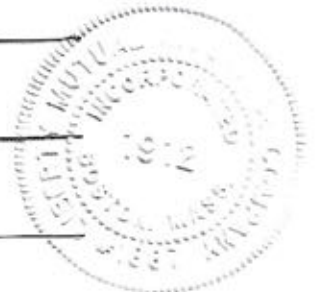

# CALIFORNIA ALL-PURPOSE ACKNOWLEDGMENT

A Notary Public or other officer completing this certificate verifies only the identity of the individual who signed the document to which this certificate is attached, and not the truthfulness, accuracy, or validity of that document.

State of California

County of Los Angeles

On MAY 03 2022 before me, Meghan Hanes, Notary Public, personally appeared Samantha Fazzini who proved to me on the basis of satisfactory evidence to be the person(s) whose name(s) is/are subscribed to the within instrument and acknowledged to me that he/she/they executed the same in his/her/their authorized capacity(ies), and that by ~~his/her/their~~ signature(s) on the instrument the person(s), or the entity upon behalf of which the person(s) acted, executed the instrument.

I certify under PENALTY OF PERJURY under the laws of the State of California that the foregoing paragraph is true and correct.

WITNESS my hand and official seal.



Signature

A handwritten signature in blue ink that reads "Meghan Hanes". The signature is written in a cursive style and is positioned above a horizontal line.

Signature of Notary Public





This Power of Attorney limits the acts of those named herein, and they have no authority to bind the Company except in the manner and to the extent herein stated.

Liberty Mutual Insurance Company
The Ohio Casualty Insurance Company
West American Insurance Company

Certificate No: 8207545-024029

POWER OF ATTORNEY

KNOWN ALL PERSONS BY THESE PRESENTS: That The Ohio Casualty Insurance Company is a corporation duly organized under the laws of the State of New Hampshire, that Liberty Mutual Insurance Company is a corporation duly organized under the laws of the State of Massachusetts, and West American Insurance Company is a corporation duly organized under the laws of the State of Indiana (herein collectively called the "Companies"), pursuant to and by authority herein set forth, does hereby name, constitute and appoint, Meghan Hanes, Rosa E. Rivas, Samantha Fazzini, Tracy Aston

all of the city of Los Angeles state of CA each individually if there be more than one named, its true and lawful attorney-in-fact to make, execute, seal, acknowledge and deliver, for and on its behalf as surety and as its act and deed, any and all undertakings, bonds, recognizances and other surety obligations, in pursuance of these presents and shall be as binding upon the Companies as if they have been duly signed by the president and attested by the secretary of the Companies in their own proper persons.

IN WITNESS WHEREOF, this Power of Attorney has been subscribed by an authorized officer or official of the Companies and the corporate seals of the Companies have been affixed thereto this 23rd day of March, 2022.



Liberty Mutual Insurance Company
The Ohio Casualty Insurance Company
West American Insurance Company

By: David M. Carey, Assistant Secretary

Not valid for mortgage, note, loan, letter of credit, currency rate, interest rate or residual value guarantees.

State of PENNSYLVANIA ss
County of MONTGOMERY

On this 23rd day of March, 2022 before me personally appeared David M. Carey, who acknowledged himself to be the Assistant Secretary of Liberty Mutual Insurance Company, The Ohio Casualty Company, and West American Insurance Company, and that he, as such, being authorized so to do, execute the foregoing instrument for the purposes therein contained by signing on behalf of the corporations by himself as a duly authorized officer.

IN WITNESS WHEREOF, I have hereunto subscribed my name and affixed my notarial seal at King of Prussia, Pennsylvania, on the day and year first above written.



Commonwealth of Pennsylvania - Notary Seal
Teresa Pastella, Notary Public
Montgomery County
My commission expires March 28, 2025
Commission number 1126044
Member, Pennsylvania Association of Notaries

By: Teresa Pastella, Notary Public

This Power of Attorney is made and executed pursuant to and by authority of the following By-laws and Authorizations of The Ohio Casualty Insurance Company, Liberty Mutual Insurance Company, and West American Insurance Company which resolutions are now in full force and effect reading as follows:

ARTICLE IV - OFFICERS: Section 12. Power of Attorney.

Any officer or other official of the Corporation authorized for that purpose in writing by the Chairman or the President, and subject to such limitation as the Chairman or the President may prescribe, shall appoint such attorneys-in-fact, as may be necessary to act in behalf of the Corporation to make, execute, seal, acknowledge and deliver as surety any and all undertakings, bonds, recognizances and other surety obligations. Such attorneys-in-fact, subject to the limitations set forth in their respective powers of attorney, shall have full power to bind the Corporation by their signature and execution of any such instruments and to attach thereto the seal of the Corporation. When so executed, such instruments shall be as binding as if signed by the President and attested to by the Secretary. Any power or authority granted to any representative or attorney-in-fact under the provisions of this article may be revoked at any time by the Board, the Chairman, the President or by the officer or officers granting such power or authority.

ARTICLE XIII - Execution of Contracts: Section 5. Surety Bonds and Undertakings.

Any officer of the Company authorized for that purpose in writing by the chairman or the president, and subject to such limitations as the chairman or the president may prescribe, shall appoint such attorneys-in-fact, as may be necessary to act in behalf of the Company to make, execute, seal, acknowledge and deliver as surety any and all undertakings, bonds, recognizances and other surety obligations. Such attorneys-in-fact subject to the limitations set forth in their respective powers of attorney, shall have full power to bind the Company by their signature and execution of any such instruments and to attach thereto the seal of the Company. When so executed such instruments shall be as binding as if signed by the president and attested by the secretary.

Certificate of Designation - The President of the Company, acting pursuant to the Bylaws of the Company, authorizes David M. Carey, Assistant Secretary to appoint such attorneys-in-fact as may be necessary to act on behalf of the Company to make, execute, seal, acknowledge and deliver as surety any and all undertakings, bonds, recognizances and other surety obligations.

Authorization - By unanimous consent of the Company's Board of Directors, the Company consents that facsimile or mechanically reproduced signature of any assistant secretary of the Company, wherever appearing upon a certified copy of any power of attorney issued by the Company in connection with surety bonds, shall be valid and binding upon the Company with the same force and effect as though manually affixed.

I, Renee C. Llewellyn, the undersigned, Assistant Secretary, The Ohio Casualty Insurance Company, Liberty Mutual Insurance Company, and West American Insurance Company do hereby certify that the original power of attorney of which the foregoing is a full, true and correct copy of the Power of Attorney executed by said Companies, is in full force and effect and has not been revoked.

IN TESTIMONY WHEREOF, I have hereunto set my hand and affixed the seals of said Companies this day of MAY 03, 2022.



By: Renee C. Llewellyn, Assistant Secretary

For bond and/or Power of Attorney (POA) verification inquiries, please call 610-832-8240 or email HOSUR@libertymutual.com.

# CALIFORNIA ALL-PURPOSE ACKNOWLEDGMENT

A Notary Public or other officer completing this certificate verifies only the identity of the individual who signed the document to which this certificate is attached, and not the truthfulness, accuracy, or validity of that document.

State of California

County of Los Angeles

On MAY 03 2022 before me, Meghan Hanes, Notary Public, personally appeared Tracy Aston who proved to me on the basis of satisfactory evidence to be the person(s) whose name(s) is/~~are~~ subscribed to the within instrument and acknowledged to me that he/~~she/they~~ executed the same in his/~~her/their~~ authorized capacity(ies), and that by his/~~her/their~~ signature(s) on the instrument the person(s), or the entity upon behalf of which the person(s) acted, executed the instrument.



I certify under PENALTY OF PERJURY under the laws of the State of California that the foregoing paragraph is true and correct.

WITNESS my hand and official seal.

Signature

A handwritten signature in blue ink that reads 'Meghan Hanes'. The signature is written in a cursive style and is positioned over the printed text 'Signature of Notary Public'.

Signature of Notary Public



**Limited Power of Attorney**

BrightView Holdings, Inc. of 980 Jolly Road, Blue Bell, PA 19422, Federal Employer Tax Identification Number 46-4190788, hereby constitutes and appoints, jointly and severally, the following employees of certain subsidiaries of Aon plc ("Aon"), as identified below, its true and lawful attorney-in fact, only upon BrightView's prior written consent, to execute and apply a corporate seal to all surety bonds issued on behalf of each of the subsidiaries of BrightView Holdings, Inc. listed on Exhibit A attached hereto:

**Aon Employee**

**Los Angeles**  
Meghan Hanes  
Rosa Rivas  
Tracy Aston

**Philadelphia**  
George Gionis  
Sara Owens  
Sean Dent

**New York**  
Frances Rodriguez

**Chicago**  
Jennifer L. Jakaitis  
Nicholas Kertesz

**Aon Subsidiary**

**Aon Risk Services West, Inc.**

**Aon Risk Services Northeast, Inc.**

**Aon Risk Services Northeast, Inc.**

**Aon Risk Services Central, Inc.**

This Power-of-Attorney shall become effective upon the signing of this document and shall remain in effect until terminated by either party upon ten (10) days written notice.

IN WITNESS WHEREOF, the signing party below affirms his/her authority to sign this Designation of Representative and grant the powers contained therein.

Dated: February 14, 2022

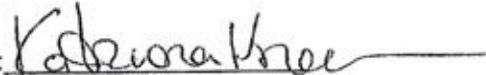
By:   
Name: Katriona Knaus  
Title: Treasurer

Sworn to and subscribed before me  
this 14<sup>th</sup> day of February 2022

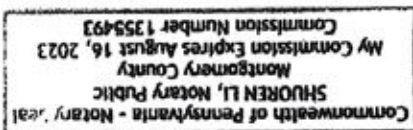

Exhibit A

BrightView Landscape Services, Inc. (California)  
BrightView Landscape Services, Inc. (Texas)  
BrightView Landscape Services, Inc. (Arizona)  
BrightView Landscape Services, Inc. (Colorado)  
BrightView Landscape Services, Inc. (Florida)  
BrightView Landscape Services, Inc. (Georgia)  
BrightView Landscape Services, Inc. (Nevada)  
BrightView Landscapes, LLC  
BrightView Tree Care Services, Inc.  
BrightView Golf Maintenance, Inc.





**RFP No. 2022-008**  
**Citywide Landscape Maintenance**  
**Section II, III, IV**

# EXPERIENCE AND QUALIFICATIONS

- **Names:** BrightView Landscape Services, Inc.  
BrightView Landscapes, LLC  
BrightView Enterprise Solutions, LLC

- **South Florida Office Locations:**

## 8191 NW 84<sup>th</sup> Street Medley

- 270 Gardeners
- 22 Supervisors
- 20 Certified Technicians

## 2711 SW 36<sup>th</sup> Street Dania Beach

- 200 Gardeners
- 17 Supervisors
- 8 Certified Technicians

## 6941 SW 196<sup>th</sup> Ave Pembroke Pines

- 150 Gardeners
- 10 Supervisors
- 4 Certified Technicians

## 440 Sawgrass Corporate Parkway Sunrise

- 180 Gardeners
- 9 Supervisors
- 5 Certified Technicians

- **Website:** <https://www.brightview.com/>

- **Business Structure:** Corporation

- **Date Founded:** 1939

- **Home:** 980 Jolly Rd #300, Blue Bell, PA 19422  
(484) 567-7204

- **Local:** 2711 SW 36<sup>th</sup> Street Fort Lauderdale, FL 33312  
(954) 431-1111

- **Outstanding Litigation:** None Outstanding and nothing to jeopardize the performance of this contract. In the ordinary course of our long history as a nation-wide provider of landscaping services, we have been involved in legal proceedings relating to our business.

- **Implement Services Time:** within 30 days



# RFP Q & A

## Company Overview

BrightView provides services ranging from landscape maintenance and enhancements to tree care and landscape development for thousands of customers' properties, including corporate and commercial properties, HOAs, public parks, hotels and resorts, hospitals and other healthcare facilities, educational institutions, restaurants and retail, and golf courses, among others. BrightView is the Official Field Consultant to Major League Baseball and the largest provider in the industry. 45-50% of our business is community associations.

## History

In 2014, Brickman Group, founded in 1939, and ValleyCrest Landscape, founded in 1949, merged and unveiled their new name as BrightView. The name BrightView was created to honor the organization's legacy brands, founders and people by carrying forward the "B" from Brickman and the "V" from ValleyCrest. BrightView Holdings Inc. is publicly traded under [BV](#).

*"BrightView reflects our optimism for the future and our drive to create greater value for our clients. It embodies our excitement to leverage the strengths of our combined company to enhance how we care for our people, our clients and our communities. It also enables our team members and clients to take pride in trusted relationships and solutions that matter."*

## Mission

BrightView is the nation's leading commercial landscape company. We take pride in delivering consistently excellent results for clients across the country, throughout the lifecycle of their landscapes. From landscape design to development, maintenance to enhancements, our comprehensive services make your job easy.

### 2021 Lawn & Landscape Top 100:

\* INDICATES NEW TO THE LIST

2021 Rank	Company	2020 Rank	2020 Revenue	Headquarters	Employees
1	BrightView	1	\$2,346,000,000	Blue Bell, Pa.	21,000
2	TruGreen	2	\$1,400,000,000	Memphis, Tenn.	13,570
3	The Davey Tree Expert Company	3	\$1,287,552,000	Kent, Ohio	10,300



# CURRENT AND PRIOR EXPERIENCE

BrightView is the nation's leading commercial landscape company. We take pride in delivering consistently excellent results for clients across the country, throughout the lifecycle of their landscapes.

Project Name: Right of ways, Medians, Facilities & Parks landscape Maintenance

Owner: City of Miramar

Contract Amount: \$250,000 (+)

Percentage complete: 100%

Percentage of subcontracted work: 0%

Project Name: Landscape Maintenance of medians, right of ways, swales, common areas of the POA

Owner: Harbor Islands POA

Contract Amount: \$1,400,000 (+)

Percentage complete: 50%

Percentage of subcontracted work: 0%

Project Name: Landscape Maintenance of Boardwalks, Medians & Bumpouts

Owner: City of Miami Beach

Contract Amount: \$1,000,000 (+)

Percentage complete: 100%

Percentage of subcontracted work: 0%

Project Name: Landscape Maintenance of medians, right of ways, swales, common areas of the Town

Owner: Town of Surfside

Contract Amount: \$400,000 (+)

Percentage complete: 90%

Percentage of subcontracted work: 0%

Project Name: Landscape Maintenance of medians, right of ways, swales, common areas

Owner: Ocean Reef Community Association

Contract Amount: \$1,500,000 (+)

Percentage complete: 70%

Percentage of subcontracted work: 0%

Project Name: Landscape Maintenance of Parks, Sports Turf

Owner: Town of Miami Lakes

Contract Amount: \$400,000 (+)

Percentage complete: 60%

Percentage of subcontracted work: 0%

Project Name: Landscape Maintenance of Parks, Sports Turf

Owner: City of Weston

Contract Amount: \$1,000,000 (+)

Percentage complete: 40%

Percentage of subcontracted work: 0%

Project Name: Landscape Maintenance of Parks, Sports Turf

Owner: Town of N Miami Beach

Contract Amount: \$400,000 (+)

Percentage complete: 70%

Percentage of subcontracted work: 0%

Project Name: Landscape Maintenance of ROW's, Biscayne Blvd, Parks, Sports Turf

Owner: City of Aventura

Contract Amount: \$2,000,000 (+)

Percentage complete: 50%

Percentage of subcontracted work: 0%

# HOW WE MAKE A DIFFERENCE

When you partner with BrightView, you have our commitment that we will manage your property and complete work on time and within budget. We provide the right equipment and manpower to perform any landscape project. Our team will take the same ownership, pride in the community and having all local area team members will keep the site in consistently looking like the residents expect. **Included in our price are services that are a resource to the community and are of no additional charge for selecting BrightView as your trusted landscape advisor.**

## ✓ COMPANY HISTORY | LEGACY

80+ years in the landscape industry: Design | Develop | Maintain | Enhance

## ✓ ACTION PLAN | HORTICULTURAL ASSESSMENT | LANDSCAPE REPORT

BrightView follows a written step by step process of how the management of your landscape requirements will be executed.

## ✓ TRAINED SKILLED CLIENT SERVICE TEAMS

800+ Employees in South Florida Trained and Skilled in all levels of landscape management

## ✓ TENURE OF MANAGEMENT STAFF

Un-Matched Sixteen (16) year average management tenure in our South Florida Branches.

## ✓ IN HOUSE TECHNICAL SERVICE

All of the technical services with regard to managing your landscape will require no third party involvement. BrightView reduce exposure to liabilities

## ✓ COMMUNICATION REPORTING TOOLS

A Quality Services Assessment report is provided to you , Irrigation Reports, Fertilization and Lawn and Ornamental Pest reports. Log of our Service Activities

## ✓ DIGITAL ENHANCEMENTS

4 Local Landscape Designers to provide renderings of landscape improvements

## ✓ EMERGENCY STORM PLANNING

With over 3000 employees in Florida we have proven that we are uniquely qualified to mobilize for hurricane recovery.

# Committed to Your Success at Every Stage of Your Landscape

## Design

Forward-thinking, constructible design that considers future operating costs



**One Partner**  
to take care of you and all your landscape needs.

## Develop

Seamless project delivery that meets your goals and long-term expectations, on-time and on-budget

## Enhance

Thoughtful improvements to enrich your landscape's appearance and sustainability

## Maintain

Consistent service delivery and proactive solutions that keep your property at its best, now and in the future

### Design

- Landscape Architecture & Planning
- Design-Build
- Program Management

### Develop

- Planting
- Hardscapes
- Pools & Water Features
- Compliance
- Tree Growing & Moving

### Maintain

- Landscape
- Tree Care
- Snow & Ice
- Specialty Turf
- Exterior Maintenance

### Enhance

- Enhancements
- Sustainability
- Water Management



# CITY OF CORAL GABLES KEY PERSONNEL

**Your point of contact:** Account Manager Davis Mendoza. Davis currently manages landscape maintenance business for Baptist Hospital. Davis has been involved in maintenance, agronomics and irrigation services within all of his property responsibilities. Mr. Mendoza has been part of the BrightView family for over 3 years and has over 15 years experience in the industry.

**Key Responsibilities:** Armando will be the main point of contact. He will oversee the production manager, the irrigation technician, and the chemical technician. He will also work hand-in-hand with the certified arborist, the arbor crew and will coordinate our enhancement manager for the large projects. He will be holding weekly meetings with the key personnel to make sure that items from our Quality Site Assessment are being addressed on a regular basis and to make sure we are exceeding Community Expectations.

**Additional contact:** Branch Manager Jenna Crawford. Jenna currently manages landscape maintenance business throughout Miami. Jenna has been involved in maintenance, agronomics and irrigation services within her responsibilities. Mrs Crawford has 13 years experience in the industry and is a graduate of horticulture from Kansas State University

**Key Responsibilities:** Jenna will ensure Davis and his team are performing to property expectations. With regular walks of the site, she will assist in the quality site assessments that make your landscape site thrive.





# PEMBROKE FALLS SERVICE SUPPORT

## Enhancement Manager

Ramiro Fernandez is the Enhancement Manager for our South Florida Branches. Ramiro has been involved in maintenance and irrigation management throughout the years, but his true passion is landscape design, renovation and installation. Mr. Fernandez has been part of the BrightView family for over 15 years and has more than 20 years' experience in the industry.

Ramiro has been running the Enhancement Division for BrightView for over 8 years now and has provided major renovations for partners like City of Weston, Williams Island, West Lake Village, Forest Ridge, etc. Outside of work Ramiro spends most of his time with his six children and when he does find a little free time he is working on cars as he 'has a need for speed'.



## Irrigation Manager

**Qualifications:** Carlos Victoria has over 29 years working in the construction / Irrigation industry. As founder of Victoria Construction (1993) and Central Irrigation (2007) has provided him a wide range of experience in the Construction and Irrigation field. With a passion for the irrigation industry, Carlos came on board to ValleyCrest today's (Brightview Landscape Maintenance) in 2009. Today, he serves as the South Florida Regional irrigation Advisor for the company. As an Irrigation contractor/designer, he has developed interest in the water conservation field, becoming a leader using smart irrigation advanced technology for water conservation purposes.

General Contractor NY lic: H-07073  
Lawn Sprinkler License Miami FL: 07P000163 Lawn sprinkler  
License Broward : cc# 08-CLS-14754-R  
Backflow Tester License: H-03178  
State of Florida Plumbing License: CFC1429383

**Education:** Carlos Victoria has received an engineering degree from CUNY University and currently possess and holds various contracting licenses in the State of FL and NY. Currently he is a Member of the Irrigation Association and other irrigation affiliations.



# ISA CERTIFIED ARBORISTS

Certification is available to those who meet predetermined and standardized criteria for knowledge, skills, or competencies. The knowledge needed to pass a Certification assessment is learned through self-study and experience. The assessment is conducted independent of a specific class, course, or other training program. To retain the credential, certificates must meet requirements for renewal.

- ✓ Experience includes both instruction and assessment as part of the program
- ✓ Tests specific knowledge, skills, or competencies associated with learning outcomes
- ✓ Awards a Qualification only to those participants who meet the standards for performance, proficiency, or passing score
- ✓ Allows trainers to know and be familiar with the assessment questions
- ✓ Permits trainers to assess their own trainees, depending on the requirements of a given program
- ✓ Requires credential holders to retrain and retest at the end of a set period of validity, unless qualification is determined to be valid for life



Corine M. Ferré



Jason Anderson



[BrightView Tree Care Service Hollywood](#)  
(*hyperlink*)



## PERSONNEL Job Descriptions

Branch Manager – Jenna Crawford– Oversees all Branch operations within including labor, equipment, customer service, safety and all administrative functions.

Assistant Branch Manager – – Oversee Branch Account Manager to ensure quality and labor

Office Manager – Maria Fundora – Implements the day-to-day tasks of managing customer service, directing calls, billing, and emergencies.

Sr. Account Manager / Program Managers - As the primary customer contact, the AM develops and maintains schedules for maintenance work and ensures compliance to job specifications and quality control standards; proactively communicates to customer and BrightView team members.

Crew Leader – Schedules the workload for their crew and ensures the readiness of workers, tools and materials.; maintains safe-working conditions at all times, including job site and crew operation.

Agronomic Technicians –The agronomic technician is licensed and knowledgeable in the safe application of fertilizers, insecticides, herbicides, and fungicides.

Enhancement Manager – Ramiro Fernandez Designs and selects premium Plants for renovations; purchases plant materials and prepares project for installation; monitors proper planting procedures and color over the life of the project.

Irrigation Technicians – Carlos Victoria Monitors inspections, irrigation checks, cleaning, repairs, and adjusting of your irrigation system; generates reports to identify repairs, consumption use requirements, and upgrades.

Irrigation Assistant – Assists in the daily management of the irrigation system and performs repairs and adjustments, and monitors malfunctions and potential leaks.

Arbor Manager – Jason Anderson assists in the

Trained Gardeners – Responsible for daily compliance of job specifications and quality standards; knowledgeable in all materials, equipment, and safety programs; proactively deals with potential problems, ensures safe working conditions at job site and identifies potential liabilities on the property.

# CORAL GABLES SERVICE TEAM

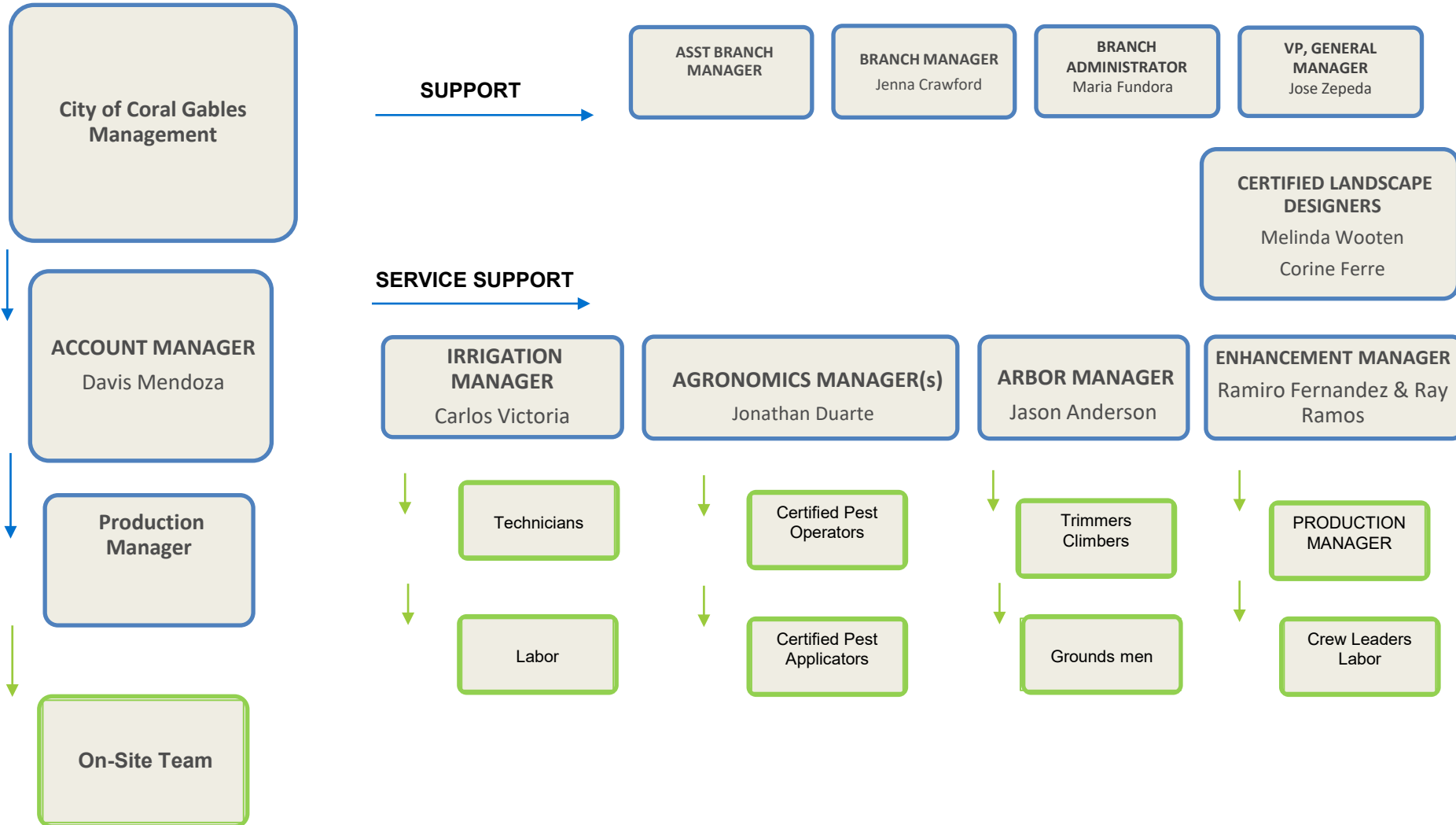

# Company Information Continued

## • PROOF OF INSURANCE



### CERTIFICATE OF LIABILITY INSURANCE

DATE(MM/DD/YYYY)  
02/05/2020

THIS CERTIFICATE IS ISSUED AS A MATTER OF INFORMATION ONLY AND CONFERS NO RIGHTS UPON THE CERTIFICATE HOLDER. THIS CERTIFICATE DOES NOT AFFIRMATIVELY OR NEGATIVELY AMEND, EXTEND OR ALTER THE COVERAGE AFFORDED BY THE POLICIES BELOW. THIS CERTIFICATE OF INSURANCE DOES NOT CONSTITUTE A CONTRACT BETWEEN THE ISSUING INSURER(S), AUTHORIZED REPRESENTATIVE OR PRODUCER, AND THE CERTIFICATE HOLDER.

**IMPORTANT:** If the certificate holder is an ADDITIONAL INSURED, the policy(ies) must have ADDITIONAL INSURED provisions or be endorsed. If SUBROGATION IS WAIVED, subject to the terms and conditions of the policy, certain policies may require an endorsement. A statement on this certificate does not confer rights to the certificate holder in lieu of such endorsement(s).

<b>PRODUCER</b> Aon Risk Services Northeast, Inc. New York NY Office One Liberty Plaza 165 Broadway, Suite 3201 New York NY 10006 USA	<b>CONTACT NAME:</b> PHONE (A/C. No. Ext): (866) 283-7122      FAX (A/C. No.): (800) 363-0105		
	<b>E-MAIL ADDRESS:</b>		
<b>INSURER(S) AFFORDING COVERAGE</b>		<b>NAIC #</b>	
<b>INSURED</b> BrightView Landscape Services, Inc. 980 Jolly Road Suite 300 Blue Bell PA 19422 USA	INSURER A: ACE American Insurance Company		22667
	INSURER B: American Guarantee & Liability Ins Co		26247
	INSURER C:		
	INSURER D:		
	INSURER E:		

**COVERAGES**      **CERTIFICATE NUMBER:** 570080462572      **REVISION NUMBER:**

THIS IS TO CERTIFY THAT THE POLICIES OF INSURANCE LISTED BELOW HAVE BEEN ISSUED TO THE INSURED NAMED ABOVE FOR THE POLICY PERIOD INDICATED. NOTWITHSTANDING ANY REQUIREMENT, TERM OR CONDITION OF ANY CONTRACT OR OTHER DOCUMENT WITH RESPECT TO WHICH THIS CERTIFICATE MAY BE ISSUED OR MAY PERTAIN, THE INSURANCE AFFORDED BY THE POLICIES DESCRIBED HEREIN IS SUBJECT TO ALL THE TERMS, EXCLUSIONS AND CONDITIONS OF SUCH POLICIES. LIMITS SHOWN MAY HAVE BEEN REDUCED BY PAID CLAIMS. Limits shown are as requested

INSR LTR	TYPE OF INSURANCE	ADDL INSD	SUBR WVR	POLICY NUMBER	POLICY EFF (MM/DD/YYYY)	POLICY EXP (MM/DD/YYYY)	LIMITS
A	<input checked="" type="checkbox"/> COMMERCIAL GENERAL LIABILITY <input type="checkbox"/> CLAIMS-MADE <input checked="" type="checkbox"/> OCCUR <input checked="" type="checkbox"/> Pesticide/Herbicide Applicator Coverage GEN'L AGGREGATE LIMIT APPLIED PER: <input type="checkbox"/> POLICY <input checked="" type="checkbox"/> PROJECT <input checked="" type="checkbox"/> LOC OTHER:			XSLG71078383 SIR applies per policy terms & conditions	10/01/2019	10/01/2020	EACH OCCURRENCE \$2,000,000 DAMAGE TO RENTED PREMISES (Ea occurrence) \$2,000,000 MED EXP (Any one person) \$10,000 PERSONAL & ADV INJURY \$2,000,000 GENERAL AGGREGATE \$4,000,000 PRODUCTS - COM/PROP AGG \$4,000,000
A	<input checked="" type="checkbox"/> AUTOMOBILE LIABILITY <input checked="" type="checkbox"/> ANY AUTO <input type="checkbox"/> OWNED AUTOS ONLY <input type="checkbox"/> HIRED AUTOS ONLY <input type="checkbox"/> SCHEDULED AUTOS <input type="checkbox"/> NON-OWNED AUTOS ONLY			ISA H09093722	10/01/2019	10/01/2020	COMBINED SINGLE LIMIT (Ea accident) \$5,000,000 BODILY INJURY (Per person) BODILY INJURY (Per accident) PROPERTY DAMAGE (Per accident)
B	<input checked="" type="checkbox"/> UMBRELLA LIAB <input checked="" type="checkbox"/> OCCUR <input type="checkbox"/> EXCESS LIAB <input type="checkbox"/> CLAIMS-MADE <input type="checkbox"/> DED <input type="checkbox"/> RETENTION			AUC508596815	10/01/2019	10/01/2020	EACH OCCURRENCE \$3,000,000 AGGREGATE \$3,000,000
A	WORKERS COMPENSATION AND EMPLOYERS' LIABILITY ANY PROPRIETOR / PARTNER / EXECUTIVE OFFICER/OWNER EXCLUDED? (Mandatory in NH) If yes, describe under DESCRIPTION OF OPERATIONS below			WLRC50800179 WC - AOS SCFC50800192 WC - WI	10/01/2019	10/01/2020	<input checked="" type="checkbox"/> PER STATUTE <input type="checkbox"/> OTH E.L. EACH ACCIDENT \$2,000,000 E.L. DISEASE-EA EMPLOYEE \$2,000,000 E.L. DISEASE-POLICY LIMIT \$2,000,000

Holder Identifier :

Certificate No : 570080462572

DESCRIPTION OF OPERATIONS / LOCATIONS / VEHICLES (ACORD 91, Additional Remarks Schedule, may be obtained if more space is required)  
Evidence of Insurance.

CANCELLATION

SHOULD ANY OF THE ABOVE DESCRIBED POLICIES BE CANCELLED BEFORE THE EXPIRATION DATE THEREOF, NOTICE WILL BE DELIVERED IN ACCORDANCE WITH THE POLICY PROVISIONS.  
  
 AUTHORIZED REPRESENTATIVE

BrightView Landscape Services, Inc.  
980 Jolly Road, Suite 300  
Blue Bell PA 19422 USA

©1988-2015 ACORD CORPORATION. All rights reserved. The ACORD name and logo are registered marks of ACORD. ACORD 25 (2016/03)





# STATE OF FLORIDA CORPORATION

**2020 FLORIDA PROFIT CORPORATION ANNUAL REPORT**

DOCUMENT# K51636

**Entity Name:** BRIGHTVIEW LANDSCAPE SERVICES, INC.

**Current Principal Place of Business:**

980 JOLLY ROAD  
SUITE 300  
BLUE BELL, PA 19422

**Current Mailing Address:**

980 JOLLY ROAD  
SUITE 300  
BLUE BELL, PA 19422 US

**FEI Number:** 95-4194223

**Name and Address of Current Registered Agent:**

CT CORPORATION SYSTEM  
1200 S PINE ISLAND RD  
PLANTATION, FL 33324 US

**Certificate of Status Desired:** No

*The above named entity submits this statement for the purpose of changing its registered office or registered agent, or both, in the State of Florida.*

**SIGNATURE:**

Electronic Signature of Registered Agent

Date

**Officer/Director Detail :**

**Title** GENERAL MANAGER  
**Name** ZEPEDA, JOSE  
**Address** 980 JOLLY ROAD  
SUITE 300  
**City-State-Zip:** BLUE BELL PA 19422

**Title** ASSISTANT TREASURER  
**Name** WILKINSON, TIMOTHY  
**Address** 980 JOLLY ROAD  
SUITE 300  
**City-State-Zip:** BLUE BELL PA 19422

**Title** ASSISTANT TREASURER  
**Name** KNAUS, KATRIONA  
**Address** 980 JOLLY ROAD  
SUITE 300  
**City-State-Zip:** BLUE BELL PA 19422

**Title** CEO  
**Name** HEROLD, JEFF  
**Address** 980 JOLLY ROAD  
SUITE 300  
**City-State-Zip:** BLUE BELL PA 19422

**Title** VP  
**Name** ZEPEDA, JOSE  
**Address** 980 JOLLY ROAD  
SUITE 300  
**City-State-Zip:** BLUE BELL PA 19422

**Title** ASSISTANT SECRETARY  
**Name** DESANTIS, SUSAN  
**Address** 980 JOLLY ROAD  
SUITE 300  
**City-State-Zip:** BLUE BELL PA 19422

**Title** DIRECTOR  
**Name** MASTERMAN, ANDREW  
**Address** 980 JOLLY ROAD  
SUITE 300  
**City-State-Zip:** BLUE BELL PA 19422

**Title** PRESIDENT  
**Name** HEROLD, JEFF  
**Address** 980 JOLLY ROAD  
SUITE 300  
**City-State-Zip:** BLUE BELL PA 19422

**Continues on page 2**

**Officer/Director Detail Continued :**

**Title** DIRECTOR  
**Name** HEROLD, JEFF  
**Address** 980 JOLLY ROAD  
SUITE 300  
**City-State-Zip:** BLUE BELL PA 19422

**Title** VP  
**Name** GONZALEZ, CHARLES  
**Address** 980 JOLLY ROAD  
SUITE 300  
**City-State-Zip:** BLUE BELL PA 19422

**Title** SECRETARY  
**Name** GOTTSEGEN, JONATHAN  
**Address** 980 JOLLY ROAD  
SUITE 300  
**City-State-Zip:** BLUE BELL PA 19422

**Title** ASSISTANT SECRETARY  
**Name** KUEHN, TOMAS  
**Address** 980 JOLLY ROAD  
SUITE 300  
**City-State-Zip:** BLUE BELL PA 19422

**Title** VP  
**Name** ANDERSON, JOHN  
**Address** 980 JOLLY ROAD  
SUITE 300  
**City-State-Zip:** BLUE BELL PA 19422

**Title** TREASURER  
**Name** TYLER, ROBERT  
**Address** 980 JOLLY ROAD  
SUITE 300  
**City-State-Zip:** BLUE BELL PA 19422

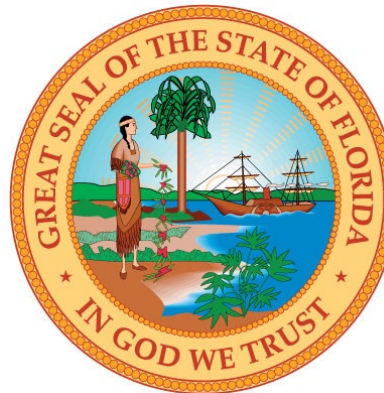

*I hereby certify that the information indicated on this report or supplemental report is true and accurate and that my electronic signature shall have the same legal effect as if made under oath; that I am an officer or director of the corporation or the receiver or trustee empowered to execute this report as required by Chapter 607, Florida Statutes; and that my name appears above, or on an attachment with all other like empowered.*

**SIGNATURE:** JONATHAN GOTTSEGEN

**SECRETARY**

**05/22/2020**

Electronic Signature of Signing Officer/Director Detail

Date

**Local Business Tax Receipt**  
Miami-Dade County, State of Florida  
-THIS IS NOT A BILL - DO NOT PAY



6137442

**RECEIPT NO.**  
RENEWAL  
95349

**BUSINESS NAME/LOCATION**  
BRIGHTVIEW LANDSCAPE  
SERVICES INC  
4155 E MOWRY DR  
HOMESTEAD, FL 33033

**EXPIRES**  
**SEPTEMBER 30, 2022**  
Must be displayed at place of business  
Pursuant to County Code  
Chapter 8A - Art. 9 & 10



**OWNER**  
BRIGHTVIEW LANDSCAPE  
SERVICES INC  
Employee(s) 500

**SEC. TYPE OF BUSINESS**  
213 SERVICE BUSINESS  
JF235005

**PAYMENT RECEIVED  
BY TAX COLLECTOR**  
2250.00 09/08/2021  
INT-21-377583

**This Local Business Tax Receipt only confirms payment of the Local Business Tax. The Receipt is not a license, permit, or a certification of the holder's qualifications, to do business. Holder must comply with any governmental or nongovernmental regulatory laws and requirements which apply to the business.**

**The RECEIPT NO. above must be displayed on all commercial vehicles - Miami-Dade Code Sec 8a-276.  
For more information, visit [www.miamidade.gov/taxcollector](http://www.miamidade.gov/taxcollector)**



U.S. Citizenship  
and Immigration  
Services

10/23/2009

# FINANCIAL STATUS

BrightView is a publically traded company: [www.brightview.com](http://www.brightview.com)

Fiscal 2020 Results – Total BrightView  
Total BrightView - Operating Highlights

	Three Months Ended June 30,			Nine Months Ended June 30,		
	2020	2019	Change	2020	2019	Change
Revenue	\$ 608.1	\$ 657.2	(7.5%)	\$ 1,737.9	\$ 1,779.9	(2.4%)
Net (Loss) Income	\$ (2.4)	\$ 31.7	(107.6%)	\$ (35.5)	\$ 19.3	(283.9%)
Net (Loss) Income Margin	(0.4)%	4.8%	(520) bps	(2.0)%	1.1%	(310) bps
Adjusted EBITDA	\$ 91.0	\$ 101.9	(10.7%)	\$ 181.6	\$ 213.1	(14.8%)
Adjusted EBITDA Margin	15.0%	15.5%	(50) bps	10.4%	12.0%	(160) bps
Adjusted Net Income	\$ 44.0	\$ 47.0	(6.4%)	\$ 56.5	\$ 73.1	(22.7%)
(Loss) Earnings per Share, GAAP	\$ (0.02)	\$ 0.31	106.5%	\$ (0.34)	\$ 0.19	278.9%
Earnings per Share, Adjusted	\$ 0.42	\$ 0.46	(8.7%)	\$ 0.55	\$ 0.71	(22.5%)
Weighted average number of common shares outstanding	103.8	102.8	1.0%	103.6	102.7	0.9%

# LICENSES & CERTIFICATIONS

- ATSSA Certified - Temporary Traffic Control Supervisor
- American Red Cross AED/CPR/ First Aid
- American Red Cross AED/CPR/ First Aid Instructor
- OSHA 10 Card – Construction Safety and Health
- FL Pesticide Applicator Certificate – Registered Tech
- VCLM – Excavation Safety – Competent Person Training
- VCLM – Forklift Safety – Trainer
- VCLM Fall Protection Training
- VCLM Fall Protection – Competent Person /Trainer
- Pesticide Applicator Certificate for Lawn and Ornamentals
- ISA Certified Arborist
- FL Licensed Tree Expert
- ISA Certified Arborist
- Certified Tree Risk Assessor
- Florida Certified Horticulturist
- Florida Certified Pesticide Applicator
- Certified Irrigation Contractor and Certified Landscape Irrigation Auditor by the Irrigation Association which is a national certifying body for the irrigation industry.
- Average of 30 years of experience in the green industry
- Degreed horticulturalist
- Masters of Business Administration



**American  
Red Cross**  
Training Services

STATE OF FLORIDA DEPARTMENT OF TRANSPORTATION



**Temporary Traffic Control  
(Maintenance of Traffic)  
Training Handbook**

OFFICE OF DESIGN - ROADWAY STANDARDS SECTION  
JANUARY 2016  
TALLAHASSEE, FLORIDA



**FEMA**

**OSHA**<sup>®</sup>  
Occupational Safety  
and Health Administration



**NATIONAL  
ASSOCIATION OF  
LANDSCAPE  
PROFESSIONALS**



**BrightView**<sup>™</sup>  
Landscape Services

3

# MISC LICENSES

## Certificate of Completion

**Steve A. Zamore**

**Has Completed a Florida Department of Transportation Approved Temporary Traffic Control (TTC) Advanced Course.**

04/05/2023	140	Messler R. Gilchrist	49944
Date Expires	FDOT Provider #	Instructor	Certificate #



Metro Florida Safety Council  
Tri-County  
Dade, Broward, Palm Beach,  
metrofloridasafetycouncil.com  
mlyons@metrofloridasafetycouncil.com



For more information about Temporary Traffic Control (TTC) or to verify this certificate  
[www.moladmin.com](http://www.moladmin.com)

### ValleyCrest Companies

#### AERIAL RESCUE SAFETY

Verification of participation and satisfactory completion of the use and safe operation of the Aerial Rescue Safety Training.

Participant: Peter Olmedo  
Facilitator: William Scully  
Date: May 6, 2013



This Certifies that  
**Peter Olmedo**

Has Completed a Florida Department of Transportation Approved Maintenance of Traffic (MOT) Intermediate Course.

Date Expires 01/08/2020      Certificate # 13481  
Instructor Michael A. Hard      FDOT Provider # 15

United Safety Council  
Phone: 407-897-4456  
1505 E. Colonial Drive  
Orlando, FL  
unitedsafetycouncil.com  
gvictor@floridasafety.org



### ValleyCrest Companies

#### EHAP TRAINING

Verification of participation and satisfactory completion of the use and safe operation of the Electrical Hazard Awareness Program.

Participant: Peter Olmedo  
Facilitator: William Scully  
Date: May 6, 2013

### ValleyCrest Companies

#### AERIAL LIFT OPERATOR TRAINING

Verification of participation and satisfactory completion of the use and safe operation of the Aerial Lift Operator Training.

Participant: Peter Olmedo  
Facilitator: William Scully  
Date: May 6, 2013

STATE OF FLORIDA  
Department of Agriculture and Consumer Services  
BUREAU OF LICENSING AND ENFORCEMENT

**GOEUARA C JULIO**  
BRIGHTVIEW LANDSCAPING SERVICES INC  
ID CARD HOLDER

**JE283014**

HAS PAID THE FEE REQUIRED BY CHAPTER 482 FOR THE PERIOD  
EXPIRING **December 31, 2020**

*Nicole Fred*      Signature  
COMMISSIONER      ATTACH PHOTO ON REVERSE

Wallet Card - Fold Here

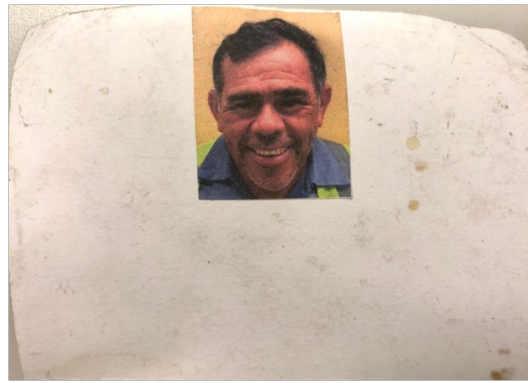



# PEST LICENSES

STATE OF FLORIDA  
Department of Agriculture and Consumer Services  
BUREAU OF LICENSING AND ENFORCEMENT

Date	File No	Expires
June 18, 2020	JF238715	June 1, 2021

THE CERTIFIED PEST CONTROL OPERATOR NAMED BELOW HAS REGISTERED UNDER THE PROVISIONS OF CHAPTER 482 FOR THE PERIOD EXPIRING: June 1, 2021

Lawn and Ornamental

JEAN BEAUVAIS  
7660 JUNIPER STREET  
MIRAMAR, FL 33023

*Nicole Fried*  
NICOLE "NIKKI" FRIED, COMMISSIONER

STATE OF FLORIDA  
Department of Agriculture and Consumer Services  
BUREAU OF LICENSING AND ENFORCEMENT

**JEAN BEAUVAIS  
CERTIFIED PEST CONTROL OPERATOR**

**JF238715**

HAS PAID THE FEE REQUIRED BY CHAPTER 482 FOR THE PERIOD EXPIRING June 1, 2021

*Nicole Fried* Signature  
COMMISSIONER

Wallet Card  
Wallet Card - Fold Here

BUREAU OF LICENSING & ENFORCEMENT  
3125 CONNER BLVD. BLDG 8  
TALLAHASSEE, FLORIDA 32399-1650

STATE OF FLORIDA  
Department of Agriculture and Consumer Services  
BUREAU OF LICENSING AND ENFORCEMENT

Date	File No	Expires
March 4, 2020	JB173804	December 31, 2020

THE PEST CONTROL COMPANY FIRM NAMED BELOW HAS REGISTERED UNDER THE PROVISIONS OF CHAPTER 482 FOR THE PERIOD EXPIRING: December 31, 2020

AT

2711 SW 36 STREET  
DANIA BEACH, FL 33312

BRIGHTVIEW LANDSCAPING SERVICES INC  
2711 SW 36 STREET  
DANIA BEACH, FL 33312

Lawn and Ornamental

*Nicole Fried*  
NICOLE "NIKKI" FRIED, COMMISSIONER

STATE OF FLORIDA  
Department of Agriculture and Consumer Services  
BUREAU OF LICENSING AND ENFORCEMENT

Date	File No	Expires
March 19, 2018	LF217357	March 13, 2022

THE LTD COMMERCIAL FERTILIZER APPLICATOR HOLDER NAMED BELOW HAS REGISTERED UNDER THE PROVISIONS OF CHAPTER 482 FOR THE PERIOD EXPIRING: March 13, 2022

JEAN BEAUVAIS  
7660 JUNIPER STREET  
MIRAMAR, FL 33023

*Adam P. Punsam*  
ADAM H. PUNSAM, COMMISSIONER

STATE OF FLORIDA  
Department of Agriculture and Consumer Services  
BUREAU OF LICENSING AND ENFORCEMENT

**JEAN BEAUVAIS  
LTD COMMERCIAL FERTILIZER APPLICATOR HOLDER**

**LF217357**

HAS PAID THE FEE REQUIRED BY CHAPTER 482 FOR THE PERIOD EXPIRING March 13, 2022

*Adam P. Punsam* Signature  
COMMISSIONER

Wallet Card - Fold Here

BUREAU OF LICENSING & ENFORCEMENT  
3125 CONNER BLVD. BLDG 8  
TALLAHASSEE, FLORIDA 32399-1650



Ron DeSantis, Governor

Halsey Beshears, Secretary



**STATE OF FLORIDA**  
**DEPARTMENT OF BUSINESS AND PROFESSIONAL REGULATION**

**CONSTRUCTION INDUSTRY LICENSING BOARD**

THE IRRIGATION SPECIALTY CONTRACTOR HEREIN IS CERTIFIED UNDER THE  
PROVISIONS OF CHAPTER 489, FLORIDA STATUTES

**NAPOLEON, ANTHONY ROBERT**

LUKES-SAWGRASS LANDSCAPE  
2711 SW 36 SW 36 STREET  
DANIA BEACH FL 33312

**LICENSE NUMBER: SCC131151616**

**EXPIRATION DATE: AUGUST 31, 2022**

Always verify licenses online at [MyFloridaLicense.com](http://MyFloridaLicense.com)



Do not alter this document in any form.

This is your license. It is unlawful for anyone other than the licensee to use this document.



CERTIFICATE OF  
**ATTENDANCE**

PRESENTED TO  
**Carlos Victoria**  
FOR IA COURSE  
**Irrigation Contractor**  
16 IA CEUs  
December 4, 2010  
Phoenix, AZ

*Sherrie Schulte*  
Sherrie Schulte, CLIA  
Certification & Education Director

*Deborah M. Hamlin*  
Deborah M. Hamlin, CAE  
Executive Director



Contractors Exam School - CILB Provider # 0000862 With  
Contractors Continuing Education, Inc. - CILB Provider # 0004963  
Certify That

**Carlos Victoria**

Has successfully completed the following Continuing Education Programs:  
C=Workers Compensation, B=Business Practices, S=Workplace Safety,  
T= Technical, A=Advanced Module FA=False Alarm Prevention, LR=Laws and Rules,  
M=Wind Mitigation.  
All other hours are considered General

Course#	Title	Date	Hours
0610656	Legislative Changes Affecting the Con. Ind.	09/14/2021	7-C,B,S
0610654	Reinforcing Steel	09/15/2021	3-G
0610653	Hurricane Shutter Design	09/15/2021	1-G
0609078	Laws and Rules	09/15/2021	1-LR
0609082	Wind Mitigation Mythologies	09/15/2021	1-M
0609693	Advance FBC Module	09/15/2021	1-A

Total Hours: **14**

Marqate, Florida

[Location of Course]

**CFC1429383**

[Certified/ Registered Number]

Edgar J Gonzalez

[Edgar J. Gonzalez, G.M.]



**INSTITUTE FOR CROSS-CONNECTION**

IN MARGATE, FLORIDA  
CERTIFIES THAT

**Carlos Victoria**

Has successfully completed the high standards of the 40 hour Backflow Prevention Assembly Tester Training And Certification Course developed using accepted practices of the American Waterworks Association Guidelines as set forth in the AWWA Manual M14 in full compliance with the Florida Administrative Code and has met the requirements for voluntary certification as a

**BACKFLOW PREVENTION ASSEMBLY TESTER**

*Ray Bordner*  
ICC Lead Instructor



**H03178**

Date of Expiration  
July 16, 2019

For Renewal Call us at: (954) 971-5383  
www.IccBackflow.com

# IRRIGATION LICENSE



Luis Acosta, Certified Irrigation Technician  
BrightView Landscape Services  
Fort Lauderdale, FL

David Prado, Certified Irrigation Technician  
BrightView Landscape Services  
Miami, FL

Miguel Carmona, Certified Irrigation Technician  
BrightView Landscape Services  
Miami, FL

Joey Malvaes, Certified Irrigation Technician  
BrightView Landscape Services  
Miami, FL

<b>Licensee Information</b>		
	Name:	<b>VICTORIA, CARLOS MIGUEL (Primary Name)</b>
	Main Address:	<b>BRIGHTVIEW LANDSCAPE SERVICES, INC. (DBA Name)</b>
	County:	<b>8975 SOUTHWEST 198TH TERRACE</b>
	License Mailing:	<b>MIAMI Florida 33157</b>
		<b>DADE</b>
	LicenseLocation:	<b>4155 EAST MOWRY DRIVE</b>
	County:	<b>HOMESTEAD FL 33033</b>
		<b>DADE</b>
<b>License Information</b>		
	License Type:	<b>Certified Plumbing Contractor</b>
	Rank:	<b>Cert Plumbing</b>
	License Number:	<b>CFC1429383</b>
	Status:	<b>Current,Active</b>
	Licensure Date:	<b>09/17/2015</b>
	Expires:	<b>08/31/2022</b>
<b>Special Qualifications</b>	<b>Qualification Effective</b>	
	<b>Construction Business</b>	<b>09/17/2015</b>



# FNGLA CERTIFICATIONS

Name: Luis Perez  
Organization: BrightView Landscape Services  
Organization Phone: 1-407-292-9600  
Organization Email: www.brightview.com  
Certification: FNGLA Certified Landscape Technician  
Certified Since: 1/1/2007  
Certification Expiration Date: 9/30/2020

Name: Robert Marshall  
Organization: BrightView Landscape Services  
Organization Phone:  
Organization Email:  
Certification: FNGLA Certified Landscape Maintenance Technician  
Certified Since: 10/1/2008  
Certification Expiration Date: 12/31/2020

Name: Corine Ferre  
Organization: BrightView Landscape Services  
Organization Phone:  
Organization Email:  
Certification: FNGLA Certified Horticulture Professional  
Certified Since: 1/15/2004  
Certification Expiration Date: 3/31/2022

Name: Larry Lentz  
Organization: BrightView Landscape Services  
Organization Phone: 1-813-994-2309  
Organization Email: www.brightview.com  
Certification: Florida Water Star Accredited Professional  
Certified Since: 7/16/2014  
Certification Expiration Date: 3/31/2022

Name: Christian Martinez  
Organization: BrightView Landscape Services  
Organization Phone: 1-407-292-9600  
Organization Email: www.brightview.com  
Certification: FNGLA Certified Landscape Technician  
Certified Since: 8/9/2014  
Certification Expiration Date: 9/30/2020

Name: Corine Ferre  
Organization: BrightView Landscape Services  
Organization Phone:  
Organization Email:  
Certification: FNGLA Certified Landscape Designer  
Certified Since: 1/15/2004  
Certification Expiration Date: 3/31/2022

Name: Humberto Guevarez  
Organization: BrightView Landscape Services  
Organization Phone: 1-407-292-9600  
Organization Email: www.brightview.com  
Certification: FNGLA Certified Landscape Technician  
Certified Since: 9/15/2018  
Certification Expiration Date: 9/30/2021

Name: Daniel L. Kilmer  
Organization: Brightview Landscape Services  
Organization Phone: 1-703-444-1700  
Organization Email:  
Certification: FNGLA Certified Horticulture Professional  
Certified Since: 9/29/2005  
Certification Expiration Date: 12/31/2020

Name: Carlos R Sanchez  
Organization: BrightView Landscape Services  
Organization Phone: 1-813-297-4695  
Organization Email:  
Certification: FNGLA Certified Horticulture Professional  
Certified Since: 9/28/2018  
Certification Expiration Date: 9/30/2021

Name: Tyler Drew  
Organization: BrightView Landscape Services  
Organization Phone: 1-813-297-4695  
Organization Email:  
Certification: FNGLA Certified Horticulture Professional  
Certified Since: 11/21/2018  
Certification Expiration Date: 12/31/2021  
Expiration Date: 9/30/2021

Name: Daniel L. Kilmer  
Organization: BrightView Landscape Services  
Organization Phone: 1-813-297-4695  
Organization Email:  
Certification: FNGLA Certified Horticulture Professional  
Certified Since: 9/29/2005  
Certification Expiration Date: 12/31/2020

Name: Carlos R Sanchez  
Organization: BrightView Landscape Services  
Organization Phone: 1-954-817-7587  
Organization Email: www.brightview.com  
Certification: FNGLA Certified Horticulture Professional  
Certified Since: 9/28/2018  
Certification Expiration Date: 9/30/20

Name: Luke Facarazzo  
Organization: Lukes' Landscaping, Inc.  
Organization Phone: 1-954-431-1111  
Organization Email: www.lukeslandscapinginc.com  
Certification: FNGLA Certified Horticulture Professional  
Certified Since: 1/5/2019  
Certification Expiration Date: 12/31/2022

Name: Tim Harris  
Organization: BrightView Landscape Services  
Organization Phone: 1-407-292-9600  
Organization Email: www.brightview.com  
Certification: FNGLA Certified Landscape Contractor  
Certified Since: 11/5/1994  
Certification

Name: Anthony Napoleon  
Organization: Lukes' Landscaping, Inc.  
Organization Phone: 1-954-431-1111  
Organization Email: www.lukeslandscapinginc.com  
Certification: Florida Water Star Accredited Professional  
Certified Since: 9/24/2015  
Certification Expiration Date: 12/31/2021



# AGRICULTURE DEGREES

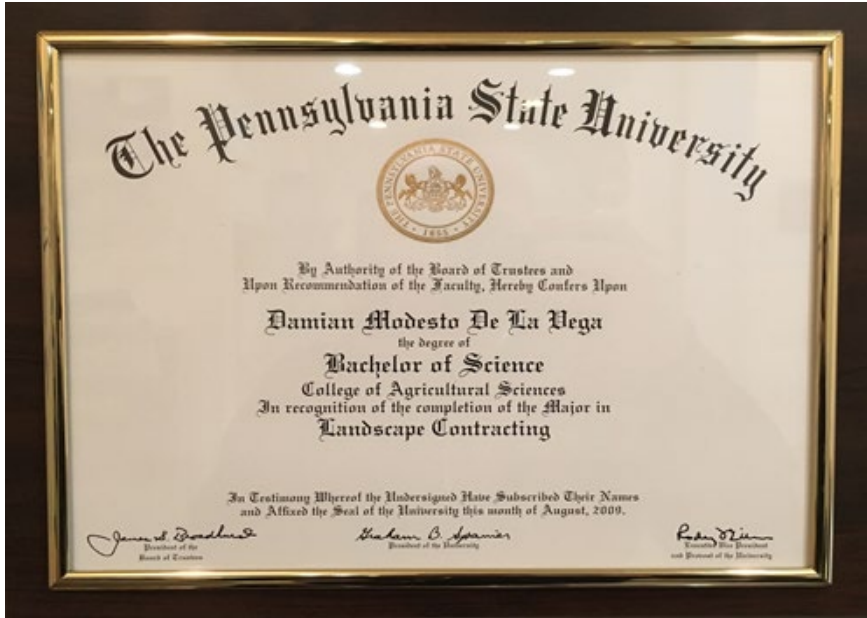

# BRIGHTVIEW'S APPROACH AND METHODOLOGY

Our Plan of Action is to make a difference within the first 3 months for The City of Coral Gables. Below is a list of action items we will focus on to make a visual impression.

## COMMUNICATION

Introduce the Account Manager, Client Services Team and walk the site together

- Determine your communication preferences
- Personalize a Monthly report of landscaping based on contract requirements
- Provide continued Pro-active and accountable communication

## SAFETY

- Identify all low hanging tree & palm limbs and trim.
- Trim all plant materials blocking line of sight at intersections and monuments
- Identify drainage problems and propose solutions
- Fix tripping hazards in the turf and hardscape

## IRRIGATION

- Obtain a full understanding of your current irrigation system.
- Create a map of the system showing locations of major components
- Review System for proper Plant Cover
- Recommend necessary repairs and upgrades

## SHRUBS AND BEDS

- Remove all existing weeds and invasive plant materials
- Hand Prune selected shrubs
- Remove plants too close to tree trunks, groundcover crowding shrubs, and poor performing plants
- Apply insect and disease control to treatable diseased plant material
- Provide nutrition to existing deficiencies of palms and shrubs as needed

## TURF

- Apply broadleaf weed control where necessary
- Apply pre-emergence weed control to suppress new weed growth
- We know the specific common problems associated with certain types of turf and we will prevent & monitor accordingly
- Provide nutrition to existing deficient areas

# EQUIPMENT LIST

This list is a representation of the equipment we have in the immediate area. As a \$2bn full-service landscape company with 21,000 employees, each branch is fully equipped to serve our clients, with multiple branches to pull from in the event backup equipment is needed. For jobs such as Heron Bay, we will maintain dedicated equipment for the site.

*\*\* Specific lists of equipment can be shared during the interview process.*

307066	312615952	52	Exmark	307083	A3G13936	Skid Steer T770	Bobcat	307722	1GCRCPEC9FZ431130	Silverado	Chevrolet
307067	XP107678	XP660 Altoz	Other	307084	AG0325293962181	Golf cart	Ez-Go	325462	JALC4J168G7K01333	NPR XD	Isuzu
307068	404821672	60	Exmark	307085	1GD412CG9CF102221	3500 Sierra	Chevrolet	325555	1TC648RACGT040142	48" QuickTrak Mower	John Deere
307069	316610776	60	Exmark	307086	307086	16' Flat Bed Trailer	Other	325556	1TC648RAVGT040117	48" QuickTrak Mower	John Deere
307070	315641126	52	Exmark	307088	THP20KAE523	60	Exmark	325558	1TC648RACGT040116	48" QuickTrak Mower	John Deere
307071	307071	Sod cutter	Bluebird	307089	1S9E01621G1303868	16' Open Trailer	Sun Coast	327050	1FD0W4GYXGEB65127	F450 DUMP	Ford
307072	255260	Z spray	Z Spray	307090	J8DC4J16367000177	W5500	GMC	327143	11130138	48" WB SK MOWER	Other
307074	316628364	60	Exmark	307091	312632260	60	Exmark	328885	1FMCU0GD4HUC19456	ESCAPE SE	Ford
307075	314643429	60	Exmark	307092	312624826	60	Exmark	331300	5F11S1017J1000942	15 Light Arrow Trailer	Wanco
307078	1UR2080H9K10	Track Loader CTX100	Vermeer	307094	1S9E01624G1303850	16' Open Trailer	Sun Coast	331816	5GLBE142XJC000317	Enclosed Trailer	Express
307081	ZS5260201681	Z spray	Z Spray	307095	5PVND8JP572S50109	Dump Truck - Hino	Other	332082	402865439	42" Mower	Exmark
								338943	55682	Kubota RTV500-H	Kubota



# CORAL GABLES EQUIPMENT





# CORAL GABLES EQUIPMENT





## AVAILABILITY

With dozens of locations across Florida and more than 3500 employees in the state, we can dispatch labor, equipment and materials faster than other landscape service provider.

Recruitment; Currently BrightView has a dedicated recruiting Team involve in 30 Horticulture and Agriculture Colleges throughout the United States and Puerto Rico. Some of these schools include University of Florida, Ohio State, Auburn, Penn State, Mississippi State and the University of Puerto Rico. Our internship and success retaining these individuals is unparallel in the Industry. BrightView also sponsors Scholarships and Industry training through recognized and accredited Landscape Associations.

### ✓ Value Delivery:

BrightView takes a practical, customer-focused approach to delivering landscape services. We pride ourselves on:

•**Delivering on our promises.** Satisfying customers is at the core of everything BrightView does. BrightView is fanatic about measuring and improving the way it creates and delivers upon client expectations.

•**Personal service based upon specific client needs.** BrightView trains, empowers, and provides incentives to local managers to make the decisions necessary to service and completely satisfy our customers. We strive to fully understand the needs of our customers and to address those needs with a personal level of service.

•**Treating our customers' dollars as if they were our own.** BrightView leverages its scale and expertise to drive down labor and material expenses and passes those savings through to its customers.

•**Anticipating and resolving problems before they arise.** With 70+ years in the landscape industry, a highly tenured workforce, and the best training in the business, BrightView prides itself on bringing the right expertise to bear on landscape problems and resolving problems right the first time.

BrightView has an unrivalled reputation in the private and public sector working successfully with owners, builders, developers and property managers to reshape the national landscape.



U.S. Citizenship  
and Immigration  
Services

- ✓ Ensure 100% compliance with all labor and immigration laws ,we are enrolled in E-Verify in all states in which we operate.



		<b>Weekly Safety Tailgate</b>	
Topic:	Proper Hydration	Date:	
Branch:		Delivered by:	

**THIS WEEKLY TRAINING MUST BE CONDUCTED WITH ALL CREW MEMBERS**

Water is important to the body at all times, but especially in hot weather. It keeps the body from overheating. When you work, your muscles generate heat. To keep from burning up, your body needs to get rid of that heat. The main way the body discards heat in warm weather is through sweat. As sweat evaporates, it cools the tissues beneath. Increased sweating reduces the body's water level, and this loss of fluid affects normal bodily functions.

**Signs of dehydration**

If you suspect that someone is dehydrated, take immediate action. Signs of dehydration include:

- fatigue
- heat intolerance
- nausea
- light-headedness
- loss of appetite
- dark-colored urine
- flushed skin
- dry cough

The best way to beat dehydration is to drink before you get thirsty. If you wait until after you're thirsty, you're already dehydrated.

**How to avoid dehydration**

- Drink plenty of cool, clean water or electrolyte products throughout the day; minimum of one quart per hour
- Drink plenty of water or electrolyte products before engaging in work activities
- Avoid drinking beverages with caffeine when working out in the heat
- Avoid heavy meals
- Cover as much of your body as possible (i.e., long sleeve shirts and long pants)

Contact your supervisor if you or someone on your team shows signs of dehydration or heat illness.

		<b>Weekly Safety Tailgate</b>	
Topic:	Roadway Work Plan	Date:	
Branch:		Delivered by:	

**THIS WEEKLY TRAINING MUST BE CONDUCTED WITH ALL CREW MEMBERS**

**Purpose:**

Company employees face a variety of hazards in the field every day while working near traffic. Planning activities to minimize Roadway clean-up activities to ensure team safety while working within five feet of the shoulder, impeding a lane of traffic, or in a parking lot.

**Planning:**

- One of the most dangerous roadway tasks is blowing. It is loud and can require the operator to be 2-3 feet into the road.
- Assess whether blowing is required – minor amounts of debris may not need to be blown.
- Take steps to minimize roadway debris. E.g. Keeping mover chutes closed and not blowing debris into the road)
- Where possible, deploy equipment that allows us to blow or vacuum without leaving the curb-line, or mount blowers on appropriately equipped vehicles.
- Create Roadway Work Plan when required

**Roadwork Work Plan:**

- When working within five feet of the shoulder, in a median, where impeding a lane of traffic, or in a parking lot, a Roadway Plan must be developed for that job.
- Roadway Work Plan must identify:
  - Job Name and Job Location
  - Trained Roadway Safety Team Member
  - Number of Team Members on Site
  - Type of work Planned
  - Posted Speed Limit
  - Traffic Conditions
  - PPE and Vest Needed

		<b>Weekly Safety Tailgate</b>	
Topic:	Roadway Signs and Safety Devices	Date:	
Branch:		Delivered by:	

**THIS WEEKLY TRAINING MUST BE CONDUCTED WITH ALL CREW MEMBERS**

**Purpose:**

Team members face a variety of hazards in the field every day while working near traffic. Signage and safety devices become an important tool in providing safe working areas for team members.

**Planning:**

- Create Roadway Work Plan when working within five (5) of the shoulder, in a median, where impeding a lane of traffic, or in a parking lot.
- Provide necessary work zone safety devices; including compliant signage, reflective tape and triangles, and shadow vehicles when required.
- Ensure that vehicles working in areas that expose team members to speed limits greater than 40 MPH are equipped with high intensity warning lights mounted upon vehicles and riding equipment.
- Maximize visibility wherever possible with signs, cones, flashers and reflective materials to highlight crew activity in or alongside roadways.

**Roadway Work Zone Vehicles and Ride-on Equipment**

- Any vehicle that moves in roadways against traffic or significantly slower than traffic shall be equipped with high intensity rotating, flashing, oscillating, or strobe lights.
- Additional reflective tape should be considered on riding equipment.
- Vehicles positioned in closed lanes shall have flashers engaged at all times and be appropriately signed and coned per regulation.

**Signage Requirements:**

- **Work Beyond Shoulder** requires "ROAD WORK AHEAD" signs to be spaced apart as indicated in the table, and the number of signs required is dependent on the size of the work zone.
- **Work on Shoulder/Minor Lane Encroachment** requires a "ROAD WORK AHEAD" and "END ROAD WORK" on both sides of a two-way roadway. Signs to be spaced apart as indicated in table. Cone enforcement is also required.

# A Trusted Advisor

## SERVICES

### Design

- Landscape Architecture & Planning
- Design-Build
- Program Management

### Develop

- Planting
- Hardscapes
- Pools & Water Features
- Compliance
- Tree Growing & Moving

### Maintain

- Landscape
- Tree Care
- Snow & Ice
- Specialty Turf
- Exterior Maintenance

### Enhance

- Enhancements
- Sustainability
- Water Management

## OFFICES

### Miami

- 8191 NW 84<sup>th</sup> Street
- Medley FL. 33166

### Dania Beach

- 2711 SW 36<sup>th</sup> Street
- Dania Beach, FL. 33312

### Pembroke Pines

- 6941 SW 196<sup>th</sup> Avenue
- Ste 30
- Pembroke Pines FL. 33332

### Sunrise

- 440 Sawgrass Corporate Parkway
- Ste 102
- Sunrise, FL. 33325

## EMPLOYEES

### Miami

- 270 Gardeners
- 22 Supervisors
- 20 Certified Technicians

### Dania Beach

- 200 Gardeners
- 17 Supervisors
- 8 Certified Technicians

### Pembroke Pines

- 150 Gardeners
- 10 Supervisors
- 4 Certified Technicians

### Sunrise

- 180 Gardeners
- 9 Supervisors
- 5 Certified Technicians

## FACTS

### Years in Business

- Since 1939
- Over 80 years

### Florida Corporation

- BrightView Landscape Services, Inc.
- FEIN #: 95-419223

### Insurance

- Aon Risk Services
- General Commercial
- Auto & Workmans Comp

### Bonding Ability

- Aon Risk Services
- Excess of \$200 Million
- \$25 million for single project



# A Trusted Advisor

## LICENCES

### Maintenance

- FNGLA Certified Maintenance Technicians
- BMP Train the Trainer

### Irrigation

- Florida Certified Plumbers
- Irrigation Association Member
- Smart Water Irrigation

### Pest & Disease

- Florida Certified Operators
- Florida Certified Applicators
- Florida Certified Ag Products

### Tree Trimming

- ISA Certified Master Arborist
- ISA Certified Arborist
- TCIA Certified

## QUALIFICATIONS

### Best Management

- Florida Friendly Landscaping
- Train the Trainer

### Emergency Response

- Certified First Responder
- Competent in Training

### Storm Water

- Emergency Recovery
- Certified Assessor

### Safety

- State Rules and Regulations
- Fall Protection

## CERTIFICATIONS

### FDOT

- Setup Certified
- Competent Trainer

### CPR

- First Aid
- Instructor

### OSHA

- Hi Lift Certified
- Osha – 10 card

### Horticulturalist

- FNGLA Certified Technicians

## DEGREES

### Agronomy

- BA | As
- Florida, Penn State

### Horticulture

- BA | As
- Florida, Penn State

### Business

- BA | As
- FAU | Florida State

### Plant Science

- BA | As
- Florida | Rutgers | Penn State



# BRIGHTVIEW PLAN

## 30 Days Prior to Service

- Introduce BrightView personnel to all facilities personnel and provide contact information
- BM will assist in developing the necessary communication channels to help expedite a smooth transition to begin initial work
- AM and PM will communicate set up process with Customer
- Take a site tour with all personnel involved
- Meet with management to discuss areas of immediate attention and concern
- Discuss with management our QSA program and set up walk schedules
- Develop schedule for daily, weekly and monthly meetings and property walks; set up reporting formats
- Provide monthly operation schedule and maps to management
- Take soil samples to apply to agronomy program

## First 30 Days of Service

- Develop a Quality Site Assessment (QSA), add any areas of improvement or concern that need to be addressed over the next several months
- Begin daily, weekly and monthly operations
- Account Manager, Production Manager to train crews on best practices for property and adjust mapping system for personnel if necessary
- BM to spend time with crews for learning curve from startup of operations. They will assist crews in training, creating schedules, and procedures for communicating with the client
- Follow up on all first month operations. Check on pruning techniques and detail operations
- Adjust on site personnel schedules to insure we are addressing daily operations
- Walk daily and continue to work off of initial QSA
- Schedule winter turf applications based off of initial soil samples
- Follow up and continue to improve daily, weekly and monthly operations
- Adjust communication with Community Staff management
- Locate areas of weed issues and address immediately

## Next 30-45 Days of Service

- Meet with management to discuss wins and opportunities of first 30 days of service
- Make any adjustments to schedules to keep on right track
- Continue monitoring crews on all services and make adjustments
- Continue training crews and work on efficiencies
- Walk property and complete new QSA within first 45 days of service
- Monthly visits from BM to assess property and meet with Community
- Prepare mow, detail, and spray schedules leading into the fall/winter season
- BM to visit property and provide first report on agronomy program



# TRANSITION PLAN AND EXECUTION

BrightView Landscape Services	JAN	FEB	MAR	APR	MAY	JUN	JUL	AUG	SEP	OCT	NOV	DEC
Branch Planning Meeting			●									
Service Schedule Confirmed				●								
Individual Site Planning				●								
Initial Site Walk-through				●								
Start Date - Anticipated				●								
Week-1 - Alignment Check				●								
Week-2 - Alignment Check				●								
30-Day - Alignment Check					●							
90-Day - Alignment Check						●						
Monthly Walk of Facility					●	●	●	●	●	●	●	
Quarter 2 Review						●						
Quarter 3 Review									●			
Quarter 4 Review												●

This is a sample of our transition plan

# PATH OF MOTION TO SERVICES – JOB SEQUENCING SAMPLE

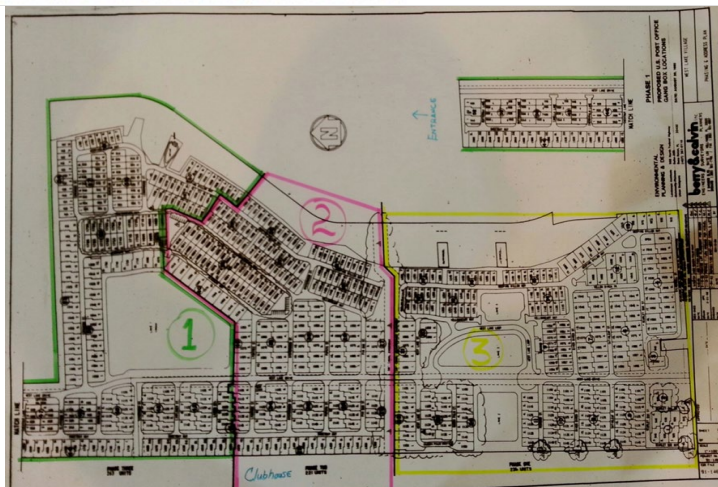
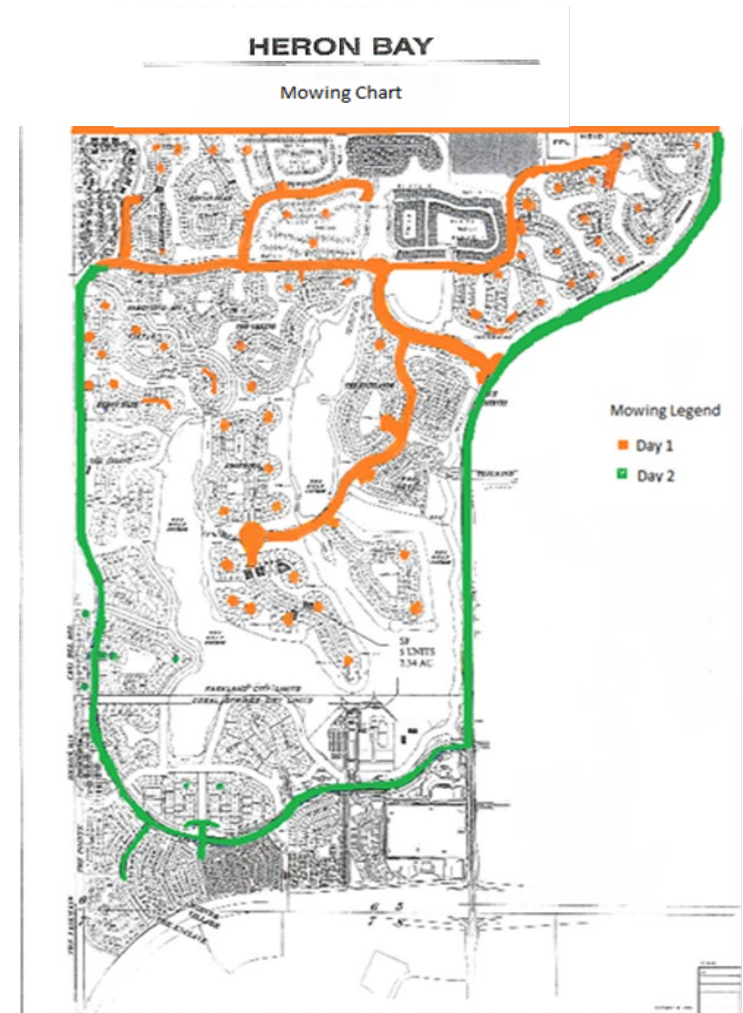
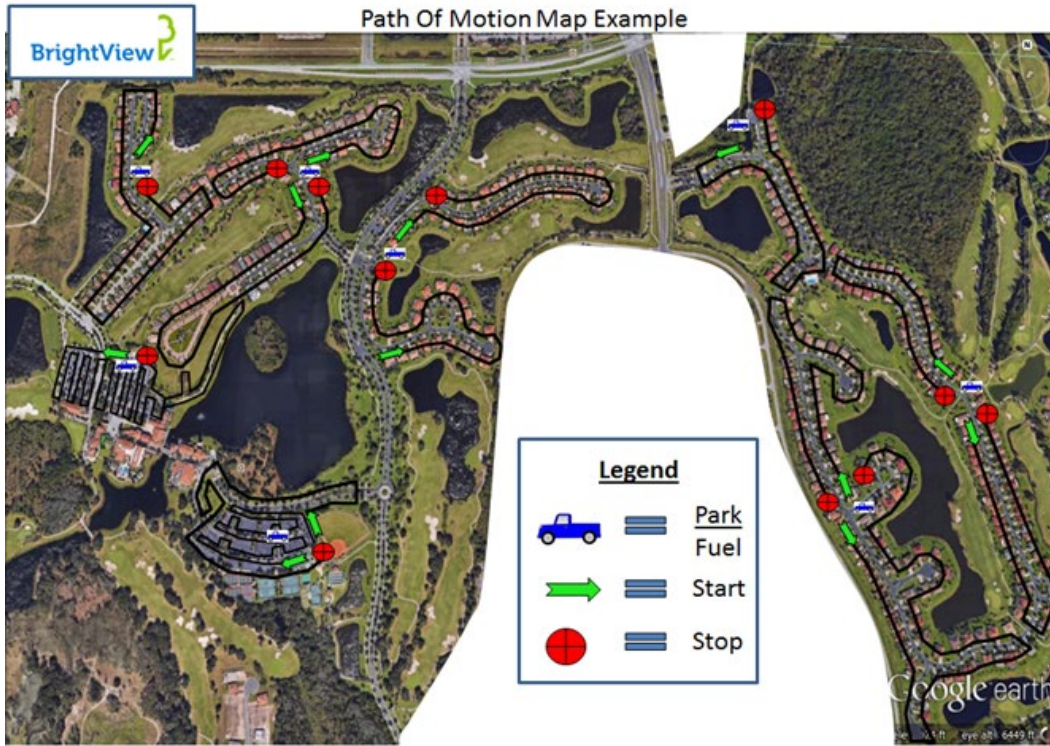

- Review Parking / Fueling / Break / Lunch Areas
- Highlight Starting and Stopping Points
- Mow Areas
- Trimming & Pruning Areas



# BRIGHTVIEW SAMPLE IRRIGATION REPORT



(805) 258-8011  
Email: carlos.victoria@brightview.com  
Date: 10/21/21

Zone Map for :  
Isle Casino Pompano  
777 Isle of Capri Cir  
Pompano Beach, FL

■ Conventional Timers    ■ Pumps  
■ Battery Timer



## Irrigation Report



**Timer 1: Rain Bird ESP-ME (North Gate)**  
 Start time 10:00 PM  
 Schedule: Mon-Tu-W-Th-F-Sun  
 Rain Sensor: Yes

**Zone 1: (0 min)**  
 Wire continuity test failed.  
 Need to troubleshoot zone not coming on \$ 195.00  
 Additional proposal may be needed to correct and repair the problem

**Zone 2: (20 min)**  
 Need to replace (5) clogged spray nozzles \$ 25.00  
 Need to replace (4) spray head gear damage \$ 120.00

**Zone 3: (20 min)**  
 Need to replace (2) leaking spray heads \$ 60.00  
 Need to replace (4) clogged spray nozzles \$ 20.00  
 Recommend straighten (3) tilted heads for proper water distribution \$ 12.00  
 Need to replace (9) spray heads not popping up \$ 270.00

**Zone 4: (20min)**  
 Need to replace (4) clogged spray nozzle \$ 20.00  
 Need straighten (24) tilted heads for water distribution purposes \$ 96.00  
 Recommend lifting (3) sunken heads too low in the soil \$ 12.00  
 Need to replace (3) leaking 6" spray heads \$ 90.00  
 Need to replace (1) broken 6" spray head \$ 30.00

### Smart Irrigation Controller.



### Recommendations:

- 1) Install a Smart irrigation controller for smart watering and remote controller access  
<https://www.hunterindustries.com/irrigation-product/hydrawise/hcc>
- 2) Irrigation controller upgrade Miami Dade rebate application  
[https://www.miamidade.gov/global/service.page?Mduid\\_service=ser1495121281246222](https://www.miamidade.gov/global/service.page?Mduid_service=ser1495121281246222)

Sincerely,

**Carlos M. Victoria**  
 South Florida & The Caribbean  
 Regional Irrigation Advisor  
 Water Smart Irrigation...  
 Keeping A Green World...  
 " Trust is earned when actions meet words"







# OUR SERVICES | EMERGENCY RESPONSE

When a catastrophe occurs such as the recent events with Hurricane Irma, we have the capabilities and manpower to respond immediately. With over **30 locations** throughout the Southeast alone, **we leverage our local and national resources** to bring in additional teams from outside the area. This allows us to ensure the site is safe and free from pedestrian hazards.

Resources from branch offices will be available in the event of an emergency to ensure **our customers have access to crews and equipment quickly.**

**Safety** before and after a storm is our primary focus. Immediately following the storm, our teams will ensure:

- Vehicle access is cleared, allowing emergency personnel access.
- Debris from structural dwellings that may pose immediate risk is cleared.
- Plant material that may have a chance of surviving is replanted.
- Hazardous damaged limbs that remain in trees are trimmed and removed.
- Tree limbs, root balls, or large wood debris remaining on the ground is chipped and removed.
- Final restoration of any remaining damages or losses resulting from the storm is performed.

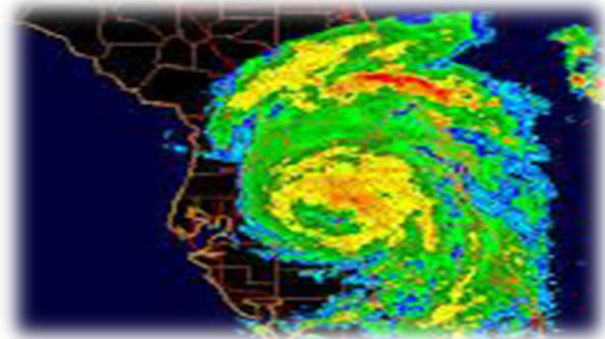



# QUALITY WORKMANSHIP





# QUALITY ASSURANCE PLAN / COMMUNICATION

## *External and Internal quality control process for success*



### **QSA (Quality Site Assessment)**

- Property evaluation by AM provided to customer
- Report with pictures, focus areas, and timelines
- Board and landscape committee invited

### **QI (Quality Inspection)**

- Property evaluation by Production Manager for BV leadership
- Internal audit to identify shortfalls and successes
- Completed with crew leaders for proper communication and follow through



## Old Form

### Quality Site Assessment

#### General Information

Property Name: Englewood  
 Date: Tuesday, June 29, 2021  
 Next Inspection Date:  
 Client Attendees:  
 Brightview Attendees: Matt Braun

#### CUSTOMER FOCUS AREA

Front entrance (shrubs, flowers, turf), pool area, neighbor monuments

#### MAINTENANCE ITEMS

- 1) Parking lot beds around pool have weeds within the jasmine. Need to be hand pulled. Then sprayed with a non-selective herbicide.
- 2) Areas in zoysia turf needs to be treated with selective herbicide
- 3) Irrigation issues at front entrance median. Looks to be connecting in areas due to rain. Zone needs to be checked for errors.
- 4) Cardboard palm coming up through bouganvillea. Needs to be removed.
- 5) Many beds of dead/dying juniper throughout property. Some have been replaced. Cause needs to be determined. Dead needs to be removed to reduce possible spread of disease/fungus if applicable
- 6) Tree rings around property have herbicide damage from possible chemical edging. Dead turf needs removed. Will not bounce back.
- 7) Bed edge needs to be done on beds to crisp edges. Inconsistent flow around property.
- 8) Shoots on bouganvillea need to be cut back. Shrubs are uniform for the most part. Plant material can be treated with growth regulators to prevent this as well as promote blooming.
- 9) More examples of issues with juniper beds
- 10) Mechanical damage to turf. Found on a few lawns from possible fuel/hydraulic leak with equipment. Turf will not recover and needs to be replaced.
- 11) Grape myrtle struggling to recover from cutback. Possible cut back too much at the wrong time.
- 12) Another example of overspray from excessive non selective herbicide spraying.
- 13) Recent some in perils
- 14) Active
- 15) Turf due
- 16) Irrigation possible
- 17) Possible with Vie

### Quality Site Assessment

Many beds of dead/dying juniper throughout property. Some have been replaced. Cause needs to be determined. Dead needs to be removed to reduce possible spread of disease/fungus if applicable

The edge around property has herbicide damage from possible chemical edging. Dead turf does not bounce back



Bed edge needs to be done on beds to crisp edges. Inconsistent flow around property



Shoots on bouganvillea need to be cut back. Shrubs are uniform for the most part. Plant material can be treated with growth regulators to prevent this as well as promote blooming



## New Form



### Quality Site Assessment

Prepared for:  
 20061 Galleria Blvd.  
 Thu Jul 22 2021

## QUALITY SITE ASSESSMENT

### 20061 Galleria Blvd.

### Maintenance Items

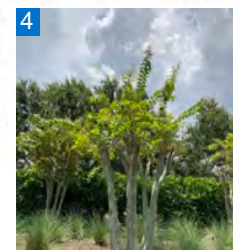
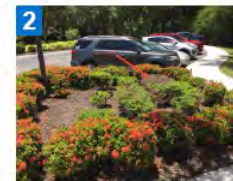

### QUALITY SITE ASSESSMENT

20061 Galleria Blvd.



#### General Information

DATE: Thursday, Jul 22, 2021  
 NEXT INSPECTION DATE: Friday, Jul 30, 2021  
 CLIENT ATTENDEES: Matt Braun  
 BRIGHTVIEW ATTENDEES:

#### Customer Focus Areas

Front entrance, clean lines, good flowers, Inside pool area

#### Quality you can count on.



**1** Bouganvillea needs to be trimmed at guard shack. Growth regulator should be applied.

**2** Removed dead plant material from bed

**3** Dead turf from hydraulic leak needs to be replaced at vendors expense

**4** Grape myrtles not doing well after "hat racking"



# MUNICIPAL REFERENCES

Project Name: Village of Bal Harbour  
Address: Bal Harbour  
Years of Service: 8+ years  
Contact: Jason Atkinson  
Phone: 305-993-7334  
Email: [jatkinson@balharbourfl.gov](mailto:jatkinson@balharbourfl.gov)  
Contract Amount: \$890,000

Village Wide Landscape & Beach Areas

Project Name: City of Aventura  
Address: Aventura  
Years of Service: 22+ years  
Contact: Alan Levine  
Phone: 305-466-8931  
Email: [Levinea@cityofaventura.com](mailto:Levinea@cityofaventura.com)  
Contract Amount: \$950,000

Full Landscape Biscayne Blvd, Parks, Government Center & Schools, All Right of Ways

Project Name: City of Weston Roadways  
Address: Weston  
Years of Service: 15+ years  
Contact: Thaddeus Bielecki  
Phone: 954-389-4321  
Email: [tbielecki@westonfl.org](mailto:tbielecki@westonfl.org)  
Contract Amount: \$1,200,000

Area A: Full Service Landscape Maintenance





# MUNICIPAL REFERENCES

Project Name: Bay Harbor Islands Landscape  
Address: Bay Harbor Islands  
Years of Service: 10 years  
Contact: Doug Armstrong  
Phone: 305-866-6241  
Email: [darmstrong@bayharborislands-fl.gov](mailto:darmstrong@bayharborislands-fl.gov)  
Contract Amount: \$260,000

Town wide Full Landscape Landscape Maintenance



Project Name: City of Weston Parks  
Address: City of Weston  
Years of Service: 2+ years  
Contact: Catherine Flenniken  
Phone: 864-884-0699  
Email: [cflenniken@westonfl.org](mailto:cflenniken@westonfl.org)  
Contract Amount: \$670,000

Park Maintenance and Sports Fields: specialty turf

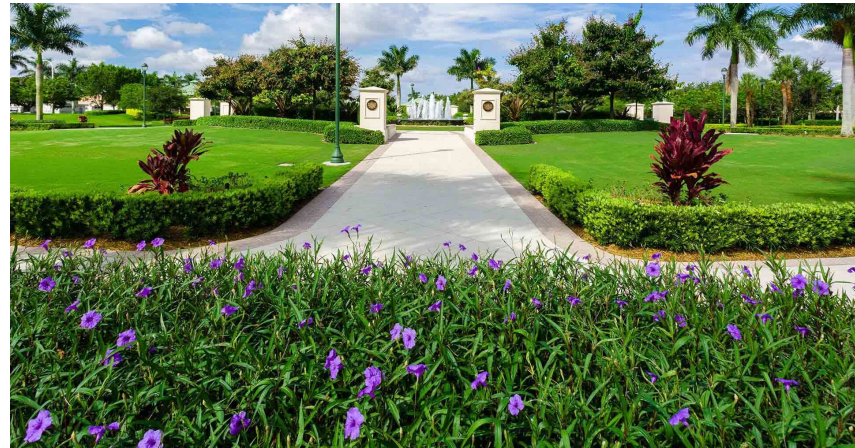

**BID PRICING SHEET (SITES) \*\*\*REVISED\*\*\*  
SOLICITATION # RFP 2022-008 CITYWIDE LANDSCAPING MAINTENANCE**

**SOLICITATION CLOSING DATE: MAY 6, 2022**

This solicitation will be awarded to the highest ranked responsive and responsible proposer(s), based on the criteria outlined in this solicitation. Proposers must provide pricing on all line items. Failure to do so will deem you as non-responsive. The City in its sole discretion will determine if the pricing received is reasonable and if it is in the best interest of the City to move forward with the award.

VENDOR: BrightView Landscape Services, Inc.

FEIN: 95-4194223

Item No.	Location	Price per Cycle (Bi-weekly cycles)	Price per Year (Cycles Multiplied by 25)
1	Campina Ct. at SW 39th Ave.	\$ 15	\$ 375
2	Ponce de Leon Blvd (Flagler to 8th St) - Median and two adjacent triangles at either end of Campina Ct. and including Campina Ct. median and including 4 traffic islands East of Douglas Road on Ponce	\$ 484	\$ 12,100
3	Santiago St. at SW 8th St - street closure, dead end	\$ 15	\$ 375
4	Pizarro St. at SW 8th St - street closure, dead end	\$ 15	\$ 375
5	Monterrey St. at SW 8th St - street closure, dead end	\$ 15	\$ 375
6	Wallace St. at SW 8th St - greenspace	\$ 15	\$ 375
7	Wallace St. at SW 8th St - street closure, dead end	\$ 15	\$ 375
8	Capri St. at SW 8th St - street closure, dead end	\$ 15	\$ 375
9	900 Blk Galiano Ave (Island)	\$ 15	\$ 375
10	Island (Jose Mari Park) - greenspace	\$ 25	\$ 625
11	San Benito Ave. at SW 57th Ave. - street closure, dead end	\$ 15	\$ 375
12	Medina Ave. at Cortez St - street closure, dead end	\$ 15	\$ 375
13	1300 Blk Columbus Blvd - Island	\$ 9	\$ 225
14	Lot #17 - 217 Madeira Ave. - ALL & ROW	\$ 75	\$ 1,875
15	Alhambra Circle - Median Galiano to back of wall at Madiera	\$ 164	\$ 4,100
16	Lot #13, 234 Navarre Ave. - ALL & ROW	\$ 60	\$ 1,500
17	1000 Blk Alhambra Circle - Median and adjacent to entrance columns North and South of median on W Granada	\$ 60	\$ 1,500
18	1100 Blk Alhambra Circle - Median	\$ 15	\$ 375
19	900 Blk Alhambra Circle - Median and including the fountain area at Majorca Ave at Alhambra and the triangle at the NE corner of Alhambra at Granada and the SE and NE corner of Alhambra at Granada.	\$ 106	\$ 2,650
20	1200 Blk Alhambra Circle - Median	\$ 15	\$ 375
21	1300 Blk. Alhambra Circle - Median, including Cadiz/Alhambra Island	\$ 15	\$ 375
22	Lot #21, 140 Minorca Ave. - ALL & ROW	\$ 30	\$ 750
23	Country Club Prado - Median 8th St. to Sevilla Ave., including islands, lots at 8th St and the two cul-de-sacs at Red Road and Coral Way	\$ 1,207	\$ 30,175
24	1400 Blk. Alhambra Circle - Median	\$ 15	\$ 375
25	800 Blk Alhambra Circle - point, north side & median	\$ 15	\$ 375
26	Water Tower - Ferdinand St. and Alhambra Circle - entire block	\$ 45	\$ 1,125
27	700 Blk Alhambra Circle - Median and park area North side	\$ 15	\$ 375
28	Alhambra Circle 200-300 Blk. - Median	\$ 15	\$ 375
29	2000 Blk. Alhambra Circle - Median	\$ 15	\$ 375
30	400 Blk Alhambra Circle - Median	\$ 15	\$ 375
31	500 Blk Alhambra Circle - Median - including swale area at back of wall	\$ 15	\$ 375
32	Lot #25, 104 Merrick Way - ALL & ROW	\$ 83	\$ 2,075
33	600 Blk Alhambra Circle - point, north side & median	\$ 15	\$ 375
34	2100 Blk. Alhambra Circle - Median	\$ 15	\$ 375
35	Lot #3 - 330 Aragon Ave - ALL & ROW	\$ 91	\$ 2,275
36	2200 Blk. Alhambra Circle - Median	\$ 15	\$ 375
37	900 Castile Ave. - Greenspace	\$ 70	\$ 1,750
38	Hernando & 500 Coral Way -Parking lot including ROW	\$ 105	\$ 2,625
39	2300 and 2400 blks Alhambra Circle - 2 points, west side of Alhambra, North and South of Coral Way	\$ 30	\$ 750
40	Garage #1, 245 Andalusia Ave. - ALL & ROW	\$ 73	\$ 1,825
41	Garage #4, 385 Andalusia Ave. - ALL & ROW	\$ 112	\$ 2,800
42	Coral Way and Red Road - entrance feature excluding flower beds.	\$ 60	\$ 1,500
43	Toledo St. - Coral Way to Billmore Way - Median and Island	\$ 15	\$ 375
44	Lot #20, 435 Valencia Ave. - ALL & ROW	\$ 15	\$ 375
45	Lot #30, 95 Almeria Ave. - ALL & ROW	\$ 155	\$ 3,875
46	395 Alhambra-[N]E side of Alhambra only, corner LeJeune] - ALL & ROW	\$ 19	\$ 475
47	Valencia and Cardena - center medians including bumpouts	\$ 30	\$ 750
48	Lot #33, 250 Almeria Ave. - ALL & ROW	\$ 67	\$ 1,675
49	1400 Blk. Valencia Ave - Medians East and West of San Domingo	\$ 15	\$ 375
50	1300 Blk. Valencia - Island at Indian Mound Trail	\$ 15	\$ 375
51	Indian Mound Trail - ROW between Valencia Ave and Sevilla Ave. West Side	\$ 15	\$ 375
52	Palos St - Median	\$ 15	\$ 375
53	Lot #10, 361 Palermo Ave. - ALL & ROW	\$ 15	\$ 375
54	Venetian Pool Parking Lot areas (2) - one directly adjacent to the pool on the North side (triangular area) and one to the West adjacent to Granada Blvd. Includes also the Desoto Fountain hedge and weeding of annual bed. Including outside of pool	\$ 272	\$ 6,800
55	1000 Blk. Sevilla Ave. - median	\$ 30	\$ 750
56	1400-1500 Blks of Sevilla Ave - medians	\$ 30	\$ 750

57	Indian Mound Trail & Sevilla Ave - Island	\$ 15	\$ 375
58	Santander Avenue & Galliano Court - greenspace at the curve, ROW included	\$ 62	\$ 1,550
59	Lot #36, 243 University Dr. - ALL & ROW	\$ 52	\$ 1,300
60	Equipment Yard at 2800 SW 72nd Ave.	\$ 724	\$ 18,100
61	San Sebastian Ave at Coconut Grove Dr.	\$ 15	\$ 375
62	San Sebastian Park - 100 Blk. San Sebastian Ave. Including ROW	\$ 95	\$ 2,375
63	Malaga Ave. at SW 57th Ave., street closure, dead end	\$ 15	\$ 375
64	Romano Avenue at SW 38th Ave - street closure, dead end	\$ 15	\$ 375
65	Blk bordered by Anastasia Ave./Columbus Blvd./Malaga Ave. Entire ROW of lot except where there are new homes	\$ 45	\$ 1,125
66	Segovia Street from Biltmore Way to Bird Road - Entire new median and two triangular areas adjacent to Segovia at Riviera Drive (West of Segovia) and University Drive (East of Segovia)	\$ 724	\$ 18,100
67	Sarto Avenue at SW 38th Ave - street closure, dead end	\$ 15	\$ 375
68	3200 blk Toledo St. - Island	\$ 91	\$ 2,275
69	University Dr. - South ROW Sarto to Cadima	\$ 91	\$ 2,275
70	Biltmore Tennis Complex - 1150 Anastasia Ave, including ROW East to the rear property line of the house on Granada, Tennis Parking Lot and entire fenced area.	\$ 862	\$ 21,550
71	Camilo Avenue at SW 38th Ave - street closure, dead end	\$ 15	\$ 375
72	Ponce De Leon Blvd. (Bird Rd. to Catalonia Ave.), including triangle at Malaga and median just N Catalonia	\$ 181	\$ 4,525
73	University Dr. - Camilo to Riviera - ROW and adjacent empty lot including ROW	\$ 226	\$ 5,650
74	Aledo Avenue at SW 38th Ave - street closure, dead end	\$ 15	\$ 375
75	3400 Blk. Banos Ct. - Island (Durango St at Banos Ct) - greenspace	\$ 23	\$ 575
76	University Dr. - Cadima to Riviera - lot including ROW	\$ 181	\$ 4,525
77	Cadima Avenue at SW 38th Ave - street closure, dead end	\$ 15	\$ 375
78	Cadima Avenue at Alley at SW 39th Ave - street closure, dead end	\$ 15	\$ 375
79	Taragona at SW 57th Ave.	\$ 23	\$ 575
80	1500 Taragona Ave. - ROW, Park on canal down to water and alhambra bridge	\$ 14	\$ 350
81	Viscaya Ct. (hedges to West end)	\$ 91	\$ 2,275
82	Lot-SW corner University Dr. & Segovia St.	\$ 24	\$ 600
83	Murcia Ave. at Red Rd. - street closure, dead end	\$ 15	\$ 375
84	Alcala Ave. at Red Rd. - street closure, dead end	\$ 15	\$ 375
85	Piasentia Ave. at Red Rd - street closure, dead end	\$ 15	\$ 375
86	2508 DESOTO-City Signage Area	\$ 15	\$ 375
87	3800 Blk. Alhambra Ct. - Lot with ROW & big triangle park	\$ 15	\$ 375
88	Girl Scout house and pump house lot at Granada Blvd. & Bird Road	\$ 15	\$ 375
89	Sopera Ave. at Red Rd - street closure, dead end	\$ 15	\$ 375
90	San Amaro Ct. & Bird Rd. - street closure, dead end	\$ 15	\$ 375
91	Ponce De Leon Blvd. - Bird Rd. to San Lorenzo. Medians including east side ROW at San Lorenzo	\$ 121	\$ 3,025
92	500 San Esteban Ave. - Island	\$ 15	\$ 375
93	4600 Blk. Riviera Dr., North of Vliabella - Manatee View Spot ROW (canal end) area adjacent to wall, including bank down to water	\$ 30	\$ 750
94	Granada Blvd. at Jeronimo Dr. bridge - Hedges and Median	\$ 30	\$ 750
95	Lot #41 Passport Office - 4520 Ponce De Leon Blvd. - ROW only	\$ 85	\$ 2,125
96	Lot #31, 350 Greco Ave. - ALL & ROW	\$ 95	\$ 2,375
97	Vliabella Ave. at LeJeune Rd. - street closure, dead end	\$ 15	\$ 375
98	Ponce De Leon Blvd. between Oak Ave. and LeJeune Rd. ROW, north side	\$ 117	\$ 2,925
99	Lot #40 - 4500 Blk. Ponce De Leon Blvd. - including ROW	\$ 70	\$ 1,750
100	Almarin Ave. at LeJeune Rd. - street closure, dead end	\$ 15	\$ 375
101	1300 Blk. Mendavia Ave - greenspace	\$ 70	\$ 1,750
102	S. Dixie Hwy- ROW East side Red Road to Grand Ave., ROW West side from North end of Fire II to LeJeune Rd.	\$ 1,448	\$ 36,200
103	Cadagua Ave. at LeJeune Rd. - street closure, dead end	\$ 15	\$ 375
104	800 Blk. Blue Rd. - 2 Islands	\$ 55	\$ 1,375
105	Ponce de Leon Blvd. at Blue Road - Island	\$ 15	\$ 375
106	800 Blk. Blue Rd. - Park-down to water & ROW (Blue Rd. waterway park)	\$ 15	\$ 375
107	Lot #12 & 16, 4650 Ponce de Leon Blvd. - actually 3 lots including lot 12 - ALL & ROW	\$ 226	\$ 5,650
108	Kakounis Park - 1300 Blk. Campo Sano Ave. - at Campo Sano Ct. - Lot. Area with big oak tree.	\$ 96	\$ 2,400
109	Fire Station II - 525 South Dixie Highway including ROW	\$ 618	\$ 15,450
110	San Amaro Ct. at San Amaro Dr. - ROW around lot	\$ 123	\$ 3,075
111	700 Blk. Paradiso Ave. - Island	\$ 15	\$ 375
112	Pisano Ave. Bridge - ROW East side of bridge only to Carrillo. Including area all the way to wall on the North side.	\$ 15	\$ 375
113	900 Blk Pisano Ave. - Granada Pineapple -greenspace	\$ 15	\$ 375
114	Ponce de Leon Blvd. - Median & swale - LeJeune Rd. to Red Rd. -ALL & ROW	\$ 1,207	\$ 30,175
115	Zuleta Ave. at SW 57th Ave. - street closure, dead end	\$ 45	\$ 1,125
116	Consolata Ave. at SW 57th Ave. - street closure, dead end	\$ 15	\$ 375
117	San Amaro Drive (Ponce de Leon Blvd. to Campo Sano Court) Median, traffic circles and small side beds	\$ 1,771	\$ 44,275
118	Zoreta Ave. at SW 57th Ave. - street closure, dead end	\$ 15	\$ 375
119	Delgado Ave. at SW 57th Ave. - street closure, dead end	\$ 15	\$ 375
120	Mataro Ave. at SW 57th Ave. - street closure, dead end	\$ 15	\$ 375

121	Sagua Ave. Ponce de Leon Blvd. to Levante Ave. - ROW hedges	\$ 45	\$ 1,125
122	Lot #43, 5700 Ponce De Leon Blvd. - ALL & ROW	\$ 91	\$ 2,275
123	Strip of ROW outside of wall on Lejeune RD across from covnrient store just South of US 1 (East side of Lejeune Rd.)	\$ 91	\$ 2,275
124	Rosario Ave. - US1 to Menendez - hedges	\$ 30	\$ 750
125	Menendez Ave. - ROW both sides, Lejeune to Riviera including Riviera side of lot at US1	\$ 362	\$ 9,050
126	Orduna Dr. - greenspace	\$ 30	\$ 750
127	5600 Blk. Granada Blvd. at Orduna Drive point	\$ 52	\$ 1,300
128	800 Blk. Miller Rd. - 2 islands and greenspace	\$ 136	\$ 3,400
129	Miami-Homestead Ave. - West side from Augusto to Sardinias	\$ 302	\$ 7,550
130	Miami-Homestead Ave. School ROW East side between Marius to Augusto	\$ 618	\$ 15,450
131	Orduna Dr. at Miller Rd - street closure, dead end	\$ 15	\$ 375
132	5600-5800 blk Marius St. - ROW on school side	\$ 121	\$ 3,025
133	5000 Blk. Maynada St. at Augusto point In between Maynada St. and Augusto St.	\$ 95	\$ 2,375
134	1100 Blk. Madruga Ave. - ROW of lots, North side	\$ 60	\$ 1,500
135	5700-5900 blk Augusto St. ROW on school side and empty lot and median at celini street. Lot is on West side of Augusto St. between Leonardo and Maynada.	\$ 429	\$ 10,725
136	Mall St. - Median & Island, Marius to Hardee Rd.	\$ 45	\$ 1,125
137	6900 Blk. Granada Blvd. at Mall St. NW swale	\$ 45	\$ 1,125
138	Hardee Bridge & Granada Blvd. to Riviera Dr. Down to water where accessible	\$ 30	\$ 750
139	1200 blk S. Alhambra ROW east side waterway.	\$ 52	\$ 1,300
140	Granada Bridge- S. Alhambra Cir. to Alfonso Down to water where accessible	\$ 60	\$ 1,500
141	700 Blk. S. Alhambra Circle at Veronese- Island	\$ 35	\$ 875
142	1400-1500 Blk Madruga (south side)	\$ 45	\$ 1,125
143	1400-1500 Blk. Monza (north side)	\$ 45	\$ 1,125
144	Maynada Bridge- S. Alhambra Cir. to Alfonso down to water where accessible	\$ 30	\$ 750
145	1500 Blk. Yenera (north side)	\$ 69	\$ 1,725
146	Yumuri Street - 6600 Blk-6900Sunset (east & west side)	\$ 414	\$ 10,350
147	Sunset Road at Granada Blvd. (small triangle island)	\$ 45	\$ 1,125
148	MacFarlane Linear Park - Grand Ave to Brooker Street	\$ 181	\$ 4,525
149	Sunrise Terrace. - Cul-de-Sac	\$ 62	\$ 1,550
150	Sunrise Court. - Cul-de-Sac and Triangle	\$ 62	\$ 1,550
151	Sunrise Place - Cul-de-Sac and Triangle	\$ 45	\$ 1,125
152	Cartagena Circle and surrounding areas to the water	\$ 45	\$ 1,125
153	Pinewood Cemetery	\$ 91	\$ 2,275
154	7700 Blk. Almansa St. at Old Cutler - Island	\$ 188	\$ 4,700
155	Section I Cocoplum (The area accessed from Los Pinos Blvd. at Cocoplum road) - Pump station area next to tennis courts and 6 cul-de-sacs	\$ 471	\$ 11,775
156	San Bruno Ave. - Cul-de-Sac only	\$ 71	\$ 1,775
157	Old Cutler & Arvida. Medians on both sides of traffic light	\$ 75	\$ 1,875
158	Kendall Drive at School House Road -triangular area and including the median hedge area on Hammock Lake Dr. to the south	\$ 258	\$ 6,450
159	SW 93 street (Oakwood Lane) - Cul-de-sac	\$ 48	\$ 1,200
160	500 Blk. Reinante Ave. - 3 Cul-de-Sacs	\$ 261	\$ 6,525
161	Solano Prado - all traffic islands and one cul-de-sac. The entrance swales and medians (from East side of main entrance to Balada street - excluding residential ROW and guard house with its associated side planters).	\$ 91	\$ 2,275
162	School House Road - West ROW 92 street to 93 street.	\$ 30	\$ 750
163	600 Blk. Marquesa Dr. - Cul-de-Sac	\$ 15	\$ 375
164	ROW of lot at Schoolhouse Rd. and 93 street.	\$ 15	\$ 375
165	SW 95 Terrace(Kenwood Oak Drive) - Median hedge & 1 Cul-de-sac and also 2 cul-de-sacs on Kenwood Terrace and Kenwood Ct.	\$ 224	\$ 5,600
166	9300 Gallardo St. - Cul-de-Sac	\$ 90	\$ 2,250
167	Balada St. - Cul-de-Sac	\$ 45	\$ 1,125
168	Old Cutler Road- ROW, Red Road to Sunset Circle excluding area South of Snapper Creek Road to the Bridge on West side only.	\$ 1,448	\$ 36,200
169	Campana Ave. - Guardhouse, ROW North side Eastward to Monforo St., 3 Hammock Oaks Cul-de-Sacs	\$ 377	\$ 9,425
170	Girasol Ave. - Medians and Cul-de-Sac	\$ 142	\$ 3,550
171	Sierra Circle & Nogales St. - all unmowed ROW's	\$ 60	\$ 1,500
172	Neda St. - ROW South side	\$ 15	\$ 375
173	Fire III - 11911 Old Cutler Road	\$ 306	\$ 7,650
174	East ROW Red Road-From Old Cutler Rd., South along Montgomery foundation fence line to north entrance of Gulliver Academy	\$ 272	\$ 6,800
175	1200 Blk. Cartagena Ave. - North side	\$ 15	\$ 375
176	12400 Red Road - two entrance sign areas and right of way of Red Road on West side of street South of these areas.	\$ 91	\$ 2,275
177	12500-12600 Blks. Ramiro St. - 2 Cul-de-Sacs	\$ 91	\$ 2,275
178	12700 Blk. Virtutes St. - East side	\$ 45	\$ 1,125
179	1300 Blk. Corona Ave. - Cul-de-Sac	\$ 45	\$ 1,125
180	800-1000 Blks. Lugo Ave. - North side	\$ 45	\$ 1,125
181	Red Rd & Lugo. Roundabout including median	\$ 60	\$ 1,500
182	13000 Blk. Deva St. - Cul-de-Sac	\$ 49	\$ 1,225
183	1500 Blk. Agua Ave. - Cul-de-Sac	\$ 49	\$ 1,225
184	1300 Blk. Lerida St. - Cul-de-Sac	\$ 49	\$ 1,225



185	1300 Blk. Nevada St. - Cul-de-Sac	\$ 49	\$ 1,225
186	1500 Blk. Tagus Ave. - Cul -de-Sac	\$ 49	\$ 1,225
187	13000 Blk. Mar St. - Cul-de-Sac	\$ 49	\$ 1,225
188	13000 Blk San Jose St. - Cul-de-Sac	\$ 49	\$ 1,225
189	13000 Blk Zambrana St- Cul-de-Sac	\$ 49	\$ 1,225
190	1300 Blk. Miranda St. -Cul-de-Sac	\$ 49	\$ 1,225
191	1300 Blk. San Mateo St. -Cul-de-Sac	\$ 49	\$ 1,225
192	Bella Vista Ave. Traffic calming installation - Deva Street	\$ 49	\$ 1,225
193	Bella Vista Ave. - South ROW & Median	\$ 87	\$ 2,175
194	Bella Vista Ave. Traffic calming installation - San Mateo	\$ 18	\$ 450
195	Bella Vista Ave. Traffic calming installation - San Jose	\$ 18	\$ 450
196	13100 Blk Red Road - East ROW within city limits for aprox. 2 blocks South of Bellavista	\$ 91	\$ 2,275
197	SW 144 street USDA ROW north side from East side of Guardhouse area Eastward to the ROW of the golf course.	\$ 272	\$ 6,800
198	Permit Dr. Marina (Kings Bay)	\$ 90	\$ 2,250
199	San Pedro Ave Cul-de-Sac	\$ 50	\$ 1,250
200	Baryan Drive - Greenspace & ROW	\$ 226	\$ 5,650
201	Red Road - 8th St to US1 - ROW's - East side only and medians near US1	\$ 2,173	\$ 54,325
202	200 - 1500 Blk. Bird Road -Median & Swale	\$ 1,931	\$ 48,275
203	South Dixie Highway medians - Red Road to Douglas Road	\$ 4,271	\$ 106,775
204	Hammock Oaks Pump Station	\$ 45	\$ 1,125
205	Coral Gables Country Club - 997 N Greenway Dr - ALL & ROW	\$ 135	\$ 3,375
206	US1 - Royal Palms (FDOT)	\$ 2,460	\$ 61,500
207	US1 - Planting (FDOT)	\$ 1,640	\$ 41,000
208	Lot #3 - 350 Aragon Ave. - ALL & ROW	\$ -	\$ -
209	Lot #4 - 153 Aragon Ave. - ALL & ROW	\$ 15	\$ 375
210	Lot # 7 - 221 Almenia Ave. - ALL & ROW	\$ 215	\$ 5,375
211	Lot #8 - 240 Giralda Ave. - ALL & ROW	\$ 105	\$ 2,625
212	Lot #18 - 351 Minorca Ave. - ALL & ROW	\$ 91	\$ 2,275
213	Lot #22 - 4010 Laguna St. - ALL & ROW	\$ 45	\$ 1,125
214	Garage 2, 220 Aragon Ave. - ALL & ROW	\$ 114	\$ 2,850
215	Garage 6, 51 Aragon Ave. - ALL & ROW	\$ 335	\$ 8,375
216	Aragon & Giralda 000-200 - (Litter Control)	\$ 79	\$ 1,975
217	Ponce De Leon 2100-2600 - (Litter Control)	\$ 79	\$ 1,975
218	Ponce De Leon 800-2100 - (Litter Control)	\$ 210	\$ 5,250
219	Alhambra (Ponce-Le June) - (Litter Control)	\$ 92	\$ 2,300
220	Andalusia (Le June-Douglas) - (Litter Control)	\$ 92	\$ 2,300
221	401 Building (Litter Control)	\$ 13	\$ 325
222	Merrick Park (Litter Control)	\$ 105	\$ 2,625
223	Pitman Park (Litter Control)	\$ 13	\$ 325
224	Four Horses (Litter Control)	\$ 39	\$ 975
225	8th Street Entrance (Litter Control)	\$ 39	\$ 975
226	City Hall Parking Lot (Litter Control)	\$ 39	\$ 975
227	Coral Gables Museum - Litter Control	\$ 39	\$ 975
228	Holiday Litter Control (6 Saturdays DEC&JAN)	\$ 1,260	\$ 31,500
<b>TOTAL</b>		<b>\$ 39,945</b>	<b>\$ 998,625</b>

**NOTE:** Pricing shall include, but not be limited to, full compensation for labor, supervision, personnel, materials, any and all tools and equipment used, travel and related expenses and any and all other costs to the Proposer. The City will not pay and/or reimburse any additional costs including, but not limited to, travel, mileage, lodging, meals, and other travel and subsistence expenses. Prices shall remain fixed and firm for the term of the contract, including renewal options.

Coral Gables Buy American Preference Acknowledgement. Please acknowledge if you are asserting you qualify. Yes . Please refer to Procurement Code Sec. 2-699(Ord. No. 2016-30, § 2(2-780), 5-24-2016) Documentation supporting the assertion that a product is American manufactured, assembled or produced must be provided with your bid submittal.

Authorized Signature: Charles Gonzalez  
Print/Type Name: Charles Gonzalez  
E-mail: jenna.crawford@brightview.com  
Address: 4155 East Mowry Drive

Title: SVP  
Phone: 786-999-4048  
Fax: 305-258-0809  
City: Homestead State: FL Zip Code: 33033

THE EXECUTION OF THIS FORM CONSTITUTES THE UNEQUIVOCAL OFFER OF THE BIDDER TO BE BOUND BY THE TERMS OF ITS BID. FAILURE TO SIGN THIS BID PRICE FORM WHERE INDICATED ABOVE BY AN AUTHORIZED REPRESENTATIVE OR PROVIDE THE FORM AS PRESENTED MAY RENDER THE BIDDER NON-RESPONSIVE.

**BID PRICING SHEET (SITES) ALTERNATE CYCLES \*\*\*REVISED\*\*\*  
SOLICITATION # RFP 2022-008 CITYWIDE LANDSCAPING MAINTENANCE**

**SOLICITATION CLOSING DATE: May 6, 2022**

This solicitation will be awarded to the highest ranked responsive and responsible proposer(s), based on the criteria outlined in this solicitation. Proposers must provide pricing on all line items. Failure to do so will deem you as non-responsive. The City in its sole discretion will determine if the pricing received is reasonable and if it is in the best interest of the City to move forward with the award.  
ALTERNATE CYCLES PRICE LIST WILL NOT BE CONSIDERED AS A FACTOR OF THE AWARD.

VENDOR: BrightView Landscape Services, Inc.

FEIN 95-4194223

Item No.	Location	Price per Cycle (Weekly cycles)	Price per Year (Weekly Cycles)	Price per Cycle (Two Times per Week)	Price per Year (Two Times per Week)
1	Campina Ct. at SW 39th Ave.	\$ 12	\$ 624	\$ 24.00	\$ 1,248.00
2	Ponce de Leon Blvd (Flagler to 8th St) - Median and two adjacent triangles at either end of Campina Ct. and including Campina Ct. median and including 4 traffic islands East of Douglas Road on Ponce	\$ 393	\$ 20,436	\$ 786.00	\$ 40,872.00
3	Santiago St. at SW 8th St. - street closure, dead end	\$ 12	\$ 624	\$ 24.00	\$ 1,248.00
4	Pizarro St. at SW 8th St. - street closure, dead end	\$ 12	\$ 624	\$ 24.00	\$ 1,248.00
5	Monterrey St. at SW 8th St. - street closure, dead end	\$ 12	\$ 624	\$ 24.00	\$ 1,248.00
6	Wallace St. at SW 8th St. - greenspace	\$ 12	\$ 624	\$ 24.00	\$ 1,248.00
7	Wallace St. at SW 8th St. - street closure, dead end	\$ 12	\$ 624	\$ 24.00	\$ 1,248.00
8	Capri St. at SW 8th St. - street closure, dead end	\$ 12	\$ 624	\$ 24.00	\$ 1,248.00
9	900 Blk Galiano Ave (Island)	\$ 12	\$ 624	\$ 24.00	\$ 1,248.00
10	Island (Jose Marti Park) - greenspace	\$ 20	\$ 1,040	\$ 40.00	\$ 2,080.00
11	San Benito Ave. at SW 57th Ave. - street closure, dead end	\$ 12	\$ 624	\$ 24.00	\$ 1,248.00
12	Medina Ave. at Cortez St. - street closure, dead end	\$ 12	\$ 624	\$ 24.00	\$ 1,248.00
13	1300 Blk Columbus Blvd. - Island	\$ 7	\$ 364	\$ 14.00	\$ 728.00
14	Lot #17 - 217 Madeira Ave. - ALL & ROW	\$ 61	\$ 3,172	\$ 122.00	\$ 6,344.00
15	Alhambra Circle - Median Galiano to back of wall at Madiera	\$ 133	\$ 6,916	\$ 266.00	\$ 13,832.00
16	Lot #13, 234 Navarre Ave. - ALL & ROW	\$ 49	\$ 2,548	\$ 98.00	\$ 5,096.00
17	1000 Blk Alhambra Circle - Median and adjacent to entrance columns North and South of median on W Granada	\$ 49	\$ 2,548	\$ 98.00	\$ 5,096.00
18	1100 Blk Alhambra Circle - Median	\$ 12	\$ 624	\$ 24.00	\$ 1,248.00
19	900 Blk Alhambra Circle - Median and including the fountain area at Majorca Ave at Alhambra and the triangle at the NE corner of Alhambra at Granada and the SE and NE corner of Alhambra at Granada.	\$ 86	\$ 4,472	\$ 172.00	\$ 8,944.00
20	1200 Blk Alhambra Circle - Median	\$ 12	\$ 624	\$ 24.00	\$ 1,248.00
21	1300 Blk. Alhambra Circle - Median, Including Cadiz/Alhambra Island	\$ 12	\$ 624	\$ 24.00	\$ 1,248.00
22	Lot #21, 140 Minorca Ave. - ALL & ROW	\$ 24	\$ 1,248	\$ 48.00	\$ 2,496.00
23	Country Club Prado - Median 8th St. to Sevilla Ave., including islands, lots at 8th St and the two cul-de-sacs at Red Road and Coral Way	\$ 984	\$ 51,168	\$ 1,968.00	\$ 102,336.00
24	1400 Blk. Alhambra Circle - Median	\$ 12	\$ 624	\$ 24.00	\$ 1,248.00
25	800 Blk Alhambra Circle - point, north side & median	\$ 12	\$ 624	\$ 24.00	\$ 1,248.00
26	Water Tower - Ferdinand St. and Alhambra Circle - entire block	\$ 37	\$ 1,924	\$ 74.00	\$ 3,848.00
27	700 Blk Alhambra Circle - Median and park area North side	\$ 12	\$ 624	\$ 24.00	\$ 1,248.00
28	Alhambra Circle 200-300 Blk. - Median	\$ 12	\$ 624	\$ 24.00	\$ 1,248.00
29	2000 Blk. Alhambra Circle - Median	\$ 12	\$ 624	\$ 24.00	\$ 1,248.00
30	400 Blk Alhambra Circle - Median	\$ 12	\$ 624	\$ 24.00	\$ 1,248.00
31	500 Blk Alhambra Circle - Median - including swale area at back of wall	\$ 12	\$ 624	\$ 24.00	\$ 1,248.00
32	Lot #25, 104 Merrick Way - ALL & ROW	\$ 68	\$ 3,536	\$ 136.00	\$ 7,072.00
33	600 Blk Alhambra Circle - point, north side & median	\$ 12	\$ 624	\$ 24.00	\$ 1,248.00
34	2100 Blk. Alhambra Circle - Median	\$ 12	\$ 624	\$ 24.00	\$ 1,248.00
35	Lot #3 - 330 Aragon Ave - ALL & ROW	\$ 74	\$ 3,848	\$ 148.00	\$ 7,696.00
36	2200 Blk. Alhambra Circle - Median	\$ 12	\$ 624	\$ 24.00	\$ 1,248.00
37	900 Castle Ave. - Greenspace	\$ 57	\$ 2,964	\$ 114.00	\$ 5,928.00
38	Hernando & 500 Coral Way - Parking lot including ROW	\$ 86	\$ 4,472	\$ 172.00	\$ 8,944.00
39	2300 and 2400 blks Alhambra Circle - 2 points, west side of Alhambra, North and South of Coral Way	\$ 25	\$ 1,300	\$ 50.00	\$ 2,600.00
40	Garage #1, 245 Andalusia Ave. - ALL & ROW	\$ 59	\$ 3,068	\$ 118.00	\$ 6,136.00
41	Garage #4, 385 Andalusia Ave. - ALL & ROW	\$ 91	\$ 4,732	\$ 182.00	\$ 9,464.00
42	Coral Way and Red Road - entrance feature excluding flower beds.	\$ 49	\$ 2,548	\$ 98.00	\$ 5,096.00
43	Toledo St. - Coral Way to Biltmore Way - Median and Island	\$ 12	\$ 624	\$ 24.00	\$ 1,248.00
44	Lot #20, 435 Valencia Ave. - ALL & ROW	\$ 12	\$ 624	\$ 24.00	\$ 1,248.00
45	Lot #30, 95 Almeria Ave. - ALL & ROW	\$ 126	\$ 6,552	\$ 252.00	\$ 13,104.00

46	395 Alhambra-[N]Side of Alhambra only, corner LeJeune] - ALL & ROW	\$	16	\$	832	\$	32.00	\$	1,664.00
47	Valencia and Cardena - center medians including bumpouts	\$	25	\$	1,300	\$	50.00	\$	2,600.00
48	Lot #33, 250 Almeria Ave. - ALL & ROW	\$	55	\$	2,860	\$	110.00	\$	5,720.00
49	1400 Blk. Valencia Ave - Medians East and West of San Domingo	\$	12	\$	624	\$	24.00	\$	1,248.00
50	1300 Blk. Valencia - Island at Indian Mound Trail	\$	12	\$	624	\$	24.00	\$	1,248.00
51	Indian Mound Trail - ROW between Valencia Ave and Sevilla Ave. West Side	\$	12	\$	624	\$	24.00	\$	1,248.00
52	Palos St - Median	\$	12	\$	624	\$	24.00	\$	1,248.00
53	Lot #10, 361 Palermo Ave. - ALL & ROW	\$	12	\$	624	\$	24.00	\$	1,248.00
54	Venetian Pool Parking Lot areas (2) - one directly adjacent to the pool on the North side (triangular area) and one to the West adjacent to Granada Blvd. Includes also the Desoto Fountain hedge and weeding of annual bed. Including outside of pool	\$	221	\$	11,492	\$	442.00	\$	22,984.00
55	1000 Blk. Sevilla Ave. - median	\$	25	\$	1,300	\$	50.00	\$	2,600.00
56	1400-1500 Blks of Sevilla Ave - medians	\$	25	\$	1,300	\$	50.00	\$	2,600.00
57	Indian Mound Trail & Sevilla Ave - Island	\$	12	\$	624	\$	24.00	\$	1,248.00
58	Santander Avenue & Galiano Court - greenspace at the curve, ROW included	\$	50	\$	2,600	\$	100.00	\$	5,200.00
59	Lot #36, 243 University Dr. - ALL & ROW	\$	42	\$	2,184	\$	84.00	\$	4,368.00
60	Equipment Yard at 2800 SW 72nd Ave.	\$	590	\$	30,680	\$	1,180.00	\$	61,360.00
61	San Sebastian Ave at Coconut Grove Dr.	\$	12	\$	624	\$	24.00	\$	1,248.00
62	San Sebastian Park - 100 Blk. San Sebastian Ave. Including ROW	\$	77	\$	4,004	\$	154.00	\$	8,008.00
63	Malaga Ave. at SW 57th Ave., street closure, dead end	\$	12	\$	624	\$	24.00	\$	1,248.00
64	Romano Avenue at SW 38th Ave - street closure, dead end	\$	12	\$	624	\$	24.00	\$	1,248.00
65	Blk bordered by Anastasia Ave./Columbus Blvd./Malaga Ave. Entire ROW of lot except where there are new homes	\$	37	\$	1,924	\$	74.00	\$	3,848.00
66	Segovia Street from Billmore Way to Bird Road - Entire new median and two triangular areas adjacent to Segovia at Riviera Drive (West of Segovia) and University Drive (East of Segovia)	\$	590	\$	30,680	\$	1,180.00	\$	61,360.00
67	Sarto Avenue at SW 38th Ave - street closure, dead end	\$	12	\$	624	\$	24.00	\$	1,248.00
68	3200 blk Toledo St. - Island	\$	12	\$	624	\$	24.00	\$	1,248.00
69	University Dr. - South ROW Sarto to Cadima	\$	74	\$	3,848	\$	148.00	\$	7,696.00
70	Billmore Tennis Complex - 1150 Anastasia Ave, including ROW East to the rear property line of the house on Granada, Tennis Parking Lot and entire fenced area.	\$	703	\$	36,556	\$	1,406.00	\$	73,112.00
71	Camilo Avenue at SW 38th Ave - street closure, dead end	\$	12	\$	624	\$	24.00	\$	1,248.00
72	Ponce De Leon Blvd. (Bird Rd. to Catalonia Ave.) including triangle at Malaga and median just N Catalonia	\$	148	\$	7,696	\$	296.00	\$	15,392.00
73	University Dr. - Camilo to Riviera - ROW and adjacent empty lot including ROW	\$	184	\$	9,568	\$	368.00	\$	19,136.00
74	Aledo Avenue at SW 38th Ave - street closure, dead end	\$	12	\$	624	\$	24.00	\$	1,248.00
75	3400 Blk. Banos Ct. - Island (Durango St at Banos Ct) - greenspace	\$	18	\$	936	\$	36.00	\$	1,872.00
76	University Dr. - Cadima to Riviera - lot including ROW	\$	148	\$	7,696	\$	296.00	\$	15,392.00
77	Cadima Avenue at SW 38th Ave - street closure, dead end	\$	12	\$	624	\$	24.00	\$	1,248.00
78	Cadima Avenue at Alley at SW 39th Ave - street closure, dead end	\$	12	\$	624	\$	24.00	\$	1,248.00
79	Taragona at SW 57th Ave.	\$	18	\$	936	\$	36.00	\$	1,872.00
80	1500 Taragona Ave. - ROW, Park on canal down to water and alhambra bridge	\$	11	\$	572	\$	22.00	\$	1,144.00
81	Viscaya Ct. (hedges to West end)	\$	74	\$	3,848	\$	148.00	\$	7,696.00
82	Lot-SW corner University Dr. & Segovia St.	\$	20	\$	1,040	\$	40.00	\$	2,080.00
83	Murcia Ave. at Red Rd. - street closure, dead end	\$	12	\$	624	\$	24.00	\$	1,248.00
84	Alcala Ave. at Red Rd. - street closure, dead end	\$	12	\$	624	\$	24.00	\$	1,248.00
85	Plasentia Ave. at Red Rd - street closure, dead end	\$	12	\$	624	\$	24.00	\$	1,248.00
86	2508 DESOTO-City Signage Area	\$	12	\$	624	\$	24.00	\$	1,248.00
87	3800 Blk. Alhambra Ct. - Lot with ROW & big triangle park	\$	12	\$	624	\$	24.00	\$	1,248.00
88	Girl Scout house and pump house lot at Granada Blvd. & Bird Road	\$	12	\$	624	\$	24.00	\$	1,248.00
89	Sopera Ave. at Red Rd - street closure, dead end	\$	12	\$	624	\$	24.00	\$	1,248.00
90	San Amaro Ct. & Bird Rd. - street closure, dead end	\$	12	\$	624	\$	24.00	\$	1,248.00
91	Ponce De Leon Blvd. - Bird Rd. to San Lorenzo. Medians including east side ROW at San Lorenzo	\$	98	\$	5,096	\$	196.00	\$	10,192.00
92	500 San Esteban Ave. - Island	\$	12	\$	624	\$	24.00	\$	1,248.00
93	4600 Blk. Riviera Dr., North of Vilabella - Manatee View Spot ROW (canal end) area adjacent to wall, including bank down to water	\$	25	\$	1,300	\$	50.00	\$	2,600.00
94	Granada Blvd. at Jeronimo Dr. bridge - Hedges and Median	\$	25	\$	1,300	\$	50.00	\$	2,600.00
95	Lot #41 Passport Office - 4520 Ponce De Leon Blvd. - ROW only	\$	69	\$	3,588	\$	138.00	\$	7,176.00
96	Lot #31, 350 Greco Ave. - ALL & ROW	\$	78	\$	4,056	\$	156.00	\$	8,112.00
97	Vilabella Ave. at LeJeune Rd. - street closure, dead end	\$	12	\$	624	\$	24.00	\$	1,248.00
98	Ponce De Leon Blvd. between Oak Ave. and LeJeune Rd. ROW, north side	\$	95	\$	4,940	\$	190.00	\$	9,880.00

99	Lot #40 - 4500 Blk. Ponce De Leon Blvd. - including ROW	\$	57	\$	2,964	\$	114.00	\$	5,928.00
100	Alminar Ave. at LeJeune Rd. - street closure, dead end	\$	12	\$	624	\$	24.00	\$	1,248.00
101	1300 Blk. Mendavia Ave - greenspace	\$	57	\$	2,964	\$	114.00	\$	5,928.00
102	S. Dixie Hwy- ROW East side Red Road to Grand Ave., ROW West side from North end of Fire II to LeJeune Rd.	\$	1,180	\$	61,360	\$	2,360.00	\$	122,720.00
103	Cadagua Ave. at LeJeune Rd. - street closure, dead end	\$	12	\$	624	\$	24.00	\$	1,248.00
104	600 Blk. Blue Rd. - 2 Islands	\$	45	\$	2,340	\$	90.00	\$	4,680.00
105	Ponce de Leon Blvd. at Blue Road - Island	\$	12	\$	624	\$	24.00	\$	1,248.00
106	800 Blk. Blue Rd. - Park-down to water & ROW (Blue Rd waterway park)	\$	12	\$	624	\$	24.00	\$	1,248.00
107	Lot #12 & 16, 4650 Ponce de Leon Blvd. - actually 3 lots including lot 12 - ALL & ROW	\$	184	\$	9,568	\$	368.00	\$	19,136.00
108	Kakouris Park - 1300 Blk. Campo Sano Ave. - at Campo Sano Ct. - Lot. Area with big oak tree.	\$	78	\$	4,056	\$	156.00	\$	8,112.00
109	Fire Station II - 525 South Dixie Highway including ROW	\$	504	\$	26,208	\$	1,008.00	\$	52,416.00
110	San Amaro Ct. at San Amaro Dr. - ROW around lot	\$	100	\$	5,200	\$	200.00	\$	10,400.00
111	700 Blk. Paradiso Ave. - Island	\$	12	\$	624	\$	24.00	\$	1,248.00
112	Pisano Ave. Bridge - ROW East side of bridge only to Carillo. Including area all the way to wall on the North side.	\$	12	\$	624	\$	24.00	\$	1,248.00
113	900 Blk Pisano Ave. - Granada Pinapple -greenspace	\$	12	\$	624	\$	24.00	\$	1,248.00
114	Ponce de Leon Blvd. - Median & swale - Lejeune Rd. to Red Rd. - ALL & ROW	\$	984	\$	51,168	\$	1,968.00	\$	102,336.00
115	Zuleta Ave. at SW 57th Ave. - street closure, dead end	\$	37	\$	1,924	\$	74.00	\$	3,848.00
116	Consolata Ave. at SW 57th Ave. - street closure, dead end	\$	12	\$	624	\$	24.00	\$	1,248.00
117	San Amaro Drive (Ponce de Leon Blvd. to Campo Sano Court) Median, traffic circles and small side beds	\$	1,444	\$	75,088	\$	2,888.00	\$	150,176.00
118	Zoreta Ave. at SW 57th Ave. - street closure, dead end	\$	12	\$	624	\$	24.00	\$	1,248.00
119	Delgado Ave. at SW 57th Ave. - street closure, dead end	\$	12	\$	624	\$	24.00	\$	1,248.00
120	Mataro Ave. at SW 57th Ave. - street closure, dead end	\$	12	\$	624	\$	24.00	\$	1,248.00
121	Sagua Ave. Ponce de Leon Blvd. to Levante Ave. - ROW hedges	\$	37	\$	1,924	\$	74.00	\$	3,848.00
122	Lot #43, 5700 Ponce De Leon Blvd. - ALL & ROW	\$	74	\$	3,848	\$	148.00	\$	7,696.00
123	Strip of ROW outside of wall on Lejeune RD across from covinient store just South of US 1 (East side of Lejeune Rd.)	\$	74	\$	3,848	\$	148.00	\$	7,696.00
124	Rosaro Ave. - US1 to Menendez - hedges	\$	25	\$	1,300	\$	50.00	\$	2,600.00
125	Menendez Ave. - ROW both sides, LeJeune to Riviera including Riviera side of lot at US1	\$	295	\$	15,340	\$	590.00	\$	30,680.00
126	Orduna Dr. - greenspace	\$	25	\$	1,300	\$	50.00	\$	2,600.00
127	5600 Blk. Granada Blvd. at Orduna Drive point	\$	42	\$	2,184	\$	84.00	\$	4,368.00
128	800 Blk. Miller Rd. - 2 islands and greenspace	\$	111	\$	5,772	\$	222.00	\$	11,544.00
129	Miami-Homestead Ave. - West side from Augusto to Sardinas	\$	246	\$	12,792	\$	492.00	\$	25,584.00
130	Miami-Homestead Ave. School ROW East side between Marius to Augusto	\$	504	\$	26,208	\$	1,008.00	\$	52,416.00
131	Orduna Dr. at Miller Rd - street closure, dead end	\$	12	\$	624	\$	24.00	\$	1,248.00
132	5600-5800 blk Marius St. - ROW on school side	\$	98	\$	5,096	\$	196.00	\$	10,192.00
133	5000 Blk. Maynada St. at Augusto point In between Maynada St. and Augusto St.	\$	78	\$	4,056	\$	156.00	\$	8,112.00
134	1100 Blk. Madruga Ave.- ROW of lots, North side	\$	49	\$	2,548	\$	98.00	\$	5,096.00
135	5700-5900 blk Augusto St. ROW on school side and empty lot and median at celini street. Lot is on West side of Augusto St. between Leonardo and Maynada.	\$	350	\$	18,200	\$	700.00	\$	36,400.00
136	Mall St.- Median & Island, Marius to Hardee Rd.	\$	37	\$	1,924	\$	74.00	\$	3,848.00
137	6900 Blk. Granada Blvd. at Mall St. NW swale	\$	37	\$	1,924	\$	74.00	\$	3,848.00
138	Hardee Bridge & Granada Blvd. to Riviera Dr. Down to water where accessible	\$	25	\$	1,300	\$	50.00	\$	2,600.00
139	1200 blk S. Alhambra ROW east side waterway.	\$	43	\$	2,236	\$	86.00	\$	4,472.00
140	Granada Bridge- S. Alhambra Cir. to Alfonso Down to water where accessible	\$	49	\$	2,548	\$	98.00	\$	5,096.00
141	700 Blk. S. Alhambra Circle at Veronese- Island	\$	28	\$	1,456	\$	56.00	\$	2,912.00
142	1400-1500 Blk Madruga (south side)	\$	37	\$	1,924	\$	74.00	\$	3,848.00
143	1400-1500 Blk. Monza (north side)	\$	37	\$	1,924	\$	74.00	\$	3,848.00
144	Maynada Bridge- S. Alhambra Cir. to Alfonso down to water where accessible	\$	25	\$	1,300	\$	50.00	\$	2,600.00
145	1500 Blk. Yenera (north side)	\$	56	\$	2,912	\$	112.00	\$	5,824.00
146	Yumuri Street - 6600 Blk-6900Sunset (east & west side)	\$	337	\$	17,524	\$	674.00	\$	35,048.00
147	Sunset Road at Granada Blvd. (small triangle island)	\$	37	\$	1,924	\$	74.00	\$	3,848.00
148	MacFarlane Linear Park - Grand Ave to Brooker Street	\$	148	\$	7,696	\$	296.00	\$	15,392.00
149	Sunrise Terrace. - Cul-de-Sac	\$	51	\$	2,652	\$	102.00	\$	5,304.00
150	Sunrise Court. - Cul-de-Sac and Triangle	\$	51	\$	2,652	\$	102.00	\$	5,304.00
151	Sunrise Place - Cul-de-Sac and Triangle	\$	37	\$	1,924	\$	74.00	\$	3,848.00



152	Cartagena Circle and surrounding areas to the water	\$	37	\$	1,924	\$	74.00	\$	3,848.00
153	Pinewood Cemetery	\$	74	\$	3,848	\$	148.00	\$	7,696.00
154	7700 Blk. Almansa St. at Old Cutler - Island	\$	154	\$	8,008	\$	308.00	\$	16,016.00
155	Section I Cocoplum (The area accessed from Los Pinos Blvd. at Cocoplum road) - Pump station area next to tennis courts and 6 cul-de-sac's	\$	384	\$	19,968	\$	768.00	\$	39,936.00
156	San Bruno Ave. - Cul-de-Sac only	\$	58	\$	3,016	\$	116.00	\$	6,032.00
157	Old Cutler & Arvida. Medians on both sides of traffic light	\$	61	\$	3,172	\$	122.00	\$	6,344.00
158	Kendall Drive at School House Road -triangular area and including the median hedge area on Hammock Lake Dr. to the south	\$	210	\$	10,920	\$	420.00	\$	21,840.00
159	SW 93 street (Oakwood Lane) - Cul-de-sac	\$	39	\$	2,028	\$	78.00	\$	4,056.00
160	500 Blk. Reinante Ave. - 3 Cul-de-Sacs	\$	213	\$	11,076	\$	426.00	\$	22,152.00
161	Solano Prado - all traffic islands and one cul-de-sac. The entrance swales and medians (from East side of main entrance to Balada street - excluding residential ROW and guard house with its associated side planters).	\$	74	\$	3,848	\$	148.00	\$	7,696.00
162	School House Road - West ROW 92 street to 93 street.	\$	25	\$	1,300	\$	50.00	\$	2,600.00
163	600 Blk. Marquesa Dr. - Cul-de-Sac	\$	12	\$	624	\$	24.00	\$	1,248.00
164	ROW of lot at Schoolhouse Rd. and 93 street.	\$	12	\$	624	\$	24.00	\$	1,248.00
165	SW 95 Terrace(Kerwood Oak Drive) - Median hedge & 1 Cul-de-sac and also 2 cul-de-sacs on Kerwood Terrace and Kerwood Ct.	\$	183	\$	9,516	\$	366.00	\$	19,032.00
166	9300 Gallardo St. - Cul-de-Sac	\$	73	\$	3,796	\$	146.00	\$	7,592.00
167	Balada St. - Cul-de-Sac	\$	36	\$	1,872	\$	72.00	\$	3,744.00
168	Old Cutler Road- ROW, Red Road to Sunset Circle excluding area South of Snapper Creek Road to the Bridge on West side only.	\$	1,180	\$	61,360	\$	2,360.00	\$	122,720.00
169	Campana Ave. - Guardhouse, ROW North side Eastward to Monforo St., 3 Hammock Oaks Cul-de-Sacs	\$	307	\$	15,964	\$	614.00	\$	31,928.00
170	Girasol Ave. - Medians and Cul-de-Sac	\$	49	\$	2,548	\$	98.00	\$	5,096.00
171	Sierra Circle & Nogales St. - all unmowed ROW's	\$	49	\$	2,548	\$	98.00	\$	5,096.00
172	Neda St. - ROW South side	\$	12	\$	624	\$	24.00	\$	1,248.00
173	Fire III - 11911 Old Cutler Road	\$	249	\$	12,948	\$	498.00	\$	25,896.00
174	East ROW Red Road-From Old Cutler Rd., South along Montgomery foundation fence line to north entrance of Gulliver Academy	\$	221	\$	11,492	\$	442.00	\$	22,984.00
175	1200 Blk. Cartagena Ave. - North side	\$	12	\$	624	\$	24.00	\$	1,248.00
176	12400 Red Road - two entrance sign areas and right of way of Red Road on West side of street South of these areas.	\$	74	\$	3,848	\$	148.00	\$	7,696.00
177	12500-12600 Blks. Ramiro St. - 2 Cul-de-Sacs	\$	74	\$	3,848	\$	148.00	\$	7,696.00
178	12700 Blk. Virtudes St. - East side	\$	37	\$	1,924	\$	74.00	\$	3,848.00
179	1300 Blk. Coruna Ave. - Cul-de-Sac	\$	37	\$	1,924	\$	74.00	\$	3,848.00
180	800-1000 Blks. Lugo Ave. - North side	\$	37	\$	1,924	\$	74.00	\$	3,848.00
181	Red Rd & Lugo. Roundabout including median	\$	49	\$	2,548	\$	98.00	\$	5,096.00
182	13000 Blk. Deva St.- Cul-de-Sac	\$	40	\$	2,080	\$	80.00	\$	4,160.00
183	1500 Blk. Agua Ave. - Cul-de-Sac	\$	40	\$	2,080	\$	80.00	\$	4,160.00
184	1300 Blk. Lenda St. - Cul-de-Sac	\$	40	\$	2,080	\$	80.00	\$	4,160.00
185	1300 Blk. Nevada St.- Cul-de-Sac	\$	40	\$	2,080	\$	80.00	\$	4,160.00
186	1500 Blk. Tagus Ave. - Cul-de-Sac	\$	40	\$	2,080	\$	80.00	\$	4,160.00
187	13000 Blk. Mar St. - Cul-de-Sac	\$	40	\$	2,080	\$	80.00	\$	4,160.00
188	13000 Blk San Jose St.- Cul-de-Sac	\$	40	\$	2,080	\$	80.00	\$	4,160.00
189	13000 Blk Zambrana St.- Cul-de-Sac	\$	40	\$	2,080	\$	80.00	\$	4,160.00
190	1300 Blk. Miranda St.- Cul-de-Sac	\$	40	\$	2,080	\$	80.00	\$	4,160.00
191	1300 Blk. San Mateo St.- Cul-de-Sac	\$	40	\$	2,080	\$	80.00	\$	4,160.00
192	Bella Vista Ave. Traffic calming installation - Deva Street	\$	37	\$	1,924	\$	74.00	\$	3,848.00
193	Bella Vista Ave. - South ROW & Median	\$	71	\$	3,692	\$	142.00	\$	7,384.00
194	Bella Vista Ave. Traffic calming installation - San Mateo	\$	14	\$	728	\$	28.00	\$	1,456.00
195	Bella Vista Ave. Traffic calming installation - San Jose	\$	14	\$	728	\$	28.00	\$	1,456.00
196	13100 Blk Red Road - East ROW within city limits for aprox. 2 blocks South of Bellavista	\$	74	\$	3,848	\$	148.00	\$	7,696.00
197	SW 144 street USDA ROW north side from East side of Guardhouse area Eastward to the ROW of the golf course.	\$	221	\$	11,492	\$	442.00	\$	22,984.00
198	Permit Dr. Marina (Kings Bay)	\$	74	\$	3,848	\$	148.00	\$	7,696.00
199	San Pedro Ave Cul-de-Sac	\$	41	\$	2,132	\$	82.00	\$	4,264.00
200	Banyan Drive - Greenspace & ROW	\$	184	\$	9,568	\$	368.00	\$	19,136.00
201	Red Road - 8th St to US1 - ROW's - East side only and medians near US1	\$	1,771	\$	92,092	\$	3,542.00	\$	184,184.00
202	200 - 1500 Blk. Bird Road - Median & Swale	\$	1,574	\$	81,848	\$	3,148.00	\$	163,696.00
203	South Dixie Highway medians - Red Road to Douglas Road	\$	3,481	\$	181,012	\$	6,962.00	\$	362,024.00
204	Hammock Oaks Pump Station - 12 cycles	\$	37	\$	1,924	\$	74.00	\$	3,848.00

205	Coral Gables Country Club - 997 N Greenway Dr - ALL & ROW	\$ 110	\$ 5,720	\$ 220.00	\$ 11,440.00
206	US1 - Royal Palms (FDOT) - 4 cycles	\$ 2,005	\$ 104,260	\$ 4,010.00	\$ 208,520.00
207	US1 - Planting (FDOT) - 12cycles	\$ 1,337	\$ 69,524	\$ 2,674.00	\$ 139,048.00
208	Lot #3 - 350 Aragon Ave. - ALL & ROW	\$ -	\$ -	\$ -	\$ -
209	Lot #4 - 153 Aragon Ave. - ALL & ROW	\$ 12	\$ 624	\$ 24.00	\$ 1,248.00
210	Lot # 7 - 221 Almeria Ave. - ALL & ROW	\$ 176	\$ 9,152	\$ 352.00	\$ 18,304.00
211	Lot #8 - 240 Giralda Ave. - ALL & ROW	\$ 86	\$ 4,472	\$ 172.00	\$ 8,944.00
212	Lot #18 - 351 Minorca Ave. - ALL & ROW	\$ 74	\$ 3,848	\$ 148.00	\$ 7,696.00
213	Lot #22 - 4010 Laguna St. - ALL & ROW	\$ 37	\$ 1,924	\$ 74.00	\$ 3,848.00
214	Garage 2, 220 Aragon Ave. - ALL & ROW	\$ 93	\$ 4,836	\$ 186.00	\$ 9,672.00
215	Garage 6, 51 Aragon Ave. - ALL & ROW	\$ 273	\$ 14,196	\$ 546.00	\$ 28,392.00
216	Aragon & Giralda 000-200 - (Litter Control)	\$ 64	\$ 3,328	\$ 128.00	\$ 6,656.00
217	Ponce De Leon 2100-2600 - (Litter Control)	\$ 64	\$ 3,328	\$ 128.00	\$ 6,656.00
218	Ponce De Leon 800-2100 - (Litter Control)	\$ 171	\$ 8,892	\$ 342.00	\$ 17,784.00
219	Alhambra (Ponce-Le June) - (Litter Control)	\$ 75	\$ 3,900	\$ 150.00	\$ 7,800.00
220	Andalusia (Le June-Douglas) - (Litter Control)	\$ 75	\$ 3,900	\$ 150.00	\$ 7,800.00
221	401 Building (Litter Control)	\$ 11	\$ 572	\$ 22.00	\$ 1,144.00
222	Merrick Park (Litter Control)	\$ 86	\$ 4,472	\$ 172.00	\$ 8,944.00
223	Pittman Park (Litter Control)	\$ 11	\$ 572	\$ 22.00	\$ 1,144.00
224	Four Horses (Litter Control)	\$ 32	\$ 1,664	\$ 64.00	\$ 3,328.00
225	8th Street Entrance (Litter Control)	\$ 32	\$ 1,664	\$ 64.00	\$ 3,328.00
226	City Hall Parking Lot (litter Control)	\$ 32	\$ 1,664	\$ 64.00	\$ 3,328.00
227	Coral Gables Museum - Litter Control	\$ 32	\$ 1,664	\$ 64.00	\$ 3,328.00
228	Holiday Litter Control (6 Saturdays DEC&JAN)	\$ 1,027	\$ 53,404	\$ 2,054.00	\$ 106,808.00
<b>TOTAL</b>		\$ 32,416	\$ 1,685,632	\$ 64,832.00	\$ 3,371,264.00

**NOTE:** Pricing shall include, but not be limited to, full compensation for labor, supervision, personnel, materials, any and all tools and equipment used, travel and related expenses and any and all other costs to the Proposer. The City will not pay and/or reimburse any additional costs including, but not limited to, travel, mileage, lodging, meals, and other travel and subsistence expenses. Prices shall remain fixed and firm for the term of the contract, including renewal options.

Coral Gables Buy American Preference Acknowledgment. Please acknowledge if you are asserting you qualify. Yes  Please refer to Procurement Code Sec. 2-699(Ord. No. 2016-30, § 2(2-780), 5-24-2016) Documentation supporting the assertion that a product is American manufactured, assembled or produced must be provided with your bid submittal.

Authorized Signature: Charles Gonzalez Title: SVP Print/Type Name: \_\_\_\_\_  
 Charles Gonzalez Phone: 786-999-4048 E-mail: jenna.crawford@brightview.com  
 Fax: 305-258-0809 Address: 4155 East Mowry Drive City: Homestead State: FL Zip Code: 33033

THE EXECUTION OF THIS FORM CONSTITUTES THE UNEQUIVOCAL OFFER OF THE BIDDER TO BE BOUND BY THE TERMS OF ITS BID. FAILURE TO SIGN THIS BID PRICE FORM WHERE INDICATED ABOVE BY AN AUTHORIZED REPRESENTATIVE OR PROVIDE THE FORM AS PRESENTED MAY RENDER THE BIDDER NON-RESPONSIVE.

5/5/2022

CITY OF CORAL GABLES, FL  
FINANCE DEPARTMENT / PROCUREMENT DIVISION  
405 Biltmore Way  
Coral Gables, FL 33134

RE: Letter of Exceptions to RFP No. 2022-008 ("RFP")

BrightView Landscape Services, Inc. ("BrightView") welcomes the opportunity to submit a bid to the above referenced RFP and looks forward to the possibility of partnering with you. In accordance with the accompanying Instructions, BrightView respectfully submits the following exceptions to the proposed terms and conditions included in the RFP itself and/or the Appendix.

**1.16. Contract Termination** BrightView believes that it is fair and equitable that the right to terminate without cause should be granted to both parties. This exception has no impact on any considerations for this project. Based upon the foregoing, BrightView respectfully requests the following revisions to 1.16: Line 6 insert "or Contractor" after "City"; and Line 7 – delete "thirty (30)" and insert "ninety (90)".

**2.16 Irrigation System Management** BrightView will perform an initial irrigation audit once contract is awarded. All repairs needed at the initial audit will not be at the expense of BrightView.

BrightView respectfully requests your consideration of the items noted herein and the opportunity to lightly negotiate certain terms for the mutual benefit of both parties. This Letter of Exceptions, together with any attached Scope of Services, Pricing, and other schedules and exhibits attached hereto, constitute BrightView's entire response to the RFP and supersedes all prior BrightView responses to the RFP, whether oral or written.

Please contact Jeremy Cruz at [Jeremy.Cruz@brightview.com](mailto:Jeremy.Cruz@brightview.com) regarding any questions you have concerning BrightView's proposed bid.

Sincerely,



Charles Gonzalez  
BrightView Landscape Services, Inc.  
Senior Vice President