

**EDWARDS & PARTNERS**  
CONSULTING ENGINEERS

November 19, 2019

Mr. Jorge E. Acevedo, P.E., Utility Director  
City of Coral Gables Public Works Department  
2800 SW 72 Avenue  
Miami, Florida 33155

RECEIVED

NOV 19 2019

PUBLIC WORKS DEPT.

Re: University of Miami, Student Housing  
1280 Stanford Drive, Coral Gables, Florida 33146

Dear Mr. Acevedo:

Please accept this letter to initiate the appropriate process necessary for the City to approve the sewer connection for the above referenced property (University of Miami Student Housing Project), by means of a new private lift station and connection to existing force main vice tap. This property is outside a sanitary-sewer district, but within City limits. It is our understanding that Commission approval must be granted, so request to include this item in the appropriate meeting is made.

UM has provided a Letter of Agreement. The projected average flow is 41,580 gallons per day. Applying a peak factor of 4.0, the peak demand equates to 166,320 GPO. The private lift station discharges to an existing - force main vice tap located on the south side of Ponce de Leon Boulevard.

Please allow this letter to serve as a consent by the applicant, to the following terms:

1. To pay a connecting fee of \$2,100 per 1000 gallons per day of peak demand paid concurrently upon signing this agreement. The connection charge shall be adjusted to reflect actual usage if greater, but in no case less that the amount originally charged. An alternate may be granted whereby, in lieu of paying connection charges at time of execution of the customer agreement, the applicant or customer may be permitted to file with the City a cash bond in the amount to be agreed upon between the City Manager and the customer, guaranteeing installment payments of said sewer service connection charges.

2. To comply with all the conditions set forth under Chapters 62 and 78 of the City Code, Resolution No. 22601, and any other pertinent ordinances or resolutions, copies of which the applicant/customer has reviewed and fully acknowledge by agreeing hereto, except that rates applied to connecting outside the City shall be 25 greater than rates applicable to the same connection within the City. This connection is outside existing sanitary sewer districts, but inside the City, the 25% additional rate shall not apply.

3. To the billing and collecting of Sewer Service charges as determined by the City of Coral Gables. Other agencies, for example the Miami Dade Water and Sewer Department, may be designated by the City to bill and/or collect sewer service charges. Sewer service charges shall be due within ten (10) days of receipt of billing by the customer. If the sewer service charge remains unpaid 30 days after due date, the

City may have water services to the property disconnected. All sewer service charges to any building or structure or unit remaining unpaid 30 days after due date shall become a lien against and upon the lands to which service has been furnished to the same extent as the lien for special assessments in the City of Coral Gables, with the same penalties and the same rights of collection and sale as would apply for Coral Gables taxes.

4. To pay the entire cost of whatever facilities are required from the source of the sewage to the point of connection with the Coral Gables system.

5. To furnish the City Attorney with a copy of the deed for each unit of the property making outside connection, or other acceptable property ownership document.

6. To install and maintain facilities for such pre-treatment of waters as may from time be found necessary to render the wastes suitable for handling and treatment by the City without creation of nuisances. Under operational difficulty, the reasonable determination by the City and the City consulting engineers shall be binding. The following shall be required in all cases:

- a. Grease separation facilities without exception.
- b. Comminutors, except where flow is directly to a City comminutor
- c. Screens at the discretion of the City in cases of laundries and similar sources of rags, string and lint.
- d. Pre-chlorination in case of long force mains.

7. To provide the City with plans and specifications in quadruplicate for applicant/customer sanitary sewer facilities as prepared by a registered civil engineer, licensed to practice in the State of Florida and fully experienced and qualified in the design of sanitary sewer systems. Said plans and specifications shall be reviewed by the City and returned to the applicant/customer marked for revision until the plans are returned marked approved and signed as such by the Director of Public Works. A composite plan/profile survey of existing utilities shall be prepared of each Coral Gables right-of-way through which a pipeline run is proposed, showing the exact relationship between and among all existing and proposed facilities. The City may refuse to process the plans unless the composite picture is complete, so that the most feasible route with the least inconvenience to residents may be confirmed by the Director of Public Works.

8. To provide a cut-off valve at the point of connection with the Coral Gables system. This cutoff valve shall be shown and described in the above plans and specifications.

9. To provide the City with a letter from said licensed/registered engineer stating that said engineering services have been retained to provide full time resident inspection during construction and installation of said facilities. Upon completion of the installation, said engineer shall certify in writing that the Work has been fully and properly installed, and that the infiltration is within the allowable limits.

10. To have proposed installation shown on said approved plans and specifications constructed and installed by a fully licensed and qualified contractor, who shall obtain all prerequisite construction permits from each agency having jurisdiction prior to initiating work in the field. The Public Works Director may withhold or withdraw issuance of City right-of-way permits if compliance with portions of Step II implementation by the applicant become overdue.

11. To keep the City informed of work progress and connections inside and outside the City so that City inspectors may confirm the integrity of the facilities at each key point.

12. To be solely responsible for continuing maintenance and operation of said facilities. The City reserves the

right to inspect the facilities and to require the applicant to have timely repairs made, where infiltration or the defects adversely affecting the cost and operation of the City's sanitary sewer system. Failure of the applicant/customer to remedy defects shall be the cause for termination of the agreement and disconnection of the service. The occupants or tenants of the connected property shall be informed by the Customer that the City is not responsible for such maintenance and operation.

13. To not permit any other connection to the customer's connecting lines to the City systems except those listed in the agreement. Any additional connection, if permitted, shall be subject to approval by the City as stated herein, and the original connection charge shall be increased to reflect the additional sewage added. Additional connectors also shall furnish the City with prior written approval by the original owner of the line and prior connectors to said line.

14. To limit peak sewage flow from the outside sewer connection in so far as the property, zoning, size and/or density of the facility herein approved for connection and any proposed change thereto which would generate significant increase in the peak sewage discharge into the Coral Gables Sanitary Sewer System shall require prior approval by Coral Gables for such increase sewage discharge in accordance with the terms of this resolution.

15. To provide that the monthly charge computed at the volumetric base rate be multiplied by a value of unity for a monthly average BOD of 250 ppm or under, said value to be increased by a surcharge factor of ¼% per part per million of monthly average of BOD in excess of 250 ppm, as follows and as interpolation thereof:

<b>Monthly BOD</b>	<b>Multiplier</b>
250 ppm or less	1.000
260	1.025
270	1.050
280	1.075
290	1.100
300	1.125
400	1.375
500	1.625
1,000	2.875

16. To provide for and bear the cost of sampling with suitable sampling facilities, when reasonable cause for sampling exists. The City shall give the customer or tenant reasonable notice when sampling is necessary, and qualified City representatives shall thereafter perform the necessary sampling as efficient as possible.

17. To connect to the City sewer systems at the customer's expense in a manner acceptable to the City, when sewerage is completed to a new area in the City which can more efficiently and effectively serve the customer's outside connection.

18. To provide liability insurance in the amounts required by Resolution No. 22601, naming the City of Coral Gables as additional insured, and covering any damages to public or private property due to failure in the customer's facilities. A certificate of insurance shall be required at the execution of the agreement in a form acceptable to the City of Coral Gables.

19. To provide a maintenance bond or other surety in the amount of five (5) percent of the construction cost

to assure timely repair of the customer's facilities should a failure occur, said surety to run in perpetuity or until the connection is no longer required.

20. To bear expense of recording the agreement encompassing the above terms in the Public Records of Dade County, Florida, and said agreement shall be a covenant running with the land which will state that the owner will not convey or cause to be conveyed, the title to the above property without requiring the successor in title to abide by all the terms and conditions of said agreement.

Should you have any questions, please do not hesitate to contact us.

Very Truly Yours,



Collin E Edwards, P.E.  
President  
Edwards and Partners Inc.



November 4, 2019

Jorge Acevedo  
City of Coral Gables  
Public Works Dept.  
2800 SW 72 Avenue  
Miami, FL 33155

Re: Sewer Connection for Student Housing Project

Dear Mr. Acevedo,

The University of Miami is requesting permission to connect a force main to the existing Coral Gables force main in the Ponce de Leon right-of-way.

The following is the project information:

Applicant: University of Miami  
Address: 1535 Levante Avenue, Coral Gables, FL 33146  
Phone: 305-284-6749  
Property Address: 1280 Stanford Drive, Coral Gables, FL 33146  
Legal Description: (See Attached)  
Government Agency Jurisdiction: Coral Gables  
Proposed Additional flows to Coral Gables system: Peak - 1,229.4 GPH  
Average - 75,620 GPD  
Minimum - 0 GPD

This connection includes 124,318 GPD redirected from an existing connection at Lift Station #1. See attached calculations.

Thank you.

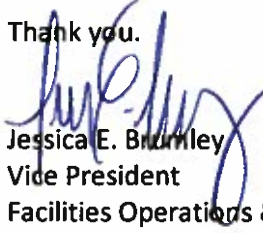
  
Jessica E. Brunley  
Vice President  
Facilities Operations & Planning  
University of Miami



# Project: University of Miami Student Housing

1320 S Dixie Hwy

Coral Gables, Florida 33146

Prepared for:

Department of Environmental Resources Management (D.E.R.M.)

## LIFT STATION #18 ENGINEERING REPORT

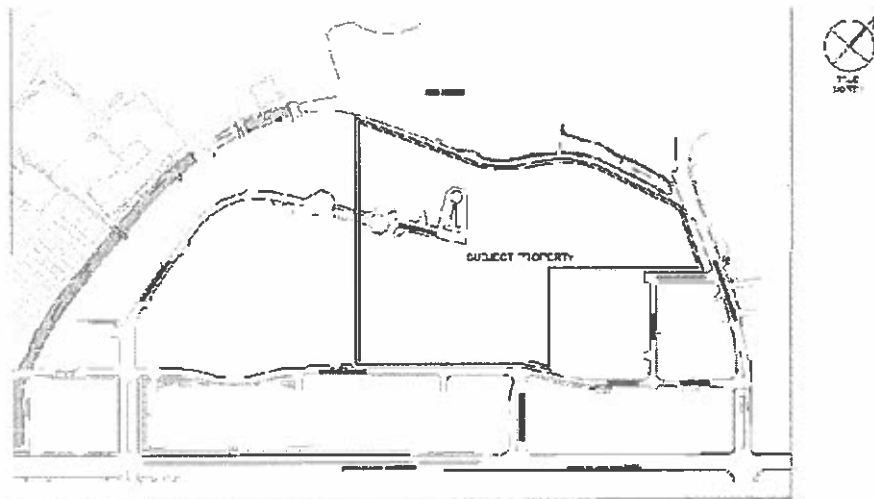

### LOCATION MAP

SCALE: 1 INCH = 300 FEET

FOLIO NUMBERS:

07-4132-0'4-0010

03-4132-0'5-0020

03-4132-0'5-0070

05-4132-0'5-0130

03-4132-0'5-0140

Prepared By: Collin. E. Edwards, P.E.

Date: February 26<sup>th</sup>, 2018

Revised: November 8<sup>th</sup>, 2018

**EDWARDS & PARTNERS**  
CONSULTING ENGINEERS

9500 S. Dixie Road, Bldg. J, Suite 703, Coral Gables, Florida 33146  
Tel: 305.662.7422 | Fax: 305.662.7472 | E-Mail: [info@edwardsandpartners.net](mailto:info@edwardsandpartners.net)

[www.edwardsandpartners.net](http://www.edwardsandpartners.net)

Site plan, drawings, etc. are the property of Edwards & Partners, Inc.

## LIFT STATION CALCULATIONS:

### Design Flows:

Type of Land Use: Apartment

School

Expected Occupancy: 452 units

65,165 ft<sup>2</sup>

Sewage Flow per Unit: 150 gpd / unit

12 gpd / 100 ft<sup>2</sup>

Average Daily Flow: 150 gpd/unit X 452 units = 67,800

12 gpd / 100ft<sup>2</sup> X 65,165 ft<sup>2</sup> = 7820

124,318 gpd (load from PS#2)

$$\begin{aligned} Q_a &= 67,800 + 7820 + 124,318 \\ &= 200,000 \text{ gpd} \\ &= 138.92 \text{ gpm (assumed run-off time of 24 hours)} \end{aligned}$$

Peak Flow Rate Factor: 4.28

Peak Flow:

$$\begin{aligned} Q_p &= Q_a \times \text{Peak Flow Rate Factor} \\ &= 138.92 \times 4.28 \\ &= 594.58 \text{ gpm} \\ &= 1.32 \text{ cfs or } 79.2 \text{ cfm} \end{aligned}$$

**EDWARDS & KELCEY**  
 ARCHITECTS  
 1000 PINE STREET, SUITE 100  
 NEW ORLEANS, LA 70112  
 (504) 581-1111  
 www.edwards-kelcey.com

**ARCHITECTONICA**  
 ARCHITECTS  
 1000 PINE STREET, SUITE 100  
 NEW ORLEANS, LA 70112  
 (504) 581-1111  
 www.architectonica.com

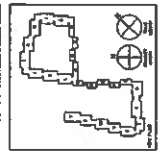

**PROPOSED SEWER LAYOUT**  
 DATE: 11/11/11  
 SHEET: C-410

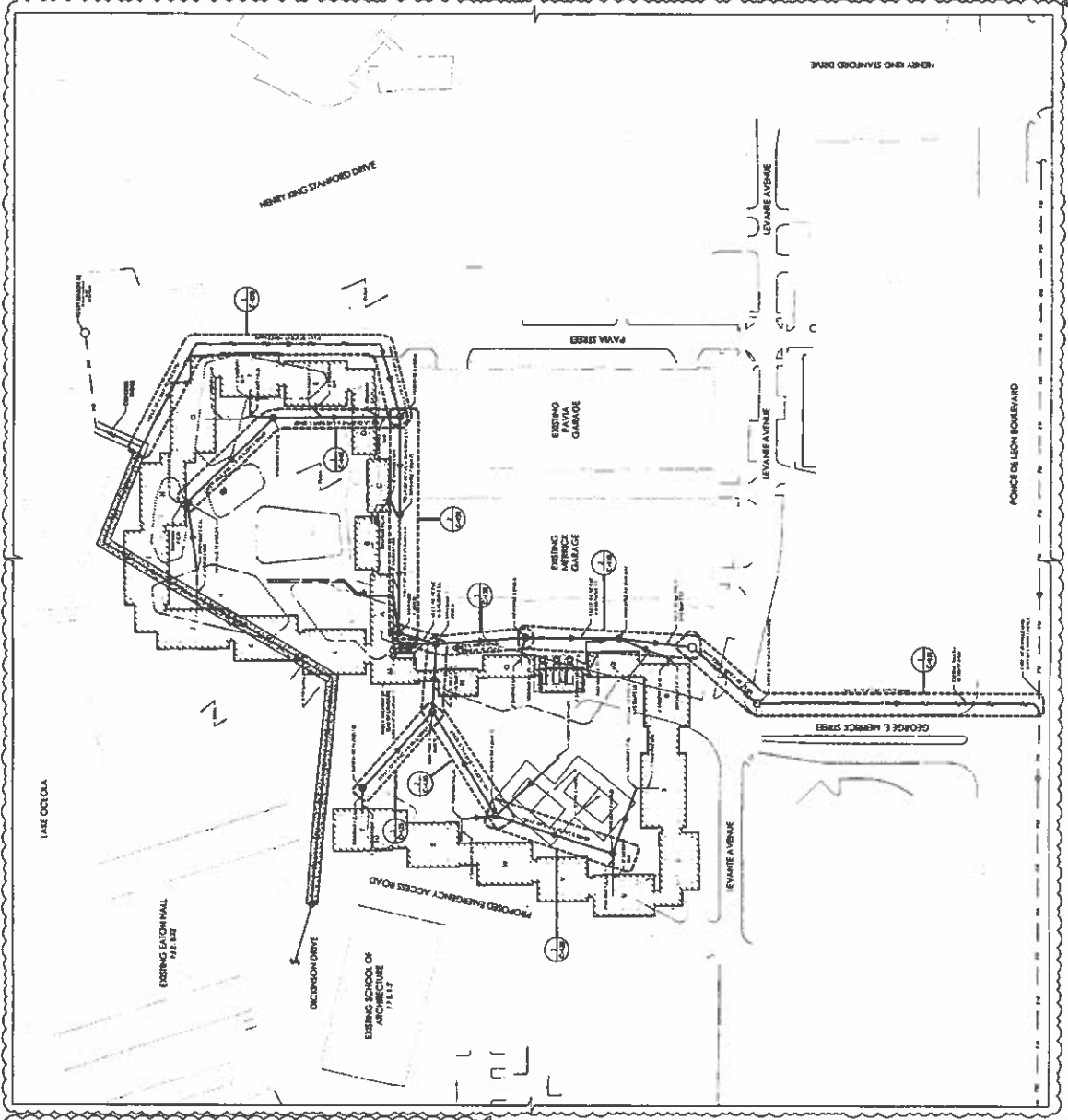

**SUPPLEMENTAL DATA**

NO.	DESCRIPTION	DATE	BY	CHECKED
1	ISSUED FOR PERMITS	11/11/11	JK	JK
2	ISSUED FOR CONSTRUCTION	11/11/11	JK	JK
3	ISSUED FOR AS-BUILT	11/11/11	JK	JK

**LEGEND**

- SANITARY SEWER MANHOLE
- LIFT STATION
- DIRECTION OF FLOW
- CHECK TRAP
- PIPE TO BE ABANDONED
- FORCE MAIN (F.M.)
- METER

**NOTE:**  
 COORDINATE LATERALS WITH PLUMBING PLAN

LINE NO.	START STATION	END STATION	LENGTH	DIAMETER	DEPTH	INVERT	GRADE	VELOCITY	MANHOLE NO.
1	1+00.00	1+10.00	10.00	12"	4'-0"	10.00	10.00	1.49	1
2	1+10.00	1+20.00	10.00	12"	4'-0"	10.00	10.00	1.49	2
3	1+20.00	1+30.00	10.00	12"	4'-0"	10.00	10.00	1.49	3
4	1+30.00	1+40.00	10.00	12"	4'-0"	10.00	10.00	1.49	4
5	1+40.00	1+50.00	10.00	12"	4'-0"	10.00	10.00	1.49	5
6	1+50.00	1+60.00	10.00	12"	4'-0"	10.00	10.00	1.49	6
7	1+60.00	1+70.00	10.00	12"	4'-0"	10.00	10.00	1.49	7
8	1+70.00	1+80.00	10.00	12"	4'-0"	10.00	10.00	1.49	8
9	1+80.00	1+90.00	10.00	12"	4'-0"	10.00	10.00	1.49	9
10	1+90.00	2+00.00	10.00	12"	4'-0"	10.00	10.00	1.49	10

LINE NO.	START STATION	END STATION	LENGTH	DIAMETER	DEPTH	INVERT	GRADE	VELOCITY	MANHOLE NO.
11	2+00.00	2+10.00	10.00	12"	4'-0"	10.00	10.00	1.49	11
12	2+10.00	2+20.00	10.00	12"	4'-0"	10.00	10.00	1.49	12
13	2+20.00	2+30.00	10.00	12"	4'-0"	10.00	10.00	1.49	13
14	2+30.00	2+40.00	10.00	12"	4'-0"	10.00	10.00	1.49	14
15	2+40.00	2+50.00	10.00	12"	4'-0"	10.00	10.00	1.49	15
16	2+50.00	2+60.00	10.00	12"	4'-0"	10.00	10.00	1.49	16
17	2+60.00	2+70.00	10.00	12"	4'-0"	10.00	10.00	1.49	17
18	2+70.00	2+80.00	10.00	12"	4'-0"	10.00	10.00	1.49	18
19	2+80.00	2+90.00	10.00	12"	4'-0"	10.00	10.00	1.49	19
20	2+90.00	3+00.00	10.00	12"	4'-0"	10.00	10.00	1.49	20

LINE NO.	START STATION	END STATION	LENGTH	DIAMETER	DEPTH	INVERT	GRADE	VELOCITY	MANHOLE NO.
21	3+00.00	3+10.00	10.00	12"	4'-0"	10.00	10.00	1.49	21
22	3+10.00	3+20.00	10.00	12"	4'-0"	10.00	10.00	1.49	22
23	3+20.00	3+30.00	10.00	12"	4'-0"	10.00	10.00	1.49	23
24	3+30.00	3+40.00	10.00	12"	4'-0"	10.00	10.00	1.49	24
25	3+40.00	3+50.00	10.00	12"	4'-0"	10.00	10.00	1.49	25
26	3+50.00	3+60.00	10.00	12"	4'-0"	10.00	10.00	1.49	26
27	3+60.00	3+70.00	10.00	12"	4'-0"	10.00	10.00	1.49	27
28	3+70.00	3+80.00	10.00	12"	4'-0"	10.00	10.00	1.49	28
29	3+80.00	3+90.00	10.00	12"	4'-0"	10.00	10.00	1.49	29
30	3+90.00	4+00.00	10.00	12"	4'-0"	10.00	10.00	1.49	30



UM STUDENT HOUSING, ID# 23500

**EXHIBIT "A" OF AGREEMENT  
BETWEEN  
MIAMI-DADE COUNTY  
AND  
UNIVERSITY OF MIAMI**

**LEGAL DESCRIPTION**

ALL THOSE LOTS, PIECES, PARCELS OR STRIPS OF LAND SITUATE, LYING AND BEING IN SECTION 30, TOWNSHIP 54 SOUTH, RANGE 41 EAST, CITY OF CORAL GABLES, MIAMI-DADE COUNTY, FLORIDA, BEING A PORTION OF BLOCK 165 OF "REVISED PLAT OF CORAL GABLES RIVIERA SECTION PART 7," ACCORDING TO THE PLAT THEREOF, AS RECORDED MARCH 19, 1928 IN PLAT BOOK 28 AT PAGE 45, TOGETHER WITH PORTIONS OF TR. 1, TR. 5, TR. 6 AND TR. 7 OF "AMENDED PLAT PORTION OF MAIN CAMPUS UNIVERSITY OF MIAMI," ACCORDING TO THE PLAT THEREOF, AS RECORDED JUNE 30, 1948 IN PLAT BOOK 46 AT PAGE 81 AND TOGETHER WITH PORTIONS OF PAVIA ST., GEO. E. MERRICK ST., WM. E. WALSH AVE. AND THEO. DICKINSON DRIVE, SAID STREETS, AVENUE AND DRIVE HAVING BEEN CREATED BY THE AFOREMENTIONED PLATS AND SUBSEQUENTLY VACATED BY CORAL GABLES CITY ORDINANCE NUMBER 2011-03 AS RECORDED JUNE 16, 2011 IN OFFICIAL RECORDS BOOK 27724 AT PAGE 2651 AND CORAL GABLES CITY ORDINANCE NUMBER 976 AS RECORDED NOVEMBER 8, 2011 IN OFFICIAL RECORDS BOOK 27887 AT PAGE 4503, ALL OF THE FOREGOING BEING FILED WITH THE CLERK OF THE CIRCUIT COURT IN THE PUBLIC RECORDS OF MIAMI-DADE COUNTY, FLORIDA AND BEING MORE PARTICULARLY DESCRIBED BY METES AND BOUNDS AS FOLLOWS, VIZ.:

BEGIN AT THE MOST SOUTHERLY CORNER OF LOT 14 IN BLOCK 165 AS SHOWN ON SAID PLAT OF "REVISED PLAT OF CORAL GABLES RIVIERA SECTION PART 7;" THENCE S47°47'57"W ACROSS THE RIGHT OF WAY FOR SAID PAVIA ST. FOR 60.00 FEET TO A POINT OF INTERSECTION WITH THE SOUTHWESTERLY RIGHT OF WAY LINE OF PAVIA ST. AND THE NORTHEASTERLY LINE OF SAID TR. 6; THENCE N42°12'03"W ALONG SAID SOUTHWESTERLY RIGHT OF WAY LINE OF PAVIA ST. AND THE NORTHEASTERLY LINE OF TR. 6 FOR 161.89 FEET; THENCE DEPARTING SAID SOUTHWESTERLY RIGHT OF WAY LINE OF PAVIA ST. AND THE NORTHEASTERLY LINE OF TR. 6, S47°47'57"W AT RIGHT ANGLES TO THE LAST DESCRIBED COURSE FOR 308.43 FEET TO A POINT OF INTERSECTION WITH THE SOUTHWESTERLY LINE OF SAID TR. 6 AND THE NORTHEASTERLY RIGHT OF WAY LINE OF SAID GEO. E. MERRICK ST.; THENCE S42°12'03"E AT RIGHT ANGLES TO THE LAST DESCRIBED COURSE FOR 431.94 FEET TO A POINT OF INTERSECTION WITH THE NORTHEASTERLY PROLONGATION OF THE SOUTHEASTERLY RIGHT OF WAY LINE OF WM. E. WALSH AVE. AS IT EXTENDS INTO SAID TR. 6; THENCE S47°47'57"W AT RIGHT ANGLES TO THE LAST DESCRIBED COURSE ALONG SAID NORTHEASTERLY PROLONGATION OF THE SOUTHEASTERLY RIGHT OF WAY LINE OF SAID WM. E. WALSH AVE. AND SAID SOUTHEASTERLY RIGHT OF WAY LINE OF WM. E. WALSH AVE. FOR 745.17 FEET; THENCE DEPARTING SAID SOUTHEASTERLY RIGHT OF WAY LINE OF WM. E. WALSH AVE., N47°12'03"W AT RIGHT ANGLES TO THE LAST DESCRIBED COURSE, CROSSING THE RIGHT OF WAY OF SAID WM. E. WALSH AVE. AND ENTERING SAID TR. 5 FOR 476.21 FEET; THENCE N47°47'57"E AT RIGHT ANGLES TO THE LAST DESCRIBED COURSE FOR 71.92 FEET; THENCE N19°02'54"W FOR 58.02 FEET; THENCE N47°47'57"E FOR 38.74 FEET; THENCE N10°02'38"W, CROSSING SAID TR. 5, THEO DICKINSON DRIVE AND TR. 1 FOR 132.87 FEET; THENCE N60°11'42"W FOR 285.69 FEET; THENCE N66°58'15"E FOR 258.91 FEET; THENCE N49°55'59"E FOR 72.86 FEET;

THENCE N74°34'53"E FOR 100.32 FEET; THENCE N38°48'44"E FOR 220.15 FEET; THENCE N42°45'42"E FOR 14.00 FEET; THENCE N59°51'24"E FOR 99.37 FEET; THENCE N71°05'17"E FOR 353.29 FEET TO A POINT OF INTERSECTION WITH THE NORTHEASTERLY LINE OF SAID TR. 1 AND THE SOUTHWESTERLY RIGHT OF WAY LINE OF HENRY KING STANFORD DRIVE (MILLER DRIVE BY PLAT); THENCE S61°31'18"W ALONG THE NORTHEASTERLY LINES OF SAID TR. 1 AND TR. 7 (THIS BEING SAID SOUTHWESTERLY RIGHT OF WAY LINE OF HENRY KING STANFORD DRIVE); FOR 355.98 FEET; THENCE DEPARTING SAID NORTHEASTERLY LINE OF TR. 7 AND THE SOUTHWESTERLY RIGHT OF WAY LINE OF HENRY KING STANFORD DRIVE, S47°47'57"W FOR 75.10 FEET TO THE MOST NORTHERLY CORNER OF LOT 14 IN SAID BLOCK 165 OF "REVISED PLAT OF CORAL GABLES RIVIERA SECTION PART 7;" THENCE S42°12'03"E ALONG THE NORTHEASTERLY LINE OF SAID LOT 14 FOR 58.00 FEET TO THE MOST EASTERLY CORNER OF SAID LOT 14; THENCE S47°47'57"W ALONG THE SOUTHEASTERLY LINE OF SAID LOT 14 FOR 105.00 FEET TO SAID MOST SOUTHERLY CORNER OF LOT 14 AND THE POINT OF BEGINNING.

SAID PARCEL OF LAND CONTAINS 738,689 SQUARE FEET OR 16.96 ACRES, BY CALCULATION.