

**NOTES:**

1. CONTRACTOR TO PAINT ALL INTERIOR WALLS, CEILINGS, & EXTERIOR WALLS. COORDINATE COLORS WITH OWNERS.
2. CONTRACTOR TO VERIFY EXACT LOCATION OF ALL TOILET ROOM, LAUNDRY ROOM, CLOSET AND KITCHEN ACCESSORIES WITH OWNER. PROVIDE P.T. WOOD BLOCKING AT ALL CABINERY AND BATHROOM ACCESSORIES.
3. FIRE BLOCKING SHALL BE PROVIDED IN WALLS EVERY 8' AT INTERCONNECTIONS, BETWEEN STAIR STRINGERS, AT OPENING, AT FLOOR JOISTS AROUND DOOR POCKETS AS PER FBC R440.0.7
4. WALL AND CEILING FINISHES SHALL HAVE A FLAME-SPREAD CLASSIFICATION OF NOT GREATER THAN 200 AND A SMOKE-DEVELOPMENT INDEX NOT GREATER THAN 450 AS PER ASTM E-84 OR UL 273.
5. AIR EXHAUST AND INTAKE OPENINGS WHICH TERMINATE AT OUTDOORS SHALL BE PROTECTED WITH CORROSION-RESISTANT SCREENS, LOUVERS, OR GRILLES WITH OPENINGS BETWEEN 1/4" AND 1/2".
6. COORD. FLOORINGS, APPLIANCES, CABINERY, HARDWARE, PLUMBING, AND LIGHTING FIXTURES WITH OWNER SELECTIONS AND INTERIOR DESIGN DRAWINGS, TYP.

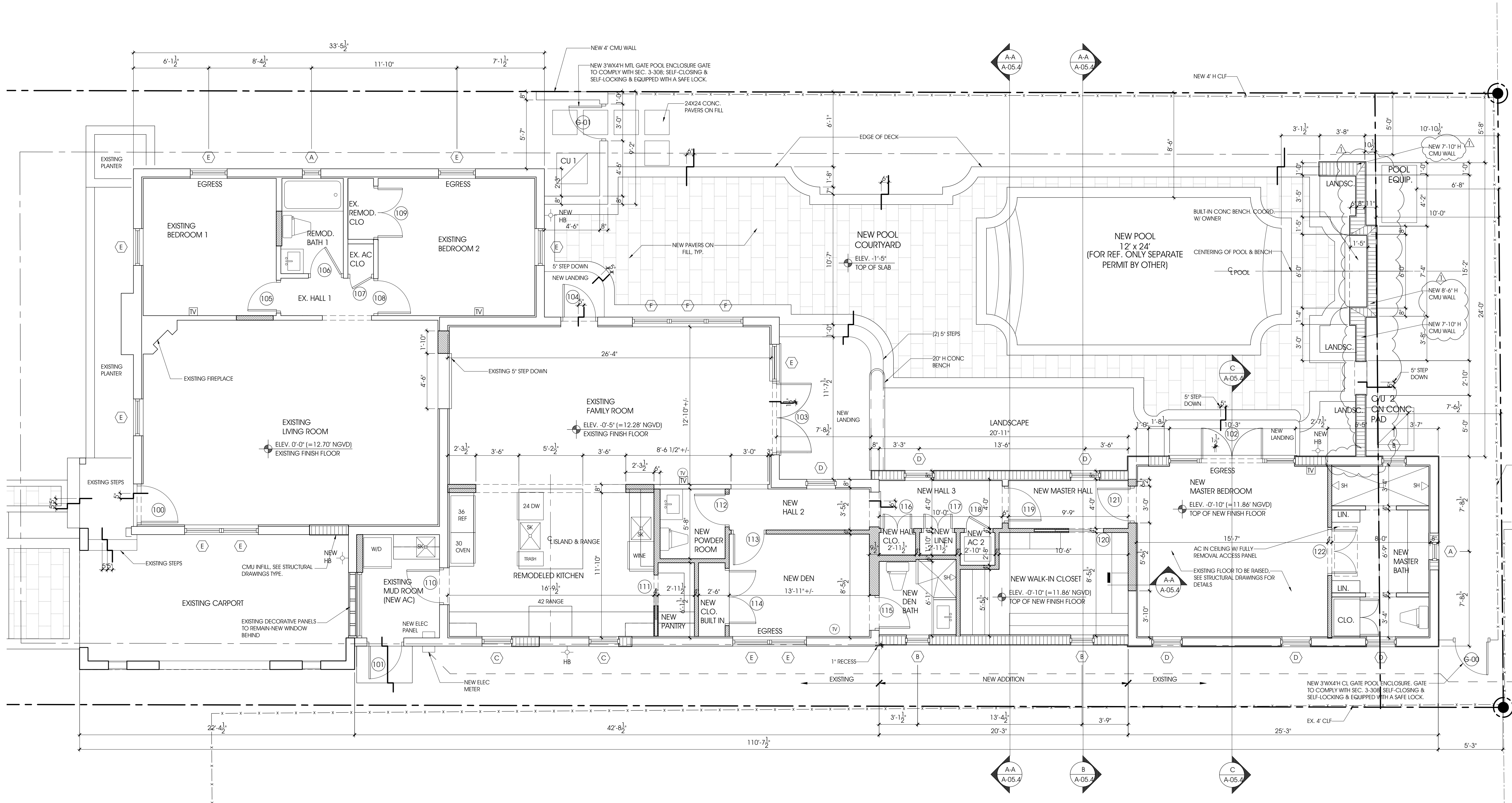

**PROPOSED FLOOR PLAN**

SCALE: 1/4" = 1'-0"

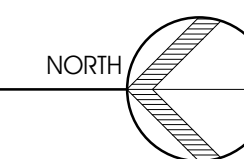

CONSULTANT(S)

NO.	REVISION/SUBMISSION	DATE
	PERMIT SUBMITTAL	10-04-24
	PRELIMINARY BOA	10-07-24
	REVIEW COMMENT	11-18-24
	PRELIMINARY COA	

PROJECT  
Remodel & Addition to  
1-Story Residence  
720 Madeira Avenue  
Coral Gables, FL 33134

DRAWING  
Proposed Floor Plan

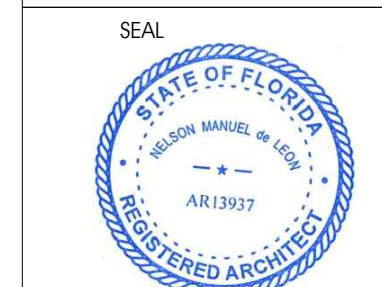

Nelson de Leon  
AR 13937

SHEET NO.

A-02.1

SCALE  
DRAWN  
REVIEWED  
Ndl  
PROJ. NO.  
361